

### Project Narrative/Notes/Revisions

1. 07/27/2023 ZD - COMPLETED DESIGN FOR CLIENT & CITY REVIEW.
2. 01/18/2024 ZD - REDLINES
3. 03/28/2024 ZD - REDLINES

# TAYLOR WEST WEBER PARK

## 1800 S

### Improvement Plans

TAYLOR, WEBER COUNTY, UTAH  
JULY, 2023

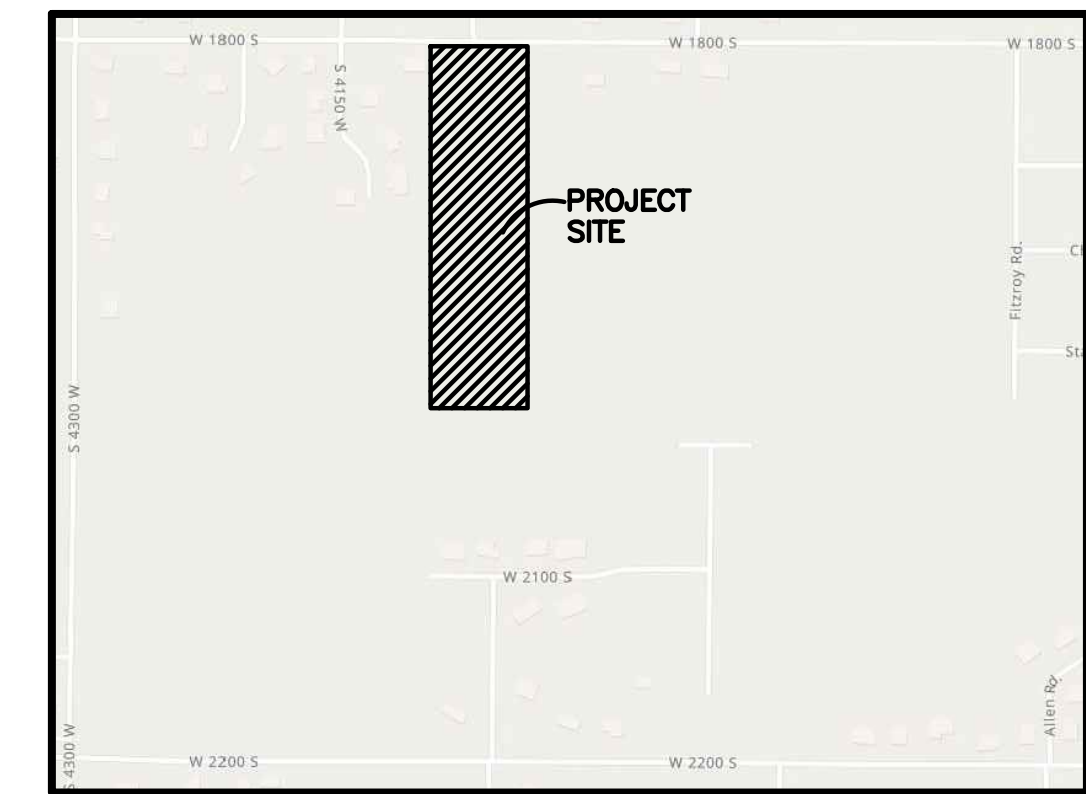

### Vicinity Map

NOT TO SCALE

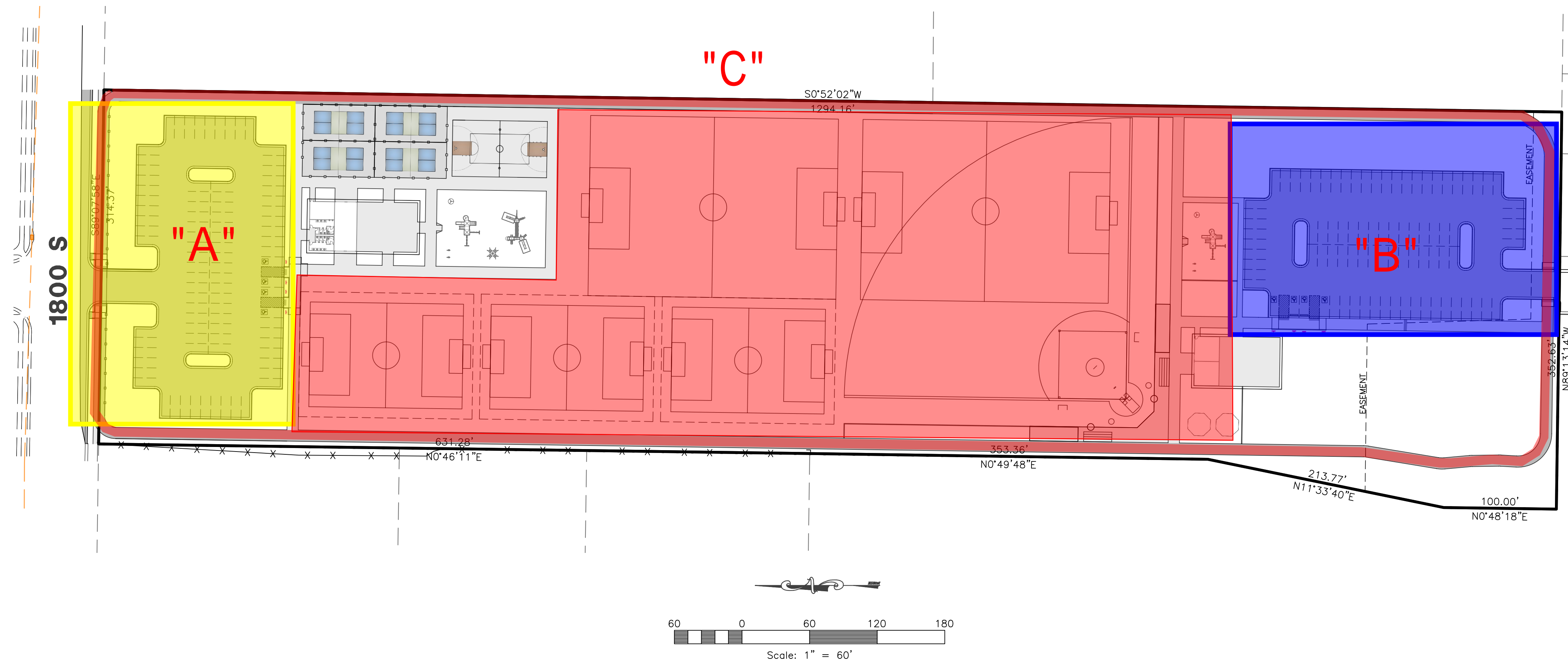

## SITE DATA

PARKING:	179 STALLS PROVIDED (8 A.D.A.)
PARCEL AREA:	413,820 S.F. (9.50 ACRES)
BUILDING AREA:	7,568.69 S.F. (0.17 ACRES)
ASPHALT AREA:	133,254 S.F (3.06 ACRES)
LANDSCAPE AREA:	272,998 S.F. (6.27 ACRES)
LS RATIO:	65.9%

## Engineer's Notice To Contractors:

THE EXISTENCE AND LOCATION OF ANY UNDERGROUND UTILITY PIPES OR STRUCTURES SHOWN ON THESE PLANS WERE OBTAINED FROM AVAILABLE INFORMATION PROVIDED BY OTHERS. THE LOCATIONS SHOWN ARE APPROXIMATE AND SHALL BE CONFIRMED IN THE FIELD BY THE CONTRACTOR, SO THAT ANY NECESSARY ADJUSTMENT CAN BE MADE IN ALIGNMENT AND/OR GRADE OF THE PROPOSED IMPROVEMENT. THE CONTRACTOR IS REQUIRED TO CONTACT THE UTILITY COMPANIES AND TAKE DUE PRECAUTIONARY MEASURE TO PROTECT ANY UTILITY LINES SHOWN, AND ANY OTHER LINES OBTAINED BY THE CONTRACTOR'S RESEARCH, AND OTHERS NOT OF RECORD OR NOT SHOWN ON THESE PLANS.

**Surveyor:**

**Jason Felt**  
Reeve & Associates, Inc.  
5160 South 1500 West  
Riverdale, Utah, 84405  
PH:(801) 621-3100

**Landscape Architect:**

**Nathan Peterson**  
Reeve & Associates, Inc.  
5160 South 1500 West  
Riverdale, Utah, 84405  
PH: (801) 621-3100

**Developer Contact:**

Pat Burns  
Lync Construction  
1946 W 5600 S  
Roy, Utah, 84067  
PH: (801) 710-2234

**Project Contact:**

**Jeremy Draper**  
Reeve & Associates, Inc.  
5160 South 1500 West  
Riverdale, Utah, 84405  
PH:(801) 621-3100



REVISIONS	DATE	DESCRIPTION
	01/18/24	ZD Redlines
	03/28/24	ZD Redlines

**Taylor West Weber Park**  
**1800 South**  
Weber County, Utah

Cover/Index Sheet



### Project Info.

Engineer:  
J. NATE REEVE, P.E.

---

Drafter:  
Z. DECARIA

---

Begin Date:  
February, 2023

---

Name:  
Taylor West Weber Park

Number: 6298-25

1	
17	Total Sheets