

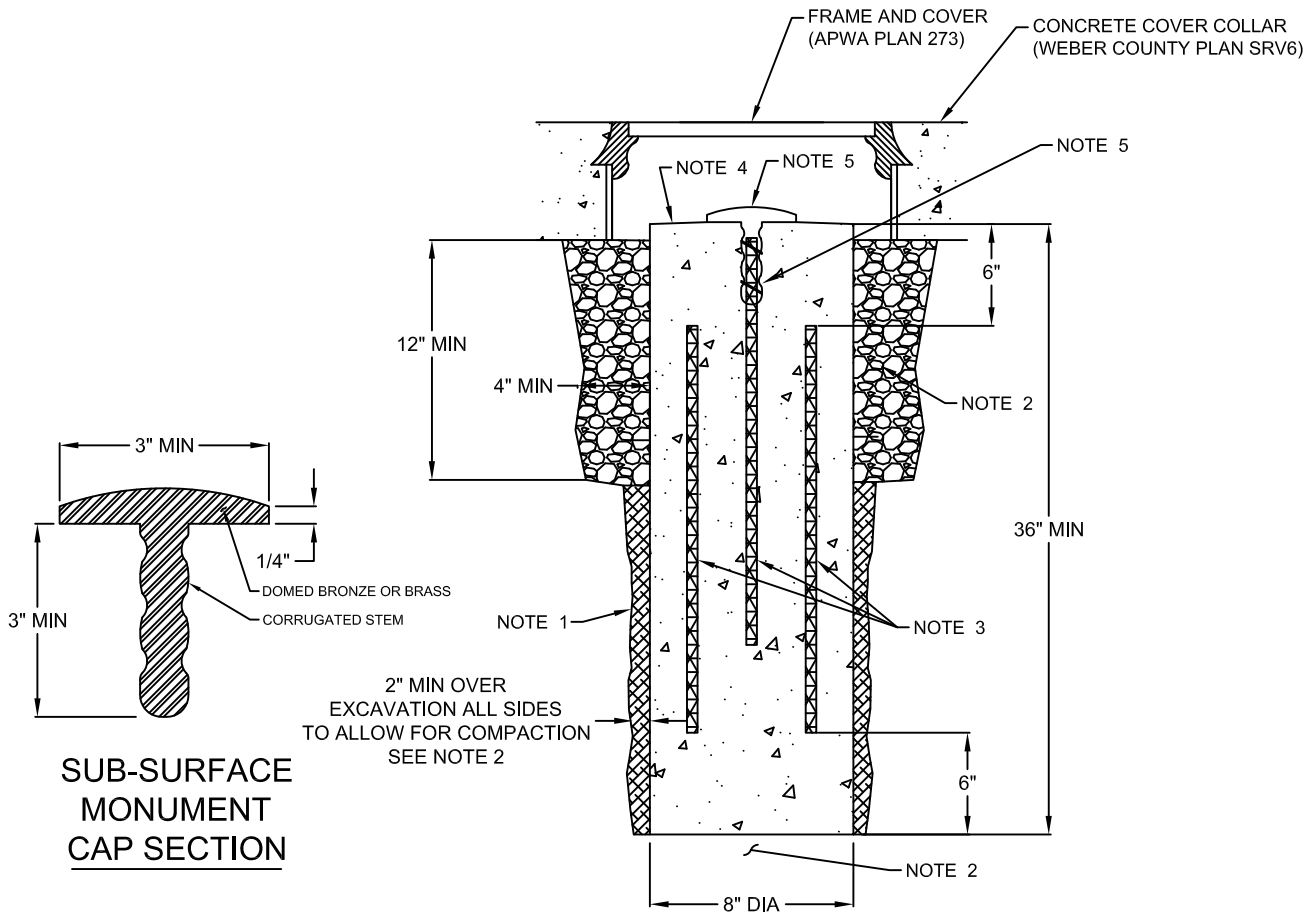

## Weber County Surveyor Monument Inspection Sheet

Subdivision:			
Monument #:			
Address:			
<input type="checkbox"/>	First Inspection	Date:	<input type="checkbox"/> Notice of Compliance
		Crew:	
<input type="checkbox"/>	Second Inspection	Date:	<input type="checkbox"/> Notice of Compliance
		Crew:	
		Date:	

Sub Surface Monument (Detail Sheet SRV5)			
Monument:	Accept	Deny	Action/ Comments
Monument Cap 6" below the surface of the road.	<input type="checkbox"/>	<input type="checkbox"/>	
1" of free draining material (1/4" to 3/8" size material) surrounding monument sufficiently compacted.	<input type="checkbox"/>	<input type="checkbox"/>	
Cap securely attached, oriented correctly, clean surface, no spaces between concrete and cap under or around cap.	<input type="checkbox"/>	<input type="checkbox"/>	
8" (min) diameter concrete column.	<input type="checkbox"/>	<input type="checkbox"/>	
Concrete domed or sloped to prevent water accumulation around cap with a smooth finish.	<input type="checkbox"/>	<input type="checkbox"/>	
Monument Collar (Detail sheet SRV6)			
24" (min) diameter concrete collar. (7" wide out from Frame)	<input type="checkbox"/>	<input type="checkbox"/>	
Magnetic reading indicating steel hoop centered in concrete collar. Or fiber mesh in concrete.	<input type="checkbox"/>	<input type="checkbox"/>	
Concrete collar minimum of 10" thick.	<input type="checkbox"/>	<input type="checkbox"/>	
Joint neat and vertical between concrete collar and existing road surface, clean of dirt, oil and loose debris.	<input type="checkbox"/>	<input type="checkbox"/>	
Broom finish on concrete collar.	<input type="checkbox"/>	<input type="checkbox"/>	
Concrete collar 1/4" to 1/2" below surrounding pavement.	<input type="checkbox"/>	<input type="checkbox"/>	
"Weber County Permit Required" frame and cover.	<input type="checkbox"/>	<input type="checkbox"/>	
Concrete collar finished flush with frame.	<input type="checkbox"/>	<input type="checkbox"/>	
Frame and cover centered over monument	<input type="checkbox"/>	<input type="checkbox"/>	
Frame, Cover, and collar independently constructed of monument	<input type="checkbox"/>	<input type="checkbox"/>	
Monument Cap (Detail Sheet SRV8)			
Clearly Stamped: Surveyor's PLS #	<input type="checkbox"/>	<input type="checkbox"/>	
Clearly Stamped: Date	<input type="checkbox"/>	<input type="checkbox"/>	
Clearly Stamped: monument or station number	<input type="checkbox"/>	<input type="checkbox"/>	
Punched within 0.04" (approx 1/2") of the center of the cap.	<input type="checkbox"/>	<input type="checkbox"/>	
3" cap made of brass or bronze	<input type="checkbox"/>	<input type="checkbox"/>	
Required text along outer edges.	<input type="checkbox"/>	<input type="checkbox"/>	



1. **EXCAVATION:** Call Blue Stakes before excavating and installing monument. Install monument only after cleared by all Blue Stakes. Over excavate the first 12" of the monument hole beneath collar to a diameter of 16" min (or 4" wider than the diameter of the monument) for the installation of free draining material to drain water out of the monument box. All over excavation of the bottom 22" of the monument hole must be compacted per governing entity's standards and specifications.
2. **BACKFILL:** Tamp and compact bottom of excavated hole to ensure solid base before placement of monument. Compact over excavation on bottom 22" of monument with untreated base course with hand held equipment per APWA Section 32 05 10 and per governing entity's standards and specifications. Tamp and compact  $\frac{1}{4}$ " min to  $\frac{3}{4}$ " max uniform free draining material into the void of the over excavation of the first 12" of the monument below the collar with hand held equipment per APWA Section 32 05 10.
3. **REINFORCEMENT:** #5 ( $\frac{5}{8}$ " diameter) galvanized or epoxy coated, deformed, 60 ksi yield grade steel, ASTM A 615.
4. **CONCRETE:** Finish concrete with a dome or slope to prevent water collection and puddling around the cap. Class 4000 per APWA Section 03 30 04.
5. **CAP:** Attach Weber County Survey domed cap to steel rebar with wire, clamp, or other approved device. Monument cap shall be centered in the monument base. Install cap in monument base before concrete sets. The center of the cap shall not exceed 0.04' (Approx.  $\frac{1}{2}$ " ), in any direction, of the actual position of the monument.

\* Per UCA 17-23-14(3)(c)(iv)(B) the Weber County Surveyor's Office will provide one monument cap per monument encroachment permit. One monument cap will also be provided, per monument location, to developers as a part of any monument improvement agreement. Monument caps needed for any other circumstance are available for purchase from the County Surveyor's Office at cost plus a convenience fee. Contact the Surveyor's Office for availability and pricing. Equivalent products shall be approved by the County Surveyor prior to construction.

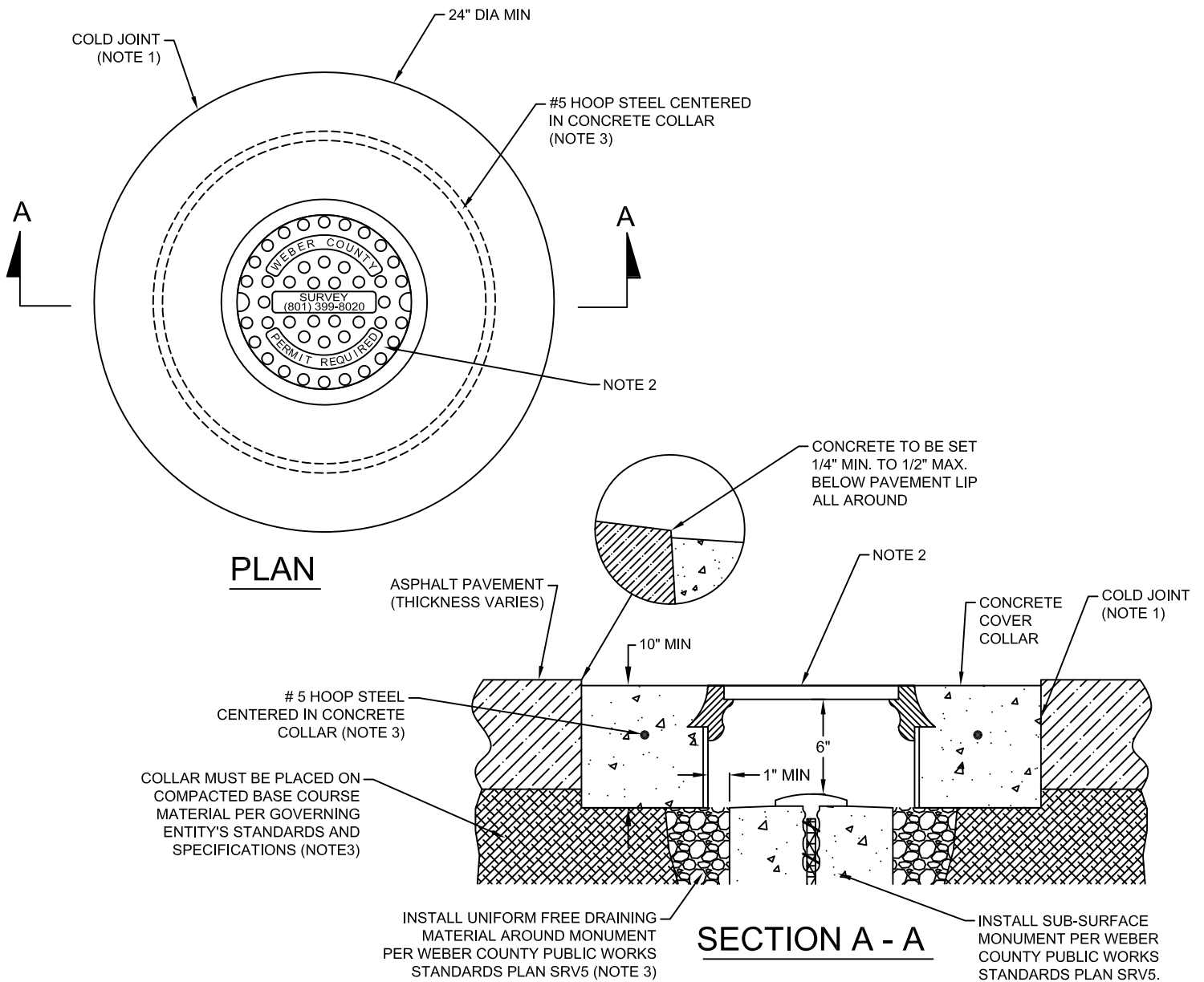

1. JOINT: Provide a neat vertical and concentric circle cut joint between concrete and existing asphalt surface. Clean edges of all dirt, oil, and loose debris. Concrete to be set  $\frac{1}{4}$ " minimum to  $\frac{1}{2}$ " maximum below pavement lip all around joint.
2. FRAME AND COVER: Install Weber County Survey traffic rated frame and cover, per Weber County Public Works Standards Plan SRV7, on top of a 12" IDA SONO Tube or PVC Pipe cut to the appropriate size to ensure top of frame and cover will be level with concrete collar. Frame and cover to be centered over and shall be separate and independent from the sub-surface monument.\*
3. BACKFILL: Collar shall be placed on compact untreated base course per governing entity's standards and specifications, and compacted  $\frac{1}{4}$ " min to  $\frac{3}{4}$ " max uniform free draining material per Weber County Publics Works Standards Plan SRV5.
3. REINFORCEMENT: Install #5 ( $\frac{5}{8}$ " diameter) galvanized or epoxy coated hoop, deformed, 60 ksi yield grade steel, ASTM A 615.
4. CONCRETE PLACEMENT: APWA Section 03 30 10. Fill annular space around frame and cover with class 4000 concrete per APWA Section 03 30 04. A fiber mesh additive per ASTM 1116 may be added to the concrete mix instead of the hoop of steel. Apply a broom finish. Apply a curing agent.
4. CURING AGENT: Clear membrane forming compound with fugitive dye (Type ID Class A), APWA Section 03 39 00.

\* Per UCA 17-23-14(3)(iv)(B) the Weber County Surveyor's Office will provide one frame and cover per monument encroachment permit. One frame and cover will also be provided, per monument location, to developers as a part of any monument improvement agreement. Frame and covers needed for any other circumstance are available for purchase from the County Surveyor's Office at cost plus a convenience fee. Contact the Surveyor's Office for availability and pricing. Equivalent products shall be approved by the County Surveyor prior to construction.

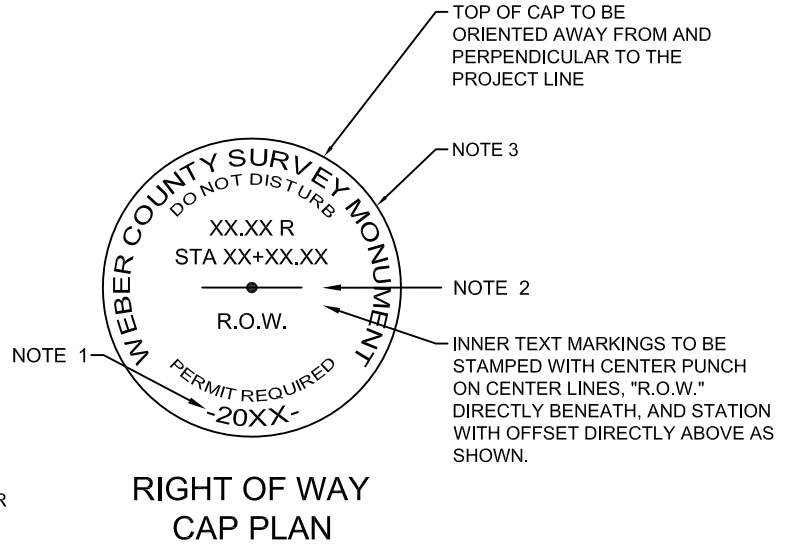
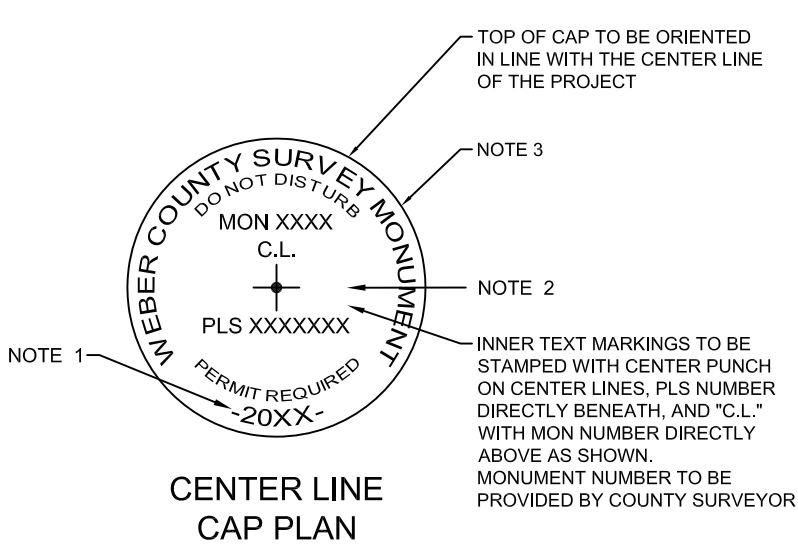
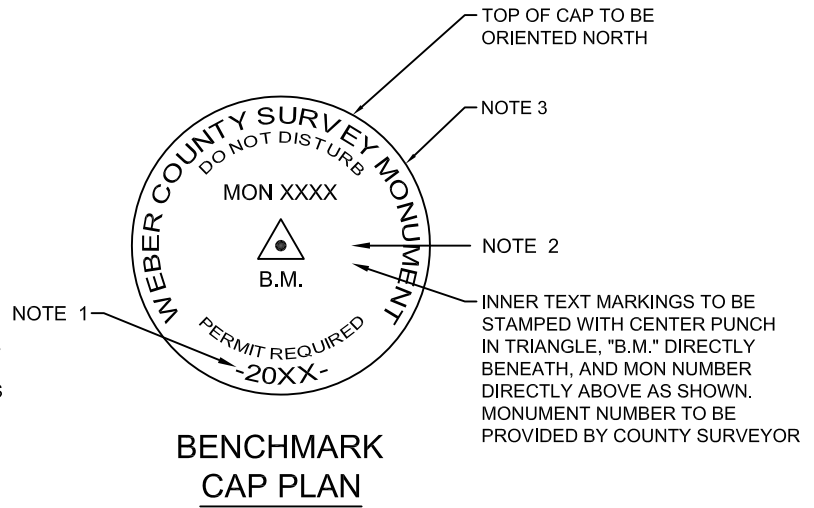
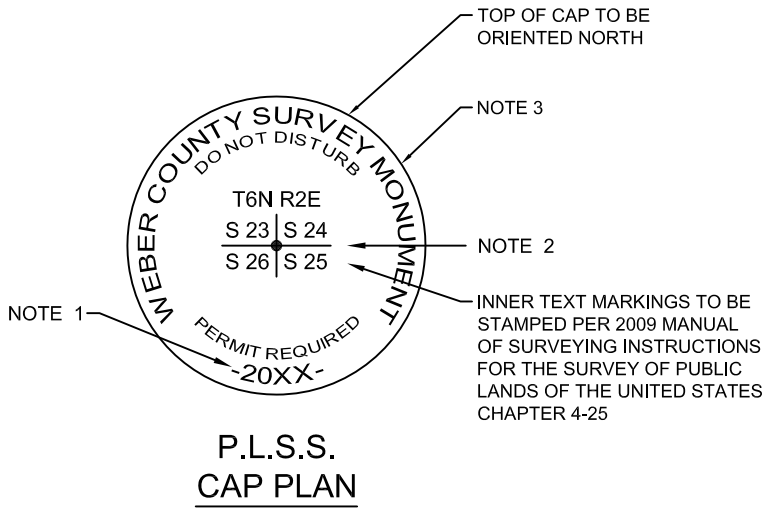

1. DATE: Stamp the full year of the date when the monument was constructed.
2. SYMBOL AND CENTER PUNCH: Apply a center punch at the actual surveyed position for the monument. Center punch of the surveyed position shall be within 0.04' (Approx. 1/2") of the center of the cap.
3. OUTER TEXT: Caps shall be brass or bronze. Text along outer edges of cap shall be pre-stamped.