

The Summit at Ski Lake No. 13 1st Amendment

Amending Lots 50-R & 51-R
A part of the North Half of Section 24,
T6N, R1E, SLB & M., U.S. Survey
Weber County, Utah
February 2024

SURVEYOR'S CERTIFICATE

I, Andy Hubbard, do hereby certify that I am a Professional Land Surveyor in the State of Utah, and that I hold License No. 6242920 in accordance with Title 58, Chapter 22, of the Professional Engineers and Professional Land Surveyors Licensing Act. I also certify that I have completed a survey of the property described hereon in accordance with Section 17-23-17 and that I have verified all measurements shown hereon this plat of The Summit at Ski Lake No. 13 Amendment No. 1, in Weber County, Utah and that it has been correctly drawn to the designated scale and is a true and correct representation of the following description of lands included in said subdivision, based on data compiled from records in the Weber County Recorder's Office. Monuments have been found or placed as represented on this plat. I furthermore certify that all lots within this Subdivision hereby meet all current lot width and area requirements of the Weber County Zoning Ordinance.

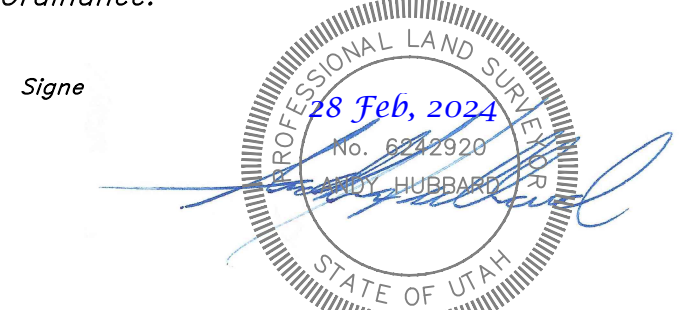

OWNER'S DEDICATION

We, the undersigned owners of the hereon described tract of land, hereby set apart and subdivide the same into lots as shown on this plat, and name said tract West View Subdivision, and hereby dedicate grant and convey to West Jordan City, Salt Lake County, Utah all those parts or portions of said tract of land designated as public utility and drainage easements as shown hereon, the same to be used for the installation, maintenance and operation of public utility service lines and drainage, as may be authorized by West Jordan City.

Signed this _____ day of _____, 2024.

Owner

BOUNDARY DESCRIPTION

All of lots 50-R and 51-R, Summit at Ski Lake No. 13, as recorded with the Weber County Recorder's Office more particularly described as"

Beginning at a point on the Northeast corner of Lot 52-R, Summit at Ski Lake No. 13, Said point being 2218.94 feet South 0°26'51" West along the Section line and 55.95 feet North 89°33'09" West from the North Quarter Corner of Section 24, T6N, R1E, SLB&M, U.S. Survey, thence along the South boundary of Summit at Ski Lake No. 4, South 69°23'59" East 276.24 feet, thence South 69°23'59" East 159.24 feet to the boundary of Subdivision "Summit at Ski Lake No. 11", thence along said boundary, South 2°29'07" West 208.80 feet to the Private Right of Way Clairatina Court; thence along said right of way North 85°45'09" West 44.74 feet; thence following 3 courses to the East boundary of lot 52-R: (1) a curve to the right 205.74 feet (chord bears North 77°12'44" West with a length of 204.10); (2) a curve to the right with a radius of 470.00 (Chord bears North 57°24'35" West with a length of 118.82 feet); (3) a curve to the left with a radius of 360.00 feet (chord bears North 60°52'11" West 133.95 feet); thence along the east boundary of lot 52-R North 18°24'31" East 197.34 feet to the Point of Beginning.

The Summit at
Ski Lake
No. 11
42R

ACKNOWLEDGMENT

State of Utah } ss
County of Weber }

The foregoing instrument was acknowledged before me this _____ day of _____, 2024 by _____.

Residing At: _____
Commission Number: _____
Commission Expires: _____

A Notary Public commissioned in Utah

Print Name

For Review
02/28/2024 4:59:44 PM

SURVEYOR:
Great Basin Engineering, Inc.
c/o Andy Hubbard, PLS
5746 South 1475 East Suite 200
Ogden, Utah 84405
(801) 394-4515

Northwest corner of Section 24,
T6N, R1E, SLB&M, U.S. Survey,
(Found Weber County 3 1/2" Brass
Cap Monument, Good Condition, 15"
below ground dated 2006)

S 89°36'57" E
2660.93' measured
(Basis of Bearing)
(2660.82' W.C.S.)
(S 89°36'46" E W.C.S.)

North 1/4 corner of Section 24,
T6N, R1E, SLB&M, U.S. Survey
(Found Weber County Brass Cap -
(1991) Good Condition. (at road surface)

Point of Beginning
S 89°33'09" E 55.95'

S 69°23'59" E
276.24'

20R

22R

The Summit at
Ski Lake No. 4

52-R

55
2.397 Acres

Δ = 21°26'37"
L = 134.73'
R = 360.00'
LC = 133.95'
N 60°52'11" W

Δ = 14°31'25"
L = 119.14'
R = 470.00'
LC = 118.82'
N 57°24'35" W

Δ = 25°04'51"
L = 205.74'
R = 470.00'
LC = 204.10'
N 77°12'44" W

Clairetina
Court

Utility Lot 2

Center of Section 24
T6N, R1E, SLB&M, U.S. Survey
(Found Weber County Monument
Dated 2005, Good Condition)

WEBER COUNTY COMMISSION ACCEPTANCE

This is to certify that this subdivision plat, the dedication of streets and other public ways and financial guarantee of public improvements associated with this subdivision, thereon are hereby approved and accepted by the Commissioners of Weber County, Utah. Signed this _____ day of _____, 2024.

Chairman, Weber County Commission

WEBER COUNTY ENGINEER

I hereby certify that the required public improvement standards and drawings for this subdivision conform with County standards and the amount of the financial guarantee is sufficient for the installation of these improvements. Signed this _____ of _____, 2024.

Weber County Engineer

WEBER COUNTY ATTORNEY

I have examined the financial guarantee and other documents associated with this subdivision plat, and in my opinion they conform with the County Ordinance applicable thereto and now in force and effect. Signed this _____ day of _____, 2024.

Weber County Attorney

WEBER COUNTY SURVEYOR

I hereby certify that the Weber County Surveyor's Office has reviewed this plat and all conditions for approval by this office have been satisfied. The approval of this plat by the Weber County Surveyor does not relieve the Licensed Land Surveyor who executed this plat from the responsibilities and/or liabilities associated therewith.

Signed this _____ day of _____, 2024

Weber County Surveyor
Record of Survey #
WCO 106-1-8(c)(1)h.10; WCO 45-4-2(c)

WEBER COUNTY PLANNING COMMISSION APPROVAL

This is to certify that this subdivision plat was duly approved by the Weber County Planning Commission. Signed this _____ day of _____, 2024.

Chairman, Weber County Planning Commission

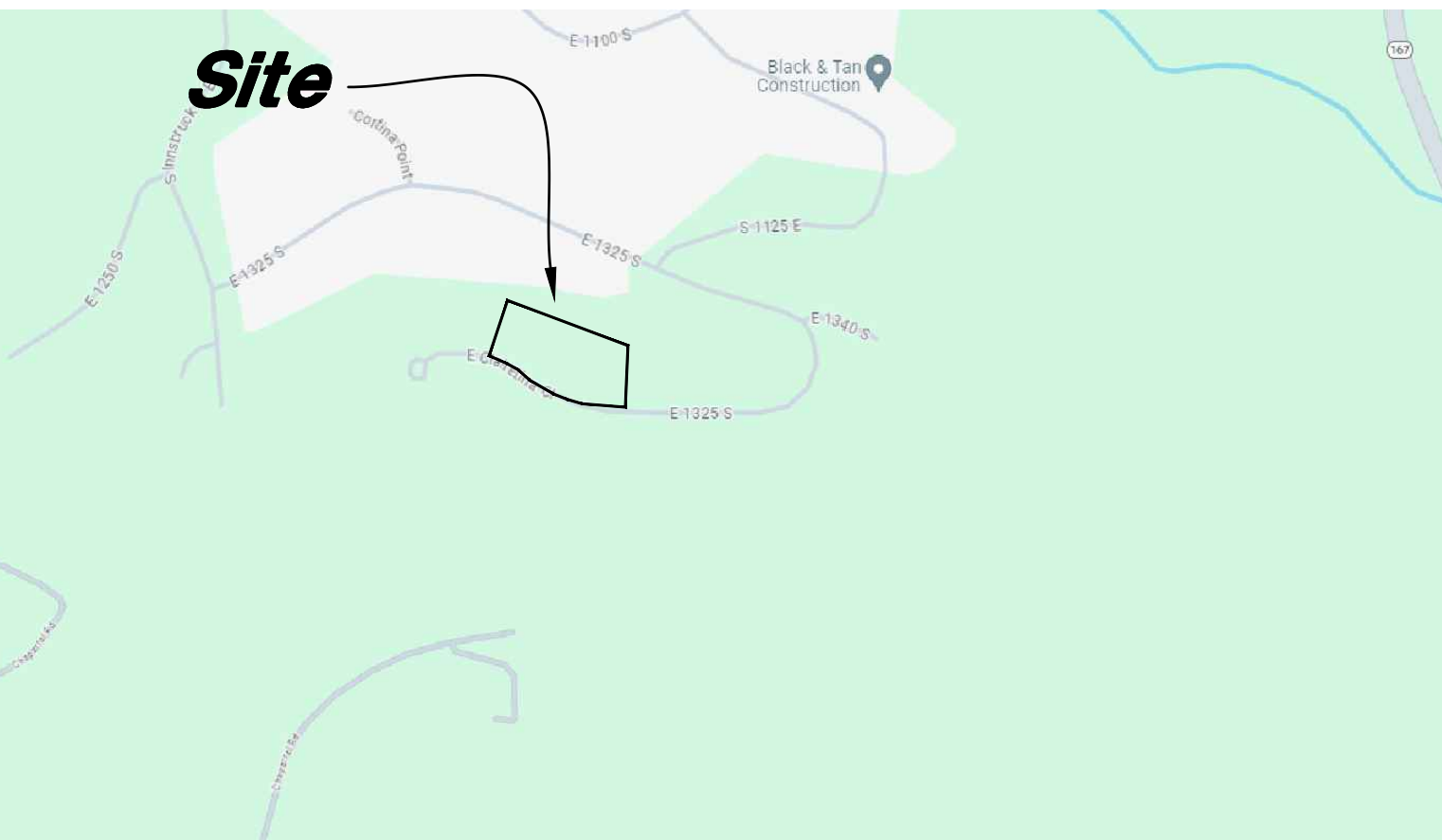

Vicinity Map
(Not to Scale)

LEGEND

Found Section Monument

P.U.E.
(Rec.)
(Meas.)
Centerline Road
Existing Parcel Line
Survey Monument Line
Existing Fence Line
Lot Line
Boundary Line
Set Back Lines
Easement
Set 5/8" x 24" Long
Rebar & Cap w/ Lathe
Street Monument

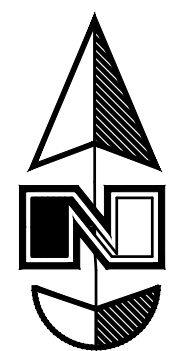

Scale: 1" = 30'

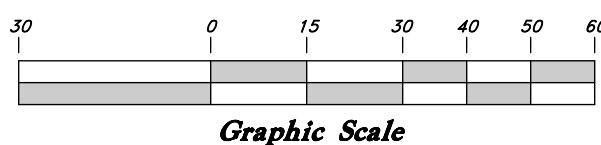

Graphic Scale

GREAT BASIN ENGINEERING
5746 SOUTH 1475 EAST OGDEN, UTAH 84403
MAIN (801) 394-4515 S.L.G (801) 521-0222 FAX (801) 392-7544
WWW.GREATBASINENGINEERING.COM