

ARCHITECTURAL NARRATIVE:

WASHINGTON HEIGHTS CHURCH WOULD LIKE TO ADD A FORMAL SANCTUARY AUDITORIUM TO THEIR EXISTING CAMPUS. THE 30,000SF ADDITION WILL INCLUDE AN INITIAL SEATING CAPACITY OF 1,500 IN FIXED SEATS ON THE MAIN LEVEL. A LATER PHASE WILL ADD AN ADDITIONAL 500 FIXED SEATS IN A BALCONY. AN EXPANDED FOYER / CIRCULATION SPACE ALONG WITH RESTROOM FACILITIES WILL BE ADDED TO BETTER FACILITATE CIRCULATION AND EXITING. CURRENT PARKING ACCOMMODATES NEARLY 650 PARKING STALLS. THE PROPOSAL IS TO REPLACE THE AFFECTED STALLS AND RETAIN A SIMILAR PARKING COUNT. A LOOP DRIVE IS ALSO PROPOSED FOR EXPEDITE BETTER SITE CIRCULATION. THE BUILDING WILL HAVE SLOPED FLOORS ALLOWING US TO RECESS THE BUILDING DEEPER INTO THE EXISTING SITE GRADING AND MAINTAIN APPROPRIATE ARCHITECTURAL MASSING AND CONNECTION TO THE EXISTING CAMPUS ROOFLINES.

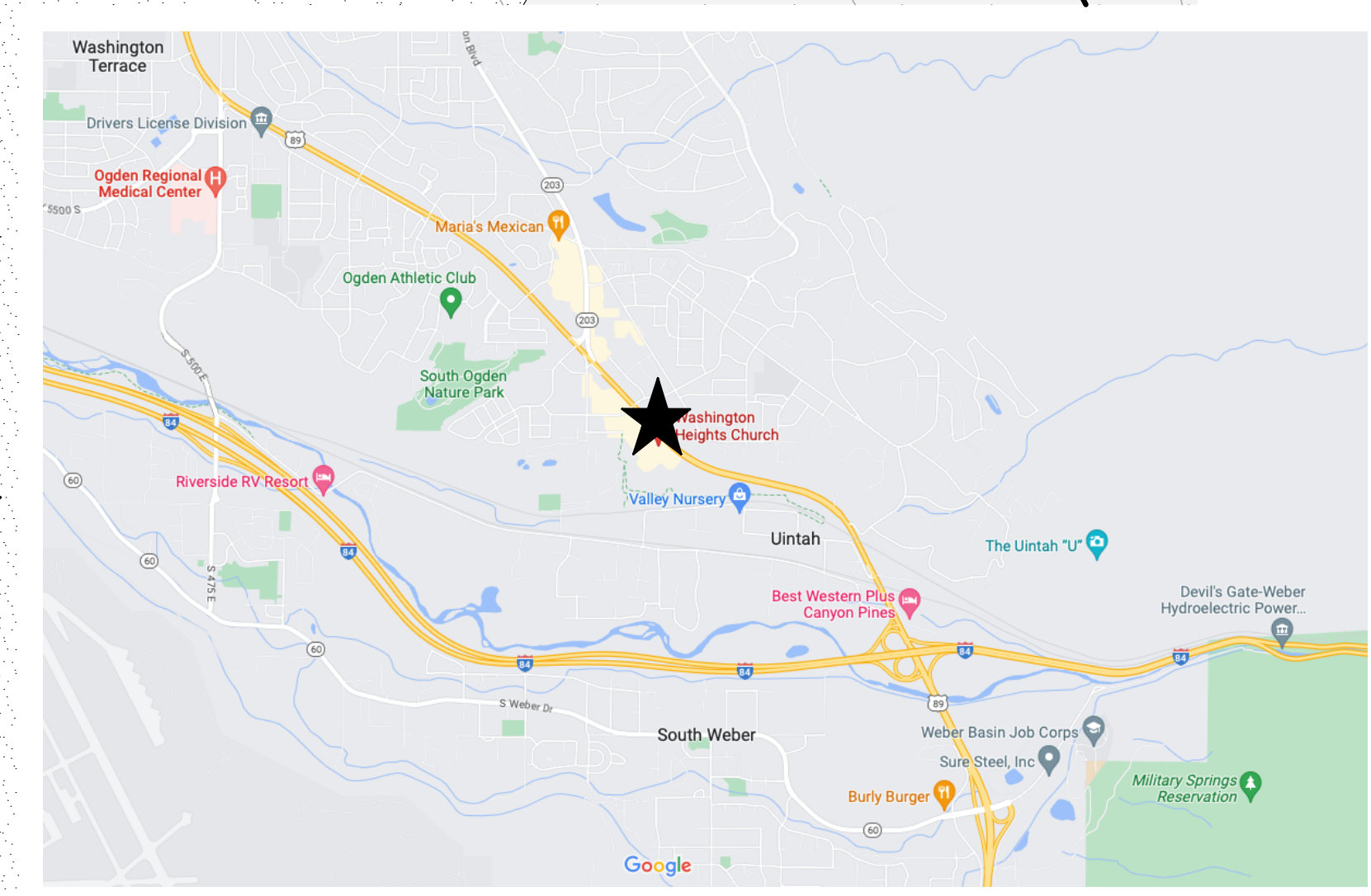

1 ARCHITECTURAL SITE PLAN
SCALE: 1" = 40'

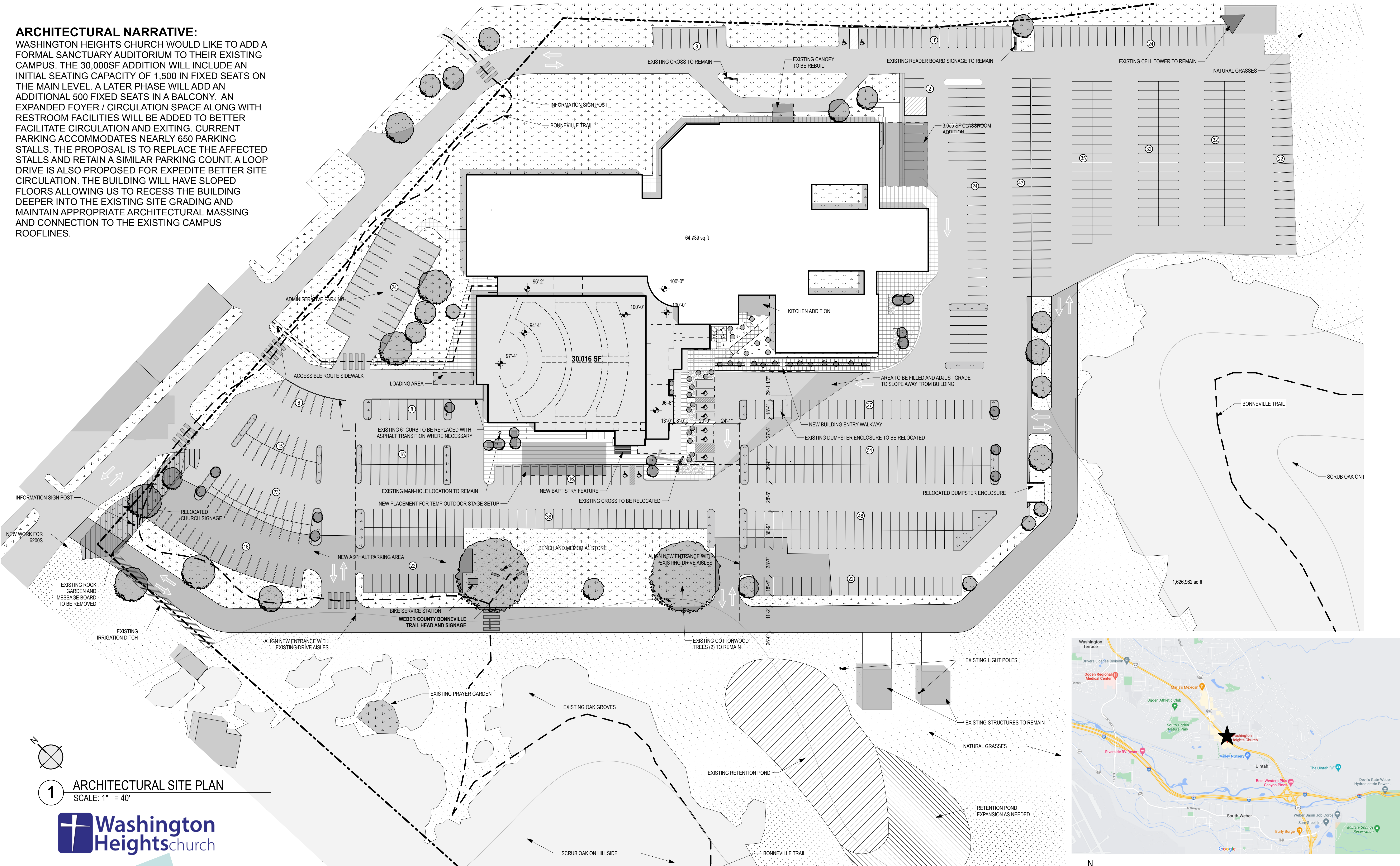

WHC
NEW SANCTUARY

ARCHITECTURAL SITE PLAN
1770 E 6200 S OGDEN, UT. 84405 (801.479.7030)

VICINITY PLAN

DATE: 8/18/23