



Land Use Permit

Weber County Planning Commission

2380 Washington Blvd. STE 240

Ogden, UT 84401

Phone: (801) 399-8791 FAX: (801) 399-8862

webercountyutah.gov/planning

Permit Number: LUP236-2023

Permit Type: Structure

Permit Date: 08/16/2023

Applicant

Name: Jamila McFarland

Business:

Address:

West Weber, UT

Phone: 801-814-6494

Owner

Name: Layne McFarland

Business:

Address: 5202 W 1150 S

Ogden, UT 84404

Phone: 801-458-1255

Parcel

Parcel: 150520046

Zoning: A-2 **Area:** 10.47 **Sq Ft:**

Address: 5210 W 1150 S OGDEN, UT 84401

Lot(s):

Subdivision:

T - R - S - QS: 6N - 2W - 19 -

Proposal

Proposed Structure: Service Sign

Proposed Structure Height: 3

of Dwelling Units: 1

Off Street Parking Reqd:

Building Footprint: 6

Max Structure Height in Zone: 3

of Accessory Bldgs: 2

***Is Structure > 1,000 Sq. Ft?** No

*If True Need Certif. Statement

Permit Checklist

Access Type: public

Greater than 4218 ft above sea level? Yes

Additional Setback Reqd. ? No

> 200 ft from paved Road? No

Culinary Water District:

Alternative Access File #

Wetlands/Flood Zone? No

Meet Zone Area Frontage? Yes

Hillside Review Reqd? No

Waste Water System:

Comments

This service sign must be placed within private property and may not be within the public right-of-way or within the area prescribed as the public right-of-way of 1150 South. Care should also be taken when placing the sign to ensure that the sign is not within the clear-view triangle of the intersection and that it will not exceed 3' in height. 108-7-7.030 The clear view site triangle is established by measuring from the corner of the intersection ten feet on both sides.

Land Use Permit

Structure Setback Graphic: Storage Shed, Detached Garage, Etc.

****See additional notes in the comments section****

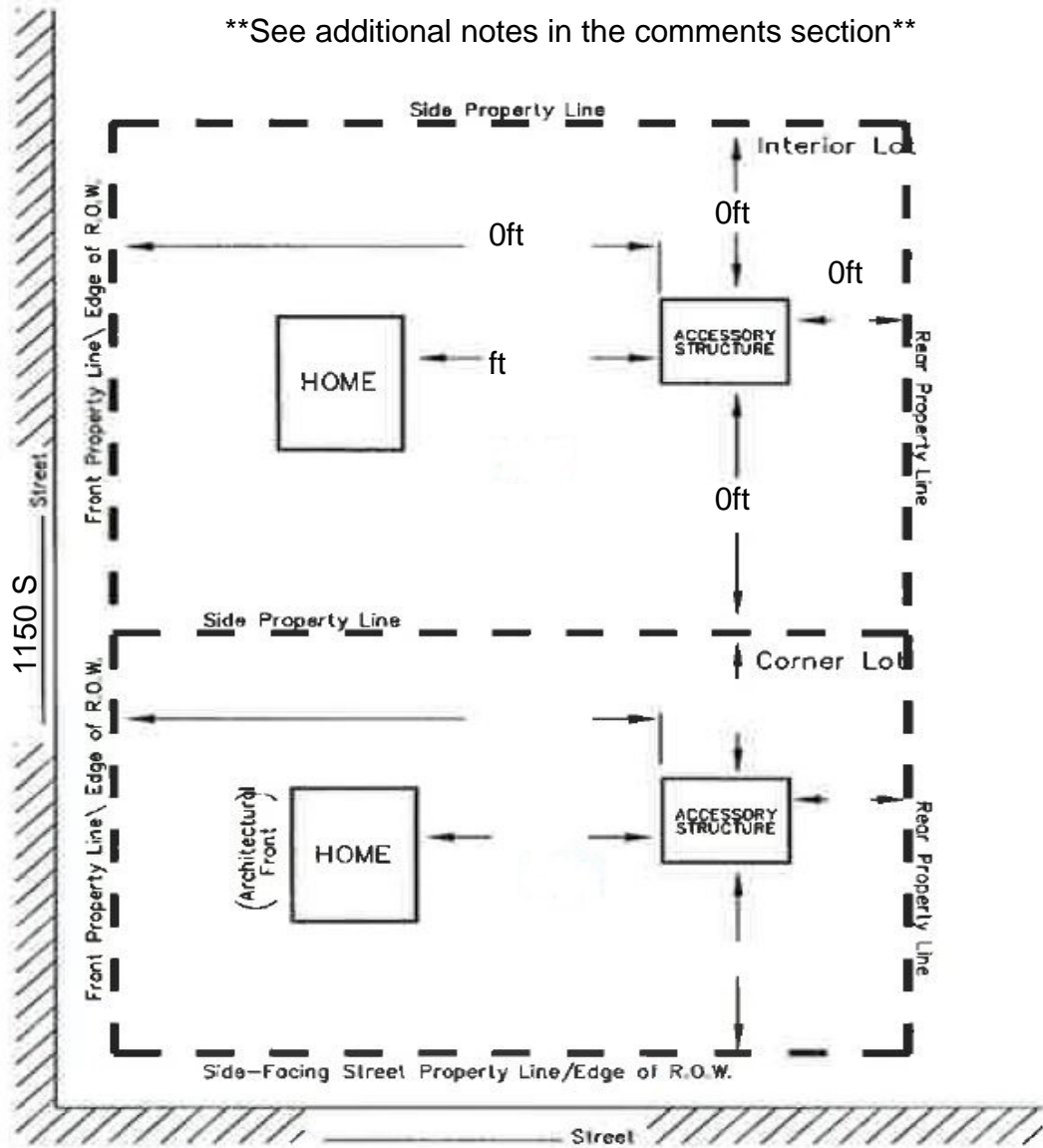

MINIMUM YARD SETBACKS Storage Shed, Detached Garage, Etc.

NOTICE FOR APPLICANT (Please Read Before Signing)

Proposals for the installation of an individual water supply and for a sanitary waste disposal system (septic tank) for any structure designed for human occupation must be approved by Weber County Health Department prior to installation.

Felix Lleverino

08/16/2023

Planning Dept. Signature of Approval

Date

I hereby certify that I have read and examined this application and know the same to be true and correct. All provisions of laws and ordinances governing this land use will be complied with whether specified herein or not. I make this statement under penalty of perjury.

Contractor/Owner Signature of Approval

Date