

Legend
(Note: All items may not appear on drawing)

- San. Sewer Manhole (Symbol)
- Water Manhole (Symbol)
- Storm Drain Manhole (Symbol)
- Electrical Manhole (Symbol)
- Catch Basins (Symbol)
- Sanitary Sewer (Symbol)
- Culinary Water (Symbol)
- Storm Drain (Symbol)
- Finish Contour (Symbol)
- Exist. Contour (Symbol)
- Finish Grade (Symbol)
- Exist. Grade (Symbol)
- Set Nail & Washer (Symbol)
- Set Rebar & Cap w/ Fencepost (Symbol)
- Set Hub & Tack (Symbol)
- Monument to be set (Symbol)
- Radial Line (Symbol)
- Non-Radial Line (Symbol)

$\Delta = 32^{\circ}37'08''$
 $R = 196.70'$
 $L = 111.98'$
 $LC = 110.48'$
 $N 55^{\circ}02'41'' W$

$\Delta = 71^{\circ}22'42''$
 $R = 50.00'$
 $L = 62.29'$
 $LC = 29.64'$
 $N 29^{\circ}19'29'' E$

$\Delta = 34^{\circ}22'17''$
 $R = 50.00'$
 $L = 29.99'$
 $LC = 29.64'$
 $N 29^{\circ}19'29'' E$

$\Delta = 28^{\circ}20'28''$
 $R = 50.00'$
 $L = 24.73'$
 $LC = 24.57'$
 $N 69^{\circ}17'56'' E$

$\Delta = 30^{\circ}44'42''$
 $R = 333.70'$
 $L = 179.06'$
 $LC = 176.92'$
 $S 84^{\circ}59'09'' E$

$\Delta = 59^{\circ}17'42'' E$
 $L = 58.40'$
 $LC = 27.26'$
 $N 59^{\circ}17'42'' E$

$\Delta = 29^{\circ}31'33''$
 $R = 336.64'$
 $L = 173.48'$
 $LC = 171.57'$
 $S 50^{\circ}32'37'' W$

Curve Data Table

Curve #	Delta	Radius	Length	Chord Direction	Chord Length
C1	27°51'53"	196.70'	95.66'	N 57°25'19" W	94.72'
C2	4°45'15"	196.70'	16.32'	N 41°06'45" W	16.32'

- Notes:**
- Due to the topography and the location of this subdivision all owners will accept responsibility for any storm water runoff from the road adjacent to this property until curb and gutter is installed.
 - The Site Triangles shall provide unobstructed cross-visibility of a level between two and eight feet in height. Trees may be planted inside the triangular areas, but shall be trimmed such that no limbs or foliage extend into the cross-visibility zone, and placed so as not to create a traffic hazard. Plant materials, excepting turf grass, shall not be located closer than three feet from the edge of any access way pavement. No other obstruction to view in excess of three feet in height shall be allowed.

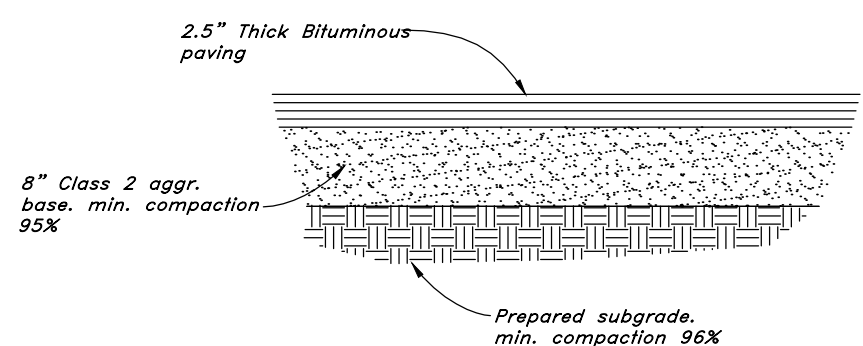
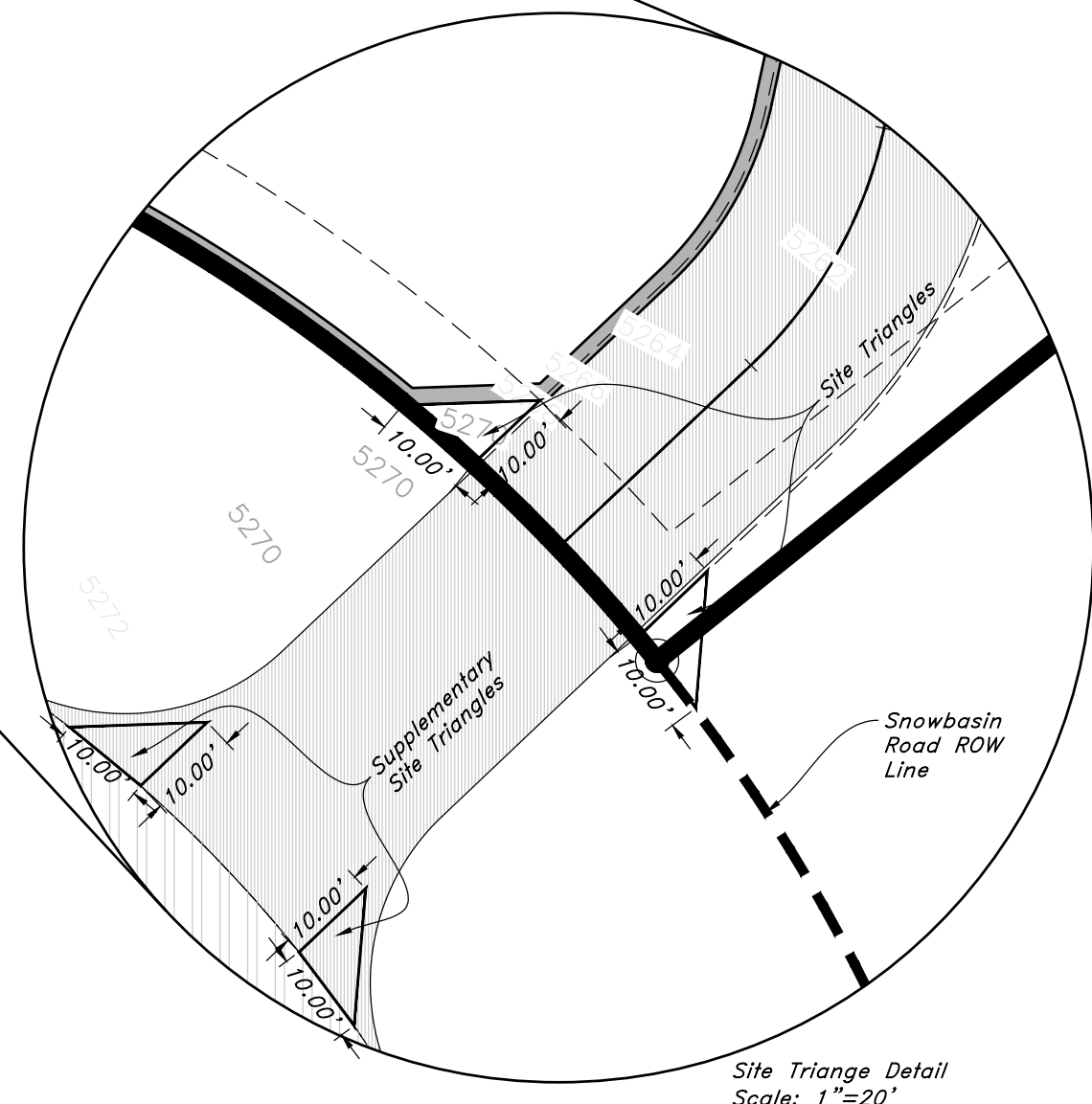

1 Typical Bituminous Pavement Section

Not to Scale

GREAT BASIN ENGINEERING
 5746 SOUTH 1475 EAST, OGDEN, UTAH 84403
 MAIN (801) 515-5115, SLLC (801) 521-0222, FAX (801) 592-7504
 WWW.GREATBASINENGINEERING.COM

Preliminary Plat
Samarel Subdivision
 A part of the East 1/2 of Section 23 & the Northwest 1/4 of Section 44, Township 6 North, Range 1 East, all Lake Base & Meridian, U.S. Survey, Huntsville, Weber County, Utah

8 MAR 2023
 SHEET NO.
P1
 20N24