



# Land Use Permit

## Weber County Planning Commission

2380 Washington Blvd. STE 240  
Ogden, UT 84401  
Phone: (801) 399-8791 FAX: (801) 399-8862  
webercountyutah.gov/planning

**Permit Number: LUP89-2023**

Permit Type: Structure  
Permit Date: 05/24/2023

### Applicant

**Name:** Kristie Martinelli  
**Business:**  
**Address:** 3465 N Hwy 39  
Huntsville, UT 84317  
**Phone:** 801-698-4362

### Owner

**Name:** Same  
**Business:**  
**Address:** , UT  
**Phone:**

### Parcel

**Parcel:** 230130010  
**Zoning:** F-40 **Area:** 5017.79Sq Ft **Lot(s):** 20 **Subdivision:** Sourdough Rock Creek R  
**Address:** 3465 N HWY 39 HUNTSVILLE, UT 84317 **T - R - S - QS:** 7N - 3E - 08 -

### Proposal

**Proposed Structure:** Canopy **Building Footprint:** 300  
**Proposed Structure Height:** 18 **Max Structure Height in Zone:** 25  
**# of Dwelling Units:** **# of Accessory Bldgs:**  
**# Off Street Parking Req'd:** **\*Is Structure > 1,000 Sq. Ft?** N/A  
**\*If True Need Certif. Statement**

### Permit Checklist

**Access Type:** Private **Alternative Access File #**  
**Greater than 4218 ft above sea level?** Yes **Wetlands/Flood Zone?** No  
**Additional Setback Req'd. ?** No **Meet Zone Area Frontage?** Yes  
**> 200 ft from paved Road?** No **Hillside Review Req'd?** No  
**Culinary Water District:** **Waste Water System:**

### Comments

The plans for a RV canopy display compliance with applicable land use requirements. The location of the structure is approved by the Sourdough HOA. Minimum yard setbacks are not applicable because the structure will be within the Sourdough Wilderness area.

# Land Use Permit

## Structure Setback Graphic: Storage Shed, Detached Garage, Etc.

**\*\*See additional notes in the comments section\*\***

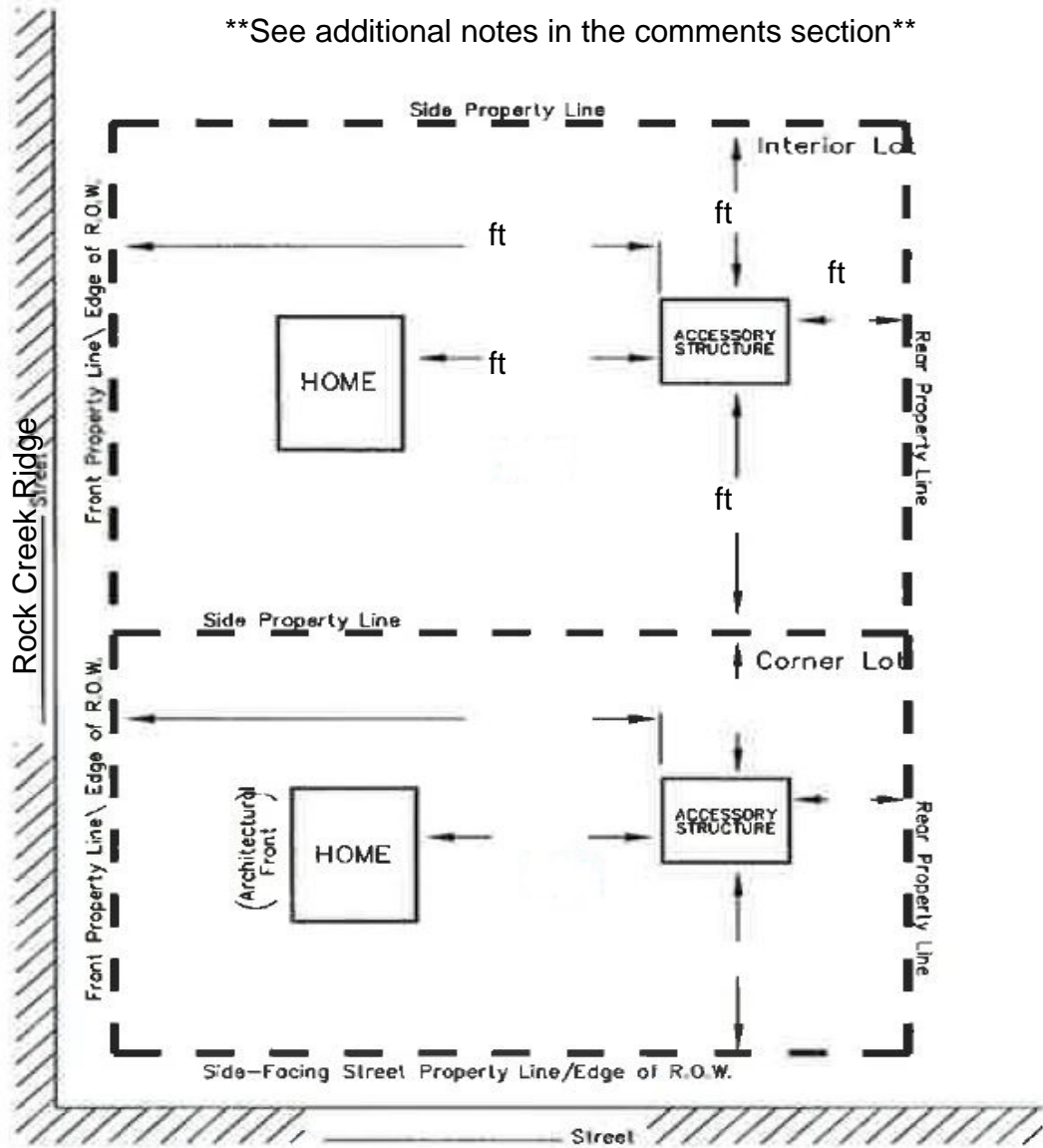

## MINIMUM YARD SETBACKS Storage Shed, Detached Garage, Etc.

### NOTICE FOR APPLICANT (Please Read Before Signing)

Proposals for the installation of an individual water supply and for a sanitary waste disposal system (septic tank) for any structure designed for human occupation must be approved by Weber County Health Department prior to installation.

**Marta Borchert**

**05/24/2023**

\_\_\_\_\_  
Planning Dept. Signature of Approval

\_\_\_\_\_  
Date

I hereby certify that I have read and examined this application and know the same to be true and correct. All provisions of laws and ordinances governing this land use will be complied with whether specified herein or not. I make this statement under penalty of perjury.

\_\_\_\_\_  
Contractor/Owner Signature of Approval

\_\_\_\_\_  
Date