

GEOTECHNICAL NOTES:
 1. AGEC REPRESENTATIVE SHOULD OBSERVE THE SITE GRADING OPERATIONS.
 2. CONTRACTOR IS TO REFER TO "GEOTECHNICAL INVESTIGATION PROPOSED CRIMSON RIDGE- PHASE 2 & 3 5129 EAST WHISPERING PINES LANE EDEN, UTAH" DATED SEPTEMBER 15, 2020 PREPARED BY AGEC.
 3. CONTRACTOR IS TO REFER TO "GEOLOGIC HAZARDS EVALUATION PROPOSED CRIMSON RIDGE PHASE 2 SUBDIVISION ABOUT 1100 NORTH MORNINGSIDE LANE EDEN, UTAH" DATED MAY 15, 2020.

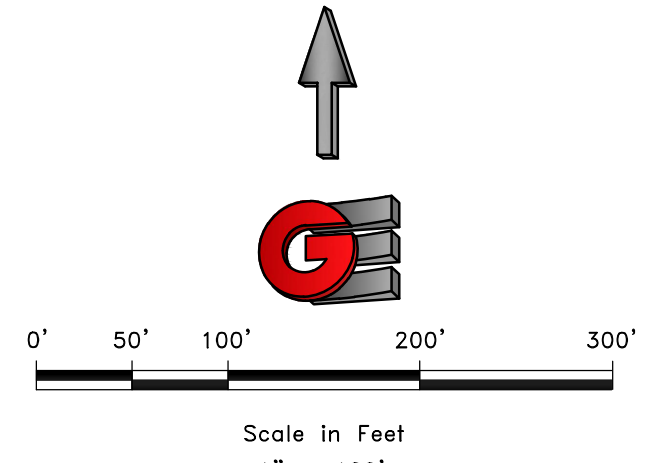
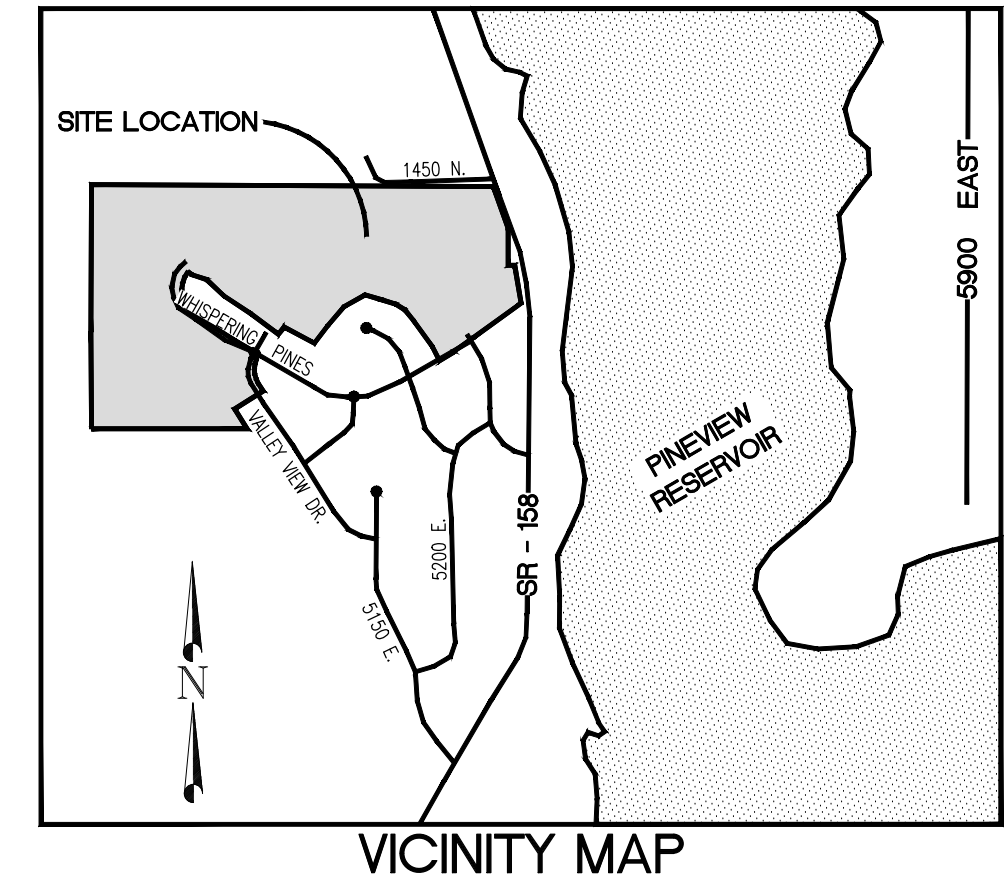

LEGEND

(---)	SUBDIVISION BOUNDARY
(—)	ROAD CENTERLINE
(- - -)	EXISTING EDGE OF ASPHALT
(- - -)	EXISTING 1' CONTOUR
(- - -)	EXISTING 5' CONTOUR
(- - -)	FINISH GRADE 1" CONTOUR
(---)	EXISTING SANITARY SEWER
(---)	NEW SANITARY SEWER
(---)	NEW PRESSURE SEWER LATERAL
(---)	EXISTING STORM DRAIN
(---)	NEW STORM DRAIN
(---)	EXISTING CULINARY WATER
(---)	NEW CULINARY WATER
(---)	NEW CULINARY WATER LATERAL
(---)	NEW CULINARY WATER METER
(---)	EXISTING FIRE HYDRANT
(---)	NEW FIRE HYDRANT
(---)	EXISTING SECONDARY WATER
(---)	NEW ASPHALT PAVING

<p>SCALE: 1" = 100'</p> <p>DATE: 3/30/2021</p> <p>DESIGN: WJS</p> <p>DRAWN: WJS</p> <p>CHECKED: TMM</p>	<p>REVISIONS</p> <table border="1" style="width: 100%; border-collapse: collapse;"> <thead> <tr> <th>DATE</th> <th>DESCRIPTION</th> </tr> </thead> <tbody> <tr> <td>2/14/23</td> <td>ENTRYWAY UPDATES</td> </tr> <tr> <td>5/18/23</td> <td>CUL-DE-SAC REV.</td> </tr> </tbody> </table> <p>DWG: R-0208 - BAH INVESTMENT CRIMSON RIDGE DESIGN AND CRIMSON RIDGE - CDS.DWG</p>	DATE	DESCRIPTION	2/14/23	ENTRYWAY UPDATES	5/18/23	CUL-DE-SAC REV.
DATE	DESCRIPTION						
2/14/23	ENTRYWAY UPDATES						
5/18/23	CUL-DE-SAC REV.						
<p>PROFESSIONAL STRUCTURAL ENGINEER</p> <p>3/30/2021</p> <p>No. 4859845</p> <p>TYLER M. NIELSON</p> <p>LICENSED</p> <p>STATE OF UTAH</p>							
<p>OVERALL SHEET LAYOUT</p> <p>THE RESERVE AT CRIMSON RIDGE CLUSTER SUBD. PHASE 2</p> <p>1250 NORTH 5200 EAST</p> <p>EDEN, WEBER COUNTY, UTAH</p>							
<p>GARDNER ENGINEERING</p> <p>CIVIL-LAND PLANNING</p> <p>MUNICIPAL-LAND SURVEYING</p> <p>5150 SOUTH 375 EAST OGDEN, UT</p> <p>OFFICE: 801.476.0202 FAX: 801.476.0066</p>							
<p>C2</p>							