

- 1 PRUNE ALL DEAD AND INJURED WOOD. DO NOT CUT LEADER.
- 2 LOOSELY TIE TO ALLOW FOR TREE MOVEMENT, BUT SECURED FOR HIGH WIND CONDITIONS.
- 3 METAL T-POSTS, 2 PER TREE. REMOVE POSTS & TIES AFTER ONE YEAR.
- 4 CONSTRUCT 4" EARTH BERM SAUCER. FILL WITH 3" BARK/ROCK MULCH. BRUSH AWAY FROM TRUNK. REMOVE SAUCER AFTER ONE YEAR.
- 5 REMOVE BURLAP/PACKAGING MAT. PLANT TREES 2"-3" HIGHER THAN GRADE.
- 6 BACKFILL WITH NATIVE SOIL
- 7 UNDISTURBED SOIL

NOTE: DIG HOLE THREE TIMES THE WIDTH AND AS DEEP AS ROOTBALL.
DECIDUOUS TREE PLANTING

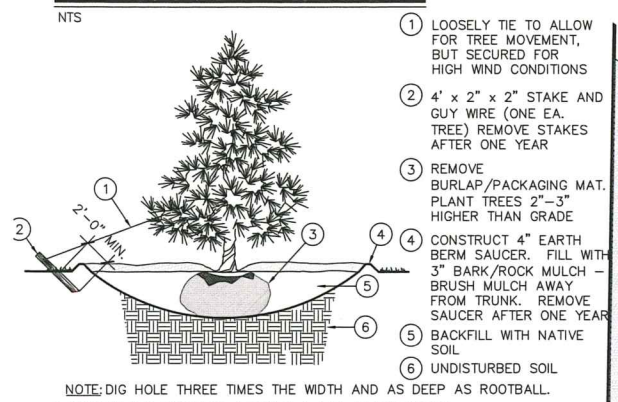

- 1 LOOSELY TIE TO ALLOW FOR TREE MOVEMENT, BUT SECURED FOR HIGH WIND CONDITIONS
- 2 4' x 2" x 2" STAKE AND GUY WIRE (ONE EA. TREE) REMOVE STAKES AFTER ONE YEAR
- 3 REMOVE BURLAP/PACKAGING MAT. PLANT TREES 2"-3" HIGHER THAN GRADE
- 4 CONSTRUCT 4" EARTH BERM SAUCER. FILL WITH 3" BARK/ROCK MULCH - BRUSH MULCH AWAY FROM TRUNK. REMOVE SAUCER AFTER ONE YEAR
- 5 BACKFILL WITH NATIVE SOIL
- 6 UNDISTURBED SOIL

NOTE: DIG HOLE THREE TIMES THE WIDTH AND AS DEEP AS ROOTBALL.
CONIFEROUS TREE PLANTING

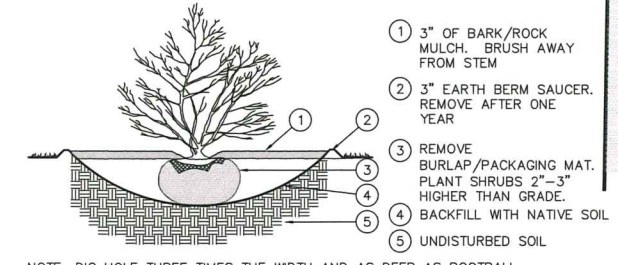

- 1 3" OF BARK/ROCK MULCH. BRUSH AWAY FROM STEM
- 2 3" EARTH BERM SAUCER. REMOVE AFTER ONE YEAR
- 3 REMOVE BURLAP/PACKAGING MAT. PLANT SHRUBS 2"-3" HIGHER THAN GRADE.
- 4 BACKFILL WITH NATIVE SOIL
- 5 UNDISTURBED SOIL

NOTE: DIG HOLE THREE TIMES THE WIDTH AND AS DEEP AS ROOTBALL.
SHRUB PLANTING

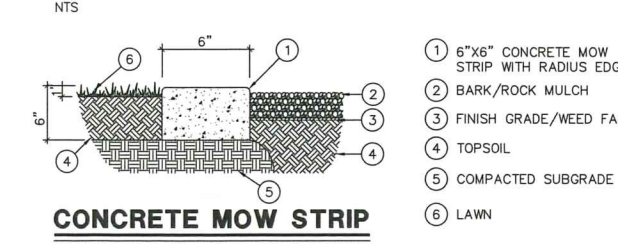

- 1 6"x6" CONCRETE MOW STRIP WITH RADIUS EDGES
- 2 BARK/ROCK MULCH
- 3 FINISH GRADE/WEED FABRIC
- 4 TOPSOIL
- 5 COMPACTED SUBGRADE
- 6 LAWN

NOTE: DIG HOLE THREE TIMES THE WIDTH AND AS DEEP AS ROOTBALL.
CONCRETE MOW STRIP

PLANTING NOTES

1. This planting plan is diagrammatic and plant locations are approximate.
2. Field survey, stake, and string the layout and locations of site construction features for approval before actual construction. The layout shall conform to the exact location and grades of the intended work to be done.
3. Coordinate all aspects of the planting plans with the irrigation system and call the attention of the owners representative to any conflict in placement of plants in relation to sprinkler heads, lines and valves at the time the landscape installation phase takes place.
4. Finish grade of soil in lawn areas shall be 2" below pads, walks, paving, headers and curbs to accommodate sod. Grades in areas when seeded shall be 1" lower than adjacent edge.
5. Native topsoil shall be stockpiled and stored on site whenever possible for use in landscape areas.
6. All sod areas shall receive a minimum 4" depth of native topsoil and shrub beds shall receive a minimum of 8" of native topsoil.
7. Imported topsoil, when required, shall come from a reputable source, have a loam consistency and be free of weeds and debris.
8. Face each shrub to give the most pleasing look as seen from a line perpendicular to the wall or walk to/from which it is viewed.
9. Edging or Curbing shall be installed as shown on the plan to separate grass from shrub beds.
10. Shrub beds shall drain properly to prevent standing water from occurring. Call improperly draining planters or planting beds to the attention of the owners representative before planting. Provide positive drainage away from all structures and walls. Slope landscape areas 2% minimum.
11. Place mulch in all shrub beds and perennial areas. See schedule for depth and type. Do not crowd out small perennial plants with excessive mulch.
12. Provide a 3" minimum diameter circle "tree ring" around trees that are placed within lawn areas. Place a 3" minimum depth of mulch. Use shredded bark mulch or match mulch being used for shrub beds.
13. The contractor shall maintain all work until work is complete and accepted by the Owner. The contractor shall maintain and guarantee all work for a period of THIRTY DAYS from the date of final acceptance by the Owner. Maintenance shall include mowing, weeding, fertilizing and irrigating.

THESE PLANS AND SPECIFICATIONS ARE THE PROPERTY OF REEVE & ASSOCIATES, INC., 5180 SOUTH 1500 WEST, RIVERDALE, UTAH 84405, AND SHALL NOT BE PHOTOCOPIED, RE-DRAWN, OR USED ON ANY PROJECT OTHER THAN THE PROJECT SPECIFICALLY DESIGNED FOR, WITHOUT THEIR WRITTEN PERMISSION. THE OWNERS AND ENGINEERS OF REEVE & ASSOCIATES, INC. DISCLAIM ANY LIABILITY FOR ANY CHANGES OR MODIFICATIONS MADE TO THESE PLANS OR THE DESIGN THEREON WITHOUT THEIR CONSENT.

PLANT TABLE

TREES				
Quantity	Symbol	Scientific Name	Common Name	Size
7		Gleditsia triacanthos 'Imperial'	Imperial Honey Locust	2" cal.
1		Pinus nigra	Austrian pine	6' Ht.
10		Pyrus calleryana	Bradford Pear	5-6' HL

SHRUBS				
Quantity	Symbol	Scientific Name	Common Name	Size
27		Mahonia aquifolium 'Compactum'	Compact Oregon Grape	5 gal.
12		Potentilla fruticosa 'Gold Drop'	Gold Drop Cinquefoil	5 gal.
35		Ribes Alpinum 'Green Mound'	Green Mound Alpine Currant	5 gal.

Ornamental Grasses				
Quantity	Symbol	Scientific Name	Common Name	Size
16		Calamagrostis 'Karl Foerster'	Karl Foerster Grass	1 gal.

PERENNIALS				
Quantity	Symbol	Scientific Name	Common Name	Size
39		Astilbe simplicifolia 'Key Largo'	Key Largo False Spirea	1 gal.
37		Bergenia cordifolia "Rose"	Rose Bergenia	1 gal.
21		Salvia superbanamorosa 'May Night'	May Night Salvia	1 gal.

OTHER		
Symbol	Description	Size/Type
	Turf Grass - Sod Kentucky Bluegrass Mix - 3 Species Minimum	Sod
	3/4" gray rock Place mulch over 5 ounce Professional weed barrier cloth in all planting beds. Contractor to provide samples to owner for approval prior to delivery.	1" Diameter 3" Depth
	Compacted Gravel	
	2 minus gray rock	
	3-5" gray rock	
	Concrete Mow Strip	6"x6"
	Vinyl Fence - 4' Height - Classic Picket - With 3' Gate	

LIGHTING SCHEDULE

SHRUBS			
Quantity	Symbol	Description	
3		LED LIGHT POLE KIT	SINGLE LED LIGHT WITH 20' POLE -ITEM #PK80 LIGHTMART.COM

PK80 LED Light Pole Kit with Single 80 Watt LED Light

Commercial-grade LED Light Pole Assembly Includes:
 Square steel light pole, single LED light complete with mounting bracket and hardware, set of anchor bolts and a base cover.

Light Pole:
 Pole Shaft: 4-inch square 11 gauge commercial grade steel with minimum yield strength of 55,000 psi
 Pole Height: Standard pole height is 10' ft. Optional heights are 15ft. and 20 ft.
 Custom heights are also available.
 Anchor Bolts: A set of 4 galvanized steel anchor bolts is provided.
 Each anchor bolt includes 2 nuts and 2 washers.
 Bolt Circle: 8-1/2" (Bolted base for 8-1/2" Bolt Circle)
 Handhole: Handhole is located 18" above the base plate. A 3" X 6" steel handhole cover is included.
 Color: Dark Bronze
 Base Cover: ABS Plastic base cover with rivets.

LED Fixture:
 Material: Aluminum construction with integrated fins to maximize heat dissipation.
 Color: Dark Bronze
 Power: 80 Watts
 Lumens: 11,000
 Lumens/Watt: 138
 Voltage: 120-277 Volt standard. 200-480 Volt option as special order.
 Color Temperature: 5000K standard, 4000K and 3000K options as special order.
 Light Distribution: Type 3 standard, Type 4 option as special order.
 Photocell: Optional Twilight/Lock photocell.
 Dimming: 0-100 Dimming Capable. Dimming control not provided (field install).
 UL Listing: UL Listed for Wet Locations.
 DLC Listing: DLC Premium
 IP Rating: IP65
 Life Expectancy: 100,000 Hours (L70)
 Warranty: 5 Years
 Weight: 13.5 lbs.

System Data

Total Power (Watts)	Total Lumens	120V	277V	Max Wind Rating
80	11,000	0.7	0.3	140 mph

Copyright © 2020 Energy Light, Inc. All Rights Reserved | 1881 Rose Road, Lake Zurich, IL 60047

Light Pole & Base
 SCALE: NONE

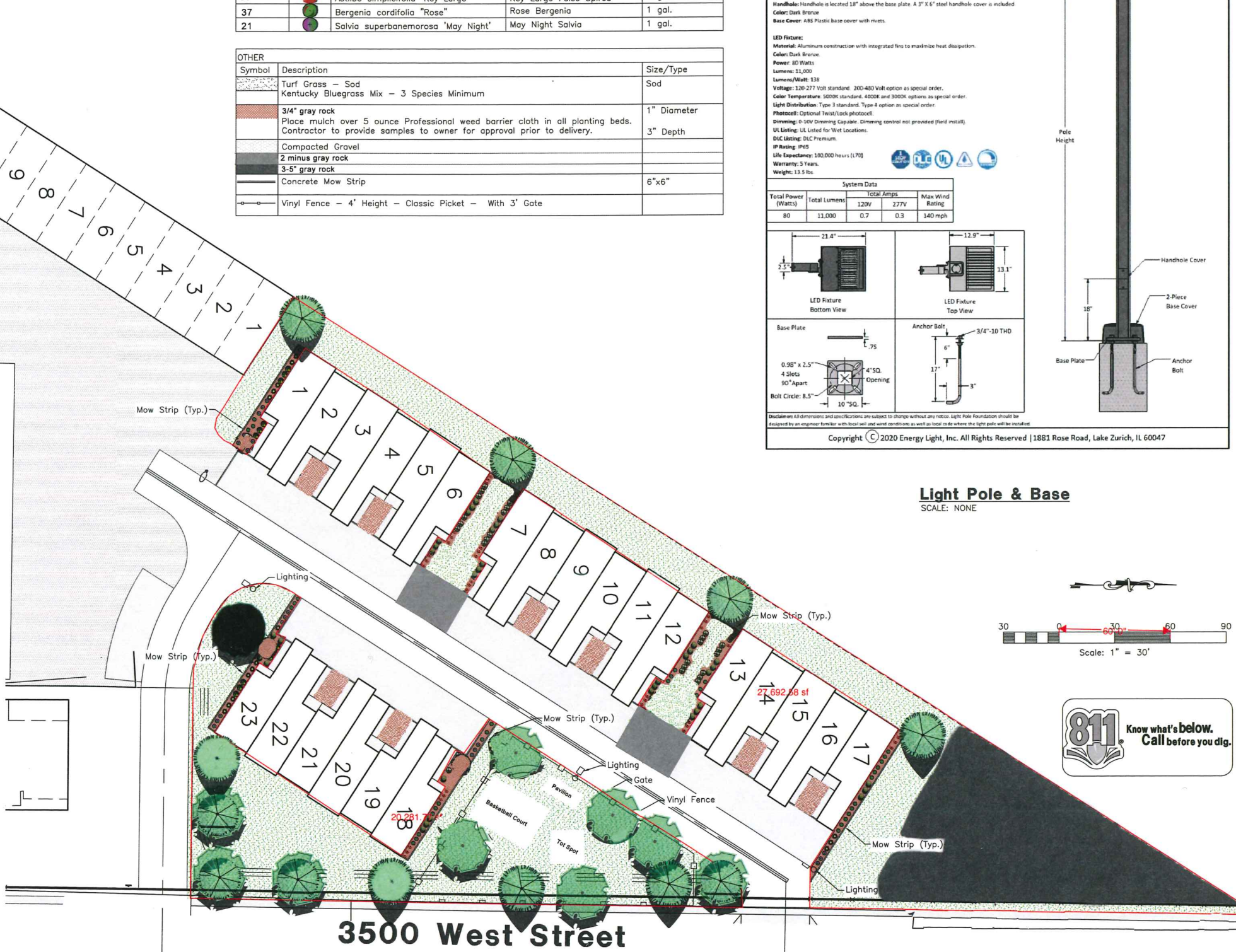
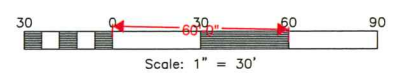
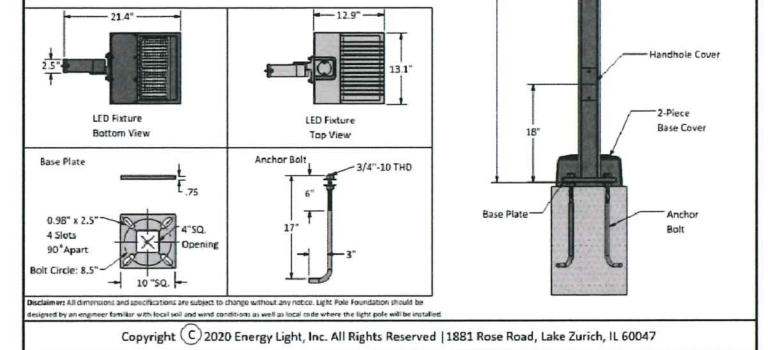

3500 West Street

Reeve & Associates, Inc.
 5180 SOUTH 1500 WEST, RIVERDALE, UTAH 84405
 TEL: (801) 621-1100 www.reeveco.com
 LAND PLANNERS & CIVIL ENGINEERS • LAND SURVEYORS
 TRAFFIC ENGINEERS • STRUCTURAL ENGINEERS • LANDSCAPE ARCHITECTS

REVISIONS	DESCRIPTION
DATE	

Lilac Estates
 TAYLOR, WEBER COUNTY, UTAH

Landscape Plan



Project Info.
 Engineer: NATHAN PETERSON
 Drafter: N. PETERSON
 Begin Date: JUNE 2021
 Name: LILAC ESTATES
 Number: 3581-03