

ISSUED SETS

Date	Description

REVISIONS

No.	Date	Description

SKY LODGE - HOTEL
NORTH POWDER RIDGE ROAD, EDEN, UTAH, 84310

This drawing was made specifically for this site and client and does not apply to any other projects. The reproduction or use of this set of drawings for other projects is prohibited. Use of this set of drawings requires appropriate authorization from Gomez Vazquez International.

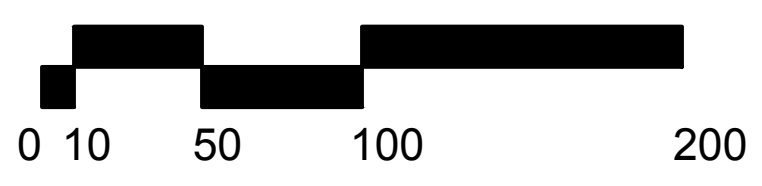
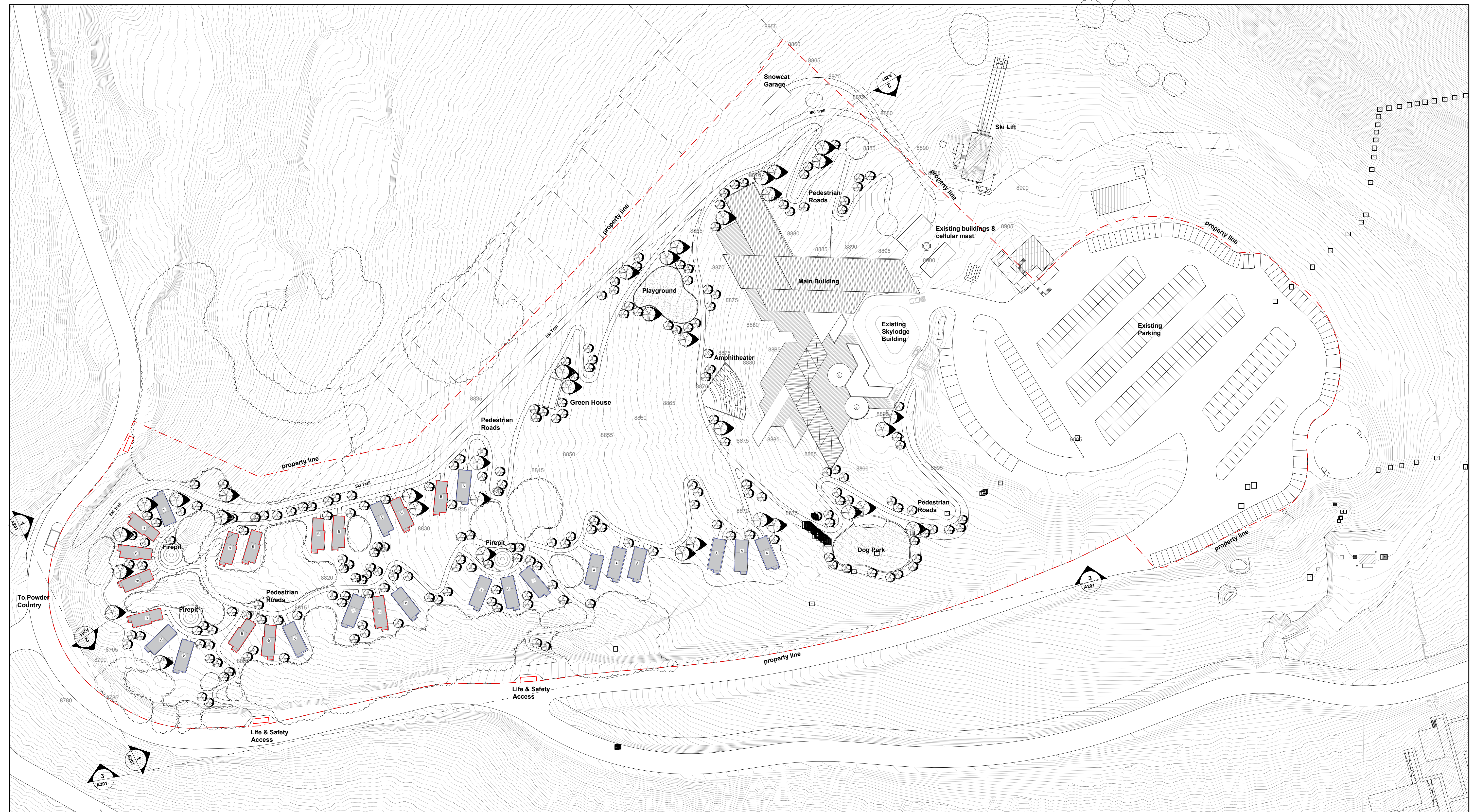

- Grading every 5 ft
- Grading every 1 ft
- Existing trees

- Cabin type A
(Single story)
420 ft²
17 keys
- Cabin type B
(Double story)
696 ft²
13 keys

1 SITE PLAN
SCALE: 1" = 60'

SET FOR COORDINATION,
NOT FOR CONSTRUCTION

PROFESSIONAL SEAL

SHEET NAME
SITEPLAN

Draftsman	GVI	Phase	SCHEMATIC DESIGN
GVI Approval	GVI	Project No.	22122
Client Approval	SKYLODGE	File	.dwg
Date	12/19/2022	Code	G051

SCALE AS INDICATED

SHEET NUMBER

G051