



**BENCHMARK**  
 NORTH QUARTER CORNER OF SECTION 20,  
 TOWNSHIP 6 NORTH, RANGE 3 WEST  
 SALT LAKE BASE AND MERIDIAN  
 ELEV = 4220.00'

# KHR SITE DEVELOPMENT

**9350 WEST 791 SOUTH  
 WEBER COUNTY, UTAH**

**INDEX OF DRAWINGS**

- C-001 GENERAL NOTES
- C-100 SITE AND UTILITY PLAN
- C-200 GRADING AND DRAINAGE PLAN
- C-300 EROSION CONTROL PLAN
- C-400 DETAILS
- L-100 LANDSCAPING PLAN

FOR REVIEW  
 NOT FOR CONSTRUCTION

DATE PRINTED  
 October 11, 2022



LAYTON  
 919 North 400 West  
 Layton, UT 84041  
 Phone: 801.547.1100

SALT LAKE CITY  
 Phone: 801.255.0529

TOOELE  
 Phone: 435.843.3590

CEDAR CITY  
 Phone: 435.865.1453

RICHFIELD  
 Phone: 435.896.2983

[WWW.ENSGNENG.COM](http://WWW.ENSGNENG.COM)

FOR:  
 KHR HOLDINGS, LLC  
 8488 STATE STREET  
 MIDVALE, UTAH 84047

CONTACT:  
 RYAN BROWN  
 PHONE: 801-514-6406

**KHR SITE DEVELOPMENT**  
**9350 WEST 791 SOUTH**  
**WEST WEBER COUNTY, UTAH**

**NOTICE TO CONTRACTOR**

ALL CONTRACTORS AND SUBCONTRACTORS PERFORMING WORK SHOWN ON OR RELATED TO THESE PLANS SHALL CONDUCT THEIR OPERATIONS SO THAT ALL EMPLOYEES ARE PROVIDED A SAFE PLACE TO WORK AND THE PUBLIC IS PROTECTED. ALL CONTRACTORS AND SUBCONTRACTORS SHALL COMPLY WITH THE "OCCUPATIONAL SAFETY AND HEALTH REGULATIONS OF THE U.S. DEPARTMENT OF LABOR AND THE STATE OF UTAH DEPARTMENT OF INDUSTRIAL RELATIONS CONSTRUCTION SAFETY ORDERS." THE CIVIL ENGINEER SHALL NOT BE RESPONSIBLE IN ANY WAY FOR THE CONTRACTORS AND SUBCONTRACTORS COMPLIANCE WITH SAID REGULATIONS AND ORDERS.

CONTRACTOR FURTHER AGREES TO ASSUME SOLE AND COMPLETE RESPONSIBILITY FOR JOB-SITE CONDITIONS DURING THE COURSE OF CONSTRUCTION OF THIS PROJECT, INCLUDING SAFETY OF ALL PERSONS AND PROPERTY. THAT THIS REQUIREMENT SHALL APPLY CONTINUOUSLY AND NOT BE LIMITED TO NORMAL WORKING HOURS, AND THAT THE CONTRACTOR SHALL DEFEND, INDEMNIFY AND HOLD THE OWNER AND THE CIVIL ENGINEER HARMLESS FROM ANY AND ALL LIABILITY, REAL OR ALLEGED IN CONNECTION WITH THE PERFORMANCE OF WORK ON THIS PROJECT, EXCEPTING FOR LIABILITY ARISING FROM THE SOLE NEGLIGENCE OF THE OWNER OR ENGINEER.

**NOTICE TO DEVELOPER/CONTRACTOR**

UNAPPROVED DRAWINGS REPRESENT WORK IN PROGRESS, ARE SUBJECT TO CHANGE, AND DO NOT CONSTITUTE A FINISHED ENGINEERING PRODUCT. ANY WORK UNDERTAKEN BY DEVELOPER OR CONTRACTOR BEFORE PLANS ARE APPROVED IS UNDERTAKEN AT THE SOLE RISK OF THE DEVELOPER, INCLUDING BUT NOT LIMITED TO BIDS, ESTIMATION, FINANCING, BONDING, SITE CLEARING, GRADING, INFRASTRUCTURE CONSTRUCTION, ETC.

**UTILITY DISCLAIMER**

THE CONTRACTOR IS SPECIFICALLY CAUTIONED THAT THE LOCATION AND / OR ELEVATIONS OF EXISTING UTILITIES AS SHOWN ON THESE PLANS IS BASED ON RECORDS OF THE VARIOUS UTILITY COMPANIES AND WHERE POSSIBLE, MEASUREMENTS TAKEN IN THE FIELD. THE INFORMATION IS NOT TO BE RELIED ON AS BEING EXACT OR COMPLETE. THE CONTRACTOR MUST CALL THE LOCAL UTILITY LOCATION CENTER AT LEAST 48 HOURS BEFORE ANY EXCAVATION TO REQUEST EXACT FIELD LOCATIONS OF UTILITIES. IT SHALL BE THE RESPONSIBILITY OF THE CONTRACTOR TO RELOCATE ALL EXISTING UTILITIES WHICH CONFLICT WITH THE PROPOSED IMPROVEMENTS SHOWN ON THE PLANS.

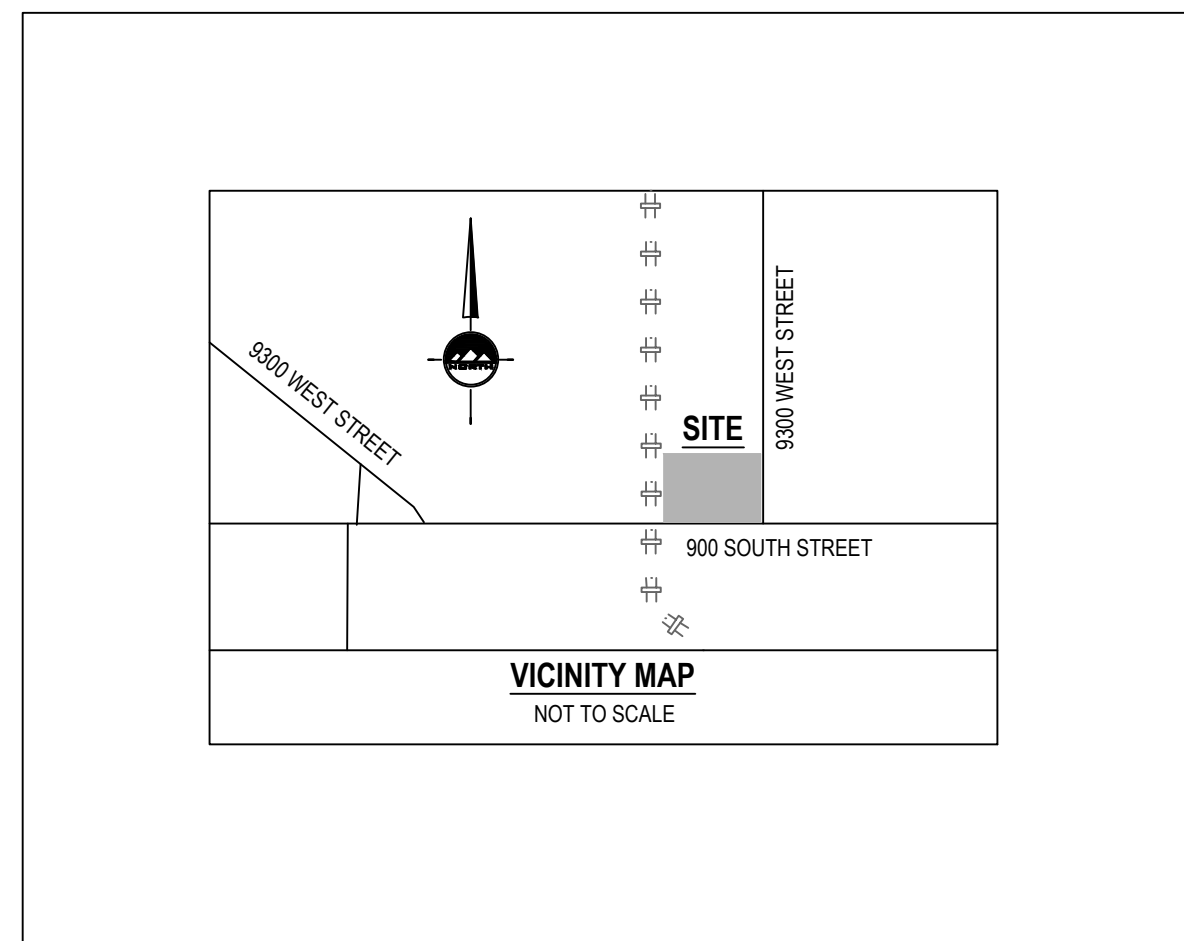

**GENERAL NOTES**

- ALL WORK SHALL CONFORM TO WEBER COUNTY STANDARDS & SPECIFICATIONS.
- CALL BLUE STAKES AT LEAST 48 HOURS PRIOR TO THE COMMENCEMENT OF ANY CONSTRUCTION ACTIVITIES.

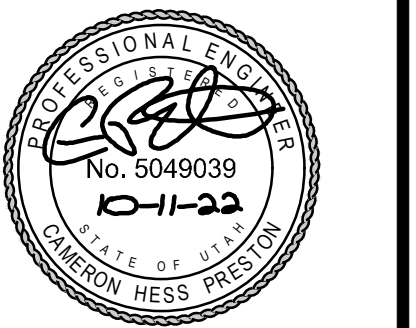

NO.	DATE	REVISION	BY
1		FOR REVIEW	
2			
3			
4			
5			
6			
7			
8			

**COVER**

PROJECT NUMBER: 11590      PRINT DATE: 10/11/22  
 DRAWN BY: J.MOSS      CHECKED BY: I.BUCKLEY  
 PROJECT MANAGER: C.PRESTON





**BENCHMARK**  
 NORTH QUARTER CORNER OF SECTION 20,  
 TOWNSHIP 6 NORTH, RANGE 3 WEST  
 SALT LAKE BASE AND MERIDIAN  
 ELEV = 4220.00'

- SCOPE OF WORK:**  
 PROVIDE, INSTALL AND/OR CONSTRUCT THE FOLLOWING PER THE SPECIFICATIONS GIVEN OR REFERENCED, THE DETAILS NOTED, AND/OR AS SHOWN ON THE CONSTRUCTION DRAWINGS:
- 1 EXISTING ASPHALT
  - 2 INSTALL ASPHALT PER DETAIL 7/C-400.
  - 3 MATCH EXISTING IMPROVEMENTS
  - 4 INSTALL COMPACTED GRAVEL PER DETAIL 9/C-400
  - 5 EXISTING POWER POLE
  - 6 EXISTING OVERHEAD POWER LINE
  - 7 INSTALL 6' SIDEWALK PER DETAIL 6/C-400
  - 8 INSTALL CONCRETE PAVEMENT PER DETAIL 8/C-400
  - 9 NOT USED
  - 10 INSTALL FIRE HYDRANT WITH VALVE COMPLETE PER WEBER COUNTY STANDARDS AND SPECIFICATIONS

- GENERAL NOTES**
1. ALL WORK TO COMPLY WITH THE GOVERNING AGENCY'S STANDARDS AND SPECIFICATIONS.
  2. ALL IMPROVEMENTS MUST COMPLY WITH ADA STANDARDS AND RECOMMENDATIONS.
  3. SEE LANDSCAPE/ARCHITECTURAL PLANS FOR CONCRETE MATERIAL, COLOR, FINISH, AND SCORE PATTERNS THROUGHOUT SITE.
  4. ALL PAVEMENT MARKINGS SHALL CONFORM TO THE LATEST EDITION OF THE M.U.T.C.D. (MANUAL ON UNIFORM TRAFFIC CONTROL DEVICES).
  5. ALL SURFACE IMPROVEMENTS DISTURBED BY CONSTRUCTION SHALL BE RESTORED OR REPLACED, INCLUDING TREES AND DECORATIVE SHRUBS, SOO, FENCES, WALLS AND STRUCTURES, WHETHER OR NOT THEY ARE SPECIFICALLY SHOWN ON THE CONTRACT DOCUMENTS.
  6. NOTIFY ENGINEER OF ANY DISCREPANCIES IN DESIGN OR STAKING BEFORE PLACING CONCRETE OR ASPHALT.
  7. THE CONTRACTOR IS TO PROTECT AND PRESERVE ALL EXISTING IMPROVEMENTS, UTILITIES, AND SIGNS, ETC. UNLESS OTHERWISE NOTED ON THESE PLANS.
  8. ALL WORK TO COMPLY WITH THE GOVERNING AGENCY'S STANDARDS AND SPECIFICATIONS.
  9. EXISTING UNDERGROUND UTILITIES AND IMPROVEMENTS ARE SHOWN IN THEIR APPROXIMATE LOCATIONS BASED UPON RECORD INFORMATION AVAILABLE AT THE TIME OF PREPARATION OF THESE PLANS. LOCATIONS MAY NOT HAVE BEEN VERIFIED IN THE FIELD AND NO GUARANTEE IS MADE AS TO THE ACCURACY OR COMPLETENESS OF THE INFORMATION SHOWN. IT SHALL BE THE RESPONSIBILITY OF THE CONTRACTOR TO DETERMINE THE EXISTENCE AND LOCATION OF THE UTILITIES SHOWN ON THESE PLANS OR INDICATED IN THE FIELD BY LOCATING SERVICES. ANY ADDITIONAL COSTS INCURRED AS A RESULT OF THE CONTRACTOR'S FAILURE TO VERIFY THE LOCATIONS OF EXISTING UTILITIES PRIOR TO THE BEGINNING OF CONSTRUCTION IN THEIR VICINITY SHALL BE BORNE BY THE CONTRACTOR AND ASSUMED INCLUDED IN THE CONTRACT. THE CONTRACTOR IS TO VERIFY ALL CONNECTION POINTS WITH THE EXISTING UTILITIES. THE CONTRACTOR IS RESPONSIBLE FOR ANY DAMAGE CAUSED TO THE EXISTING UTILITIES AND UTILITY STRUCTURES THAT ARE TO REMAIN. IF CONFLICTS WITH EXISTING UTILITIES OCCUR, THE CONTRACTOR SHALL NOTIFY THE ENGINEER PRIOR TO CONSTRUCTION TO DETERMINE IF ANY FIELD ADJUSTMENTS SHOULD BE MADE.
  10. ALL SANITARY SEWER INFRASTRUCTURE TO BE INSTALLED PER GOVERNING AGENCY STANDARD PLANS AND SPECIFICATIONS.
  11. ALL WATER INFRASTRUCTURE TO BE INSTALLED PER GOVERNING AGENCY OR APWA STANDARD PLANS AND SPECIFICATIONS.
  6. DEFLECT OR LOOP ALL WATERLINES TO AVOID CONFLICTS WITH OTHER UTILITIES PER GOVERNING AGENCY'S STANDARDS AND SPECIFICATIONS.
  7. PROJECT SHALL COMPLY WITH ALL UTAH DIVISION OF DRINKING WATER RULES AND REGULATIONS INCLUDING, BUT NOT LIMITED TO, THOSE PERTAINING TO BACKFLOW PROTECTION AND CROSS CONNECTION PREVENTION.
  8. THE CONTRACTOR IS TO COORDINATE ALL UTILITIES WITH MECHANICAL/PLUMBING PLANS.
  9. NOTIFY ENGINEER OF ANY DISCREPANCIES IN DESIGN OR STAKING BEFORE PLACING UTILITY STRUCTURES OR PIPES.
  10. THE CONTRACTOR SHALL ADJUST TO GRADE ALL EXISTING UTILITIES AS NEEDED PER LOCAL GOVERNING AGENCY'S STANDARDS AND SPECIFICATIONS.
  11. THE CONTRACTOR IS TO PROTECT AND PRESERVE ALL EXISTING IMPROVEMENTS, UTILITIES, AND SIGNS, ETC. UNLESS OTHERWISE NOTED ON THESE PLANS.

**EN SIGN**  
 THE STANDARD IN ENGINEERING

LAYTON  
 919 North 400 West  
 Layton, UT 84041  
 Phone: 801.547.1100

SALT LAKE CITY  
 Phone: 801.255.0529

TOOELE  
 Phone: 435.843.3590

CEDAR CITY  
 Phone: 435.865.1453

RICHFIELD  
 Phone: 435.896.2983

[WWW.ENSIGNENG.COM](http://WWW.ENSIGNENG.COM)

FOR:  
 KHR HOLDINGS, LLC  
 8488 STATE STREET  
 MIDVALE, UTAH 84047

CONTACT:  
 RYAN BROWN  
 PHONE: 801-514-6406

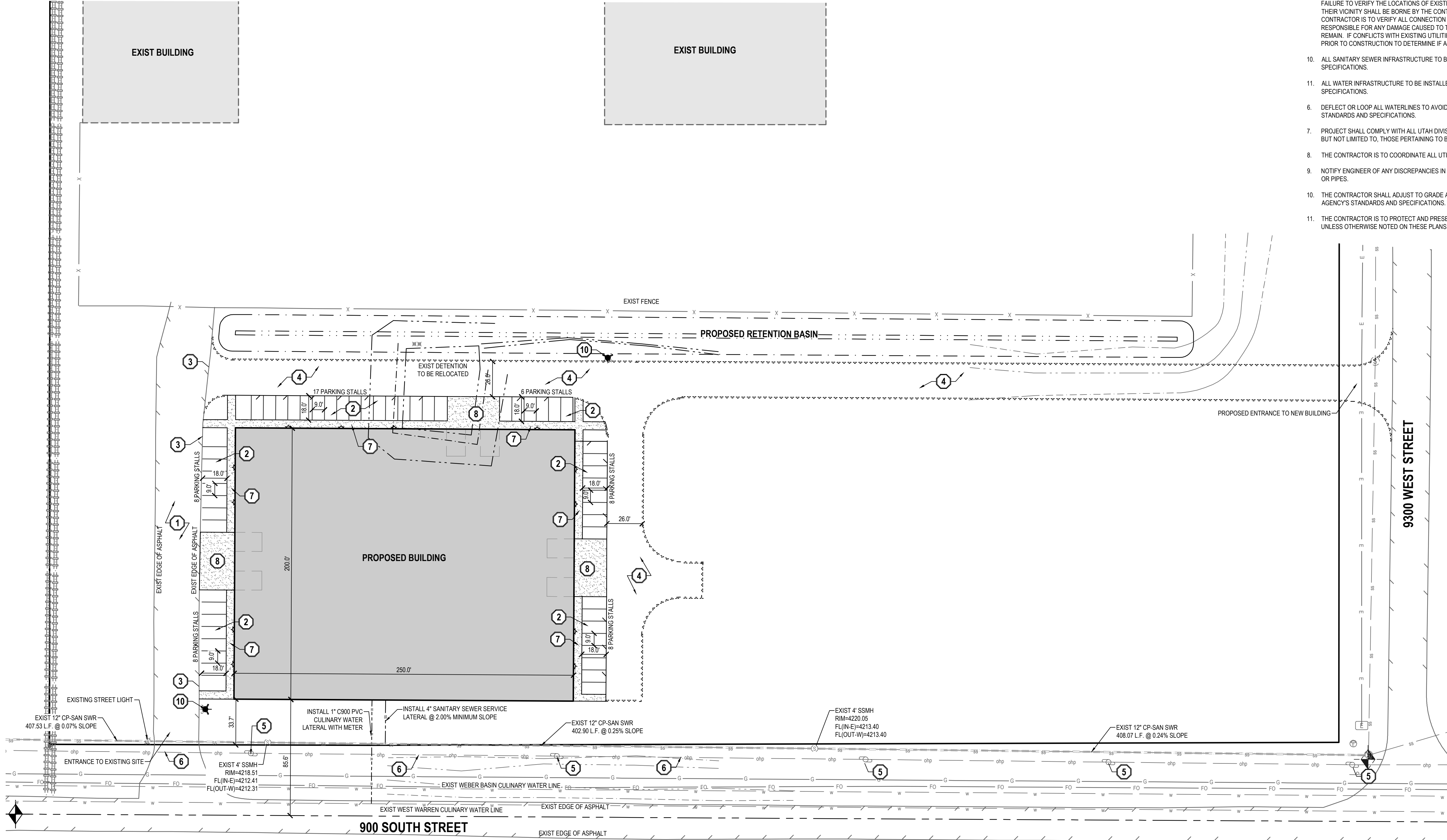

**KHR SITE DEVELOPMENT**

9350 WEST 791 SOUTH  
 WEST WEBER COUNTY, UTAH



NO.	DATE	REVISION	BY
1		FOR REVIEW	
2			
3			
4			
5			
6			
7			
8			

**SITE AND UTILITY PLAN**

PROJECT NUMBER: 11590      PRINT DATE: 10/11/22  
 DRAWN BY: J.MOSS      CHECKED BY: I.BUCKLEY  
 PROJECT MANAGER: C.PRESTON

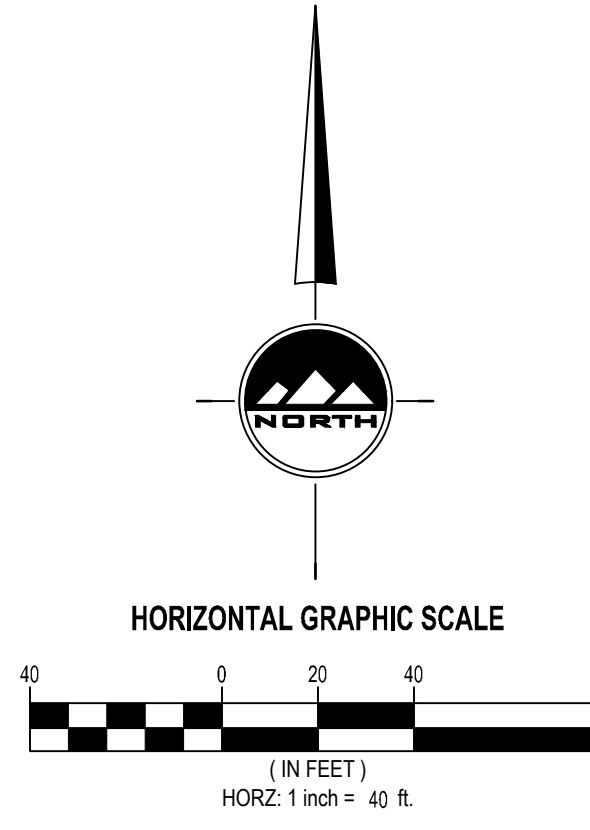

**C-100**

**811**  
CALL BLUESTAKES  
@ 811 AT LEAST 48 HOURS  
PRIOR TO THE  
COMMENCEMENT OF ANY  
CONSTRUCTION.

**BENCHMARK**

NORTH QUARTER CORNER OF SECTION 20,  
TOWNSHIP 6 NORTH, RANGE 3 WEST,  
SALT LAKE BASE AND MERIDIAN

ELEV = 4220.00'

**Retention Calculations (100-year storm)**

	C	Area ft <sup>2</sup>
Hardscape	0.9	150000
Landscape	0.25	115937
<b>Total Area</b>		<b>265937</b>
Runoff coefficient C:	0.62	
1 hr Intensity:	1.67	
	Required Storage	Storage Provided
	Area (ft <sup>2</sup> )	Area (ft <sup>2</sup> )
	265937	31964

**Pipe Design (10-year storm)**

Pipe	Tributary	Surface	Upstream	Pipe Flow	Total	Pipe	Diameter	Pipe Type	Full Flow	% of Full-
RD 1	2	0.663		0.663	0.50%	8	ADS	1.013	1.013	65.5%
SD-1			RD1	0.663	0.663	12	RCP	2.526	2.526	26.3%
SD-2			RD2	0.663	0.663	12	RCP	2.526	2.526	26.3%
RD 2	3	0.663		0.663	0.50%	8	ADS	1.013	1.013	65.5%

**Catchment Calculations (10-year storm)**

Time of Concentration: 15 min  
Rainfall Intensity I: 2.00 in/hr  
Manning's N: 0.013

Catchment	Area (SF)	C	Flow (CFS)	Destination
1	215,937	0.573	5,729	
2	25,000	0.573	0,663	SD-1
3	25,000	0.573	0,663	SD-2

**GENERAL NOTES**

- ALL WORK TO COMPLY WITH THE GOVERNING AGENCY'S STANDARDS AND SPECIFICATIONS.
- ALL IMPROVEMENTS MUST COMPLY WITH ADA STANDARDS AND RECOMMENDATIONS.
- ALL WORK SHALL COMPLY WITH THE RECOMMENDATIONS OF THE GEOTECHNICAL ENGINEER POSSIBLY INCLUDING, BUT NOT LIMITED TO, REMOVAL OF UNCONSOLIDATED FILL, ORGANICS, AND DEBRIS, PLACEMENT OF SUBSURFACE DRAIN LINES AND GEOTEXTILE, AND OVEREXCAVATION OF UNSUITABLE BEARING MATERIALS AND PLACEMENT OF ACCEPTABLE FILL MATERIAL.
- THE CONTRACTOR SHALL BECOME FAMILIAR WITH THE EXISTING SOIL CONDITIONS.
- ELEVATIONS HAVE BEEN TRUNCATED FOR CLARITY. XX.XX REPRESENTS AN ELEVATION OF 48XX.XX ON THESE PLANS.
- LANDSCAPED AREAS REQUIRE SUBGRADE TO BE MAINTAINED AT A SPECIFIC ELEVATION BELOW FINISHED GRADE AND REQUIRE SUBGRADE TO BE PROPERLY PREPARED AND SCARIFIED. SEE LANDSCAPE PLANS FOR ADDITIONAL INFORMATION.
- SLOPE ALL LANDSCAPED AREAS AWAY FROM BUILDING FOUNDATIONS TOWARD CURB AND GUTTER OR STORM DRAIN INLETS.
- EXISTING UNDERGROUND UTILITIES AND IMPROVEMENTS ARE SHOWN IN THEIR APPROXIMATE LOCATIONS BASED UPON RECORD INFORMATION AVAILABLE AT THE TIME OF PREPARATION OF THESE PLANS. LOCATIONS MAY NOT HAVE BEEN VERIFIED IN THE FIELD AND NO GUARANTEE IS MADE AS TO THE ACCURACY OR COMPLETENESS OF THE INFORMATION SHOWN. IT SHALL BE THE RESPONSIBILITY OF THE CONTRACTOR TO DETERMINE THE EXISTENCE AND LOCATION OF THE UTILITIES SHOWN ON THESE PLANS OR INDICATED IN THE FIELD BY LOCATING SERVICES. ANY ADDITIONAL COSTS INCURRED AS A RESULT OF THE CONTRACTOR'S FAILURE TO VERIFY THE LOCATIONS OF EXISTING UTILITIES PRIOR TO THE BEGINNING OF CONSTRUCTION IN THEIR VICINITY SHALL BE BORNE BY THE CONTRACTOR AND ASSUMED INCLUDED IN THE CONTRACT. THE CONTRACTOR IS TO VERIFY ALL CONNECTION POINTS WITH THE EXISTING UTILITIES. THE CONTRACTOR IS RESPONSIBLE FOR ANY DAMAGE CAUSED TO THE EXISTING UTILITIES AND UTILITY STRUCTURES THAT ARE TO REMAIN. IF CONFLICTS WITH EXISTING UTILITIES OCCUR, THE CONTRACTOR SHALL NOTIFY THE ENGINEER PRIOR TO CONSTRUCTION TO DETERMINE IF ANY FIELD ADJUSTMENTS SHOULD BE MADE.
- ALL STORM DRAIN INFRASTRUCTURE TO BE INSTALLED PER GOVERNING AGENCY OR APWA STANDARD PLANS AND SPECIFICATIONS.
- ENSURE MINIMUM COVER OVER ALL STORM DRAIN PIPES PER MANUFACTURER'S RECOMMENDATIONS. NOTIFY ENGINEER IF MINIMUM COVER CANNOT BE ATTAINED.
- ALL FACILITIES WITH DOWNSPOUTS/ROOF DRAINS SHALL BE CONNECTED TO THE STORM DRAIN SYSTEM. SEE PLUMBING PLANS FOR DOWNSPOUT/ROOF DRAIN LOCATIONS AND SIZES. ALL ROOF DRAINS TO HAVE MINIMUM 1% SLOPE.
- THE CONTRACTOR SHALL ADJUST TO GRADE ALL EXISTING UTILITIES AS NEEDED PER LOCAL GOVERNING AGENCY'S STANDARDS AND SPECIFICATIONS.
- NOTIFY ENGINEER OF ANY DISCREPANCIES IN DESIGN OR STAKING BEFORE PLACING CONCRETE, ASPHALT, OR STORM DRAIN STRUCTURES OR PIPES.
- THE CONTRACTOR IS TO PROTECT AND PRESERVE ALL EXISTING IMPROVEMENTS, UTILITIES, AND SIGNS, ETC. UNLESS OTHERWISE NOTED ON THESE PLANS.

**ENSIGN**  
THE STANDARD IN ENGINEERING

LAYTON  
919 North 400 West  
Layton, UT 84041  
Phone: 801.547.1100

SALT LAKE CITY  
Phone: 801.255.0529

TOOELE  
Phone: 435.843.3590

CEDAR CITY  
Phone: 435.865.1453

RICHFIELD  
Phone: 435.896.2983

[www.ensigneng.com](http://www.ensigneng.com)

FOR:  
KHR HOLDINGS, LLC  
8488 STATE STREET  
MIDVALE, UTAH 84047

CONTACT:  
RYAN BROWN  
PHONE: 801-514-6406

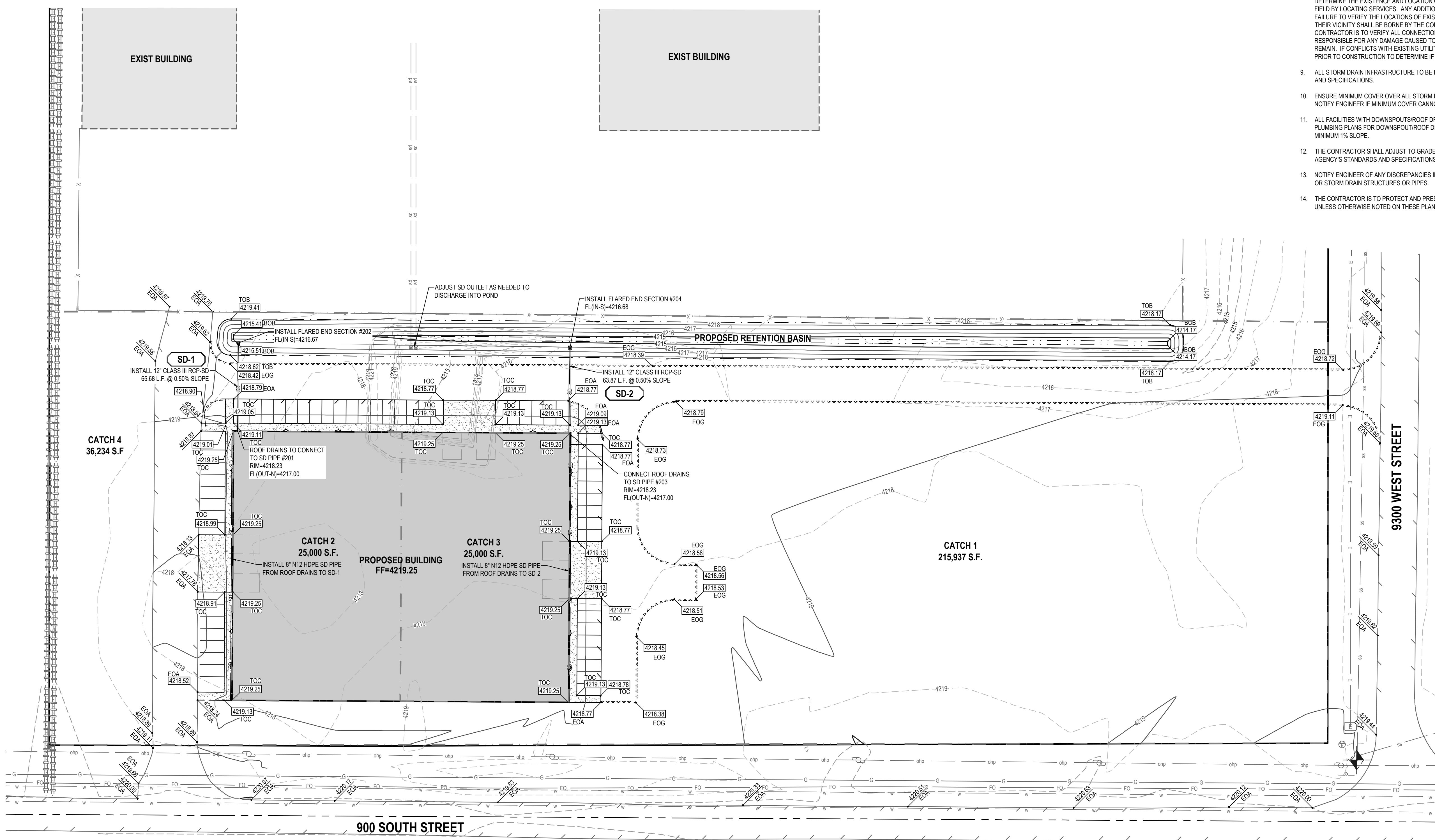

**KHR SITE DEVELOPMENT**

9350 WEST 791 SOUTH  
WEST WEBER COUNTY, UTAH



NO.	DATE	REVISION	BY
1		FOR REVIEW	
2			
3			
4			
5			
6			
7			
8			

**GRADING AND DRAINAGE PLAN**

PROJECT NUMBER 11590	PRINT DATE 10/11/22
DRAWN BY J.MOSS	CHECKED BY I.BUCKLEY
PROJECT MANAGER C.PRESTON	

**C-200**

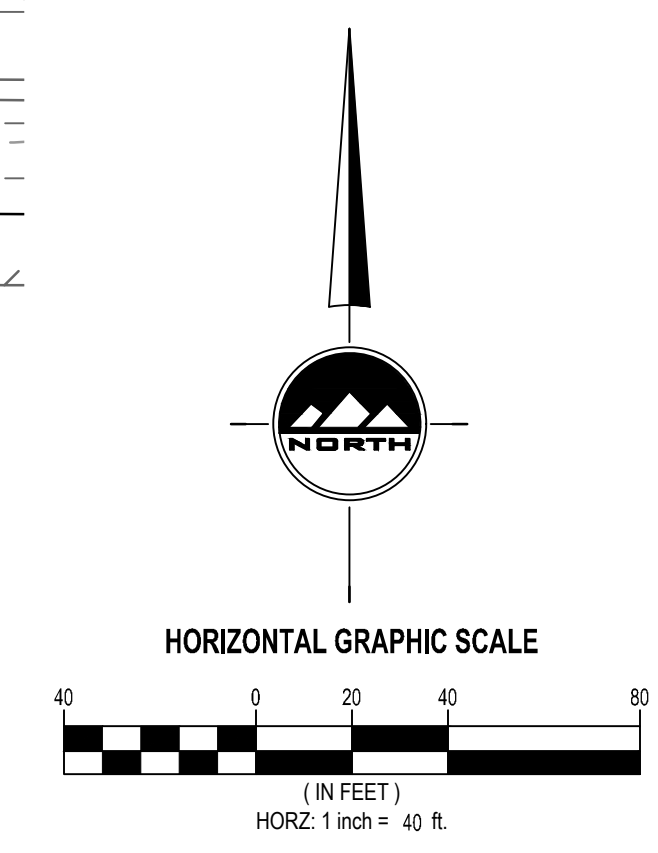

**811**  
CALL BLUESTAKES  
@ 811 AT LEAST 48 HOURS  
PRIOR TO THE  
COMMENCEMENT OF ANY  
CONSTRUCTION.  
Call before you dig.

**BENCHMARK**  
NORTH QUARTER CORNER OF SECTION 20,  
TOWNSHIP 6 NORTH, RANGE 3 WEST  
SALT LAKE BASE AND MERIDIAN  
ELEV = 4220.00'

REVISION SCHEDULE			
NUMBER	DATE	AUTHOR	COMPANY REPRESENTATIVE SIGNATURE
1			
2			
3			
4			
5			
6			
7			
8			
9			
10			
11			
12			

- SCOPE OF WORK:**  
PROVIDE, INSTALL AND/OR CONSTRUCT THE FOLLOWING PER THE SPECIFICATIONS GIVEN OR REFERENCED, THE DETAILS NOTED, AND/OR AS SHOWN ON THE CONSTRUCTION DRAWINGS.
- 1 VEHICLE WASHDOWN AND STABILIZED CONSTRUCTION ENTRANCE PER DETAIL 1/C-400.
  - 2 SUGGESTED TEMPORARY CONSTRUCTION SITE PARKING, STAGING, DUMPSTER, AND MATERIAL STORAGE AREA.
  - 3 CONCRETE CLEANOUT LINED BASIN OR DUMPSTER
  - 4 LIMITS OF DISTURBANCE
  - 5 INSTALL TEMPORARY SILT FENCE PER DETAIL 4/C-400
  - 6 INSTALL TEMPORARY OUTLET PROTECTION PER DETAIL 5/C-400

- GENERAL NOTES**
1. THIS PLAN IS DESIGNED AS A FIRST APPRAISAL OF NECESSARY MEANS TO PROTECT THE WATERS OF THE STATE FROM POTENTIAL POLLUTION. IT IS THE RESPONSIBILITY OF THE OWNER/OPERATOR TO ADD WARRANTED BEST MANAGEMENT PRACTICES (BMPs) AS NECESSARY, MODIFY THOSE SHOWN AS APPROPRIATE, AND DELETE FROM THE PROJECT THOSE FOUND TO BE UNNECESSARY. FEDERAL AND STATE LAW ALLOWS THESE UPDATES TO BE MADE BY THE OWNER/OPERATOR ONSITE AND RECORDED BY THE OWNER/OPERATOR ON THE COPY OF THE SWPPP KEPT ONSITE.
  2. DISTURBED LAND SHALL BE KEPT TO A MINIMUM. STABILIZATION MEASURES SHALL BE INITIATED AS SOON AS PRACTICABLE IN PORTIONS OF THE SITE WHERE CONSTRUCTION ACTIVITIES HAVE TEMPORARILY OR PERMANENTLY CEASED, BUT IN NO CASE MORE THAN 14 DAYS AFTER THE CONSTRUCTION ACTIVITY IN THAT PORTION OF THE SITE HAS TEMPORARILY OR PERMANENTLY CEASED. HOWEVER, WHERE CONSTRUCTION ACTIVITY ON A PORTION OF THE SITE IS TEMPORARILY CEASED, AND EARTH DISTURBING ACTIVITIES WILL BE RESUMED WITHIN 21 DAYS, TEMPORARY STABILIZATION MEASURES DO NOT HAVE TO BE INITIATED ON THAT PORTION OF THE SITE.
  3. RESEED DISTURBED LAND WITH NATIVE GRASS MIXTURE WITHIN 14 CALENDAR DAYS OF ACHIEVEMENT OF FINISH GRADE TO STABILIZE SOILS IF LAND IS NOT TO BE RE-WORKED WITHIN 14 CALENDAR DAYS OF THE CESSATION OF CONSTRUCTION ACTIVITIES AT THAT LOCATION.
  4. DETAILS SHOWN ARE TO BE EMPLOYED TO PROTECT RUNOFF AS APPROPRIATE DURING CONSTRUCTION. NOT ALL DETAILS ARE NECESSARY AT ALL PHASES OF THE PROJECT. IT SHALL BE THE RESPONSIBILITY OF THE OWNER/OPERATOR TO USE APPROPRIATE BEST MANAGEMENT PRACTICES AT THE APPROPRIATE PHASE OF CONSTRUCTION. SEE SWPPP FOR BMP IMPLEMENTATION SCHEDULE.
  5. VARIOUS BEST MANAGEMENT PRACTICES HAVE BEEN SHOWN ON THE PLANS AT SUGGESTED LOCATIONS. THE CONTRACTOR MAY MOVE AND RECONFIGURE THESE BMPs TO OTHER LOCATIONS IF PREFERRED, PROVIDED THE INTENT OF THE DESIGN IS PRESERVED.
  6. NOT ALL POSSIBLE BMPs HAVE BEEN SHOWN. THE CONTRACTOR IS RESPONSIBLE TO APPLY CORRECT MEASURES TO PREVENT THE POLLUTION OF STORM WATER PER PROJECT SWPPP.
  7. A UPDES (UTAH POLLUTANT DISCHARGE ELIMINATION SYSTEM) PERMIT IS REQUIRED FOR ALL CONSTRUCTION ACTIVITIES 1 ACRE OR MORE.

**ENSIGN**  
THE STANDARD IN ENGINEERING

LAYTON  
919 North 400 West  
Layton, UT 84041  
Phone: 801.547.1100

SALT LAKE CITY  
Phone: 801.255.0529

TOOELE  
Phone: 435.843.3590

CEDAR CITY  
Phone: 435.865.1453

RICHFIELD  
Phone: 435.896.2983

[WWW.ENSIGNENG.COM](http://WWW.ENSIGNENG.COM)

FOR:  
KHR HOLDINGS, LLC  
8488 STATE STREET  
MIDVALE, UTAH 84047

CONTACT:  
RYAN BROWN  
PHONE: 801-514-6406

**KHR SITE DEVELOPMENT**  
**9350 WEST 791 SOUTH**  
**WEST WEBER COUNTY, UTAH**



NO.	DATE	REVISION	BY
1		FOR REVIEW	
2			
3			
4			
5			
6			
7			
8			

**EROSION CONTROL PLAN**

PROJECT NUMBER: 11590  
PRINT DATE: 10/11/22  
DRAWN BY: J.MOSS  
CHECKED BY: I.BUCKLEY  
PROJECT MANAGER: C.PRESTON

**C-300**

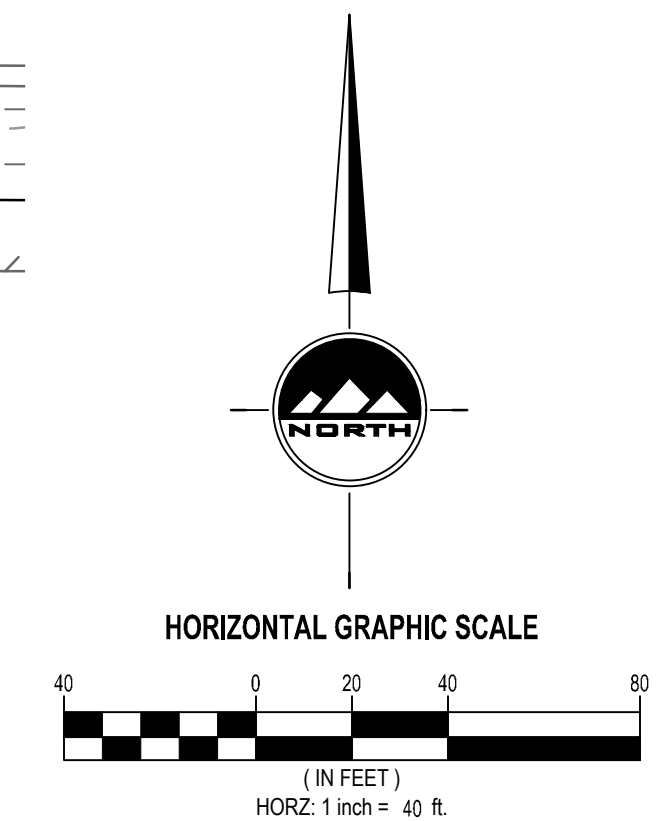
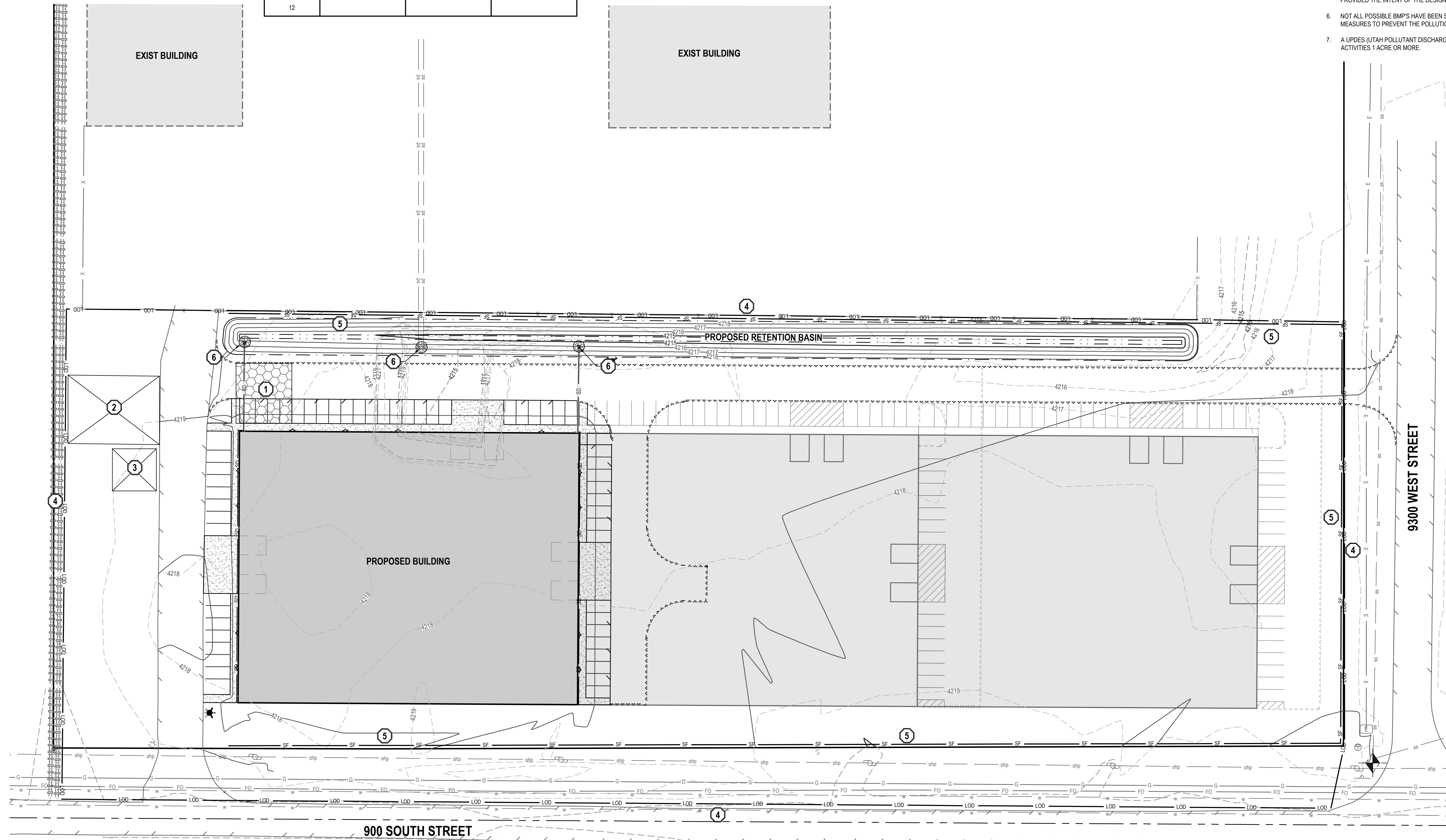

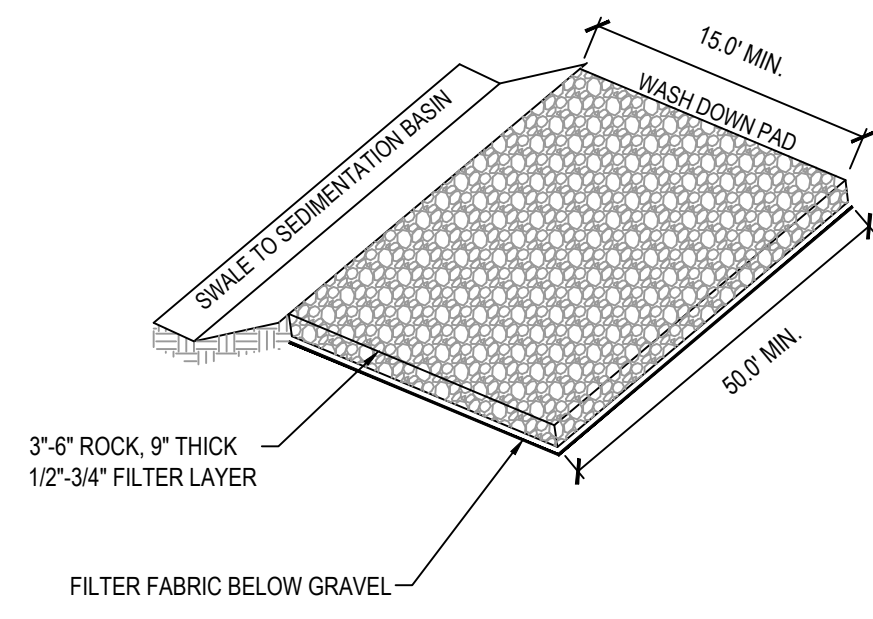

- NOTE:**
1. PLACE SIGN ADJACENT TO ENTRANCE \* CONSTRUCTION TRAFFIC ONLY - ALL CONSTRUCTION TRAFFIC SHALL ENTER AND EXIT SITE AT THIS LOCATION\*

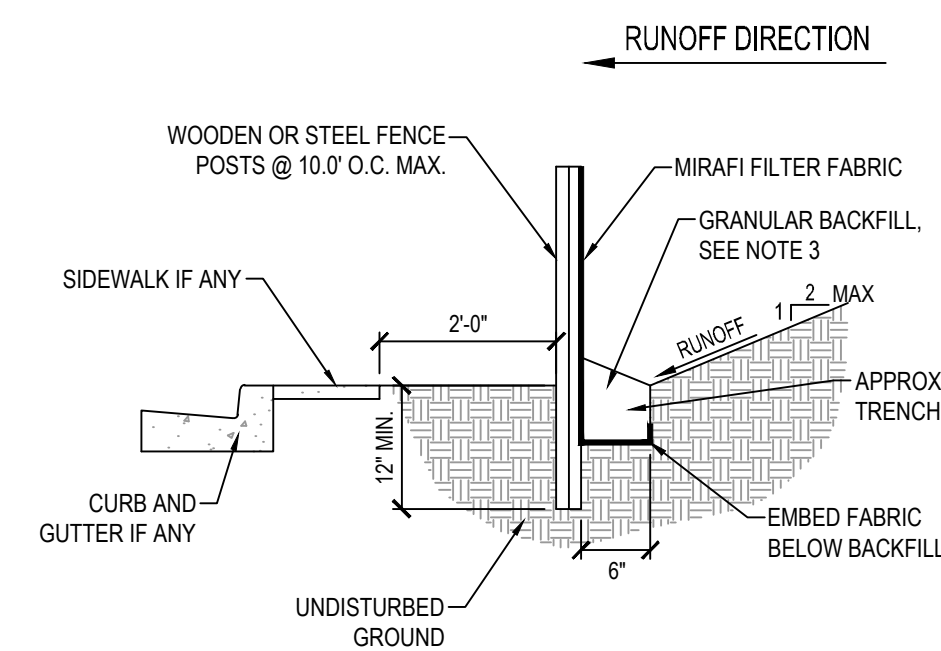
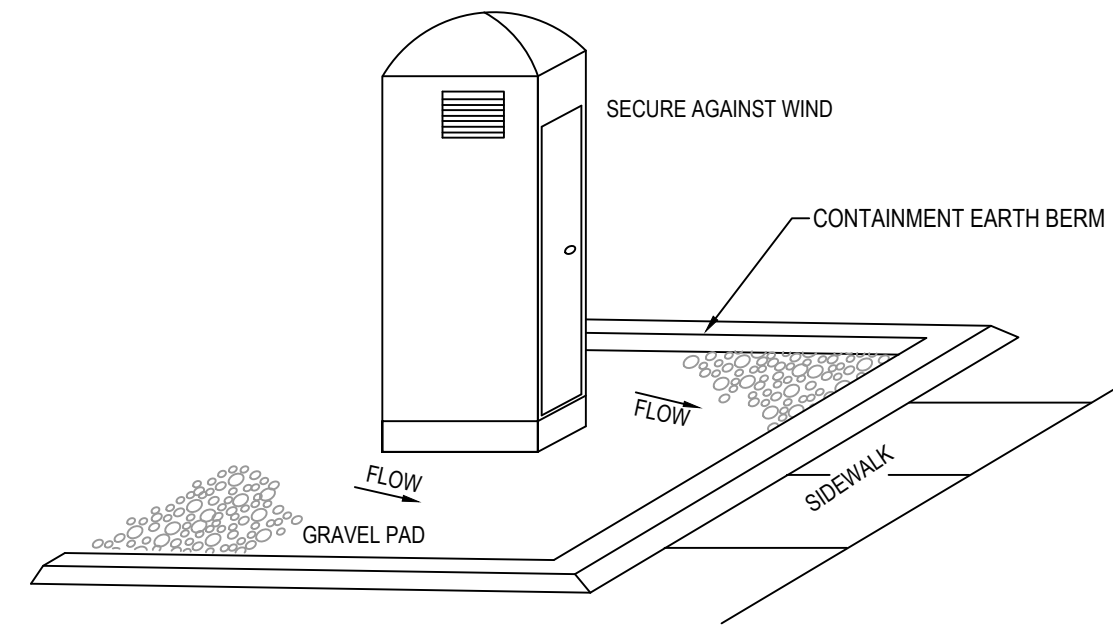
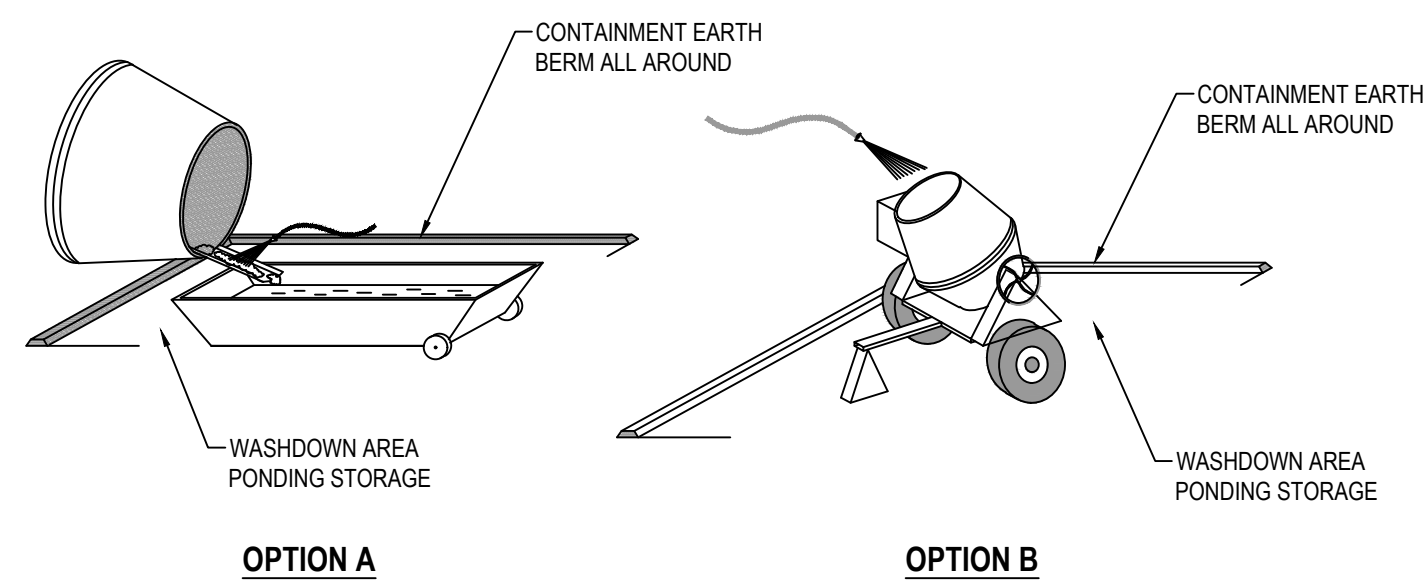

- NOTES:**
1. EXCAVATE 6"x6" TRENCH ALONG LIMITS OF DISTURBANCE AS SHOWN ON CONSTRUCTION DRAWINGS. POSTS SHALL BE POSITIONED ON DOWNSTREAM SIDE OF FENCE.
  2. LAY TOE-IN FABRIC FLAP IN BOTTOM OF TRENCH. BACKFILL TRENCH WITH FREE DRAINING GRANULAR MATERIAL. COMPACT TRENCH TO SATISFACTION OF THE ENGINEER OF RECORD.
  3. SILT FENCE GEOTEXTILE SHALL MEET AASHTO M288-92 REQUIREMENTS.
  4. REMOVE & DISPOSE OF SEDIMENT WHEN ACCUMULATION IS 50% OF EXPOSED FENCE HEIGHT.
  5. 10' MAX. SPACING BETWEEN STAKES.
  6. SILT FENCES SHALL BE INSTALLED ALONG CONTOURS, NOT UP AND DOWN SLOPES, WITH 10' OVERLAP AT BREAKS.

**1 STABILIZED CONSTRUCTION ENTRANCE** SCALE: NONE

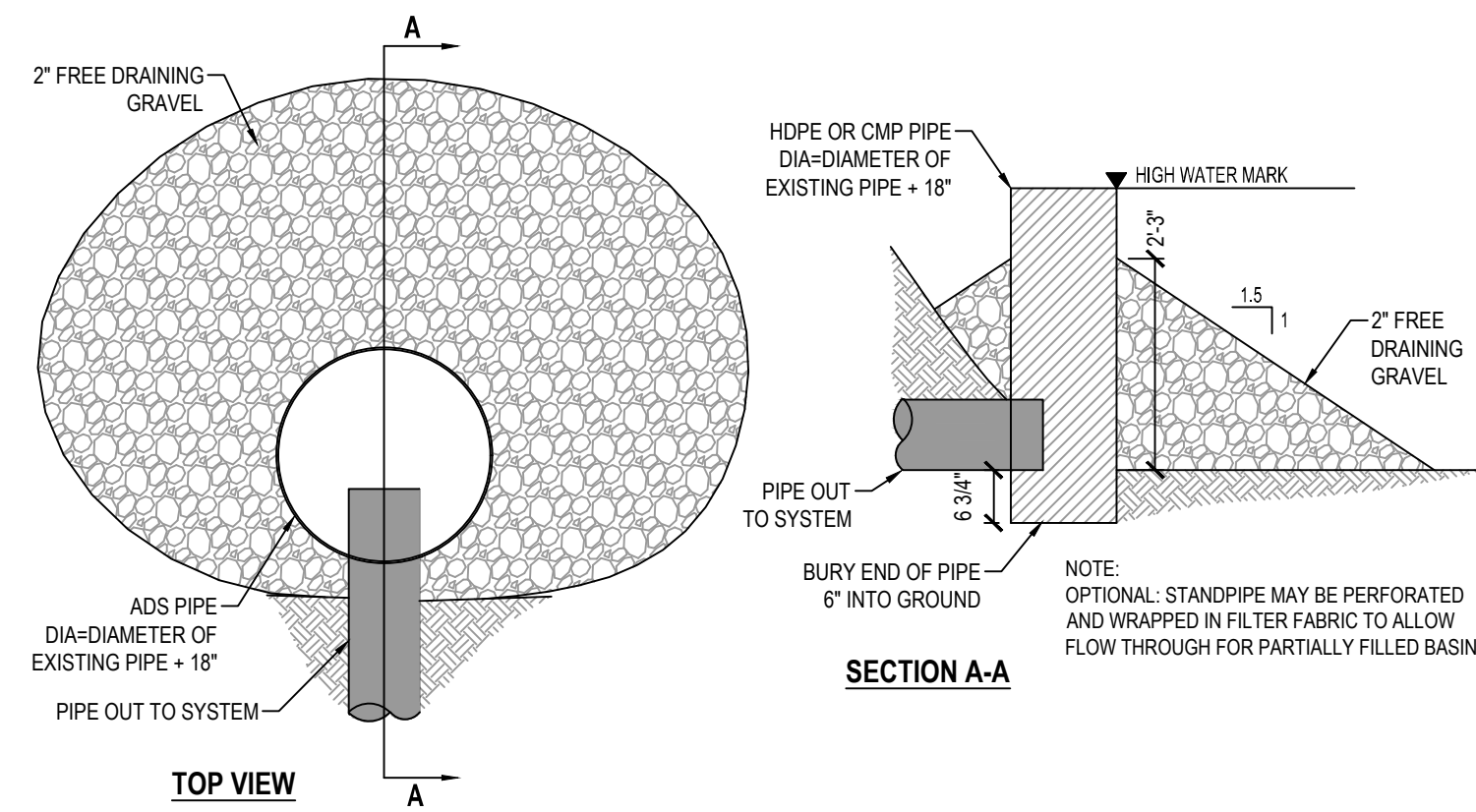

**2 CONCRETE WASTE MANAGEMENT** SCALE: NONE

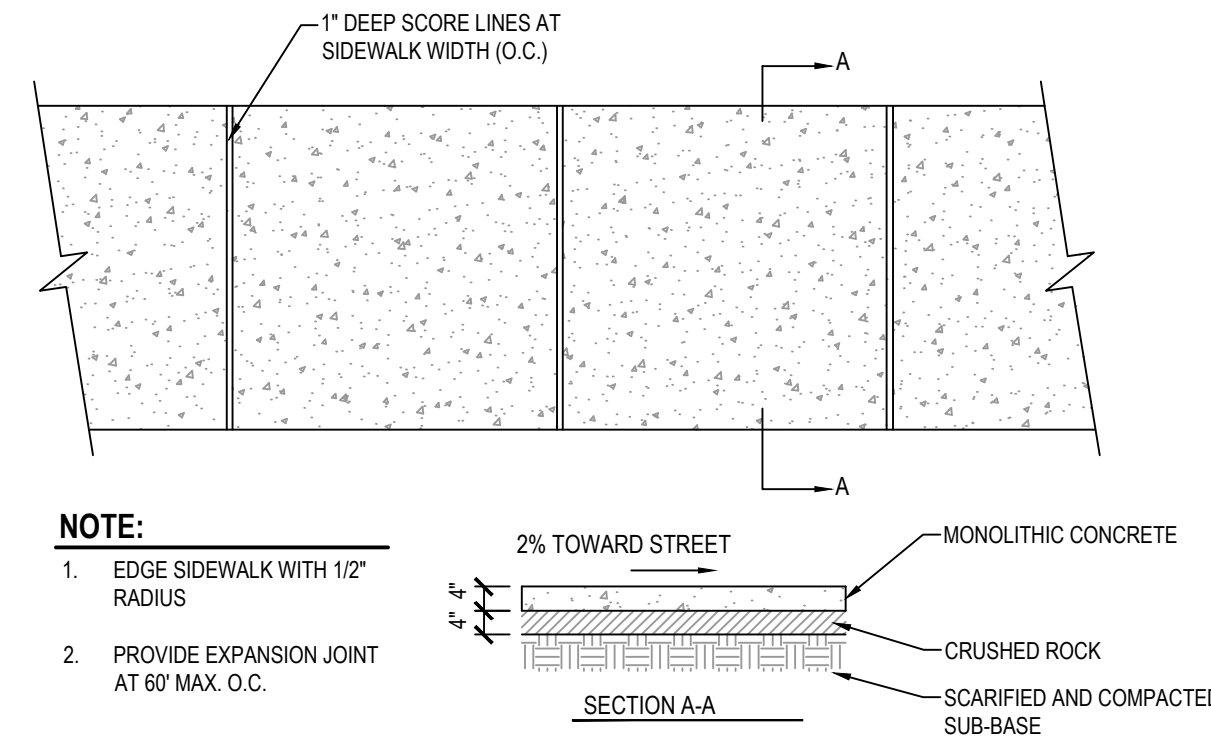

**3 PORTABLE TOILET** SCALE: NONE

- ASPHALT NOTES**
1. ALL PAVING TO BE PLACED OVER PROPERLY PREPARED NATURAL SOILS AND/OR PROPERLY PREPARED EXISTING FILL SOILS AND PROPERLY COMPACTED STRUCTURAL FILL WHERE SPECIFIED.
  2. ALL STRUCTURAL FILL TO BE PLACED AND COMPACTED PER THE PROJECT GEOTECHNICAL REPORT OR TO A MINIMUM OF 95% OF THE MAXIMUM DRY DENSITY AS DETERMINED BY THE AASHTO T-180 (D-1557) METHOD OF COMPACTION. LIFTS SHOULD BE PLACED PER GEOTECHNICAL RECOMMENDATIONS BUT SHOULD NOT EXCEED 8" IN LOOSE THICKNESS.
  3. REMOVE SURFACE VEGETATION AND OTHER DELETERIOUS MATERIALS OVER THE ENTIRE SITE IN PREPARATION OF PROPOSED IMPROVEMENTS.

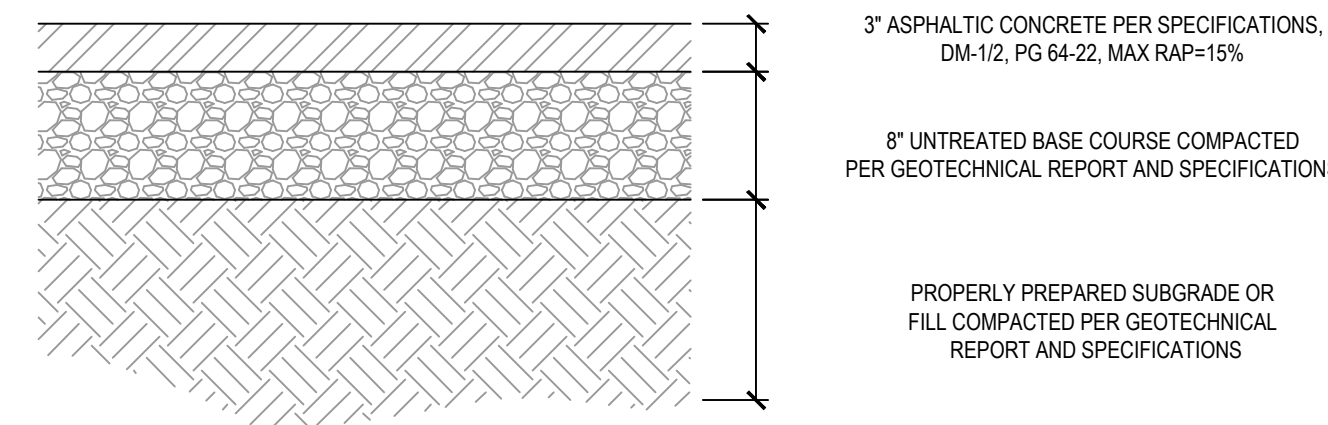

**4 TEMPORARY SILT FENCE** SCALE: NONE

- CONCRETE NOTES**
1. ALL PAVING TO BE PLACED OVER PROPERLY PREPARED NATURAL SOILS AND/OR PROPERLY PREPARED EXISTING FILL SOILS AND PROPERLY COMPACTED STRUCTURAL FILL WHERE SPECIFIED.
  2. ALL STRUCTURAL FILL TO BE PLACED AND COMPACTED PER THE PROJECT GEOTECHNICAL REPORT OR TO A MINIMUM OF 95% OF THE MAXIMUM DRY DENSITY AS DETERMINED BY THE AASHTO T-180 (D-1557) METHOD OF COMPACTION. LIFTS SHOULD BE PLACED PER GEOTECHNICAL RECOMMENDATIONS BUT SHOULD NOT EXCEED 8" IN LOOSE THICKNESS.
  3. REMOVE SURFACE VEGETATION AND OTHER DELETERIOUS MATERIALS OVER THE ENTIRE SITE IN PREPARATION OF PROPOSED IMPROVEMENTS.

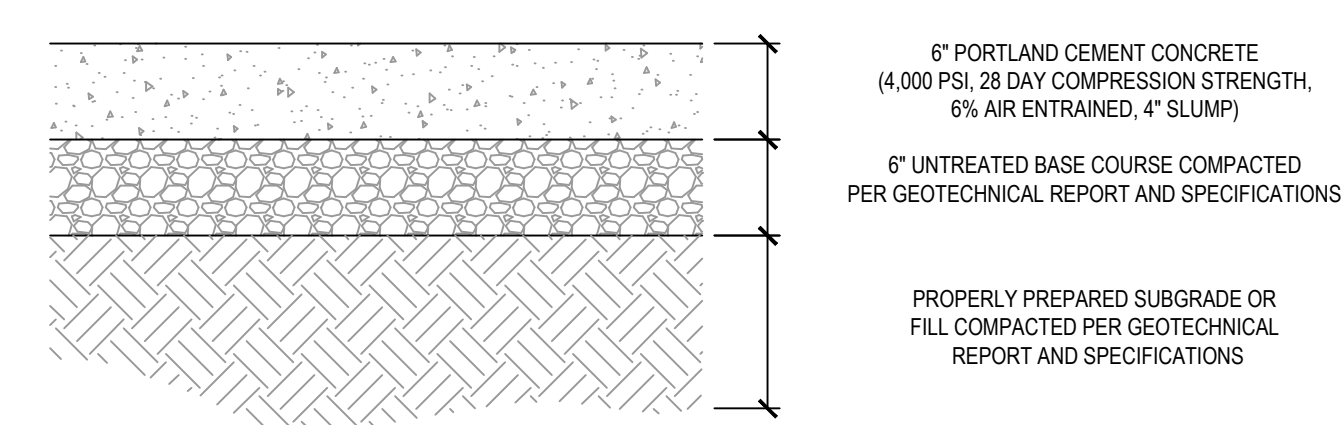

**5 TEMPORARY BASIN OUTLET PROTECTION** SCALE: NONE

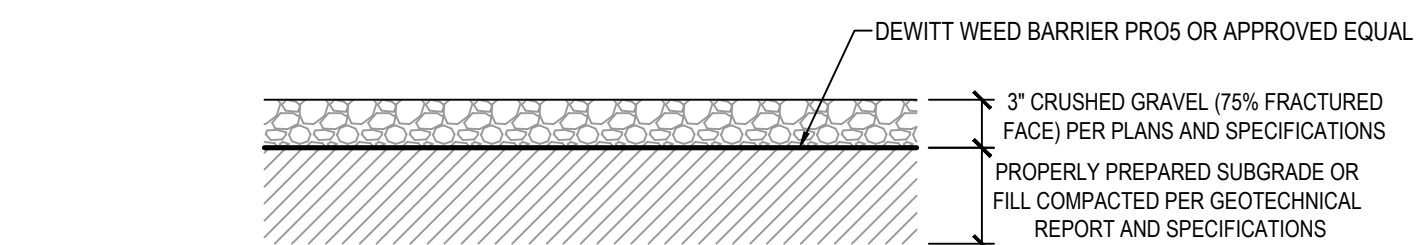

**6 CONCRETE SIDEWALK** SCALE: NONE

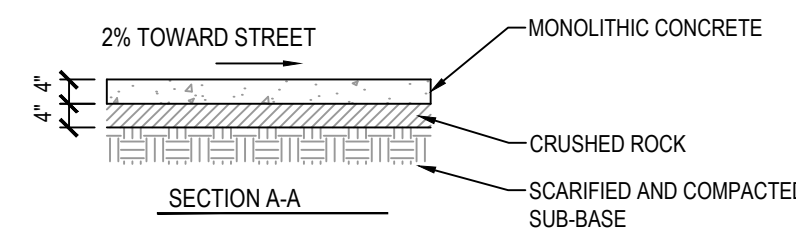

**7 STANDARD ASPHALT SECTION** SCALE: NONE

**9 GRAVEL SECTION** SCALE: NONE

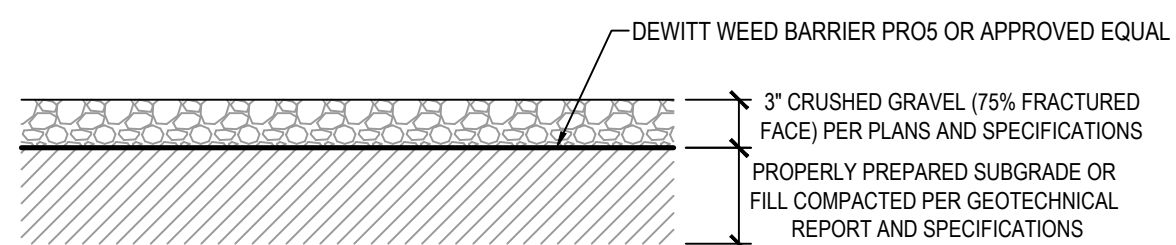

NO.	DATE	REVISION	BY
1		FOR REVIEW	
2			
3			
4			
5			
6			
7			
8			

**DETAILS**

PROJECT NUMBER: 11590  
PRINT DATE: 10/11/22

DRAWN BY: J.MOSS  
CHECKED BY: I.BUCKLEY

PROJECT MANAGER: C.PRESTON



**BENCHMARK**  
 NORTH QUARTER CORNER OF SECTION 20,  
 TOWNSHIP 6 NORTH, RANGE 3 WEST,  
 SALT LAKE BASE AND MERIDIAN  
 ELEV = 4220.00'



LAYTON  
 919 North 400 West  
 Layton, UT 84041  
 Phone: 801.547.1100

SALT LAKE CITY  
 Phone: 801.255.0529

TOOELE  
 Phone: 435.843.3590

CEDAR CITY  
 Phone: 435.865.1453

RICHFIELD  
 Phone: 435.896.2983

Qty	Symbol	Common Name	Scientific Name	Plant Size
9	◡	Cinquefoil	Potentilla fruticosa 'Abbottswood'	5 Gallon
9	⊙	Barberry, Crimson Pygmy	Berberis thunbergii atropurpurea nana	5 Gallon
9	☼	Pine, Mugo	Pinus mugo 'Compacta'	5 Gallon
9	⊙	Blue Oat Grass	Helictotrichon sempervirens	5 Gallon

**WWW.ENSIGNENG.COM**

FOR:  
 KHR HOLDINGS, LLC  
 8488 STATE STREET  
 MIDVALE, UTAH 84047

CONTACT:  
 RYAN BROWN  
 PHONE: 801-514-6406

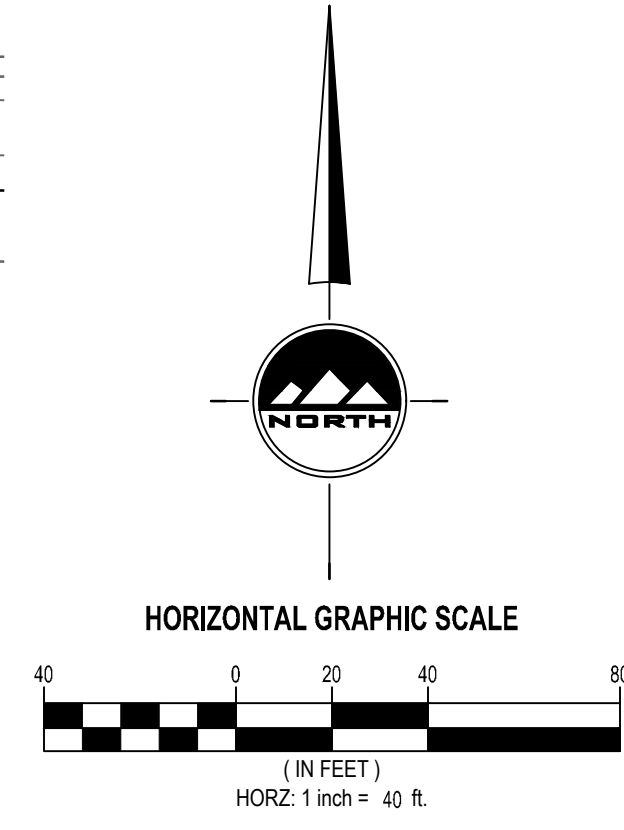
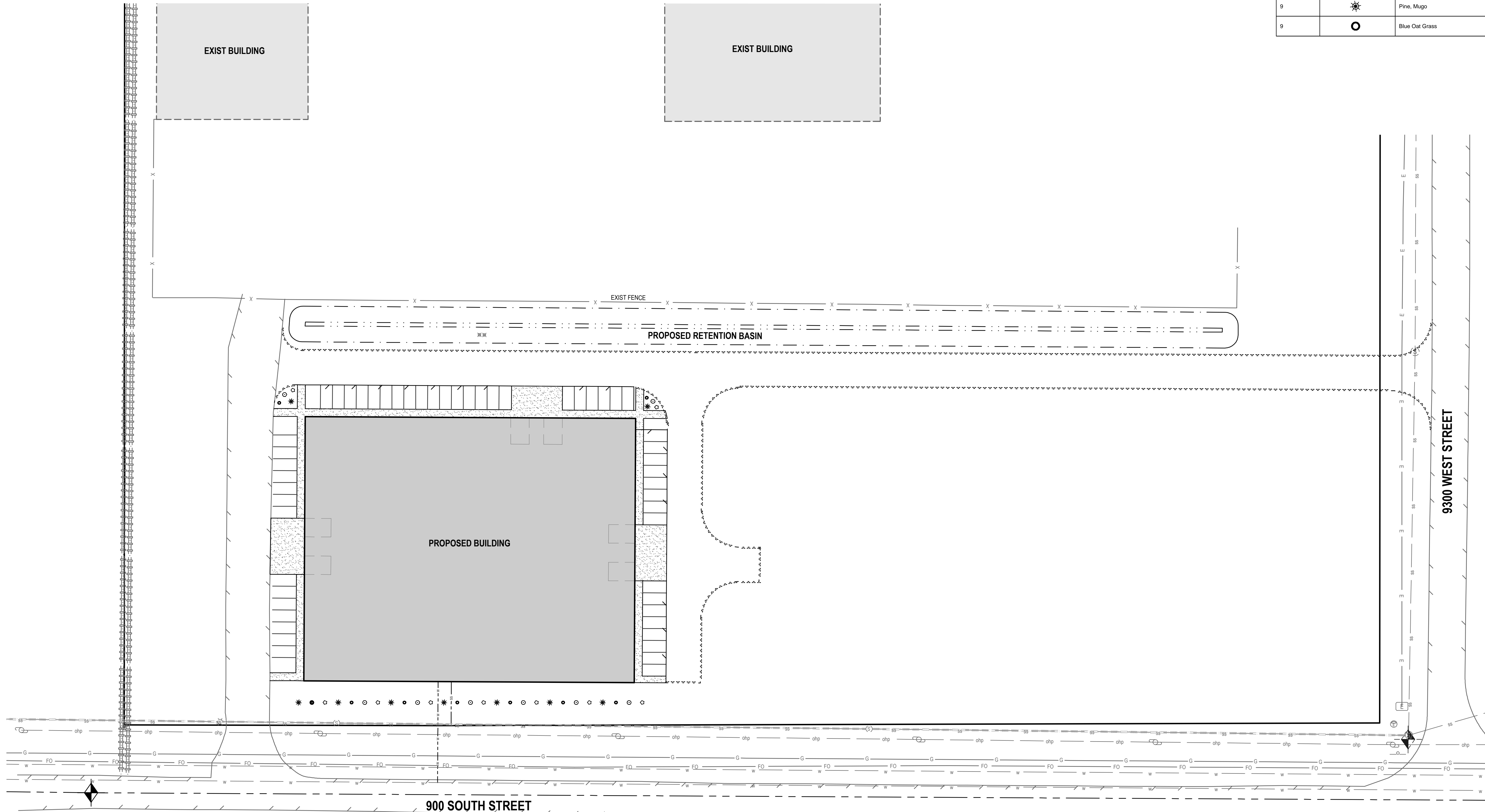

**KHR SITE DEVELOPMENT**

**9350 WEST 791 SOUTH**

**WEST WEBER COUNTY, UTAH**

NO.	DATE	REVISION	BY
1		FOR REVIEW	
2			
3			
4			
5			
6			
7			
8			

**LANDSCAPE PLAN**

PROJECT NUMBER 11590	PRINT DATE 10/11/22
DRAWN BY J.MOSS	CHECKED BY I.BUCKLEY
PROJECT MANAGER C.PRESTON	

**L-100**