

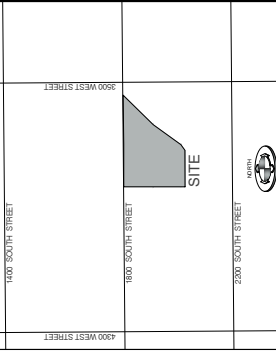

# WINSTON PARK SUBDIVISION

LOCATED IN THE NORTHEAST QUARTER OF SECTION 28,  
TOWNSHIP 6 NORTH, RANGE 2 WEST,  
SALINE COUNTY, ILLINOIS  
WEBER COUNTY, UTAH

2021



CURVE #	LENGTH	RADIUS	DELTA	CHORD BEARING	CHORD DISTANCE
C1	77.39	10.00	90.0000	N71.1457 W	76.72
C2	31.42	20.00	90.0000	S45.4652 W	29.38
C3	31.42	20.00	90.0000	S45.4652 W	29.38
C4	23.95	15.00	90.0000	S44.1036 E	21.21
C5	13.00	10.00	90.0000	N64.4037 E	13.14
C6	70.24	60.00	97.9377	S72.2924 W	66.03
C7	64.62	60.00	89.0000	N39.2927 W	61.39
C8	69.97	60.00	89.2927	N20.2914 E	65.31
C9	82.05	60.00	81.9330	S78.9449 E	75.79
C10	13.00	10.00	90.0000	N64.4037 E	13.14
C11	23.95	15.00	90.0000	S45.4652 W	21.21
C12	287.38	90.00	283.9313	N00.4432 E	271.51
C13	23.95	15.00	90.0000	S44.1036 E	21.21
C14	13.00	10.00	90.0000	N64.4037 E	13.14
C15	64.62	60.00	89.0000	S39.2927 W	61.44
C16	69.97	60.00	89.2927	N20.2914 E	65.12
C17	71.33	60.00	89.7000	N19.2926 E	67.20
C18	24.98	60.00	27.8820	N01.2911 E	24.41
C19	13.91	10.00	90.0000	S45.4652 W	13.42
C20	24.81	10.00	84.6830	S27.2147 E	22.08
C21	40.47	200.00	117.9542	N65.5709 W	40.41
C22	63.73	160.00	267.4544	N76.1149 W	63.18
C23	23.97	15.00	90.0000	S44.1036 E	21.22
C24	28.96	10.00	89.0000	S44.1036 E	27.31
C25	18.52	10.00	70.2414	N20.2924 E	17.27
C26	28.01	10.00	109.1610	N43.6247 W	24.47
C27	23.95	15.00	90.0000	S45.4652 W	21.21
C28	228.71	60.00	215.3200	N43.9647 W	114.28
C29	18.43	20.00	37.4219	S19.3001 W	18.10
C30	31.99	60.00	37.4219	S19.3001 W	31.02
C31	18.43	20.00	37.4219	S19.3001 W	18.10
C32	31.99	60.00	37.4219	S19.3001 W	31.02
C33	11.11	5.00	127.1934	S49.2923 W	9.80
C34	45.07	20.00	37.7100	S73.2637 E	44.79
C35	10.00	10.00	90.0000	N49.4432 E	9.80
C36	32.07	60.00	74.2840	N39.2917 W	49.41
C37	90.32	30.74	148.0230	S00.4432 W	66.95
C38	32.07	60.00	74.2840	N39.2917 W	49.41
C39	10.00	10.00	90.0000	N44.1036 W	9.80
C40	45.49	20.00	37.7140	S72.9802 E	44.69
C41	11.10	5.00	127.1934	S49.2918 E	9.80
C42	3.03	3.00	49.0000	S23.1650 W	3.87
C43	48.69	60.00	49.0000	S08.1625 W	47.49
C44	97.39	60.00	90.0000	N44.1036 W	87.69
C45	41.67	60.74	74.2840	N37.9914 E	38.73
C46	111.12	62.74	148.0230	S00.4432 W	82.37
C47	41.67	60.00	74.2840	N37.9914 E	38.73
C48	97.39	60.00	90.0000	N44.1036 W	87.69
C49	48.62	60.00	49.9940	S09.5141 E	47.97
C50	3.02	3.00	44.0000	S21.1414 E	3.82

PARCEL LINE TABLE	LINE #	BEARING	DISTANCE
L1	S 69.9918 E	25.14	
L2	S 09.4432 W	15.28	
L3	S 09.4432 W	15.28	
L4	S 09.4432 W	15.28	
L5	S 09.4432 W	15.28	
L6	S 09.4432 W	15.28	
L7	S 09.4432 W	15.28	
L8	S 09.4432 W	15.28	
L9	S 09.4432 W	15.28	
L10	S 09.4432 W	15.28	
L11	S 09.4432 W	15.28	
L12	S 09.4432 W	15.28	
L13	S 09.4432 W	15.28	
L14	S 09.4432 W	15.28	
L15	S 09.4432 W	15.28	
L16	N 09.1036 W	15.12	
L17	S 09.1036 W	15.12	
L18	N 09.1036 W	15.12	
L19	S 09.1036 W	15.12	
L20	N 09.1036 W	15.12	
L21	S 09.1036 W	15.12	
L22	N 09.1036 W	15.12	
L23	S 09.1036 W	15.12	
L24	N 09.1036 W	15.12	
L25	S 09.1036 W	15.12	
L26	N 09.1036 W	15.12	
L27	S 09.1036 W	15.12	
L28	S 09.4432 W	75.38	
L29	S 09.4432 W	90.38	
L30	S 09.4432 W	90.38	
L31	S 09.4432 W	90.38	
L32	S 09.4432 W	90.38	
L33	S 09.4432 W	90.38	
L34	S 09.4432 W	90.38	
L35	S 09.4432 W	90.38	
L36	S 09.4432 W	90.38	
L37	S 09.4432 W	90.38	
L38	S 09.4432 W	90.38	
L39	S 09.4432 W	90.38	
L40	N 09.1132 E	80.20	

PARCEL LINE TABLE	LINE #	BEARING	DISTANCE
L41	N 62.0133 E	83.34	
L42	S 30.4111 E	45.77	
L43	S 09.1036 W	15.12	
L44	S 09.1036 W	15.12	
L45	S 09.1036 W	15.12	
L46	S 09.1036 W	15.12	
L47	S 09.1036 W	15.12	
L48	S 09.1036 W	15.12	
L49	S 09.1036 W	15.12	
L50	S 09.1036 W	15.12	
L51	S 09.1036 W	15.12	
L52	S 09.1036 W	15.12	
L53	S 09.1036 W	15.12	
L54	S 09.1036 W	15.12	
L55	S 09.1036 W	15.12	
L56	S 09.1036 W	15.12	
L57	S 09.1036 W	15.12	
L58	S 09.1036 W	15.12	
L59	S 09.1036 W	15.12	
L60	S 09.1036 W	15.12	
L61	S 09.1036 W	15.12	
L62	S 09.1036 W	15.12	
L63	S 09.1036 W	15.12	
L64	S 09.1036 W	15.12	
L65	S 09.1036 W	15.12	
L66	S 09.1036 W	15.12	
L67	S 09.1036 W	15.12	
L68	S 09.1036 W	15.12	
L69	S 09.1036 W	15.12	
L70	S 09.1036 W	15.12	
L71	S 09.1036 W	15.12	
L72	S 09.1036 W	15.12	
L73	S 09.1036 W	15.12	
L74	S 09.1036 W	15.12	
L75	S 09.1036 W	15.12	
L76	S 09.1036 W	15.12	
L77	S 09.1036 W	15.12	
L78	S 09.1036 W	15.12	
L79	S 09.1036 W	15.12	
L80	S 09.1036 W	15.12	
L81	S 09.1036 W	15.12	
L82	S 09.1036 W	15.12	

PARCEL LINE TABLE	LINE #	BEARING	DISTANCE
L83	S 09.1412 E	81.27	
L84	N 09.4548 E	10.81	
L85	S 09.1412 E	81.27	
L86	S 09.4548 W	15.00	
L87	S 09.1412 E	81.27	
L88	N 09.4548 E	10.81	
L89	S 09.1412 E	81.27	
L90	S 09.4548 W	15.00	
L91	S 09.1412 E	81.27	
L92	S 09.4548 W	15.00	
L93	S 09.4432 W	90.71	
L94	N 09.1508 W	123.69	
L95	S 09.4432 W	105.74	
L96	S 09.1412 E	105.74	
L97	S 09.1412 E	105.74	
L98	S 09.4432 W	105.74	
L99	S 09.1412 E	105.74	
L100	S 09.4432 W	105.74	
L101	S 09.1412 E	105.74	
L102	S 09.4432 W	105.74	
L103	S 09.1412 E	105.74	
L104	S 09.4432 W	105.74	
L105	S 09.1412 E	105.74	
L106	S 09.4432 W	105.74	
L107	S 09.1412 E	105.74	
L108	S 09.4432 W	105.74	
L109	S 09.1412 E	105.74	
L110	S 09.4432 W	105.74	
L111	S 09.1412 E	105.74	
L112	S 09.4432 W	105.74	
L113	S 09.1412 E	105.74	
L114	S 09.4432 W	105.74	
L115	S 09.1412 E	105.74	
L116	S 09.4432 W	105.74	
L117	S 09.1412 E	105.74	
L118	S 09.4432 W	105.74	
L119	S 09.1412 E	105.74	
L120	S 09.4432 W	105.74	
L121	S 09.1412 E	105.74	
L122	S 09.4432 W	105.74	

PARCEL LINE TABLE	LINE #	BEARING	DISTANCE
L123	S 00.7133 W	10.00	
L124	S 00.7133 W	17.40	
L125	N 20.7925 W	24.19	
L126	N 00.4432 E	36.47	
L127	N 00.4432 E	36.47	
L128	S 89.1036 W	29.47	
L129	S 44.8914 E	21.6	
L130	S 49.2736 E	179.60	
L131	N 09.4432 E	124.89	
L132	S 09.4432 W	120.18	
L133	N 09.1036 W	30.00	
L134	S 89.4649 E	30.00	
L135	S 89.4649 E	30.00	
L136	N 40.9134 E	300.98	
L137	N 09.4432 E	361.12	

LOT ADDRESS	LOT ADDRESS
101 3769 W / 1811 S.	101 1825 S.
102 3769 W / 1811 S.	102 1825 S.
103 1841 S.	103 1841 S.
104 1857 S.	104 1857 S.
105 1871 S.	105 1871 S.
106 1885 S.	106 1885 S.
107 1901 S.	107 1901 S.
108 1915 S.	108 1915 S.
109 1931 S.	109 1931 S.
110 1947 S.	110 1947 S.
111 1961 S.	111 1961 S.
112 1977 S.	112 1977 S.
113 1991 S.	113 1991 S.
114 1985 S. / 3761 W.	114 1985 S. / 3761 W.
115 3749 W.	115 3749 W.
116 3725 W.	116 3725 W.
117 3725 W.	117 3725 W.
118 3711 W.	118 3711 W.
119 3701 W.	119 3701 W.
120 3687 W.	120 3687 W.
121 3673 W.	121 3673 W.
122 1957 S. / 3685 W.	122 1957 S. / 3685 W.
123 3702 W.	123 3702 W.
124 3722 W.	124 3722 W.
125 3738 W.	125 3738 W.
126 3758 W. / 1958 S.	126 3758 W. / 1958 S.
127 1942 S.	127 1942 S.
128 1927 S. / 3759 W.	128 1927 S. / 3759 W.
129 3741 W.	129 3741 W.
130 3723 W.	130 3723 W.
131 3705 W.	131 3705 W.
132 3689 W.	132 3689 W.
133 3682 W. / 1958 S.	133 3682 W. / 1958 S.
134 1942 S.	134 1942 S.
135 1926 S.	135 1926 S.
136 1926 S.	136 1926 S.



WEBER COUNTY RECORDER  
ENTRY NO. \_\_\_\_\_  
FILED FOR RECORD AND  
RECORDED \_\_\_\_\_ OF OFFICIAL RECORDS.  
PAGE \_\_\_\_\_  
RECORDED FOR \_\_\_\_\_

WEBER COUNTY RECORDER  
DEPUTY



BENCHMARK  
ENGINEERING &  
LAND SURVEYING  
PROFESSIONAL SURVEYING FIRM  
1000 WEST 1000 SOUTH  
COURT, SUITE 100  
MOUNTAIN VIEW, UTAH 84040