



Land Use Permit

Weber County Planning Commission

2380 Washington Blvd. STE 240
Ogden, UT 84401
Phone: (801) 399-8791 FAX: (801) 399-8862
webercountyutah.gov/planning

Permit Number: LUP74-2022

Permit Type: Structure
Permit Date: 03/30/2022

Applicant

Name:

Business:

Address:

, UT

Phone:

Name: Randy Hunter

Business:

Address: 3465 N Hwy 39

Huntsville, UT 84317

Phone: 8017357888

Owner

Parcel

Parcel: 230130010

Zoning: F-40 **Area:** 5017.79Sq Ft:

Address: 3465 N HWY 39 HUNTSVILLE, UT 84317

Lot(s): Segund

Subdivision: Sourdough

T - R - S - QS: 7N - 3E - 08 -

Proposal

Proposed Structure: Snow Canopy

Proposed Structure Height:

of Dwelling Units:

Off Street Parking Reqd:

Building Footprint: 300

Max Structure Height in Zone: 25

of Accessory Bldgs:

***Is Structure > 1,000 Sq. Ft?** N/A

*If True Need Certif. Statement

Permit Checklist

Access Type: Private Own Front

Greater than 4218 ft above sea level? Yes

Additional Setback Reqd. ? N/A

> 200 ft from paved Road? No

Culinary Water District:

Alternative Access File #

Wetlands/Flood Zone? N/A

Meet Zone Area Frontage? Yes

Hillside Review Reqd? No

Waste Water System:

Comments

This permit to construct a snow canopy within the Sourdough Wilderness area is granted after the plans and site plan display compliance with Weber County Planning requirements.



Land Use Permit

Structure Setback Graphic: Barn, Corral, or Stable

See additional notes in the comments section

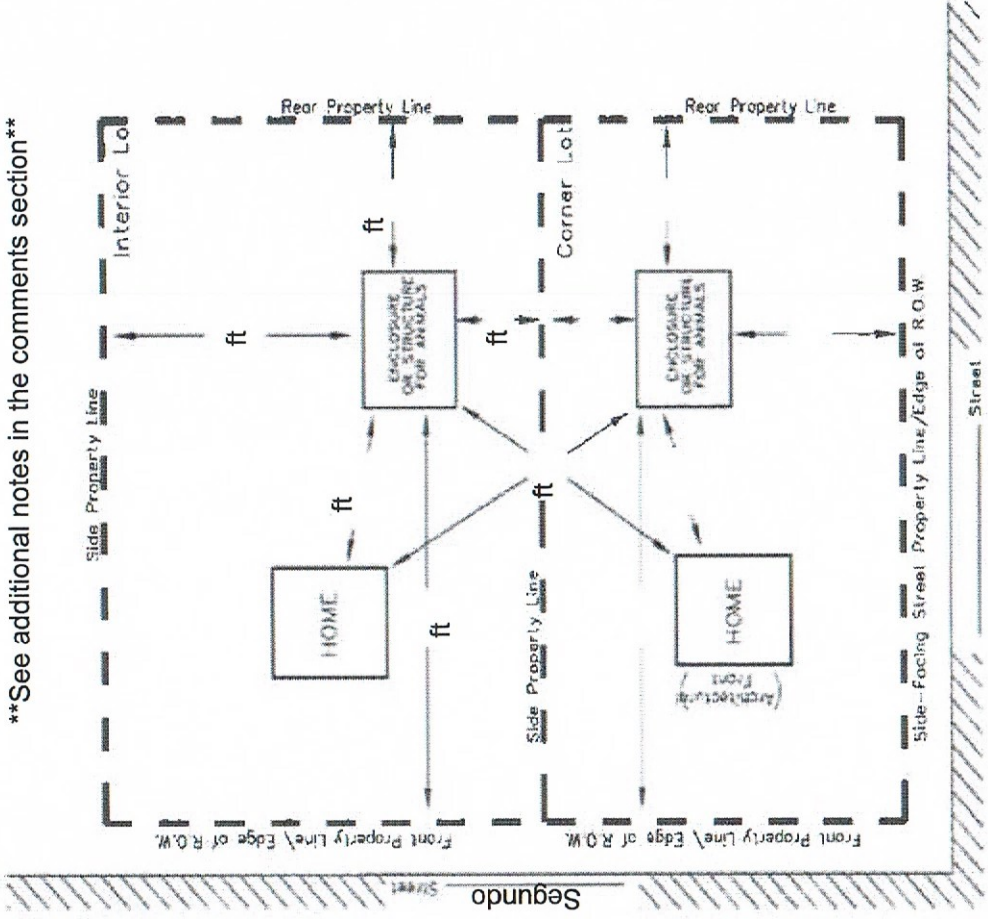

MINIMUM YARD SETBACKS Barn, Corral, or Stable

NOTICE FOR APPLICANT (Please Read Before Signing)

Proposals for the installation of an individual water supply and for a sanitary waste disposal system (septic tank) for any structure designed for human occupation must be approved by Weber County Health Department prior to installation.

Felix Lleverino

03/30/2022

Planning Dept. Signature of Approval

Date

I hereby certify that I have read and examined this application and know the same to be true and correct. All provisions of laws and ordinances governing this land use will be complied with whether specified herein or not. I make this statement under penalty of perjury.

 _____
Contractor/Owner Signature of Approval

Date

Randy Hunter

3-31-2022

Your payment is being sent. Please print this page for your records.

Payment Complete

3/31/2022 7:01:30 AM

R Hunter

Invoice #: 13813

Reference #: 14664

Date Paid: 3/31/2022 7:01:26 AM

UT

Description(s)	Amount(s)
Land use permit	60.00

Total Due: 60.00

Payment Amount: 60.00

[Print Receipt](#)

Need Help?

If you have any questions concerning your payment please contact us.

Weber County Planning
2380 Washington Blvd., Suite 240
Ogden, Ut 84401
801-399-8371

Weber County has contracted with Forte Payments for online payment processing.