

● = Garbage Cans

MEDICAL/ NO VEHICLES

ENTRANCE/ EXIT

Info/ lost & fond

BOTTLED WATER

PORTOLETS & HAND WASHING

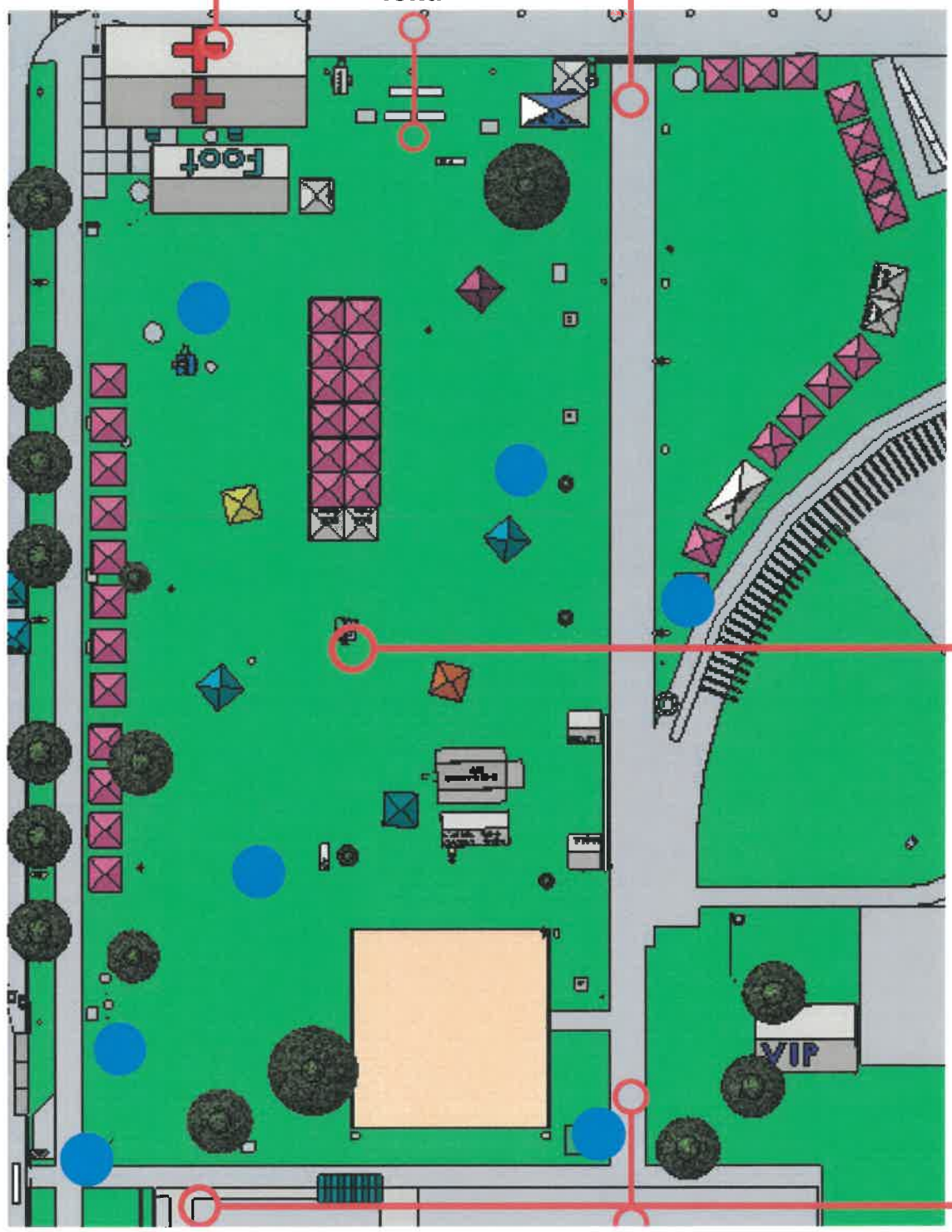

**AREA IMPACTED BY
EVENT- 25TH - 26TH,
GRANT- KEISEL AVENUE**

**2 FOOD
TRUCKS**

SIDEWALK



Parking

**PERMANENT
STRUCTURE
BATHROOMS**