

# Mad Moose Storage Room

## Top View of 30' L x 7.5' W x 9' H

South

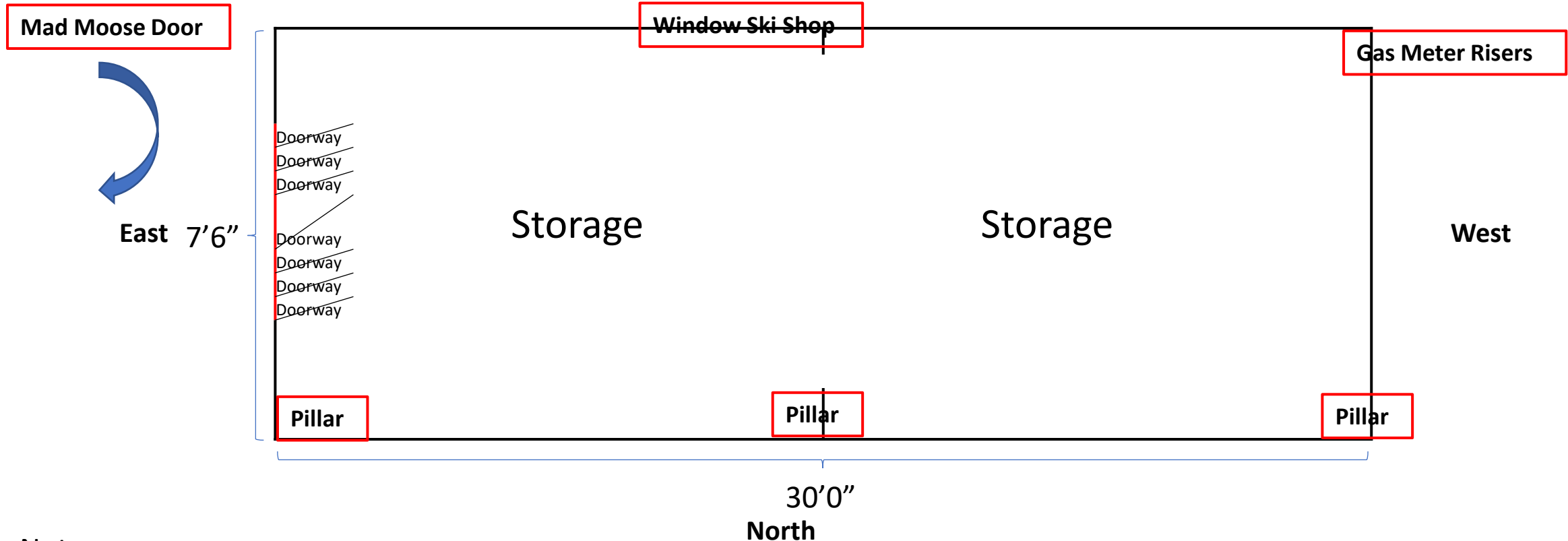

- Notes:
- Description: Open space three wall wood frame storage room to contain fridges, freezers, and shelves. Bare floor, Wide door on east side that's lockable. South wall stays in place, ceiling overhang stays in place, Mad Moose Door needs to change to open as shown by blue arrow.
  - Requires attractive wall to match existing wall décor / design, plus 8 electrical outlets to run 8 fridge freezers
  - Covers bike shop window
  - Requires movement of A/C unit, Gas Meter Risers Can Stay
  - Ventilation fan for summer, lights, may require heat in winter and sprinkler to meet code and fire marshal approval.

# Mad Moose Outdoor Storage



- Current length of space being used is 30 feet (Dry Storage and Freezer / Cooler)
- Proposal is to close in part of the porch for a walkin storage area “west” of The Mad Moose “north” door, leaving space to the east clean and empty.



Space where proposed / enclosed outdoor storage would go.

