

WINSTON PARK SUBDIVISION

LOCATED IN THE NORTHEAST QUARTER OF SECTION 28,
TOWNSHIP 6 NORTH, RANGE 2 WEST,
SALINE COUNTY, ILLINOIS
WEBER COUNTY, UTAH
2021

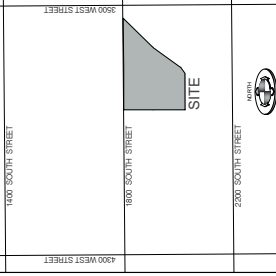

CURVE #	LENGTH	RADIUS	DELTA	CHORD BEARING	CHORD DISTANCE
C1	77.39	10.00	90.0000	N76°14'00" W	76.72
C2	31.42	20.00	90.0000	S45°46'52" W	28.38
C3	31.42	20.00	90.0000	S44°10'00" E	28.38
C4	23.96	15.00	90.0000	S44°10'00" E	21.21
C5	13.00	10.00	90.0000	N64°40'37" E	13.14
C6	70.24	60.00	99.2917	S72°20'42" W	66.03
C7	64.62	60.00	99.2917	N39°29'37" W	61.39
C8	69.97	60.00	99.2917	N20°20'14" E	65.31
C9	82.05	60.00	91.9530	S78°46'49" E	75.79
C10	13.00	10.00	90.0000	N63°16'07" E	13.14
C11	23.96	15.00	90.0000	S45°46'52" W	21.21
C12	287.38	90.00	283.9313	N00°44'32" E	271.51
C13	23.96	15.00	90.0000	S44°10'00" E	21.21
C14	13.00	10.00	90.0000	N64°40'37" E	13.14
C15	64.62	60.00	99.2917	S89°29'37" W	61.44
C16	69.97	60.00	99.2917	N39°29'37" W	65.12
C17	71.33	60.00	99.2917	N19°29'37" E	67.20
C18	24.98	60.00	237.8250	N00°15'11" E	24.41
C19	13.91	10.00	90.0000	S45°46'52" W	13.42
C20	24.81	10.00	94.6830	S27°14'47" E	22.08
C21	40.47	200.00	117.9542	N65°57'09" W	40.41
C22	63.73	160.00	267.4544	N76°11'49" W	63.18
C23	23.97	15.00	90.0000	S44°10'00" E	21.22
C24	28.96	10.00	90.0000	S44°14'42" E	27.31
C25	18.52	10.00	109.1610	N20°25'42" E	17.27
C26	28.96	10.00	90.0000	N45°26'47" W	24.47
C27	23.96	15.00	90.0000	S45°46'52" W	21.21
C28	228.71	60.00	215.3200	N48°46'47" W	114.28
C29	18.43	20.00	37.4219	S19°30'11" W	18.10
C30	31.99	40.00	37.4219	N19°30'11" E	31.02
C31	18.43	20.00	37.4219	N19°30'11" E	18.10
C32	31.99	40.00	37.4219	S49°30'11" W	31.02
C33	11.11	5.00	127.1934	S84°25'23" W	9.80
C34	45.07	20.00	37.7102	S73°26'37" E	44.79
C35	10.99	20.00	90.0000	N49°44'32" W	9.89
C36	32.07	40.00	74.2845	N39°29'31" W	49.41
C37	90.32	30.74	148.0230	S00°44'32" W	66.95
C38	32.07	40.00	74.2845	N37°50'14" E	49.41
C39	10.99	20.00	90.0000	N44°10'00" W	9.89
C40	45.49	20.00	37.7146	S72°00'02" W	44.69
C41	11.10	5.00	127.1934	S02°31'08" E	9.80
C42	3.03	5.00	49.0000	S21°10'50" W	3.87
C43	46.69	60.00	49.0000	S88°16'25" W	47.49
C44	97.39	60.00	90.0000	N44°10'00" W	67.69
C45	41.67	40.00	74.2845	N37°50'14" E	38.73
C46	11.12	62.74	148.0230	S00°44'32" W	82.37
C47	41.67	40.00	74.2845	N39°29'31" W	38.73
C48	97.39	60.00	90.0000	N44°10'00" W	67.69
C49	46.62	60.00	49.9944	S04°51'41" E	47.57
C50	3.02	5.00	44.0000	S21°11'41" E	3.82

PARCEL LINE TABLE	LINE #	BEARING	DISTANCE
L1	S 00°00'00" E	25.14	
L2	S 09°43'02" W	158.28	
L3	S 00°44'32" W	120.02	
L4	S 00°44'32" W	89.30	
L5	S 00°44'32" W	89.45	
L6	S 00°44'32" W	89.30	
L7	S 00°44'32" W	89.30	
L8	S 00°44'32" W	89.61	
L9	S 00°44'32" W	89.72	
L10	S 00°44'32" W	89.72	
L11	S 00°44'32" W	89.84	
L12	S 00°44'32" W	89.84	
L13	S 00°44'32" W	89.80	
L14	S 00°44'32" W	89.80	
L15	S 00°44'32" W	89.80	
L16	N 00°13'00" W	126.12	
L17	S 00°13'00" E	126.12	
L18	N 89°13'00" W	146.32	
L19	S 89°13'00" E	146.32	
L20	N 89°13'00" W	146.30	
L21	S 89°13'00" E	146.30	
L22	N 89°13'00" W	146.69	
L23	S 89°13'00" E	146.69	
L24	N 89°13'00" W	146.67	
L25	S 89°13'00" E	146.67	
L26	N 89°13'00" W	146.90	
L27	S 89°13'00" E	146.90	
L28	S 00°44'32" W	146.14	
L29	S 00°44'32" W	75.38	
L30	S 00°44'32" W	90.38	
L31	S 00°44'32" W	90.38	
L32	S 89°13'00" E	80.30	
L33	S 89°13'00" E	133.13	
L34	S 89°13'00" E	133.13	
L35	S 00°44'32" W	90.38	
L36	S 00°44'32" W	90.38	
L37	S 00°44'32" W	119.50	
L38	S 00°44'32" W	119.50	
L39	S 89°13'00" E	47.61	
L40	N 89°11'32" E	80.20	

PARCEL LINE TABLE	LINE #	BEARING	DISTANCE
L41	N 82°13'32" E	83.34	
L42	S 89°14'12" E	81.27	
L43	N 00°45'48" E	101.89	
L44	S 89°14'12" E	81.27	
L45	S 00°45'48" W	159.07	
L46	S 89°14'12" E	81.84	
L47	N 00°45'48" E	158.00	
L48	S 89°14'12" E	82.27	
L49	S 00°45'48" W	158.29	
L50	S 89°14'12" E	81.84	
L51	S 00°45'48" W	158.29	
L52	S 00°44'32" W	102.69	
L53	S 00°44'32" W	90.71	
L54	S 00°44'32" W	103.69	
L55	S 89°14'12" E	105.74	
L56	S 89°14'12" E	105.74	
L57	S 00°44'32" W	103.69	
L58	S 00°44'32" W	105.77	
L59	S 89°14'12" E	102.69	
L60	S 00°44'32" W	103.69	
L61	S 89°14'12" E	105.81	
L62	S 00°44'32" W	103.69	
L63	S 00°44'32" W	103.69	
L64	N 20°13'00" E	101.51	
L65	S 89°13'00" E	111.60	
L66	N 20°13'00" E	90.89	
L67	N 89°13'00" W	110.54	
L68	S 00°44'32" W	105.72	
L69	N 89°13'00" W	110.54	
L70	N 20°13'00" E	90.42	
L71	N 09°48'25" W	112.34	
L72	N 20°13'00" E	91.22	
L73	N 09°48'25" W	112.34	
L74	N 20°13'00" E	114.29	
L75	S 89°13'00" E	28.80	
L76	S 00°44'32" W	144.43	
L77	S 89°14'12" E	36.18	
L78	S 00°46'48" W	102.18	
L79	S 00°44'32" W	80.80	
L80	N 00°44'32" W	91.84	
L81	S 89°14'12" E	80.80	
L82	S 00°46'48" W	90.90	

PARCEL LINE TABLE	LINE #	BEARING	DISTANCE
L83	S 89°14'12" E	81.27	
L84	N 00°45'48" E	101.89	
L85	S 89°14'12" E	81.27	
L86	S 00°45'48" W	159.07	
L87	S 89°14'12" E	81.84	
L88	N 00°45'48" E	158.00	
L89	S 89°14'12" E	82.27	
L90	S 00°45'48" W	158.29	
L91	S 89°14'12" E	81.84	
L92	S 00°44'32" W	102.69	
L93	S 00°44'32" W	90.71	
L94	N 89°13'00" W	123.69	
L95	S 00°44'32" W	103.69	
L96	S 89°14'12" E	105.74	
L97	S 89°14'12" E	105.74	
L98	S 00°44'32" W	103.69	
L99	S 89°14'12" E	102.69	
L100	S 00°44'32" W	103.69	
L101	S 89°14'12" E	105.81	
L102	S 00°44'32" W	103.69	
L103	S 00°44'32" W	103.69	
L104	N 20°13'00" E	101.51	
L105	N 20°13'00" E	111.60	
L106	N 20°13'00" E	90.89	
L107	N 89°13'00" W	110.54	
L108	S 00°44'32" W	105.72	
L109	N 89°13'00" W	110.54	
L110	S 00°44'32" W	112.34	
L111	N 89°13'00" W	112.34	
L112	S 00°44'32" W	105.72	
L113	N 89°13'00" W	112.34	
L114	S 00°44'32" W	110.54	
L115	N 89°13'00" W	117.36	
L116	S 00°44'32" W	105.69	
L117	N 89°13'00" W	90.72	
L118	S 00°44'32" W	102.69	
L119	N 89°13'00" W	123.69	
L120	S 00°44'32" W	103.69	
L121	S 00°44'32" W	103.69	
L122	S 89°14'12" E	174.69	

PARCEL LINE TABLE	LINE #	BEARING	DISTANCE
L123	S 00°27'13" W	10.00	
L124	S 89°15'00" E	71.17	
L125	N 89°15'00" W	29.03	
L126	N 00°44'32" E	36.47	
L127	S 89°15'00" E	29.47	
L128	S 44°09'44" E	21.6	
L129	S 00°44'32" W	124.83	
L130	S 00°44'32" W	124.83	
L131	S 89°15'00" E	30.00	
L132	S 89°15'00" E	30.00	
L133	N 89°15'00" E	762.47	
L134	N 20°01'30" E	309.57	
L135	S 89°14'12" E	603.59	
L136	S 15°42'00" E	219.82	
L137	S 00°44'32" W	279.01	
L138	S 00°44'32" W	279.01	
L139	S 00°44'32" W	279.01	
L140	S 89°15'00" E	30.00	
L141	S 89°15'00" E	30.00	
L142	S 00°44'32" W	279.01	
L143	S 00°44'32" W	279.01	
L144	S 89°15'00" E	30.00	
L145	N 41°12'30" E	303.77	
L146	N 41°12'30" E	1.90	
L147	S 00°44'32" W	216.62	
L148	N 17°50'14" W	103.47	
L149	S 00°00'00" E	230.00	
L150	N 00°00'00" E	97.07	
L151	S 00°00'00" E	194.64	
L152	S 00°00'00" E	194.64	
L153	N 00°00'00" W	7.90	
L154	N 00°00'00" W	7.90	
L155	S 00°00'00" E	160.79	
L156	N 89°15'00" W	166.49	
L157	N 89°15'00" W	166.49	
L158	N 00°00'00" E	49.30	
L159	N 00°00'00" E	208.89	
L160	N 17°50'14" W	103.69	
L161	S 00°44'32" W	213.59	
L162	S 00°44'32" W	442.91	
L163	N 00°44'32" W	442.91	
L164	N 89°27'11" E	790.11	
L165	N 89°15'00" W	294.47	
L166	S 00°44'32" W	294.47	
L167	S 00°44'32" W	324.27	

PARCEL LINE TABLE	LINE #	BEARING	DISTANCE
L168	S 89°15'00" E	29.03	
L169	S 45°46'52" W	71.17	
L170	N 89°15'00" W	29.03	
L171	N 00°44'32" E	36.47	
L172	N 00°44'32" E	36.47	
L173	S 89°15'00" E	29.47	
L174	S 44°09'44" E	21.6	
L175	S 00°44'32" W	124.83	
L176	S 00°44'32" W	124.83	
L177	S 89°15'00" E	30.00	
L178	S 89°15'00" E	30.00	
L179	S 00°44'32" W	722.22	
L180	S 89°14'12" E	103.69	
L181	S 89°14'12" E	103.69	
L182	S 00°44'32" W	29.47	
L183	S 00°44'32" W	120.18	

LOT ADDRESS	LOT ADDRESS
101 3769 W / 1811 S.	101 1825 S.
102 1825 S.	102 1841 S.
103 1841 S.	103 1841 S.
104 1841 S.	104 1855 S.
105 1855 S.	105 1871 S.
106 1871 S.	106 1885 S.
107 1885 S.	107 1901 S.
108 1901 S.	108 1915 S.
109 1915 S.	109 1931 S.
110 1931 S.	110 1947 S.
111 1947 S.	111 1961 S.
112 1961 S.	112 1977 S.
113 1977 S.	113 1991 S.
114 1991 S.	114 1991 S.
115 1991 S.	115 1991 S.
116 1991 S.	116 1991 S.
117 1991 S.	117 1991 S.
118 1991 S.	118 1991 S.
119 1991 S.	119 1991 S.
120 1991 S.	120 1991 S.
121 1991 S.	121 1991 S.
122 1991 S.	122 1991 S.
123 1991 S.	123 1991 S.
124 1991 S.	124 1991 S.
125 1991 S.	125 1991 S.
126 1991 S.	126 1991 S.
127 1991 S.	127 1991 S.
128 1991 S.	128 1