

Legend

(Note: All items may not appear on drawing)

- San. Sewer Manhole
- Water Manhole
- Storm Drain Manhole
- Cleanout
- Electrical Manhole
- Catch Basins
- Exist. Fire Hydrant
- Fire Hydrant
- Exist. Water Valve
- Water Valve
- Sanitary Sewer
- Culinary Water
- Gas Line
- Irrigation Line
- Storm Drain
- Telephone Line
- Secondary Waterline
- Power Line
- Fire Line
- Land Drain
- Power pole
- Power pole w/guy
- Light Pole
- Fence
- Flowline of ditch
- Overhead Power line
- Corrugated Metal Pipe
- Concrete Pipe
- Reinforced Concrete Pipe
- Ductile Iron
- Polyvinyl Chloride
- Top of Asphalt
- Edge of Asphalt
- Centerline
- Flowline
- Finish Floor
- Top of Curb
- Top of Wall
- Top of Walk
- Top of Concrete
- Natural Ground
- Finish Grade
- Match Existing
- Fire Department Connection
- Finish Contour
- Exist. Contour
- Finish Grade
- Exist. Grade
- Ridge Line
- Existing Asphalt
- New Asphalt
- Heavy Duty Asphalt
- Existing Concrete
- New Concrete
- Spill Curb & Gutter

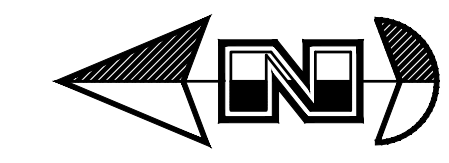

Scale:
1" = 40' Horiz.
1" = 4' Vertical

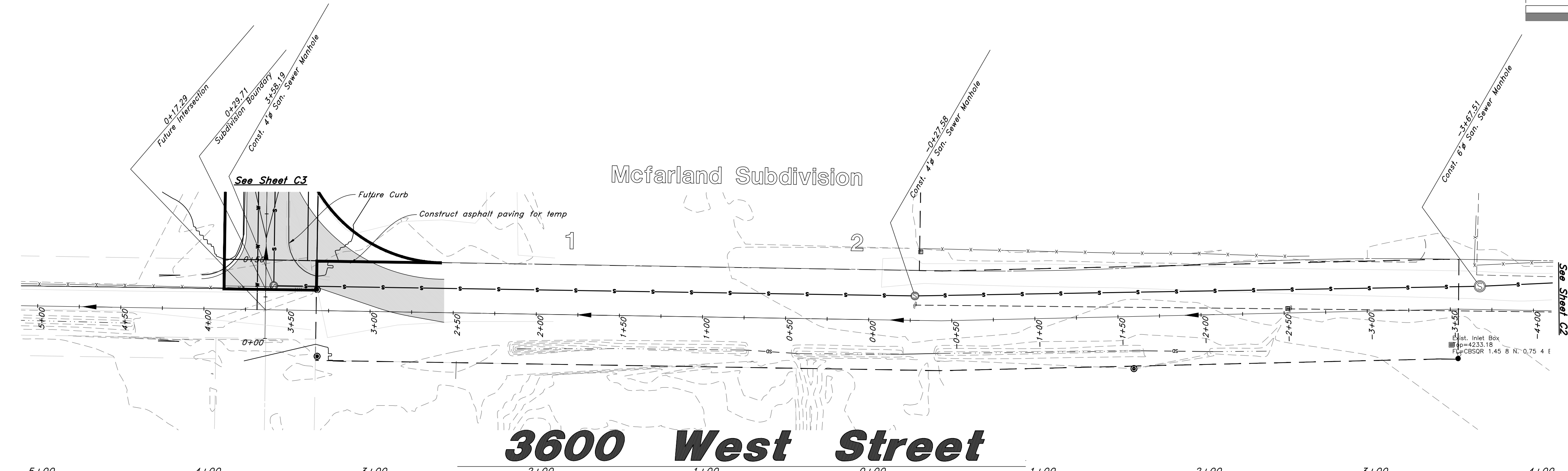
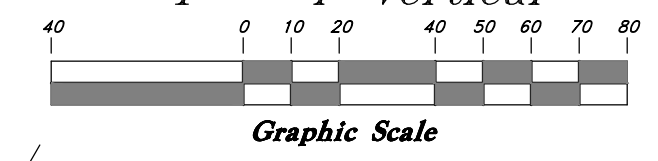

TENTATIVE FINAL



GREAT BASIN ENGINEERING
 574 EAST 1475 SOUTH, SUITE 100, SALT LAKE CITY, UT 84143
 WWW.GREATBASINENGINEERING.COM

Plan & Profile
Terakee Farm PRUD No. 1
 Approximately 1000 North 3600 West
 Weber County, Utah
 A part of Section 9, T6N, R2W, SLB&M, U.S. Survey

10 Nov, 2021
 SHEET NO.
C1
 of 7
 16N704 - AM-1

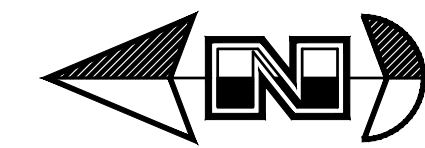

Scale:
 1" = 40' Horiz.
 1" = 4' Vertical

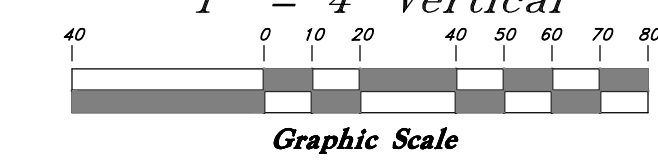

Legend

(Note: All items may not appear on drawing)

- San. Sewer Manhole
- Water Manhole
- Storm Drain Manhole
- Cleanout
- Electrical Manhole
- Catch Basins
- Exist. Fire Hydrant
- Fire Hydrant
- Exist. Water Valve
- Water Valve
- Sanitary Sewer
- Culinary Water
- Gas Line
- Irrigation Line
- Storm Drain
- Telephone Line
- Secondary Waterline
- Power Line
- Fire Line
- Land Drain
- Power pole
- Power pole w/guy
- Light Pole
- Fence
- Flowline of ditch
- Overhead Power line
- Corrugated Metal Pipe
- Concrete Pipe
- Reinforced Concrete Pipe
- Ductile Iron
- Polyvinyl Chloride
- Top of Asphalt
- Edge of Asphalt
- Centerline
- Flowline
- Finish Floor
- Top of Curb
- Top of Wall
- Top of Walk
- Top of Concrete
- Natural Ground
- Finish Grade
- Match Existing
- Fire Department Connection
- Exist. Contour
- Finish Grade
- Finish Contour
- Exist. Grade
- Ridge Line

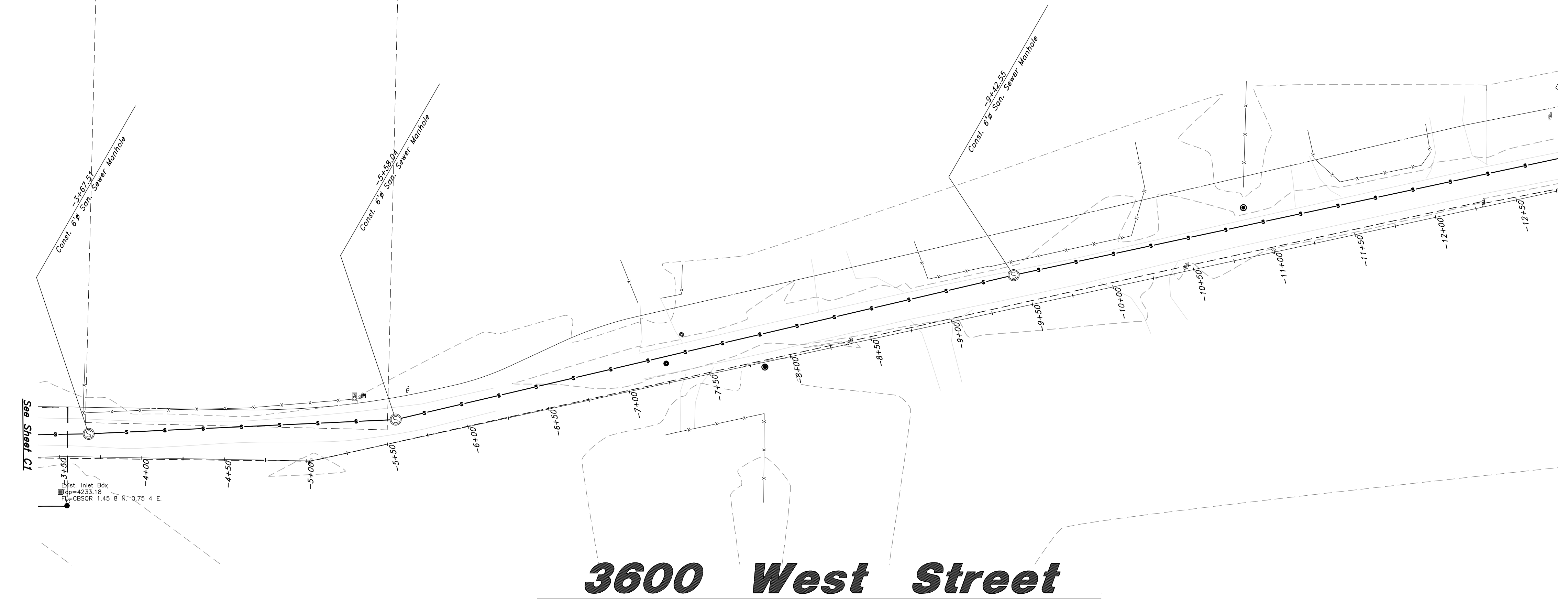

3600 West Street

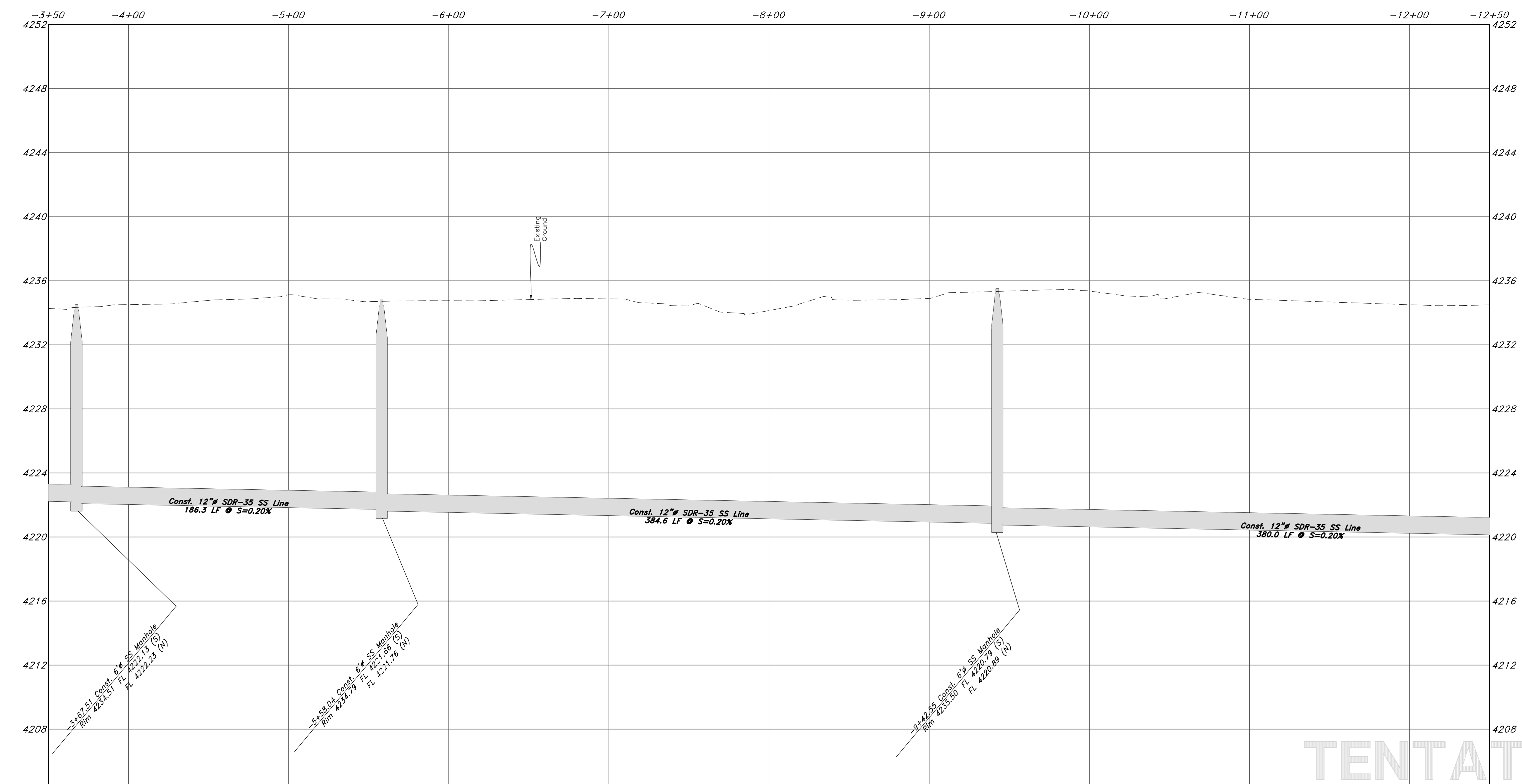

TENTATIVE FINAL



GREAT BASIN ENGINEERING
 574 SOUTH 1475 EAST, SUITE 100, OGDEN, UTAH 84403
 WWW.GREATBASINENGINEERING.COM

Plan & Profile
Terakee Farm PRUD No. 1
 Approximately 1000 North 3600 West
 Weber County, Utah
 A part of Section 9, T6N, R2W, SLB&M, U.S. Survey

10 Nov, 2021
 SHEET NO.
G2
 of 7
 16N704 - AM-1

Legend

(Note: All items may not appear on drawing)

- San. Sewer Manhole
- Water Manhole
- Storm Drain Manhole
- Cleanout
- Electrical Manhole
- Catch Basins
- Exist. Fire Hydrant
- Fire Hydrant
- Exist. Water Valve
- Water Valve
- Sanitary Sewer
- Culinary Water
- Gas Line
- Irrigation Line
- Storm Drain
- Telephone Line
- Secondary Waterline
- Power Line
- Fire Line
- Land Drain
- Power pole
- Power pole w/guy
- Light Pole
- Fence
- Flowline of ditch
- Overhead Power line
- Corrugated Metal Pipe
- Concrete Pipe
- Reinforced Concrete Pipe
- Ductile Iron
- Polyvinyl Chloride
- Top of Asphalt
- Edge of Asphalt
- Centerline
- Flowline
- Finish Floor
- Top of Curb
- Top of Wall
- Top of Walk
- Top of Concrete
- Natural Ground
- Finish Grade
- Match Existing
- Fire Department Connection
- Finish Contour
- Exist. Contour
- Finish Grade
- Exist. Grade
- Ridge Line
- Existing Asphalt
- New Asphalt
- Heavy Duty Asphalt
- Existing Concrete
- New Concrete
- Spill Curb & Gutter

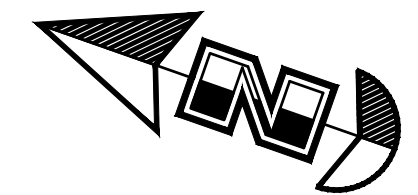

Scale:
 1" = 40' Horiz.
 1" = 4' Vertical

Graphic Scale

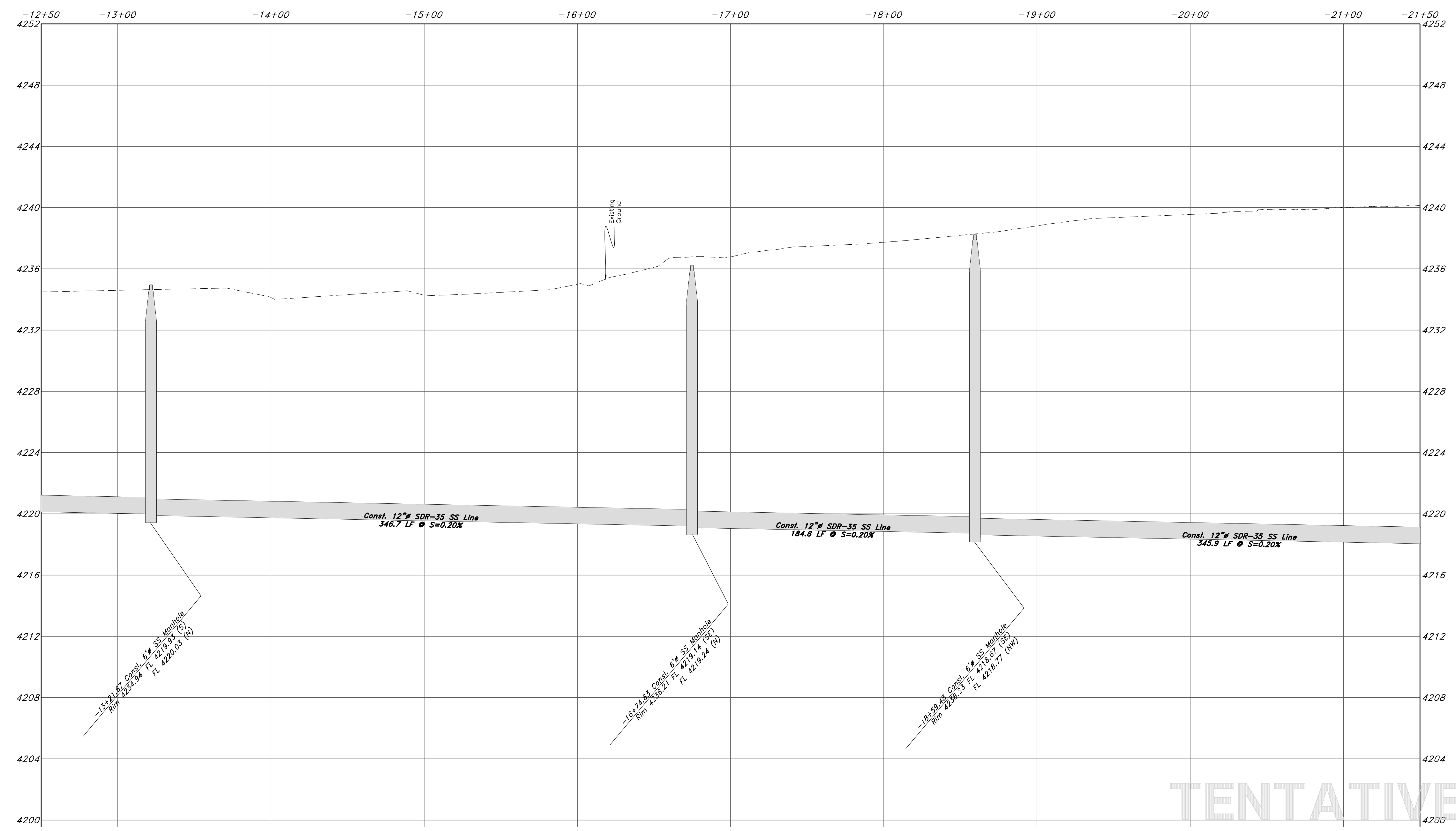

REV	DATE	DESCRIPTION

GREAT BASIN ENGINEERING

574 EAST 1475 SOUTH, SUITE 100, SALT LAKE CITY, UTAH 84143
 WWW.GREATBASINENGINEERING.COM

Plan & Profile

Terakee Farm PRUD No. 1

Approximately 1000 North 3600 West
 Weber County, Utah
 A part of Section 9, T6N, R2W, SLB&M, U.S. Survey

10 Nov, 2021

SHEET NO.

C3

of 7

16N704 - AM-1



TENTATIVE FINAL

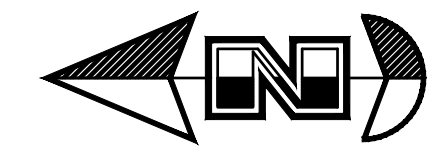

Scale:
 1" = 40' Horiz.
 1" = 4' Vertical

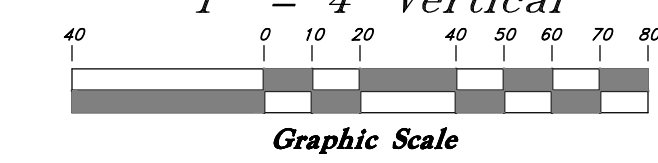

3600 West Street

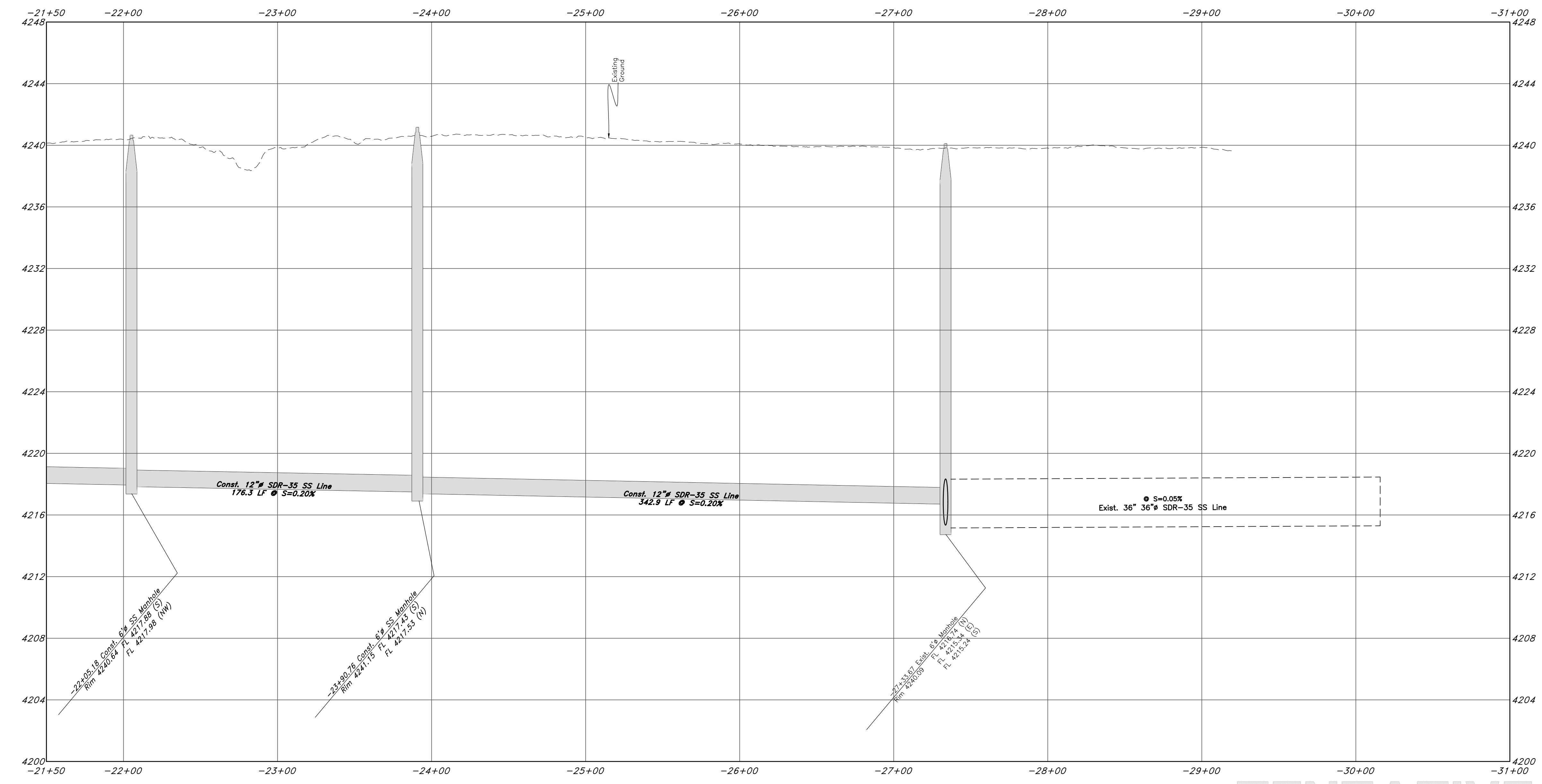

REV	DATE	DESCRIPTION

GREAT BASIN ENGINEERING

574 SOUTH 1475 EAST, SUITE 100, OGDEN, UTAH 84403
 435 734-4455 FAX (801) 392-7544
 WWW.GREATBASINENGINEERING.COM

Plan & Profile

Terakee Farm PRUD No. 1

Approximately 1000 North 3600 West
 Weber County, Utah
 A part of Section 9, T6N, R2W, SLB&M, U.S. Survey

10 Nov, 2021

SHEET NO.

C4 of 7

16N704 - AM-1



TENTATIVE FINAL