

BOUNDARY DESCRIPTION
 ALL OF LOT 3 AND LOT 2, SUN DANCE RIDGE SUBDIVISION, WEBER COUNTY UTAH.

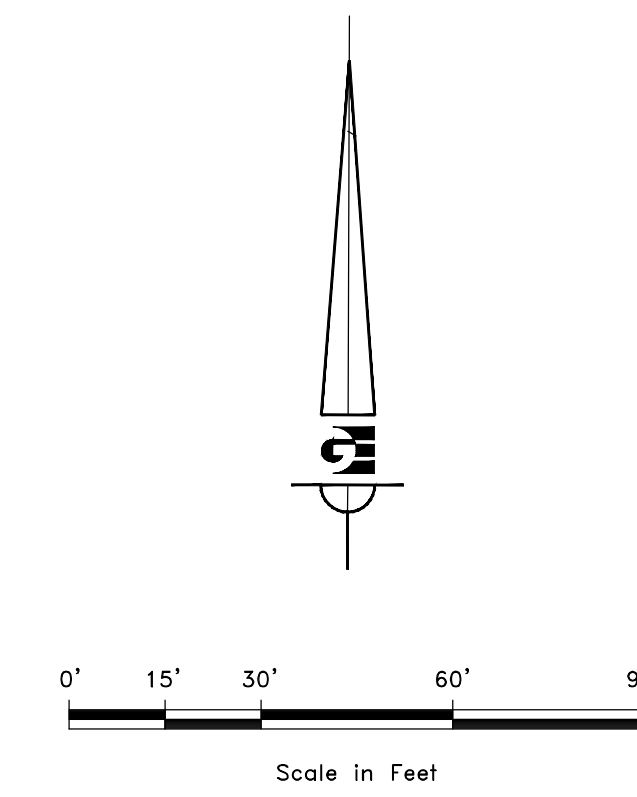
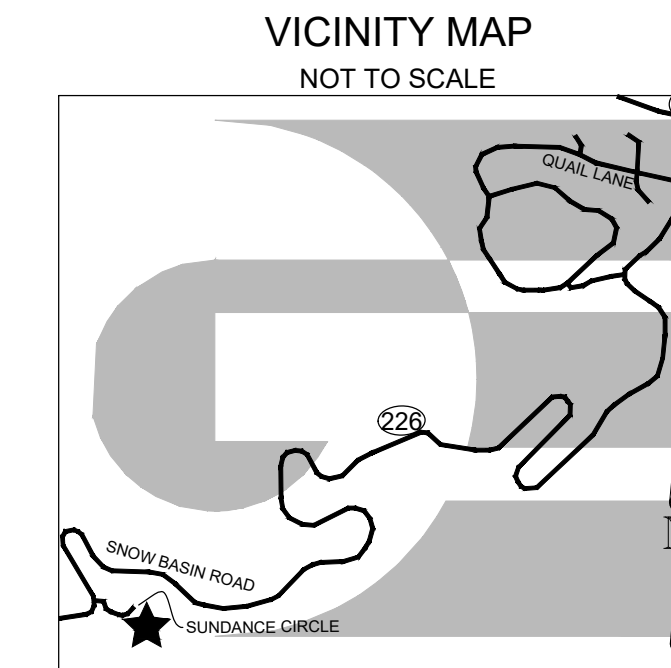

LEGEND

- STREET CENTERLINE MONUMENT
- SET 24" REBAR AND CAP
- MARKED GARDNER ENGINEERING
- SUBJECT PROPERTY BOUNDARY
- ADJACENT PARCEL
- SECTION LINE
- EASEMENT

- NOTES**
1. SITE BENCHMARK IS SET BY A CAP AND REBAR SET BY MOUNTAIN WEST WITH AN ELEVATION OF 5763.27'
 2. VERTICAL DATUM: NAVD 88
 3. UTILITIES WERE DETERMINED BY FIELD MEASUREMENTS AND PLANS.
 4. SETBACKS ARE DETERMINED BY SUN DANCE RIDGE SUBDIVISION PLAT.



REVISIONS	DESCRIPTION
DATE	

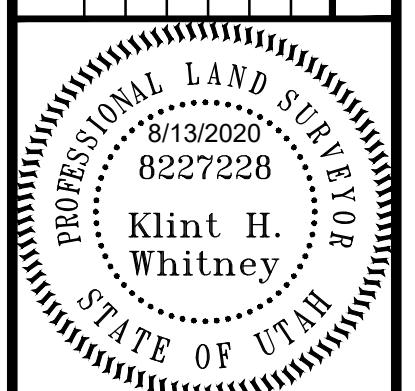

PROPERTY SURVEY FOR WYATT BURTON
 5605 E 1700 S HUNTSVILLE, UTAH
 LOCATED IN THE SOUTHWEST QUARTER OF SECTION 23,
 TOWNSHIP 6 NORTH, RANGE 1 EAST, S.L.B. AND M.

GARDNER ENGINEERING
 CIVIL - LAND PLANNING
 MUNICIPAL - LAND SURVEYING
 5150 SOUTH 375 EAST OGDEN, UT
 OFFICE: 801.476.0202 FAX: 801.476.0066