



Land Use Permit

Weber County Planning Commission

2380 Washington Blvd. STE 240
Ogden, UT 84401
Phone: (801) 399-8791 FAX: (801) 399-8862
webercountyutah.gov/planning

Permit Number: LUP83-2021

Permit Type: Structure
Permit Date: 03/22/2021

Applicant

Name: Craig Brown
Business:
Address: 3465 N Hwy 39 (Lot 69 Bullmoose)
Huntsville, UT 84317
Phone: 435-279-3277

Owner

Name: Same as Applicant
Business:
Address: , UT
Phone:

Parcel

Parcel: 230130010
Zoning: F-40 **Area:** 5017.79 **Sq Ft:** **Lot(s):** 69 Bullmoose **Subdivision:** Sourdough Wilderness Ranch
Address: 3465 N HWY 39 HUNTSVILLE, UT 84317 **T - R - S - QS:** 7N - 3E - 08 - NW

Proposal

Proposed Structure: Storage Shed **Building Footprint:** 100
Proposed Structure Height: 15 **Max Structure Height in Zone:** 25
of Dwelling Units: 0 **# of Accessory Bldgs:** 1
Off Street Parking Req'd: 0 ***Is Structure > 1,000 Sq. Ft?** No
***If True Need Certif. Statement**

Permit Checklist

Access Type: Wilderness Rd off Sourdough Meadows **Alternative Access File #** NA
Greater than 4218 ft above sea level? Yes **Wetlands/Flood Zone?** No
Additional Setback Req'd. ? No **Meet Zone Area Frontage?** Yes
> 200 ft from paved Road? Yes **Hillside Review Req'd?** No N/A
Culinary Water District: N/A **Waste Water System:** N/A

Comments

This land use permit is for a 100 sq. ft. storage shed to be placed on Lot 69 of the Bullmoose Area within Sourdough Wilderness Ranch. The entirety of the structure must remain within the Lot 69 footprint.

Land Use Permit

Structure Setback Graphic: Storage Shed, Detached Garage, Etc.

****See additional notes in the comments section****

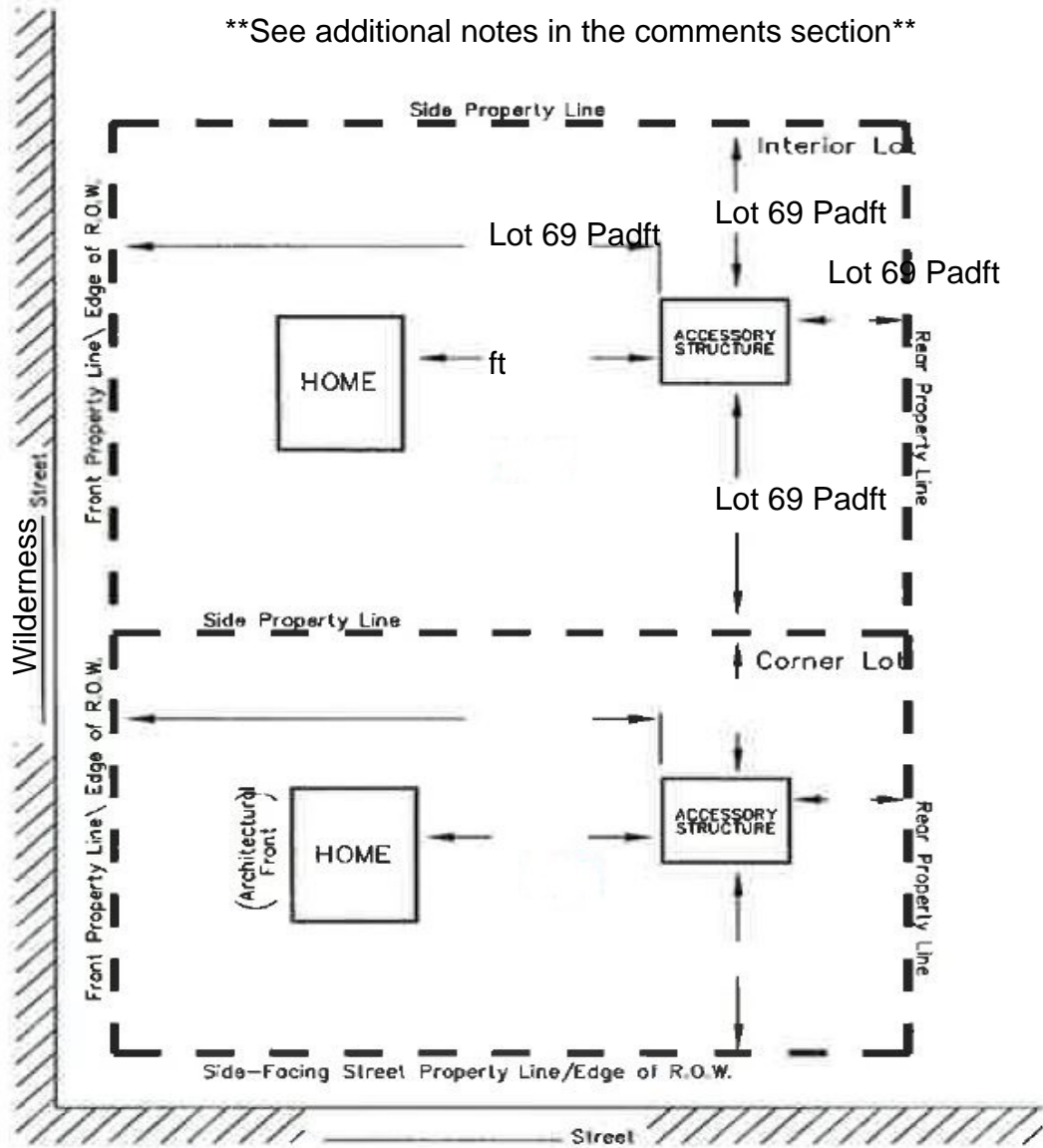

MINIMUM YARD SETBACKS Storage Shed, Detached Garage, Etc.

NOTICE FOR APPLICANT (Please Read Before Signing)

Proposals for the installation of an individual water supply and for a sanitary waste disposal system (septic tank) for any structure designed for human occupation must be approved by Weber County Health Department prior to installation.

Scott Perkes

03/22/2021

Planning Dept. Signature of Approval

Date

I hereby certify that I have read and examined this application and know the same to be true and correct. All provisions of laws and ordinances governing this land use will be complied with whether specified herein or not. I make this statement under penalty of perjury.

Contractor/Owner Signature of Approval

Date

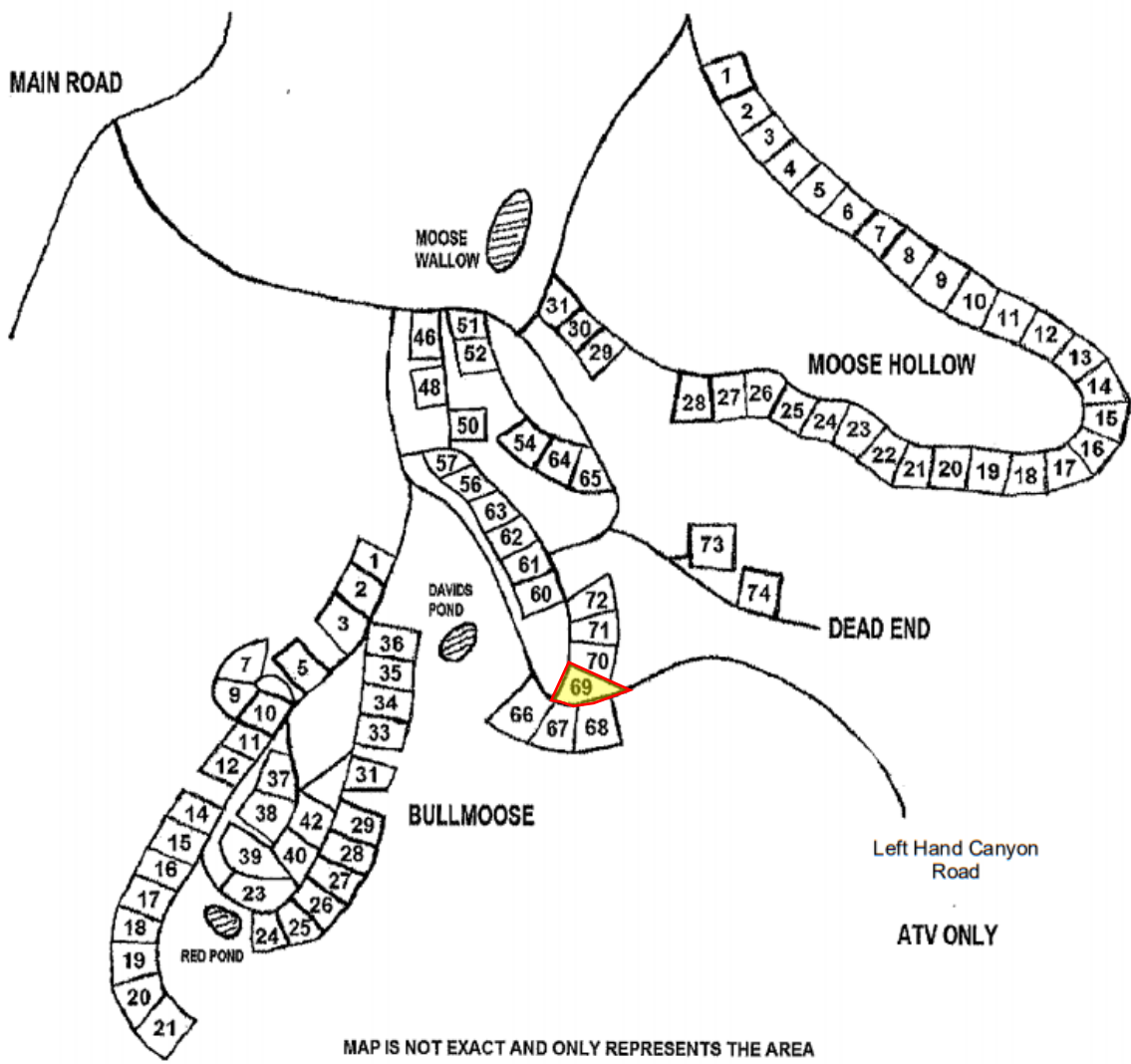

MAP IS NOT EXACT AND ONLY REPRESENTS THE AREA

ATV ONLY

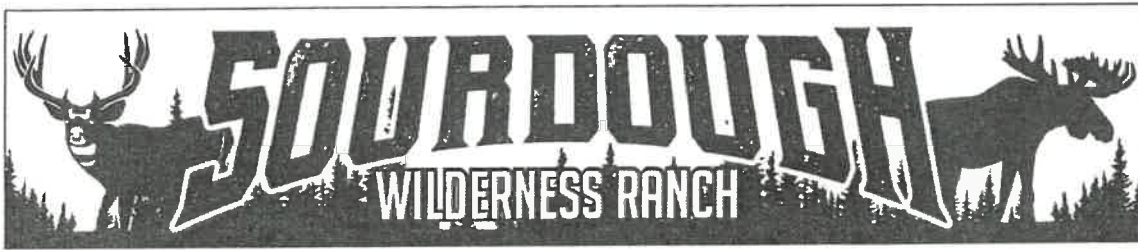

1150 N. Hwy 89 Suite B
Harrisville, UT 84404
801-773-3348
Sourdoughranch@gmail.com

Weber County

RE: Bull Moose 69/shed approval

March 18, 2021

Craig Brown has been approved to place a shed 10' X 10' in size on Bull Moose site 69 by the board of trustees of Sourdough Wilderness Ranch as per trustee signature on permit application.

Thank You

A handwritten signature in blue ink that reads "Shawna Lee".

Shawna Lee
Office Manager
Board Secretary/Treasurer