

UDOT Street Detail
SCALE: NONE

UDOT Notes:

1. ALL CONSTRUCTION WITHIN THE UDOT RIGHT-OF-WAY SHALL CONFORM TO THE MOST CURRENT UDOT STANDARD (INCLUDING SUPPLEMENTAL) DRAWINGS AND SPECIFICATIONS.
2. THE CONTRACTOR IS TO OBTAIN AN ENCROACHMENT PERMIT FROM THE APPLICABLE UDOT REGION PERMIT OFFICE PRIOR TO COMMENCING WORK WITHIN UDOT RIGHT-OF-WAY. WORKING HOUR LIMITATIONS WILL BE LISTED IN THE LIMITATION SECTION OF THE ENCROACHMENT PERMIT.
3. UDOT RESERVES THE RIGHT, AT ITS OPTION, TO INSTALL A RAISED MEDIAN ISLAND OR RESTRICT THE ACCESS TO A RIGHT-IN OR RIGHT-OUT AT ANY TIME.
4. OWNER, DEVELOPER, AND CONTRACTOR ARE RESPONSIBLE FOR ANY DAMAGES DIRECTLY OR INDIRECTLY WITHIN THE UDOT RIGHT-OF-WAY AS A RESULT OF DEVELOPMENT ACTIVITIES.
5. OWNER, DEVELOPER, AND/OR CONTRACTOR IS REQUIRED TO HIRE AN INDEPENDENT COMPANY FOR ALL TESTING WITHIN THE UDOT RIGHT-OF-WAY.
6. ALL SIGNS INSTALLED ON THE UDOT RIGHT-OF-WAY MUST BE HIGH INTENSITY GRADE (TYPE XI SHEETING) WITH A B3 SLIP BASE. INSTALL ALL SIGNS PER UDOT 'S' SERIES STANDARD DRAWINGS.
7. COMPLY WITH THE REQUIREMENTS OF UTAH CODE 17-23-14 (DISTURBED CORNERS - COUNTY SURVEYOR TO BE NOTIFIED - COORDINATION WITH CERTAIN STATE AGENCIES).

NOTE:
1. SAWCUT EXISTING ASPHALT INSIDE FROM OUTER EDGE FOR TACK SEAL OF NEW ASPHALT
2. CONTRACTOR TO VERIFY 2% MIN. AND 5% MAX SLOPE FROM EDGE OF ASPHALT TO LIP OF GUTTER

UDOT NOTE:
REPAIR OR REPLACE ANY DAMAGED CURB, GUTTER &/OR DRIVEWAY. CURB & GUTTER TO BE TYPE B1 CURB, DRIVEWAY TO BE CONSTRUCTED AS GW3A (2017 UDOT DRAWING)

ALL TRENCHES TO BE REPAIRED AS A T-PATCH W/ ASPHALT THE GREATER OF 7" OR TO MATCH EXISTING IN LIFTS NO GREATER THAN 3". 10' ON EACH SIDE OF TRENCH TO BE MILLED 2" DEEP AND REPAVED AS A SINGLE PATCH.

UTILITY WORK REQUIRES SEPARATE PERMITTING. CONTRACTOR TO APPLY DIRECTLY W/ UDOT AT LEAST 30 DAYS IN ADVANCE.

ANY DAMAGED PAINT STRIPING DURING CONSTRUCTION MUST BE REDONE.

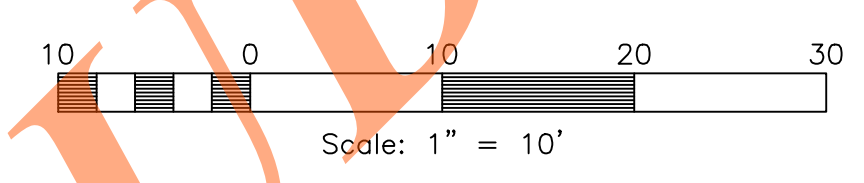

Reeve & Associates, Inc.
5160 SOUTH 1500 WEST RIVERDALE, UTAH 84405
TEL: (801) 621-3100 www.reeve-associ.com

IRA
LAND PLANNERS • CIVIL ENGINEERS • LAND SURVEYORS
TRAFFIC ENGINEERS • STRUCTURAL ENGINEERS • LANDSCAPE ARCHITECTS

REVISIONS	DESCRIPTION
DATE	

Bridger Butler Subdivision
PART OF THE NW 1/4 OF SECTION 32, T.6N., R.2W., S.1B & M., U.S. SURVEY
WEBER COUNTY, UTAH

UDOT Exhibit
4700 West Street (SR-134)



Project Info.

Engineer:	JEREMY DRAPER P.E.
Drafter:	K.EAVES
Begin Date:	5/28/2020
Name:	BRIDGER BUTLER SUBDIVISION
Number:	6403-01

Sheet	1
1	Sheets

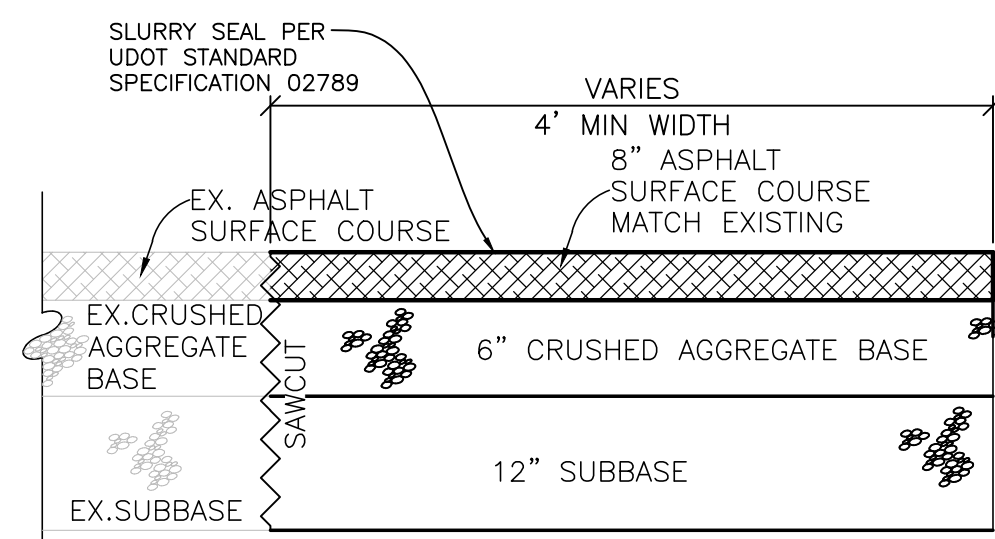
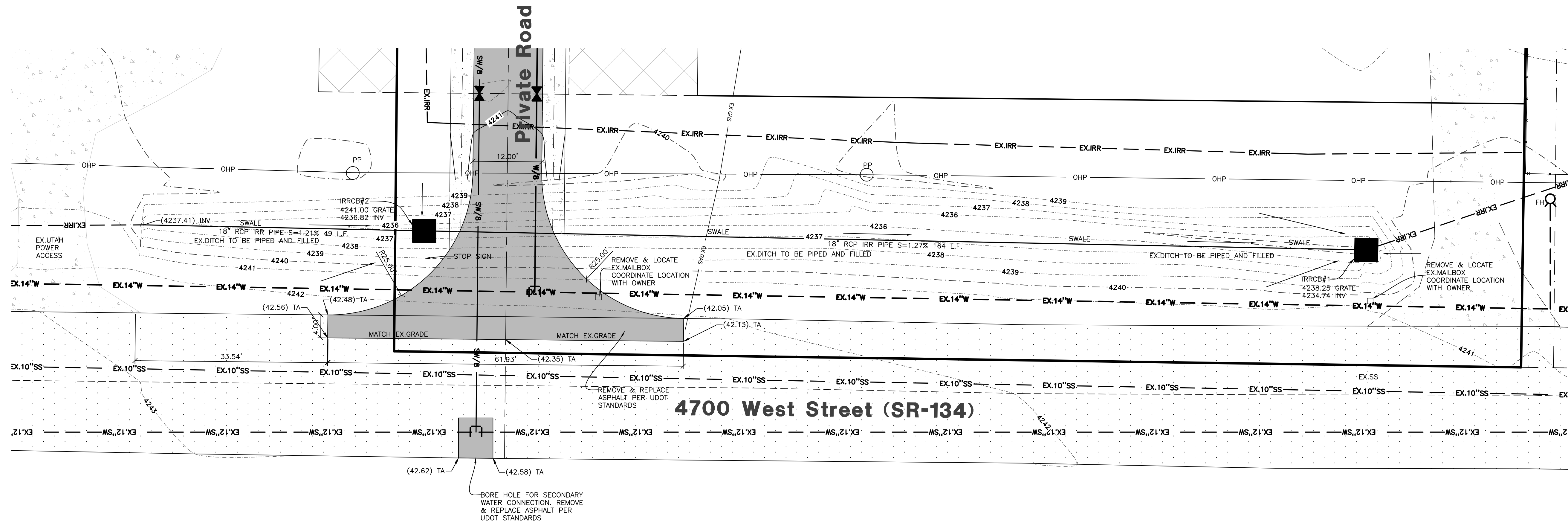

UDOT Street Detail
SCALE: NONE

1. MIX DESIGN ASPHALT CONFORMING TO UDOT SPECIFICATIONS 02741
2. SAWCUT AND TACK COAT VERTICAL CUTS IN ASPHALT PER UDOT SPECIFICATION 027055 PAVEMENT CUTTING

UDOT Notes:

1. ALL CONSTRUCTION WITHIN THE UDOT RIGHT-OF-WAY SHALL CONFORM TO THE MOST CURRENT UDOT STANDARD (INCLUDING SUPPLEMENTAL) DRAWINGS AND SPECIFICATIONS.
2. THE CONTRACTOR IS TO OBTAIN AN ENCROACHMENT PERMIT FROM THE APPLICABLE UDOT REGION PERMIT OFFICE PRIOR TO COMMENCING WORK WITHIN UDOT RIGHT-OF-WAY. WORKING HOUR LIMITATIONS WILL BE LISTED IN THE LIMITATION SECTION OF THE ENCROACHMENT PERMIT.
3. UDOT RESERVES THE RIGHT, AT ITS OPTION, TO INSTALL A RAISED MEDIAN ISLAND OR RESTRICT THE ACCESS TO A RIGHT-IN OR RIGHT-OUT AT ANY TIME.
4. OWNER, DEVELOPER, AND CONTRACTOR ARE RESPONSIBLE FOR ANY DAMAGES DIRECTLY OR INDIRECTLY WITHIN THE UDOT RIGHT-OF-WAY AS A RESULT OF DEVELOPMENT ACTIVITIES.
5. OWNER, DEVELOPER, AND/OR CONTRACTOR IS REQUIRED TO HIRE AN INDEPENDENT COMPANY FOR ALL TESTING WITHIN THE UDOT RIGHT-OF-WAY.
6. ALL SIGNS INSTALLED ON THE UDOT RIGHT-OF-WAY MUST BE HIGH INTENSITY GRADE (TYPE XI SHEETING) WITH A B3 SLIP BASE. INSTALL ALL SIGNS PER UDOT 'S' SERIES STANDARD DRAWINGS.
7. COMPLY WITH THE REQUIREMENTS OF UTAH CODE 17-23-14 (DISTURBED CORNERS - COUNTY SURVEYOR TO BE NOTIFIED - COORDINATION WITH CERTAIN STATE AGENCIES).

- NOTE:
1. SAWCUT EXISTING ASPHALT INSIDE FROM OUTER EDGE FOR TACK SEAL OF NEW ASPHALT
 2. CONTRACTOR TO VERIFY 2% MIN. AND 5% MAX SLOPE FROM EDGE OF ASPHALT TO LIP OF GUTTER

UDOT NOTE:
REPAIR OR REPLACE ANY DAMAGED CURB, GUTTER &/OR DRIVEWAY. CURB & GUTTER TO BE TYPE B1 CURB, DRIVEWAY TO BE CONSTRUCTED AS GW3A (2017 UDOT DRAWING)

ALL TRENCHES TO BE REPAIRED AS A T-PATCH W/ ASPHALT THE GREATER OF 7" OR TO MATCH EXISTING IN LIFTS NO GREATER THAN 3". 10' ON EACH SIDE OF TRENCH TO BE MILLED 2" DEEP AND REPAVED AS A SINGLE PATCH.

UTILITY WORK REQUIRES SEPARATE PERMITTING. CONTRACTOR TO APPLY DIRECTLY W/ UDOT AT LEAST 30 DAYS IN ADVANCE.

ANY DAMAGED PAINT STRIPING DURING CONSTRUCTION MUST BE REDONE.



Vicinity Map
NOT TO SCALE

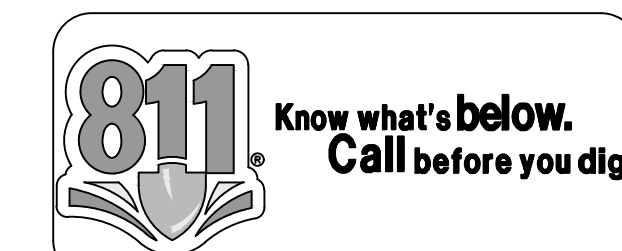
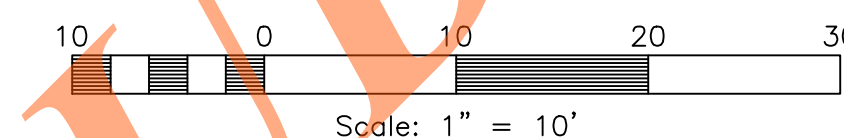

REVISIONS	DESCRIPTION
DATE	

Bridger Butler Subdivision
PART OF THE NW 1/4 OF SECTION 32, T.6N., R.2W., S.1B & M., U.S. SURVEY
WEBER COUNTY, UTAH

UDOT Exhibit
4700 West Street (SR-134)



Project Info.
Engineer: JEREMY DRAPER P.E.
Drafted: K.EAVES
Begin Date: 5/28/2020
Name: BRIDGER BUTLER SUBDIVISION
Number: 6403-01

Sheet **1** of 1 Sheets