



Land Use Permit

Weber County Planning Commission

2380 Washington Blvd. STE 240
Ogden, UT 84401
Phone: (801) 399-8791 FAX: (801) 399-8862
webercountyutah.gov/planning

Permit Number: LUP200-2020

Permit Type: Structure
Permit Date: 06/29/2020

Applicant

Name: Michael Ohman
Business:
Address: 4596 N 4175 E
Eden, UT 84310
Phone: 8015899192

Owner

Name: Same as app
Business:
Address: , UT
Phone:

Parcel

Parcel: 222440016
Zoning: FV-3 **Area:** .4794 **Sq Ft:**
Address: 4596 N 4175 E EDEN, UT 84310

Lot(s): 115 **Subdivision:** Sheep Creek Phase 3
T - R - S - QS: 7N - 1E - 16 -

Proposal

Proposed Structure: Accessory shed
Proposed Structure Height: 14
of Dwelling Units: 1
Off Street Parking Reqd: 0

Building Footprint: 192
Max Structure Height in Zone: 25
of Accessory Bldgs: 1
***Is Structure > 1,000 Sq. Ft?** N/A
***If True Need Certif. Statement**

Permit Checklist

Access Type: Across front lot line
Greater than 4218 ft above sea level? N/A
Additional Setback Reqd. ? N/A
> 200 ft from paved Road? N/A
Culinary Water District: N/A

Alternative Access File #
Wetlands/Flood Zone? N/A
Meet Zone Area Frontage? N/A
Hillside Review Reqd? N/A
Waste Water System: N/A

Comments

Permit issued based on compliance with land use code.

Land Use Permit

Structure Setback Graphic: Storage Shed, Detached Garage, Etc.

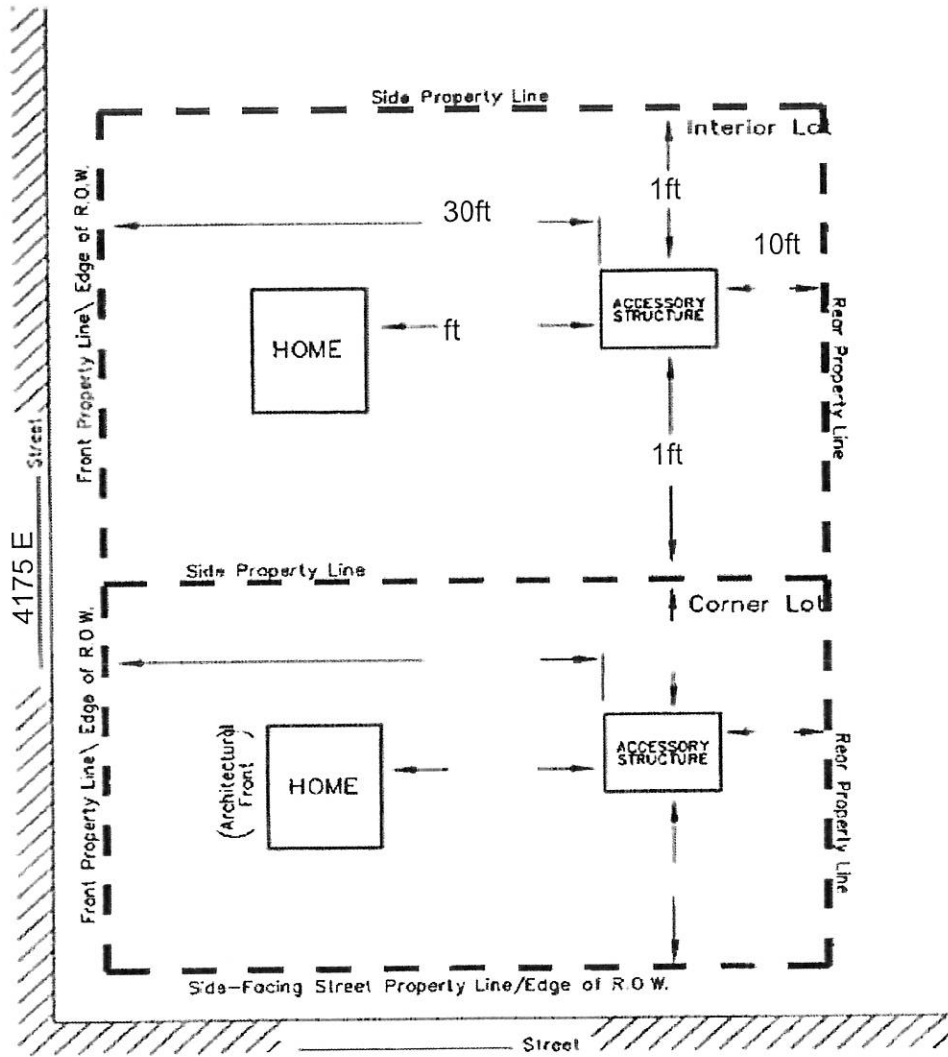

MINIMUM YARD SETBACKS Storage Shed, Detached Garage, Etc.

NOTICE FOR APPLICANT (Please Read Before Signing)

Proposals for the installation of an individual water supply and for a sanitary waste disposal system (septic tank) for any structure designed for human occupation must be approved by Weber County Health Department prior to installation.

Steven Burton
 Planning Dept. Signature of Approval 06/29/2020
 Date

I hereby certify that I have read and examined this application and know the same to be true and correct. All provisions of laws and ordinances governing this land use will be complied with whether specified herein or not. I make this statement under penalty of perjury.

 Contractor/Owner Signature of Approval 6/29/2020
 Date

Weber County Land Use Permit Application

Application submittals are recommended to be submitted with an appointment.
(801) 399-8791. 2380 Washington Blvd. Suite 240, Ogden, UT 84401

Date Submitted / Completed

Fees (Office Use)

Receipt Number (Office Use)

Property Owner Contact Information

Name MICHAEL OHMAN		Mailing Address 4596N. 4175E EDEN, UT 84310	
Phone 801 589-9192	Fax		
Email Address M_OHMAN@MSN.COM		Preferred Method of Written Correspondence <input checked="" type="checkbox"/> Email <input type="checkbox"/> Fax <input type="checkbox"/> Mail	

Authorized Representative Contact Information

Name of Person Authorized to Represent the Property Owner(s)		Mailing Address of Authorized Person	
Phone	Fax		
Email Address		Preferred Method of Written Correspondence <input type="checkbox"/> Email <input type="checkbox"/> Fax <input type="checkbox"/> Mail	

Property Information

Address		Land Serial Number(s) 22-244-0016	
Subdivision Name	Lot Number	Current Zoning FV3	Acreage 0.48
Culinary Water Provider	Secondary Water Provider	Waste Water Provider	Frontage

Detailed Description of Proposed Use/Structure

12x16 SHED

Property Owner Affidavit

I (We), _____, depose and say that I (we) am (are) the owner(s) of the property identified in this application and that the statements herein contained, the information provided in the attached plans and other exhibits are in all respects true and correct to the best of my (our) knowledge.

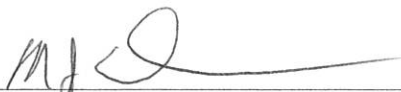
(Property Owner)

(Property Owner)

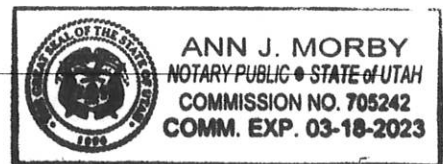

Subscribed and sworn to me this 29 day of June, 2020.

(Notary)

Authorized Representative Affidavit

I (We), _____, the owner(s) of the real property described in the attached application, do authorized as my (our) representative(s), _____, to represent me (us) regarding the attached application and to appear on my (our) behalf before any administrative or legislative body in the County considering this application and to act in all respects as our agent in matters pertaining to the attached application.

(Property Owner)

(Property Owner)

Dated this _____ day of _____, 20 _____, personally appeared before me _____, the signer(s) of the Representative Authorization Affidavit who duly acknowledged to me that they executed the same.

(Notary)

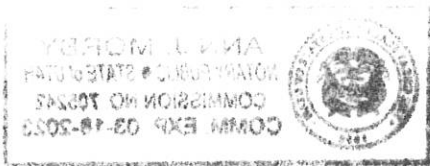



Weber County Corporation

Weber County Planning
2380 Washington Blvd, Ste 240

Customer Receipt

Receipt Number **137673**

Receipt Date
06/29/20

Received From:
Michael Ohman

Time: 14:18:2
Clerk: amorby

Description	Comment	Amount
ZONING FEES	Land Use Permit	\$60.00

Payment Type	Quantity	Ref	Amount
CREDIT CARD		6684	

AMT TENDERED: \$60.00

AMT APPLIED: \$60.00

CHANGE: \$0.00

