



Land Use Permit

Weber County Planning Commission

2380 Washington Blvd. STE 240
Ogden, UT 84401
Phone: (801) 399-8791 FAX: (801) 399-8862
webercountyutah.gov/planning

Permit Number: LUP196-2020

Permit Type: Structure
Permit Date: 06/26/2020

Applicant

Name: Kandis Brice
Business:
Address:
, UT
Phone: 8016893630

Owner

Name: Dana Surrage
Business:
Address: 3638 W 900 S
Ogden, UT 84401
Phone: 8017215631

Parcel

Parcel: 150450013
Zoning: A-1 **Area:** 1 **Sq Ft:**
Address: 3638 W 900 S OGDEN, UT 84404

Lot(s): **Subdivision:**
T - R - S - QS: 6N - 2W - 16 - SE

Proposal

Proposed Structure: Barn
Proposed Structure Height: 20
of Dwelling Units: 1
Off Street Parking Reqd:

Building Footprint: 1900
Max Structure Height in Zone: 35
of Accessory Bldgs: 3
***Is Structure > 1,000 Sq. Ft?** Yes
***If True Need Certif. Statement**

Permit Checklist

Access Type: Public own front
Greater than 4218 ft above sea level? Yes
Additional Setback Reqd. ? No
> 200 ft from paved Road? No
Culinary Water District: TWWW

Alternative Access File #
Wetlands/Flood Zone? No
Meet Zone Area Frontage? Yes
Hillside Review Reqd? No
Waste Water System: Septic

Comments

The plans display compliance with all applicable land use requirements.



Land Use Permit

Structure Setback Graphic: New Dwelling, Addition, Etc.

See additional notes in the comments section

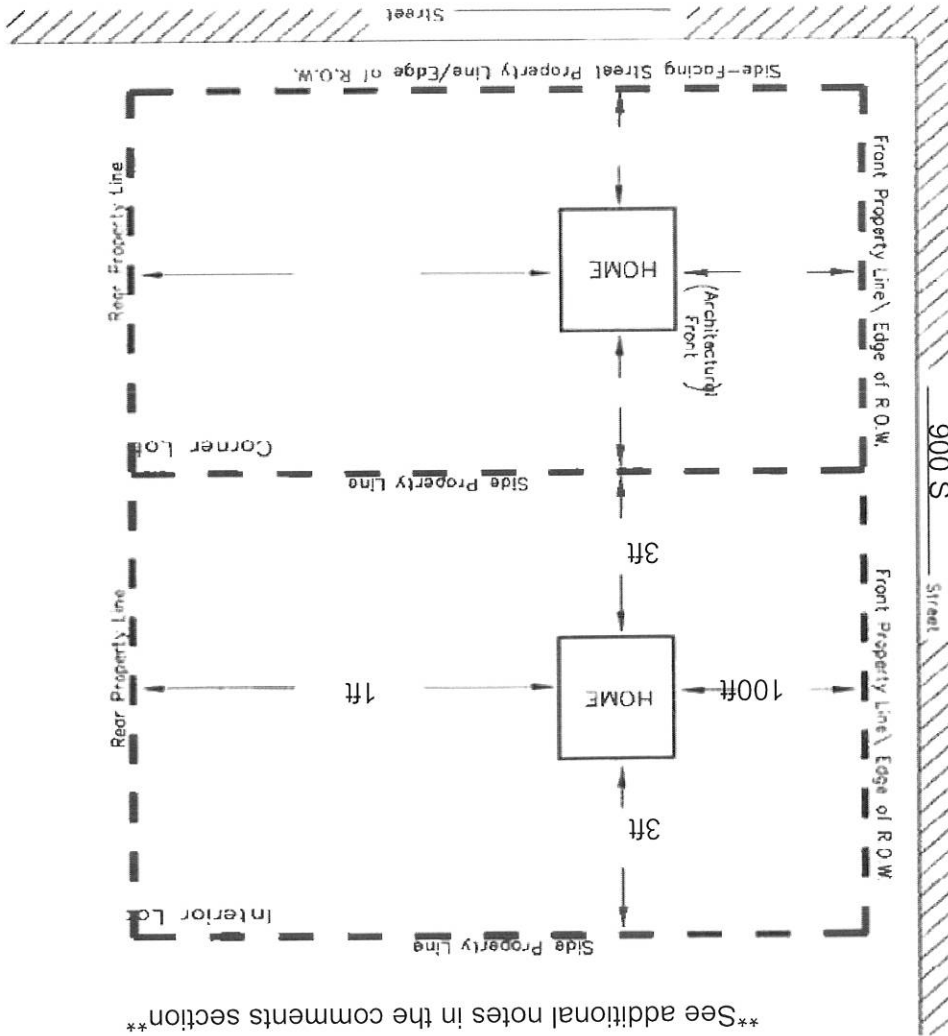

MINIMUM YARD SETBACKS New Dwelling, Addition, Etc.

NOTICE FOR APPLICANT (Please Read Before Signing)

Proposals for the installation of an individual water supply and for a sanitary waste disposal system (septic tank) for any structure designed for human occupation must be approved by Weber County Health Department prior to installation.

Felix Lleverino

06/26/2020

Planning Dept. Signature of Approval

Date

I hereby certify that I have read and examined this application and know the same to be true and correct. All provisions of laws and ordinances governing this land use will be complied with whether specified herein or not. I make this statement under penalty of perjury.

Contractor/Owner Signature of Approval

Date