



Land Use Permit

Weber County Planning Commission

2380 Washington Blvd. STE 240

Ogden, UT 84401

Phone: (801) 399-8791 FAX: (801) 399-8862

webercountyutah.gov/planning

Permit Number: LUP30-2020

Permit Type: Structure

Permit Date: 03/06/2020

Applicant

Name: Michael Roundy

Business:

Address: 595 N 5150 E
Eden, UT 84310

Phone: 8018884417

Owner

Name: Same as applicant

Business:

Address:
, UT

Phone:

Parcel

Parcel: 200460006

Zoning: FV-3 **Area:** 0 **Sq Ft:**
Address: 595 N 5150 E EDEN, UT 84310

Lot(s): 13 **Subdivision:** Pine View West No. 2
T - R - S - QS: 6N - 1E - 10 - SE

Proposal

Proposed Structure: Large Accessory Buildin

Proposed Structure Height: 19

of Dwelling Units: 0

Off Street Parking Reqd: 0

Building Footprint: 1000

Max Structure Height in Zone: 25

of Accessory Bldgs: 1

***Is Structure > 1,000 Sq. Ft?** No

*If True Need Certif. Statement

Permit Checklist

Access Type: Across front lot line

Greater than 4218 ft above sea level? Yes

Additional Setback Reqd. ? No

> 200 ft from paved Road? N/A

Culinary Water District: N/A

Alternative Access File #

Wetlands/Flood Zone? No

Meet Zone Area Frontage? Yes

Hillside Review Reqd? N/A

Waste Water System: N/A

Comments

This parcel received a 15ft variance into the stream corridor setback on the property (BOA 2020-01). The parcel also received a building parcel designation to combine with parcel to the south (BPD 2019-01). No outdoor lighting is proposed with this project.

Land Use Permit

Structure Setback Graphic: Storage Shed, Detached Garage, Etc.

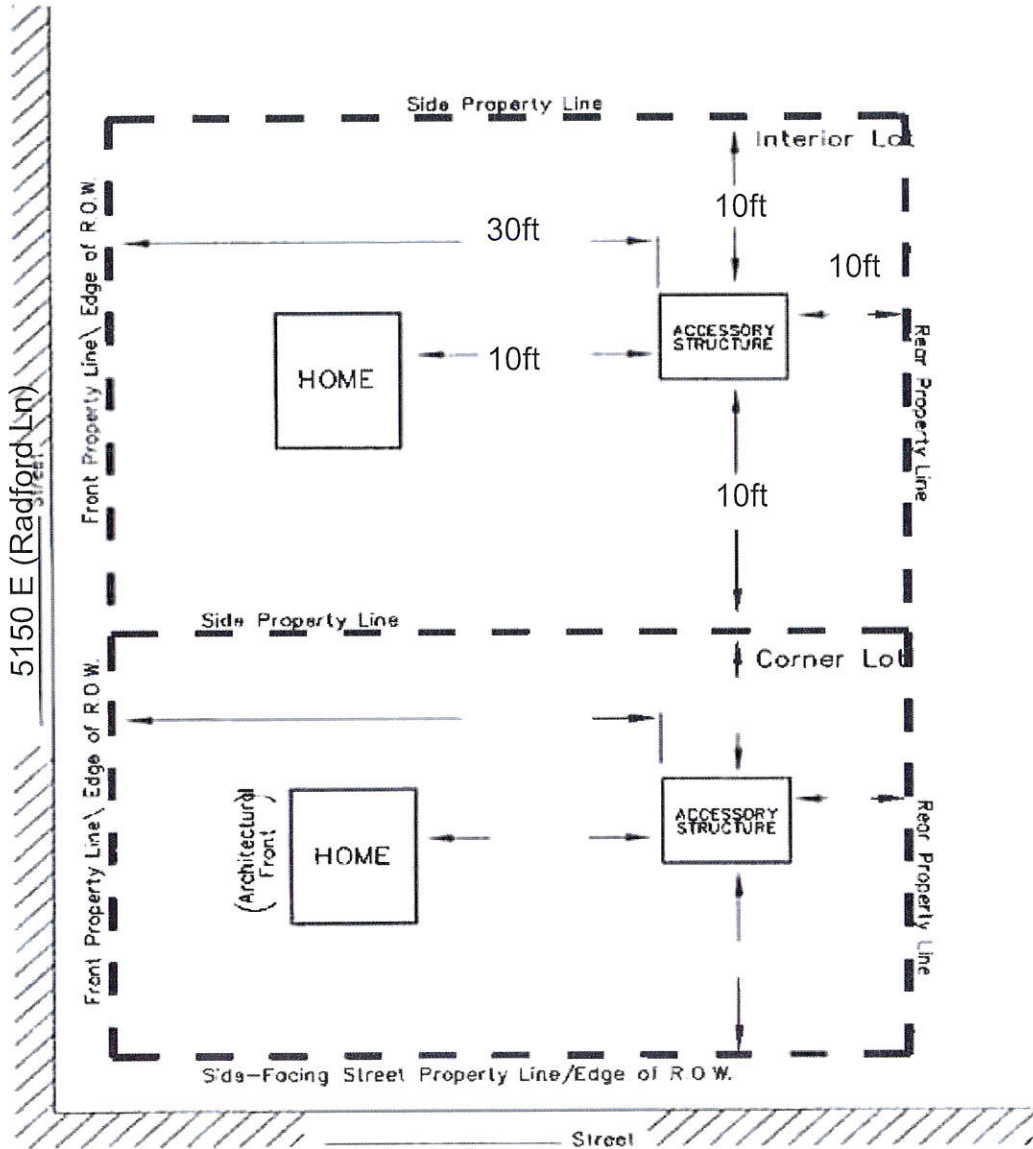

MINIMUM YARD SETBACKS Storage Shed, Detached Garage, Etc.

NOTICE FOR APPLICANT (Please Read Before Signing)

Proposals for the installation of an individual water supply and for a sanitary waste disposal system (septic tank) for any structure designed for human occupation must be approved by Weber County Health Department prior to installation.

Steven Burton

03/06/2020

Planning Dept. Signature of Approval

Date

I hereby certify that I have read and examined this application and know the same to be true and correct. All provisions of laws and ordinances governing this land use will be complied with whether specified herein or not. I make this statement under penalty of perjury.

Contractor/Owner Signature of Approval

Date