

EDGEWATER BEACH RESORT EASEMENT EXHIBIT

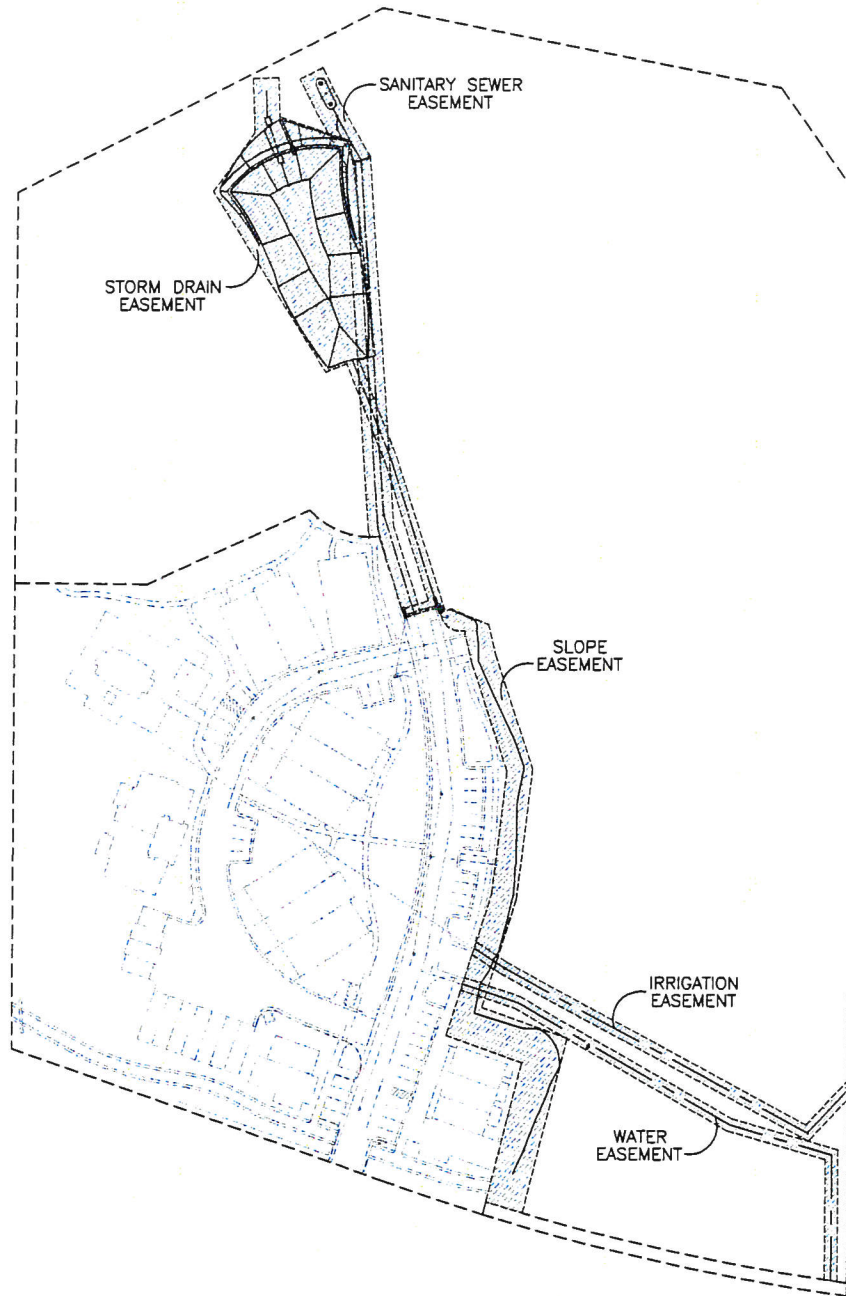

1"=150'



Reeve & Associates, Inc.

920 CHAMBERS STREET, SUITE 14, OGDEN, UTAH 84403
TEL: (801) 621-3100 FAX: (801) 621-2666 www.reeve-assoc.com
LAND PLANNERS • CIVIL ENGINEERS • LAND SURVEYORS
TRAFFIC ENGINEERS • STRUCTURAL ENGINEERS • LANDSCAPE ARCHITECTS

Project Info.

Designer: N. ANDERSON
Date: 12-5-13
Name: EASEMENT EXHIBIT
Number: 5917-15
Scale: 1"=150'



12-5-13

**EDGEWATER BEACH RESORT
SLOPE EASEMENT LEGAL DESCRIPTION**

PART OF THE SOUTHWEST QUARTER OF SECTION 13, TOWNSHIP 6 NORTH, RANGE 1 EAST, SALT LAKE BASE AND MERIDIAN, U.S. SURVEY. DESCRIBED AS FOLLOWS:

BEGINNING AT A POINT WHICH LIES N00°25'49"E 125.99 FEET AND S89°34'11"E 381.87 FEET FROM THE SOUTHWEST CORNER OF SECTION 13; THENCE N14°34'00"E 111.64 FEET; THENCE N70°43'57"W 63.32 FEET; THENCE N17°56'43"E 115.86 FEET; THENCE N06°58'25"E 95.65 FEET; THENCE N18°32'05"W 88.52 FEET; THENCE N13°34'41"W 26.00 FEET; THENCE ALONG A CURVE TURNING TO THE RIGHT WITH AN ARC LENGTH OF 22.64 FEET, A RADIUS OF 15.00 FEET, A CHORD BEARING OF N60°20'46"W, AND A CHORD LENGTH OF 20.55 FEET; THENCE N17°38'34"W 3.94 FEET; THENCE N72°21'26"E 9.03 FEET; THENCE S68°10'57"E 32.20 FEET; THENCE S13°34'41"E 25.13 FEET; THENCE S18°32'05"E 92.18 FEET; THENCE S06°58'25"W 102.09 FEET; THENCE S17°56'43"W 88.24 FEET; THENCE S70°43'57"E 71.64 FEET; THENCE S14°34'00"W 140.19 FEET; THENCE ALONG A CURVE TURNING TO THE RIGHT WITH AN ARC LENGTH OF 30.01 FEET, A RADIUS OF 1859.86 FEET, A CHORD BEARING OF N73°40'49"W, AND A CHORD LENGTH OF 30.01 FEET;

CONTAINING 12,497 SQUARE FEET OR 0.287 ACRES

Solutions You Can Build On™

Civil Engineering • Land Planning • Structural Engineering • Landscape Architecture • Land Surveying • Construction Surveying
920 Chambers St., Suite 14 • Ogden, Utah 84403 • Tel: 801-621-3100 • Fax: 801-621-2666
ogden@reeve-assoc.com • reeve-assoc.com



12-5-13

**EDGEWATER BEACH RESORT
WATER EASEMENT LEGAL DESCRIPTION**

PART OF THE SOUTHWEST QUARTER OF SECTION 13, TOWNSHIP 6 NORTH, RANGE 1 EAST, SALT LAKE BASE AND MERIDIAN, U.S. SURVEY. DESCRIBED AS FOLLOWS:

BEGINNING AT A POINT WHICH LIES N00°25'49"E 299.61 FEET AND S89°34'11"E 363.38 FEET FROM THE SOUTHWEST CORNER OF SECTION 13; THENCE S72°03'17"E 46.50 FEET; THENCE S60°23'12"E 190.37 FEET; THENCE S73°57'58"E 86.92 FEET; THENCE S00°20'30"W 102.08 FEET; THENCE N81°45'41"W 10.10 FEET; THENCE N00°20'30"E 93.11 FEET; THENCE N73°57'58"W 80.53 FEET; THENCE N60°23'12"W 190.54 FEET; THENCE N72°03'17"W 45.48 FEET; THENCE N17°56'43"E 10.00 FEET TO THE POINT OF BEGINNING.

CONTAINING 4,178 SQUARE FEET OR 0.096 ACRES

Solutions You Can Build On™

Civil Engineering • Land Planning • Structural Engineering • Landscape Architecture • Land Surveying • Construction Surveying
920 Chambers St., Suite 14 • Ogden, Utah 84403 • Tel: 801-621-3100 • Fax: 801-621-2666
ogden@reeve-assoc.com • reeve-assoc.com



12-5-13

**EDGEWATER BEACH RESORT
IRRIGATION EASEMENT LEGAL DESCRIPTION**

PART OF THE SOUTHWEST QUARTER OF SECTION 13, TOWNSHIP 6 NORTH, RANGE 1 EAST, SALT LAKE BASE AND MERIDIAN, U.S. SURVEY. DESCRIBED AS FOLLOWS:

BEGINNING AT A POINT WHICH LIES N00°25'49"E 327.71 FEET AND S89°34'11"E 372.25 FEET FROM THE SOUTHWEST CORNER OF SECTION 13; THENCE S57°08'11"E 29.47 FEET; THENCE S61°53'45"E 265.36 FEET; THENCE N43°48'26"E 47.95 FEET; THENCE S00°20'30"W 14.54 FEET; THENCE S43°48'26"W 44.98 FEET; THENCE N61°53'45"W 273.35 FEET; THENCE N57°08'11"W 27.22 FEET; THENCE N17°56'43"E 10.35 FEET TO THE POINT OF BEGINNING.

CONTAINING 3,442 SQUARE FEET OR 0.079 ACRES

Solutions You Can Build On™

Civil Engineering • Land Planning • Structural Engineering • Landscape Architecture • Land Surveying • Construction Surveying
920 Chambers St., Suite 14 • Ogden, Utah 84403 • Tel: 801-621-3100 • Fax: 801-621-2666
ogden@reeve-assoc.com • reeve-assoc.com



12-5-13

**EDGEWATER BEACH RESORT
SANITARY SEWER EASEMENT LEGAL DESCRIPTION**

PART OF THE SOUTHWEST QUARTER OF SECTION 13, TOWNSHIP 6 NORTH, RANGE 1 EAST, SALT LAKE BASE AND MERIDIAN, U.S. SURVEY. DESCRIBED AS FOLLOWS:

BEGINNING AT A POINT WHICH LIES N00°25'49"E 994.57 FEET AND S89°34'11"E 224.72 FEET FROM THE SOUTHWEST CORNER OF SECTION 13; THENCE N63°12'30"E 20.00 FEET; THENCE S26°47'30"E 29.60 FEET; THENCE S30°05'17"E 49.38 FEET; THENCE S03°59'49"E 286.09 FEET; THENCE S17°58'09"E 70.50 FEET; THENCE S72°01'51"W 13.39 FEET; THENCE N17°58'09"W 66.23 FEET; THENCE ALONG A CURVE TURNING TO THE RIGHT WITH AN ARC LENGTH OF 6.84 FEET, A RADIUS OF 66.72 FEET, A CHORD BEARING OF S87°04'52"W, AND A CHORD LENGTH OF 6.84 FEET; THENCE N17°58'09"W 4.95 FEET; THENCE N03°59'49"W 283.90 FEET; THENCE N30°05'17"W 45.32 FEET; THENCE N26°47'30"W 30.18 FEET TO THE POINT OF BEGINNING.

CONTAINING 8,236 SQUARE FEET OR 0.189 ACRES

Solutions You Can Build On™

Civil Engineering • Land Planning • Structural Engineering • Landscape Architecture • Land Surveying • Construction Surveying
920 Chambers St., Suite 14 • Ogden, Utah 84403 • Tel: 801-621-3100 • Fax: 801-621-2666
ogden@reeve-assoc.com • reeve-assoc.com



12-5-13

**EDGEWATER BEACH RESORT
STORM DRAIN EASEMENT LEGAL DESCRIPTION**

PART OF THE SOUTHWEST QUARTER OF SECTION 13, TOWNSHIP 6 NORTH, RANGE 1 EAST, SALT LAKE BASE AND MERIDIAN, U.S. SURVEY. DESCRIBED AS FOLLOWS:

BEGINNING AT A POINT WHICH LIES N00°25'49"E 994.54 FEET AND S89°34'11"E 187.87 FEET FROM THE SOUTHWEST CORNER OF SECTION 13; THENCE N87°56'19"E 20.00 FEET; THENCE S02°03'41"E 30.39 FEET; THENCE S71°48'17"E 58.83 FEET; THENCE S07°03'54"E 167.27 FEET; THENCE S74°06'56"W 13.19 FEET; THENCE S21°50'53"E 82.50 FEET; THENCE S17°58'28"E 121.68 FEET; THENCE S72°01'51"W 4.02 FEET; THENCE N17°38'34"W 3.00 FEET; THENCE S72°01'51"W 28.00 FEET; THENCE N17°58'09"W 7.00 FEET; THENCE N72°01'51"E 22.00 FEET; THENCE N17°58'09"W 111.17 FEET; THENCE N21°50'53"W 83.48 FEET; THENCE S68°09'07"W 18.11 FEET; THENCE N32°39'36"W 165.20 FEET; THENCE N35°02'51"E 56.28 FEET; THENCE N02°03'41"W 41.90 FEET TO THE POINT OF BEGINNING.

CONTAINING 17,901 SQUARE FEET OR 0.411 ACRES

Solutions You Can Build On™

Civil Engineering • Land Planning • Structural Engineering • Landscape Architecture • Land Surveying • Construction Surveying
920 Chambers St., Suite 14 • Ogden, Utah 84403 • Tel: 801-621-3100 • Fax: 801-621-2666
ogden@reeve-assoc.com • reeve-assoc.com