

LEVEL 1

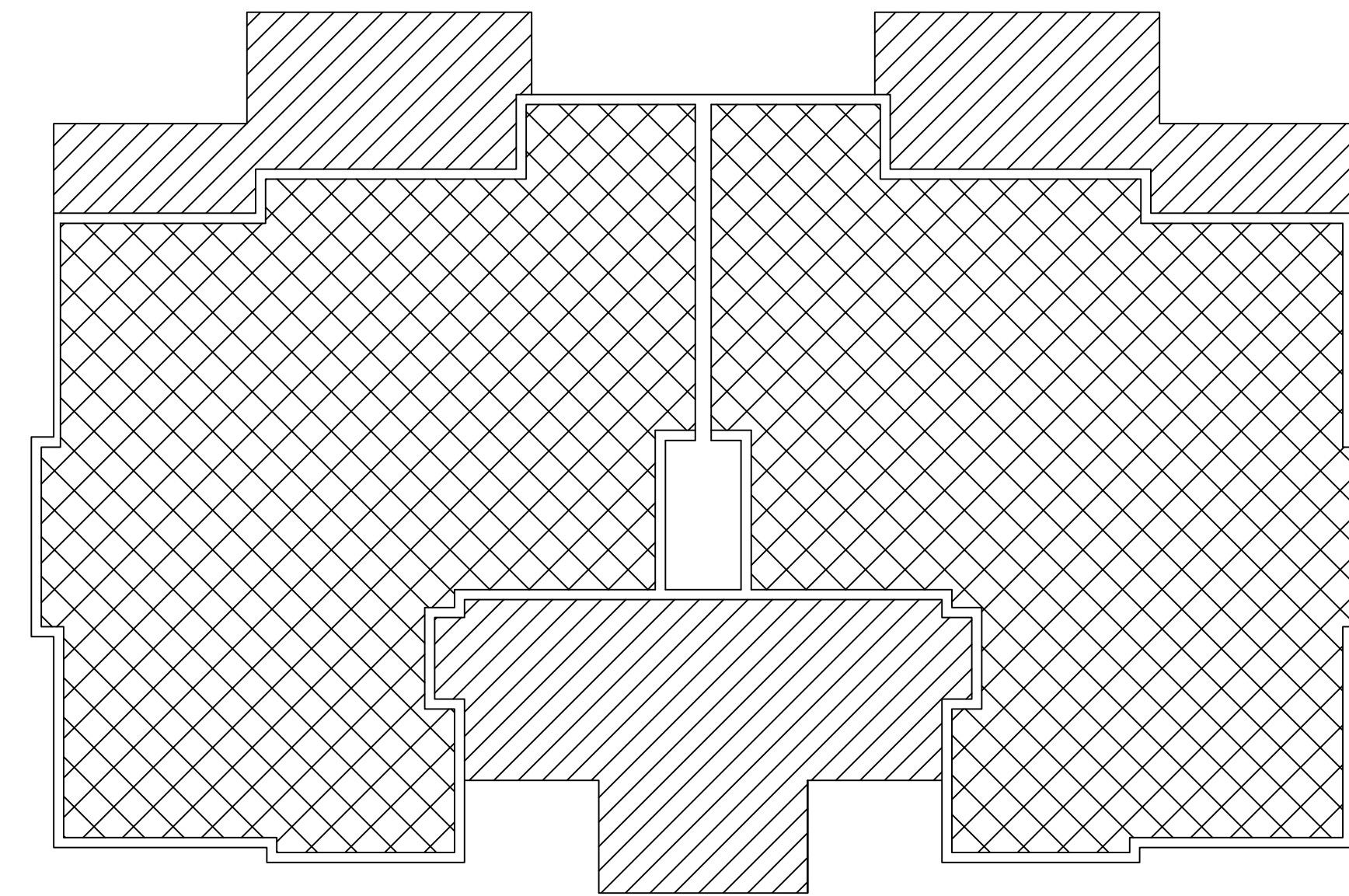

LEVEL 2

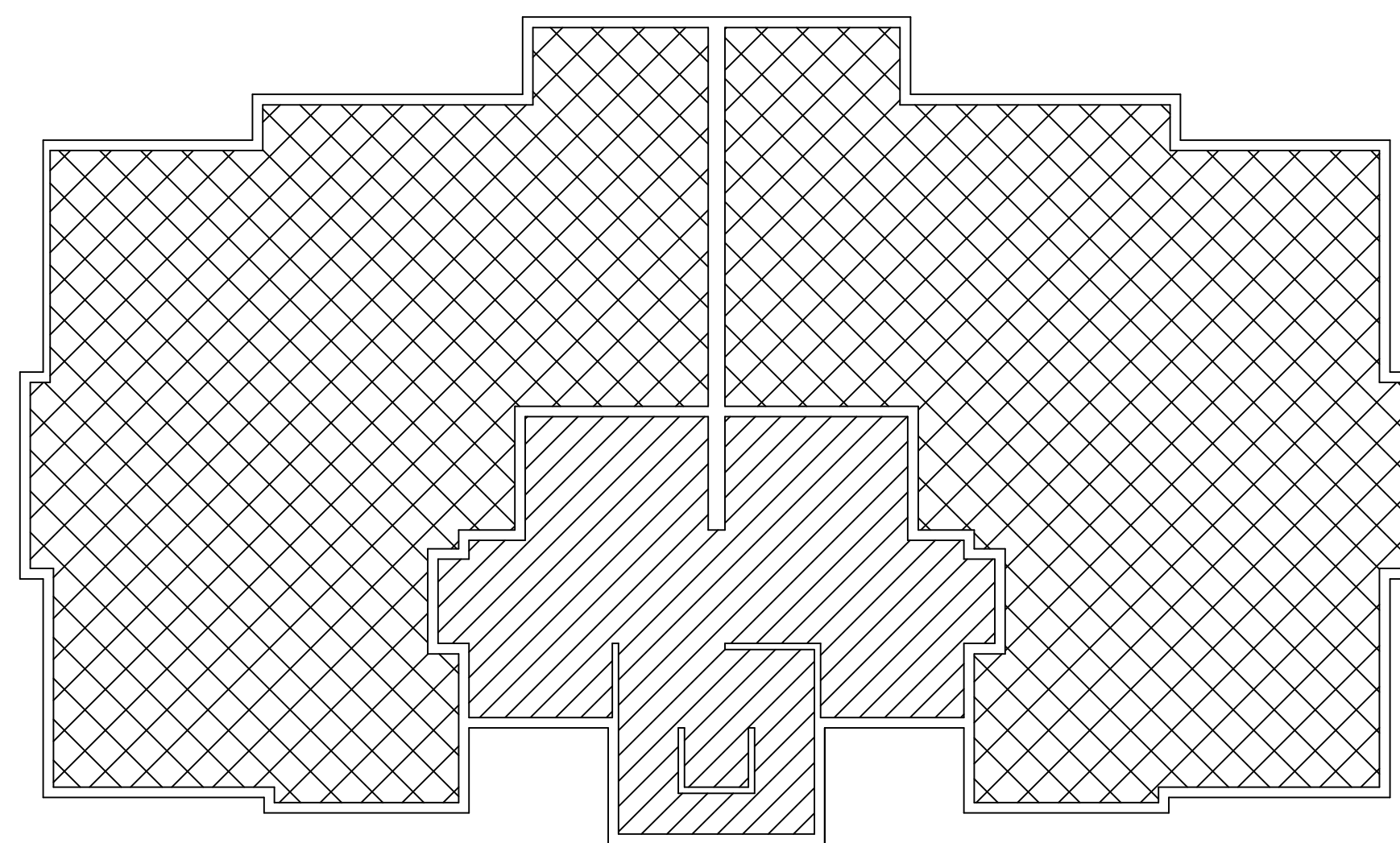

BASEMENT

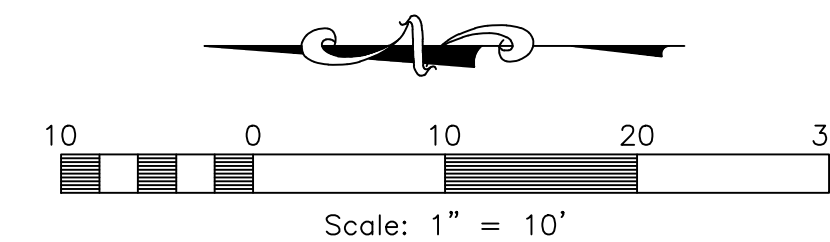

**EDGEWATER BEACH
RESORT PHASE 1 -AMENDED**

A PLANNED RESIDENTIAL UNIT DEVELOPMENT (P.R.U.D.)
PART OF THE SOUTHWEST QUARTER OF SECTION
13, TOWNSHIP 6 NORTH, RANGE 1 EAST, SALT
LAKE BASE AND MERIDIAN, U.S. SURVEY
WEBER COUNTY, UTAH
AUGUST, 2012



920 CHAMBERS STREET, SUITE 14, OGDEN, UT 84403
TEL: (801) 621-3100 FAX: (801) 621-2666 www.reeve-assoc.com

- CONDOMINIUM NOTES:
1. UNITS 101-104 WILL BE CONDOMINIUM UNITS
 2. ALL DRIVEWAYS, PATIOS, DECKS, BALCONIES ON UNITS 101-104 ARE CONSIDERED LIMITED COMMON AREAS. THEY ARE SET ASIDE AND RESERVED FOR THE USE OF THE RESPECTIVE CONDOMINIUM UNIT TO WHICH THEY ARE ATTACHED OR APPURTENANT.
 3. EXISTING OFFSITE EASEMENTS WILL BE VACATED AND RE-RECORDED, AS REQUIRED.

Project Info.

Surveyor: R. KUNZ
 Designer: N. ANDERSON
 Begin Date: 07-11-12
 Name: EDGEWATER BEACH
 RSRT. PH 1 AMD. PRUD
 Number: 5917-15
 Revision:
 Scale: 1"=20'
 Checked:

Weber County Recorder

Entry No. _____ Fee Paid _____
 At _____ In Book _____
 Of The Official Records, Page _____
 Recorded For: _____

 Weber County Recorder
 _____ Deputy.