



Land Use Permit

Weber County Planning Commission

2380 Washington Blvd. STE 240

Ogden, UT 84401

Phone: (801) 399-8791 FAX: (801) 399-8862

webercountyutah.gov/planning

Permit Number: LUP212-2019

Permit Type: Structure

Permit Date: 07/09/2019

Applicant

Name: Kelly Smith
Business:
Address: 3465 N HWY 39
HUNTSVILLE, UT
Phone: 801-678-3074

Owner

Name: Sourdough Wilderness Ranch
Business:
Address: , UT
Phone:

Parcel

Parcel: 230130010

Zoning: F-40 **Area:** 5017.79Sq Ft:

Lot(s):

Subdivision:

Address: 3465 N HWY 39 HUNTSVILLE, UT 84317

T - R - S - QS: 7N - 3E - 18 - NE

Proposal

Proposed Structure: RV Canopy

Building Footprint: 300

Proposed Structure Height: 13

Max Structure Height in Zone: 25

of Dwelling Units:

of Accessory Bldgs:

Off Street Parking Reqd:

***Is Structure > 1,000 Sq. Ft?** N/A

***If True Need Certif. Statement**

Permit Checklist

Access Type: Across front lot line

Alternative Access File #

Greater than 4218 ft above sea level? Yes

Wetlands/Flood Zone? No

Additional Setback Reqd. ? N/A

Meet Zone Area Frontage? N/A

> 200 ft from paved Road? N/A

Hillside Review Reqd? N/A

Culinary Water District:

Waste Water System:

Comments

Nearest property line is to the west about 700 ft. The proposed site plan is in compliance with all setbacks.

Structure Setback Graphic: New Dwelling, Addition, Etc.

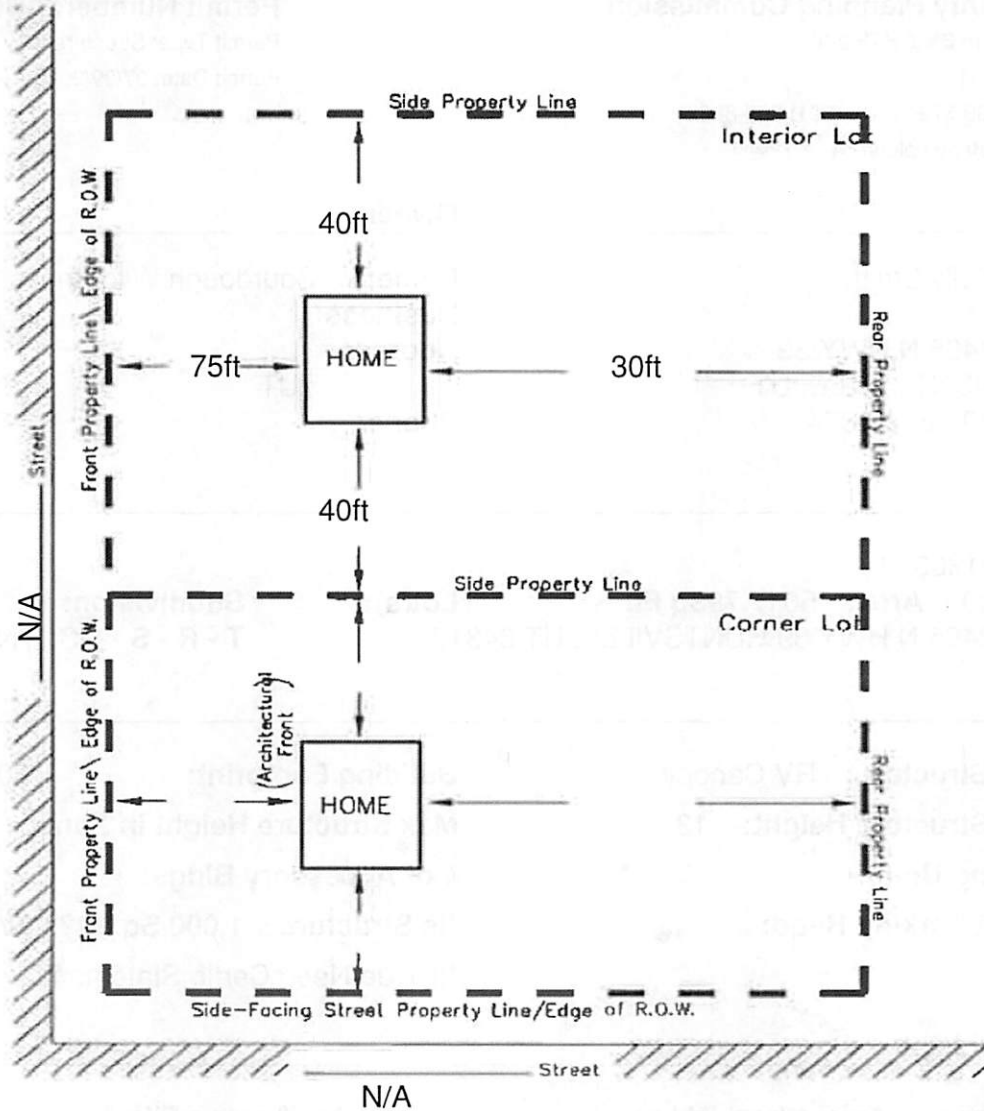

N/A
MINIMUM YARD SETBACKS
 New Dwelling, Addition, Etc.

NOTICE FOR APPLICANT (Please Read Before Signing)

Proposals for the installation of an individual water supply and for a sanitary waste disposal system (septic tank) for any structure designed for human occupation must be approved by Weber County Health Department prior to installation.

Steven Burton

07/09/2019

Planning Dept. Signature of Approval

Date

I hereby certify that I have read and examined this application and know the same to be true and correct. All provisions of laws and ordinances governing this land use will be complied with whether specified herein or not. I make this statement under penalty of perjury.

Contractor/Owner Signature of Approval

Date