

SWPPP
Gary Lucas
Lucas Residence
Lot 2, Anderson Sub
Weber County, UT

1. The proposed residence as per site plan.
2. Gary T Lucas Const. Co.
3. N/A All neighbors have fence yards. Will keep all constructions activities to lot.
4. All materials will stay on lot.
5. As per site plan. All materials dried & hauled off.
6. As per site plan. Anchored down.
7. As per site plan – gravel area.
8. Sweep or shovel mud & dirt as it occurs. If that were to happen.
9. N/A
10. Place sand bag in gutter at west end of property.
11. None.

Gary T Lucas Construction
801-721-6501

BASIC SWPPP EXAMPLE STORMWATER POLLUTION PREVENTION PLAN

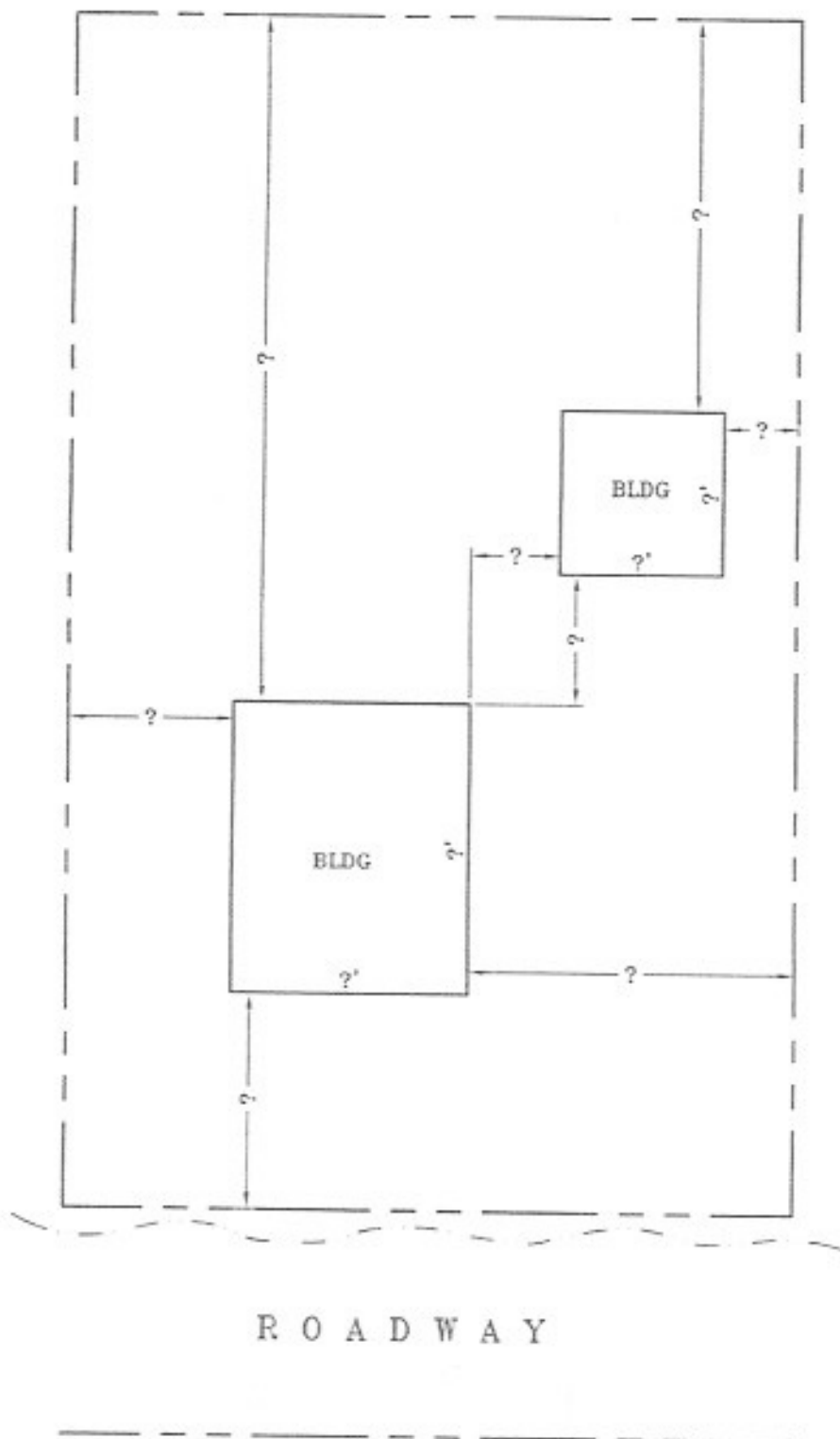

1. HOW MUCH AREA WILL BE DISTURBED?
2. WHO WILL BE RESPONSIBLE FOR THE CONDITIONS OF THE SITE DURING CONSTRUCTION?
3. WHAT WILL BE DONE TO PREVENT THE NEIGHBORS FROM BEING AFFECTED BY THE PROPOSED CONSTRUCTION ACTIVITIES?
4. WHAT WILL BE DONE WITH ALL EXCAVATED MATERIAL TEMPORARILY AND PERMANENTLY?
5. WHERE IS THE CONCRETE WASHOUT & HOW WILL IT BE MAINTAINED?
6. WHERE ARE THE PORTA-JOHNS LOCATED AND HOW ARE THEY INSTALLED?
7. HOW WILL THE CONSTRUCTION ENTRANCE BE BUILT AND WHERE WILL IT BE LOCATED?
8. WHAT WILL YOU DO WHEN MUD AND/OR DIRT GETS TRACKED ON THE ASPHALT?
9. IS THERE A DRAINAGE DITCH OR SWALE ON OR NEAR YOUR PROPERTY? HOW WILL IT BE PROTECTED?
10. WHAT CURRENTLY HAPPENS TO THE RAIN/STORM WATER WHEN IT REACHES THIS PROJECT SITE?
11. SHOW ALL EXISTING OCCUPATION ON THE PROPERTY.