

(This SWPPP Template is for the **Common Plan** Permit Only, and
does **NOT** address SWPPP requirements found in the CGP.)

Common Plan SWPPP for 6169 E Hummingbird Pt.

Huntsville, UT 84317

Glade McCombs

88 E 250 N

Morgan, UT 84050

Date

June 21, 2019



1. Project Information

Project Name: Residence for Glade and Corinne McCombs

Address: 6169 E Hummingbird Pt.

City: Huntsville

State: UT

Zip: 84317

Latitude: 41.246025

Longitude: -111.80092

UPDES Permit Tracking Number: UTRH94279, issued effective Jun 20, 2019 and expiring Jun 20, 2020.

Owner: Glade and Corinne McCombs

Contact Person: Glade McCombs

Address: 88 E 250 N #11

City: Morgan

State: UT

Zip: 84050

Telephone Number: 801-330-1040

Email Address: glade@gladesells.com

General Contractor: Glade McCombs

Contact Person: Glade McCombs

Address: See Above

City: Click here to enter text.

State: State

Zip: Zip Code

Telephone Number: Contact Person Phone

Email Address: See Above

Answering "no" to the two questions below means the project is not eligible for this permit.

Is the project in Indian Country?

Yes

No

Is the project a residential building on a single lot and disturbing one acre or less?

Yes

No

2. Pollution Sources/Best Management Practices

Answer yes or no whether the following features are located at your site. If yes, select the BMP(s) that will be used to protect each feature. If no, continue to the next question. Attach necessary illustrated details for proper installation in Appendix G, and show locations of all controls on Site Map in Appendix A.

- 2.1 Is there a SWPPP sign on site?** (see permit part 1.10) **Yes** **Required**
The sign must include the UPDES tracking number, the owner or general contractor name, phone number and email, and if the SWPPP is on-line, instructions on how to view it. The size requirement is to be readable from a publicly accessible point.
- 2.2 Will there be construction dewatering on the site?** (see permit part 2.7) **Yes** **No**
BMP(s): Dewatering of the construction area is needed and a separate dewatering permit has been obtained to treat and discharge water. *Construction Dewatering (if discharged offsite) must be covered by UPDES Permit UTG070000.*
 Water from the dewatering of the construction area will be infiltrated on site.
- 2.3 Will there be non-storm water discharges on the site?** (see permit part 1.3) **Yes** **No**
Allowable discharges include: Flushing of drinking water or irrigation water (not including wash or cleaning waters), water used for dust control, spring water or groundwater not exposed to construction activities, water from emergency fire-fighting activities, and water from foot drains not exposed to construction activities. (see permit part 2.4.5 & 2.9).
Please list all anticipated non-storm water discharges: Click here to enter text.
What will you do to manage the non-storm water discharges? Please list direct discharges, contained non-storm water discharges, and discharges that are treated separately.
BMP(s): All non-storm water discharges are listed as allowable per permit part 1.3 and discharged
 All non-storm water discharges that are not allowed are properly contained (see questions 2.12 and 2.16)
 All non-storm water discharges that are contaminated with sediment only (free of chemicals, oils, etc.) will be treated in a sediment basin or equivalent (see permit part 2.8.1).
 Other: Click here to enter text.

- 2.4 Is it possible for the total area of disturbance to be phased, minimizing the total exposure of disturbed soil at one time?** (see permit part 2.3.1) **Yes** **No**
If disturbance can be minimized please show the locations on the site map and summarize (here) where disturbances will be delayed for some of the disturbed area: [Click here to enter text.](#)
- 2.5 What perimeter controls will be used to prevent sediment from leaving the site?** (permit part 2.1.2 & 2.3)
BMP(s): Silt Fence Berms
 Vegetative Buffer Cut-Back-Curb
 Staked straw Wattles (Fiber Rolls) Weighted Wattles
 Other: [Click here to enter text.](#)
- 2.6 Are surface waters located within 30 feet of your project's earth disturbances?** **Yes** **No**
Note: A 30' natural vegetative buffer MUST be maintained by water bodies. If a buffer less than 30' is used, you must demonstrate that the additional controls offer the same protection as a 30' natural vegetative buffer, and select the reason for exemption below. (see permit part 2.3.5)
BMP(s): 30' Natural Vegetative Buffer
If less than 30' Natural Vegetative Buffer select additional Controls:
 2 Silt Fence Barrier 2 Straw Wattle Barriers (Fiber Roll)
 Other: [Click here to enter text.](#)
- 2.7 Are there critical or sensitive areas (such as preservation of the drip lines around trees, wetlands, buffer zones by water bodies, etc.) located on or adjacent to the site?** (see permit part 2.2) **Yes** **No**
BMP(s): Separate and isolate with environmental fencing
 Other: [Click here to enter text.](#)
- 2.8 What track out control will be used to prevent dirt from being tracked on streets as vehicles leave the site?** (see permit part 2.4.1)
BMP(s): Track Out Pad Cobble Gravel
 Rumble Strips Wash Down Pad Delivery Pad
 Restricted Site Selective Access During Dry Weather (Dry soil) Access
 Other: [Click here to enter text.](#)
- 2.9 Do you have storm drain inlets on or down gradient of this site?** (see permit part 2.1.3) **Yes** **No**
Protection must address the curb inlet opening (throat) as well as the grate.
Where is/are the nearest downstream inlet(s) and how will you protect them: Storm grate is in front of the lot at the street location.
BMP(s): Rock/Sand-filled Bags Drop Inlet Bags
 Filter Fabric Gravel or Sand filled Wattles
 Proprietary inlet devices
 Other: [Click here to enter text.](#)
- 2.10 Will curb ramps be used at the site?** (see permit part 2.4.2) **Yes** **No**
If curb ramps are used it must be done with material [not dirt] that will not wash away in storm water.
BMP(s): Crushed Rock Wood/Steel Ramps

- 2.11 Will there be stockpiles or spoil piles on the site?** Yes No
- Note:** Select "Contained by other BMP" if another BMP on your site will contain runoff from the stockpiles. Materials that can be transported with precipitation must not be placed in the street. (see permit part 2.1.1)
- BMP(s):** Surrounded by Silt Fence Surrounded by Staked Straw
 Covered with Tarp Wattles
 Temporary – Removed same day
 Contained by other BMP. Explain: [Click here to enter text.](#)
 Other: [Click here to enter text.](#)
- 2.12 Does the project include installation of concrete, masonry, stucco, and paint (water based) work in this project?** (see permit part 2.4.5 & 2.9.1) Yes No
Wash water must be contained, the solids dried, and disposed of at a landfill.
- BMP(s):** Lined Depression Steel Dumpster
 Regional Washout (per development)
 Other: [Click here to enter text.](#)
- 2.13 How will solid waste be dealt with on the site?** (see permit part 2.4.3)
Light trash in uncovered dumpsters can blow out and scatter with wind and rain may fall on uncovered leachable material in the dumpster and leak out the bottom causing pollutants to escape.
- BMP(s):** Bag Lightweight Trash Leak Proof Dumpsters
 Receptacles with Lids Other: [Click here to enter text.](#)
- 2.14 Will there be a need to dispose of solvents, oil, fuel, etc. liquid waste?** (see permit part 2.9) Yes No
- BMP(s):** Contained and Removed from the site Collected for Reuse
 Other: [Click here to enter text.](#)
- 2.15 How will sanitary waste be handled on the site?** (see permit part 2.4.4)
- BMP(s):** Portable Toilet(s) (*must be staked down on dirt surface & 10' from curb*)
 Onsite or Adjacent Indoor Bathrooms
 Portable Toilet Secondary Containment (secured down with straps to heavy weights)
 Other: [Click here to enter text.](#)
- 2.16 How will you minimize the discharge of pollutants from spills and leaks?** (see permit part 2.8.3)
- BMP(s):** Use of drip pans Offsite fueling, and maintenance
 Spill kit Spill response plan.
 Other: [Click here to enter text.](#)
- 2.17 Will there be a need to store construction materials on site?** (see permit 2.8.2) Yes No
Minimize the exposure of materials with a pollution risk (certain building and landscaping materials, fertilizers, pesticides, herbicides, detergents).
- BMP(s):** Covering Erodible or Liquid Materials Secondary Containment
 Strategic Storage and Staging Stored off-site
 Enclose them in a weather proof shed.
 Other: [Click here to enter text.](#)
- 2.18 Does your site have steep slopes (greater than 70%)?** (see permit part 2.3.2) Yes No
- BMP(s):** Erosion Control Blanket Avoid Disturbance on slope
 Seeding Hydroseed

- Mulch Tackifiers
 Other: [Click here to enter text.](#)

2.19 Are there site conditions that cause storm water flows with highly erosive velocities? (see permit parts 2.3.3 and 2.3.4) Yes No

Flows must be controlled to minimize sediment transport.

- BMP(s):** Gravel Check Dam Straw Wattles (Fiber Rolls) Check Dam
 Divert Flows around the Site Armored channel (riprap, geotextile, other)
 Other: [Click here to enter text.](#)

2.20 How will you reduce storm water volume to minimize sediment transport, channel and stream bank erosion? (see permit parts 2.3.4 and 2.3.3)

- BMP(s):** Utilize basin, depression storage of storm water, cut back curb, or other to hold and infiltrate.
 Prevent heavy equipment (as much as possible) from compacting soil so storm water will infiltrate easier.
 Rip soil after heavy equipment has caused compaction.
 Other: [Click here to enter text.](#)

2.21 Is there a need for dust control on the site (regulatory or for practical reasons)? Yes No

- BMP(s):** Wetting with Water Cover dirt piles with a tarp
 Use Mag chloride, Calcium Chloride or Lignan Sulfonate
 Stabilize surface with mulch, gravel or other surface cover
 Other: See Fugitive Dust Control Plan for additional BMP(s)

2.22 Will there be disturbed areas on the site that will need to be temporarily stabilized before the project is completed? (see permit part 2.6) Yes No

Places that are disturbed and then left for over 14 days with no activity, must be temporarily or permanently stabilized.

- BMP(s):** Bark or other mulch Hydro-mulch Seeding
 Tackifier Staked netting with straw mulch
 Other: [Click here to enter text.](#)

2.23 Will the house be sold without any landscaping? Yes No

If so, how will you leave the site for the new home owner so sediment will be contained on site until the home owner completes landscaping? (the permit can be terminated when the owner occupies the house even though the site is not stabilized).

- BMP(s):** Mulching/Hydro-mulching Swales Silt Fence
 Wattles Cut-Back-Curb Seeding
 Vegetated Buffer Grade Front-Yard Lower than Sidewalk
 Other: [Click here to enter text.](#)

3. Sequence of Construction Activity

Type of Construction Activity	Approximate Date Range
Start/End of the Project	7/1/19-7/1/20
Excavation activities	7/1/19-9/1/19
Foundation/Footings	7/8/19-7/31/19
Backfill	8/1/19
Erection of Building	8/1/19-11/13/19
Utility Lines installed	11/1/18-11/3/18
Landscaping	3/2/20-3/23/20

4. Site Map

On a blank page (or include a page from the architectural drawings that show site layout and dimensions), please draw a map (and place this map in Appendix A) showing the layout of the site including locations of:

1. boundaries of project/property
2. boundaries of disturbance (including areas outside of property boundaries)
3. show slopes on site (if there are steep areas show steep areas)
4. location of structures/facilities
5. locations of :
 - a. stockpiles for soils and materials
 - b. construction supplies
 - c. portable toilets
 - d. garbage/trash containers
 - e. egress points/track out pads
 - f. concrete washout pits or containers
6. water bodies, wetlands, natural vegetative buffers
7. placement of all BMPs, perimeter, erosion control, sediment control, inlet protection, etc.
8. storm water inlets and storm water discharge points (where storm water drains off the site)
9. areas that will be temporarily or permanently stabilized on the site
10. areas where disturbances will be delayed to minimize total exposed surface at one time.

5. Potential Sources of Pollutants

Potential sources of sediment to storm water runoff:

- Clearing and grubbing operations

- Grading and site excavation operations
- Vehicle tracking
- Topsoil stripping and stockpiling
- Landscaping operations

Potential pollutants and sources, other than sediment, to storm water runoff:

- Combined Staging Area—small fueling activities, minor equipment maintenance, sanitary facilities, and hazardous waste storage.
- Materials Storage Area—general building materials, solvents, adhesives, paving materials, paints, aggregates, trash, and so on.
- Construction Activity—paving, curb/gutter installation, concrete pouring/mortar/stucco, and building construction
- Concrete Washout Area

For all potential construction site pollutants, see Table 2 below.

Table 2. Potential construction site pollutants. Circle/highlight all that applies to your site and in the last column identify pollution prevention measures to minimize their discharge.

Material/Chemical	Storm Water Pollutants	Common Location*	Pollution Prevention Methods
Pesticides (insecticides, fungicides, herbicides, rodenticide)	Chlorinated hydrocarbons, organophosphates, carbamates, arsenic	Herbicides used for noxious weed control	Do not spread during periods of rain or forecast of rain. Minimize by spot application
Fertilizer	Nitrogen, phosphorous	Newly seeded areas	Contained in hydroseed area.
Plaster	Calcium sulphate, calcium carbonate, sulfuric acid	Building construction	Not used.
Cleaning solvents	Perchloroethylene, methylene chloride, trichloroethylene, petroleum distillates	No equipment cleaning allowed in project limits	Solvents will be contained to lined drain area.
Asphalt	Oil, petroleum distillates	Streets and roofing	Roofing debris will be hauled away or disposed in contained dumpster.
Concrete	Limestone, sand, pH, chromium	Curb and gutter, building construction	Debris will be hauled away or disposed in contained dumpster.
Glue, adhesives	Polymers, epoxies	Building construction	Debris will be hauled away or disposed in contained dumpster.

Material/Chemical	Storm Water Pollutants	Common Location*	Pollution Prevention Methods
Paints	Metal oxides, Stoddard solvent, talc, calcium carbonate, arsenic	Building construction	Debris will be hauled away or disposed in contained dumpster.
Curing compounds	Naphtha	Curb and gutter	Debris will be hauled away or disposed in contained dumpster.
Wood preservatives	Stoddard solvent, petroleum distillates, arsenic, copper, chromium	Timber pads and building construction	Contaminated soil will be removed from site.
Hydraulic oil/fluids	Mineral oil	Leaks or broken hoses from equipment	Contaminated soil will be removed from site.
Gasoline	Benzene, ethyl benzene, toluene, xylene, MTBE	Secondary containment/staging area	Contaminated soil will be removed from site.
Diesel Fuel	Petroleum distillate, oil & grease, naphthalene, xylenes	Secondary containment/staging area	Contaminated soil will be removed from site.
Kerosene	Coal oil, petroleum distillates	Secondary containment/staging area	Contaminated soil will be removed from site.
Antifreeze/coolant	Ethylene glycol, propylene glycol, heavy metals (copper, lead, zinc)	Leaks or broken hoses from equipment	Contaminated soil will be removed from site.
Sanitary toilets	Bacteria, parasites, and viruses	Staging area	Pumping will occur on regular basis.

*(Area where material/chemical is used on-site)

6. Spill Prevention and Response Plan

Describe the spill prevention and control plan to include ways to reduce the chance of spills, stop the source of spills, contain and cleanup spills, dispose of materials contaminated by spills, and train personnel responsible for spill prevention and control. Additionally, fill in all **BLUE** fields below.

Spill Plan:

Contractor and sub-contractors will be responsible for managing crews to reduce spillage. Contractor will meet with sub-contractors before construction phases begin to review spill policies. Should a spill occur the will notify the contractor immediately of any spillage or contamination of soils on the property. Immediate action will be taken to remove any contaminated soils from the property and contractor will notify the National Response Center and the Division of Water Quality (DWQ) as soon as practical after knowledge of the spill is known to the permittee.

Any discharges in 24 hours equal to or in excess of the reportable quantities listed in 40 CFR 117, 40 CFR 110, and 40 CFR 302 will be reported to the National Response Center and the Division of Water Quality (DWQ) as soon as practical after knowledge of the spill is known to the permittee. The permittee shall submit within 14 calendar days of knowledge of the release a written description of: the release (including the type and estimate of the amount of material released), the date that such release occurred, the circumstances leading to the release, and measures taken and/or planned to be taken to the Division of Water Quality (DWQ), 288 North 1460 West, P.O. Box 144870, Salt Lake City, Utah 84114-4870. The Storm Water Pollution Prevention Plan must be modified within 14 calendar days of knowledge of the release to provide a description of the release, the circumstances leading to the release, and the date of the release. In addition, the plan must be reviewed to identify measures to prevent the reoccurrence of such releases and to respond to such releases, and the plan must be modified where appropriate.

Agency	Phone Number
National Response Center	(800) 424-8802
Division of Water Quality (DWQ) 24-Hr Reporting	(801) 538-6146; (801) 536-4123
Utah Department of Health Emergency Response	(801) 580-6681
Weber Fire District	(801) 782-3580

Minimum spill quantities requiring reporting:

Material	Media Released To	Reportable Quantity
Engine oil, fuel, hydraulic & brake fluid	Land	25 gallons
Paints, solvents, thinners	Land	100 lbs (13 gallons)
Engine oil, fuel, hydraulic & brake fluid	Water	Visible Sheen
Refrigerant	Air	1 lb
Antifreeze, battery acid, gasoline, engine degreasers	Air, Land, Water	100 lbs (13 gallons)

Emphasis to:

- 1st Priority: Protect all people (including onsite staff)
- 2nd Priority: Protect equipment and property
- 3rd Priority: Protect the environment

1. Make sure the spill area is safe to enter and that it does not pose an immediate threat to health or safety of any person.
2. Check for hazards (flammable material, noxious fumes, cause of spill) – if flammable liquid, turn off engines and nearby electrical equipment. If serious hazards are present leave area and call 911. LARGE SPILLS ARE LIKELY TO PRESENT A HAZARD.
3. Stop the spill source and contain flowing spills immediately with spill kits, dirt or other material that will achieve containment.
4. Call co-workers and supervisor for assistance and to make them aware of the spill and potential dangers
5. If spilled material has entered a storm sewer, regardless of containment; contact the City Storm Water Division.

6. Cleanup all spills (flowing or non-flowing) immediately following containment. Clean up spilled material according to manufacturer specifications, for liquid spills use absorbent materials AND DO NOT FLUSH AREA WITH WATER.
7. Properly dispose of cleaning materials and used absorbent material according to manufacturer specifications.
8. Report the reportable quantity to the Weber Morgan Health Department (801) 399-7100.

Emergency Numbers

Utah Hazmat Response Officer 24 hrs	(801)-538-3745
Weber County Sheriff Department	(801)-778-6600
Weber County Engineering Division	(801)399-8374

7. SWPPP, Inspections and Corrective Action Reports

Inspection Schedule and Procedures: The permit requires inspections once a week (see permit Part 3). You must list and provide details of your BMPs in Appendix G. Inspection reports require reporting on BMPs and how effective they are (download inspection reports from the DWQ construction storm water website under the Common Plan Permit). You may be required to maintain, modify, remove, or apply/install more or different BMPs to control pollutants on the site. Please number your BMPs in Appendix G and refer to those numbers on your inspection reports and corrective action reports when you inspect or report on them.

Describe the general procedures for correcting problems when they are identified. Include responsible staff and time frames for making corrections:

Log will be maintained on site to maintain inspection records. Contractor will identify the responsible party and will contact them immediately to report the reported condition and will take corrective measures as soon as possible. Should the responsible party fail to make corrections to avoid future offenses. Contractor will replace responsible parties that do not comply to the site SWPPP plan.

Inspections and Corrective Actions: All inspections and corrective actions must be logged using the "Inspection/Correction Action Log" attached in Appendix E. The log should be filled out completely for each BMP.

8. Training of Sub-Contractors

All sub-contractors, installers of utility connections, and others that perform activities that are affected by permit requirements will be informed about permit requirements that pertain to their scope of work.

Sub-Contractors that have been informed:

Contractor	Date	Topic(s) Covered	Initials of Trainer
Excavator			
Gas utilities			
Plumbing connection			
Electrical connection			
Concrete foundation walls			
Concrete flat work			
Landscaper			
Other: Asphalt Contractor			
Other: Click here to enter text.			
Other: Click here to enter text.			
Other: Click here to enter text.			

9. Changes to the SWPPP

All changes to this SWPPP must be redlined, dated, and initialed in the SWPPP document and on the site map.

10. Record Keeping

The following items should be kept at the project site available for inspectors to review:

1. A copy of the Common Plan Permit (Appendix B)
2. The signed and certified NOI form (Appendix C)
3. Inspection reports (Appendix E)

11. Delegation of Authority (if any)

Duly Authorized Representatives or Positions:

Company/Organization: Company of Representative.

Name: Glade McCombs

Position: Owner

Address: 88 E 250 N #11

City: Morgan

Telephone: 801-330-1040

State: UT

Zip: 84050

Fax/Email: glade@gladesells.com

Owner/General Contractor Signature: _____ Date: _____

12. Discharge Information

Does your project/site discharge storm water into a Municipal Separate Storm Sewer System (MS4)?
 Yes No

Municipal Storm Drain System receiving the discharge from the construction project: Weber County

Receiving Waters (look up <http://mapserv.utah.gov/surfacewaterquality/> to identify your receiving water body)

Enter the name(s) of the first surface water(s) that receives storm water directly from your site and/or from the MS4 listed above. **Note:** *multiple rows provided in the case that your site has more than one point of discharge in which each flows to different surface waters.*

1. **South Fork Ogden River and tributaries from Pineview Reservoir to Causey Reservoir**
2. Click here to enter name of receiving waters.
3. Click here to enter name of receiving waters.
4. Click here to enter name of receiving waters.

Impaired Waters (refer to <http://mapserv.utah.gov/surfacewaterquality/> in the left hand column to determine status of receiving water body).

Select any impaired surface water(s) that your site will discharge to, either directly or through the MS4 selected above.

Impaired Surface Water	Is this surface water impaired?	Pollutant(s) causing the impairment	Has a TMDL been completed?	Pollutant(s) for which there is a TMDL
South Fork Ogden River and tributaries from Pineview Reservoir to Causey Reservoir	<input type="checkbox"/> Yes <input checked="" type="checkbox"/> No	Click here to enter text.	<input type="checkbox"/> Yes <input checked="" type="checkbox"/> No	Click here to enter text.
Click here to enter text.	<input type="checkbox"/> Yes <input type="checkbox"/> No	Click here to enter text.	<input type="checkbox"/> Yes <input type="checkbox"/> No	Click here to enter text.

13. Certification and Notification

I, Glade McCombs, certify under penalty of law that this document and all attachments were prepared under my direction or supervision in accordance with a system designed to assure that qualified personnel properly gathered and evaluated the information submitted. Based on my inquiry of the person or persons who manage the system, or those persons directly responsible for gathering the information, the information submitted is, to the best of my knowledge and belief true, accurate, and complete. I am aware that there are significant penalties for submitting false information, including the possibility of fine and imprisonment for knowing violations.

X

Construction Operator:

This SWPPP should be signed and certified by the construction operator(s).

SWPPP Appendices

Ensure the following documentation is attached to the SWPPP:

Appendix A: SWPPP Site Maps

Appendix B: Common Plan Permit

Appendix C: Notice of Intent (NOI), and a copy of the NOT form unless you plan to terminate the permit on-line

Appendix D: Daily Site Check Log

Appendix E: Inspection Reports and Corrective Actions

Appendix F: Additional Information (i.e. permits such as local permits, dewatering, stream alteration, wetland, and out of date SWPPP documents, delegation of authority forms, etc.)

Appendix G: BMP Specifications and Details (label BMPs to match the sections identified in this document.)

APPENDIX A: SWPPP Site Maps

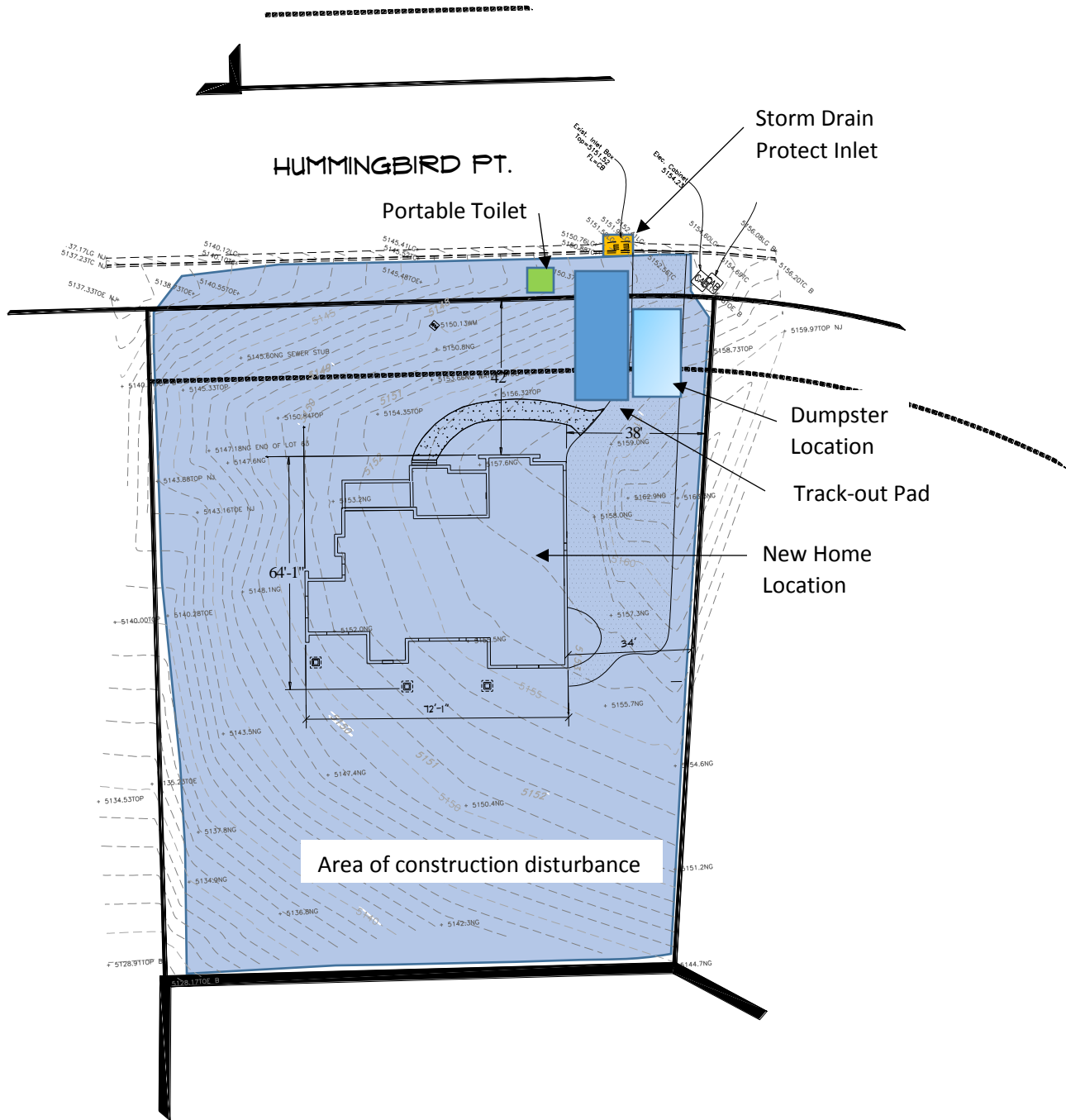

Storm Water Pollution Prevention Plan Template (SWPPP)
Common Plan Permit



APPENDIX B: Common Plan Permit

Find the permit on <https://deq.utah.gov/legacy/permits/water-quality/utah-pollutant-discharge-elimination-system/docs/2016/02feb/updes-common-plan.pdf>

APPENDIX C: Notice of Intent and Termination.

Find the Notice of Termination Form at

<https://deg.utah.gov/Permits/water/updes/stormwatercon.htm>

However, termination of the project can be done on-line at <https://secure.utah.gov/stormwater>

(You must log in using the same username that you applied for your NOI with. If you completed a paper NOI you must complete a paper NOT.)

APPENDIX E: Inspection Reports

APPENDIX F: Additional Information

For permits such as local permits, dewatering, stream alteration, wetland, and out of date SWPPP documents, delegation of authority forms, etc.

Delegation of Authority

I, Glade McCombs, hereby designate the person or specifically described position below to be a duly authorized representative for the purpose of overseeing compliance with environmental requirements, including the Common Plan Permit, at the 6169 E Hummingbird Pt., Huntsville, Utah construction site. The designee is authorized to sign any reports, storm water pollution prevention plans and all other documents required by the permit.

Glade McCombs (name of person or position)
88 E 250 N #11 (address)
Morgan, UT 84050 (city, state, zip)
801-330-1040 (phone)

By signing this authorization, I confirm that I meet the requirements to make such a designation as set forth in _____ (Reference State Permit), and that the designee above meets the definition of a “duly authorized representative” as set forth in _____ (Reference State Permit).

I certify under penalty of law that this document and all attachments were prepared under my direction or supervision in accordance with a system designed to assure that qualified personnel properly gathered and evaluated the information submitted. Based on my inquiry of the person or persons who manage the system, or those persons directly responsible for gathering the information, the information submitted is, to the best of my knowledge and belief, true, accurate, and complete. I am aware that there are significant penalties for submitting false information, including the possibility of fine and imprisonment for knowing violations.

Name: Glade McCombs
Title: Owner/Contractor

Signature:

Date:

APPENDIX G: BMP Specifications and Details

Backfilling area previously excavated or trenched. BMP 01

GENERAL REQUIREMENT: ALL ACTIVITIES MUST MEET OPACITY REQUIREMENTS IN R307-309-5

Stabilize backfill material when not actively handling.

01-01 Water backfill material to maintain moisture or to form crust.

Stabilize backfill material during handling.

01-04 Empty loader bucket slowly and minimize drop height from loader bucket.

Stabilize soil at completion of backfilling activity.

01-09 Apply water and maintain disturbed soils in a stable condition.

Clearing for site preparation and vacant land cleanup. BMP 03

GENERAL REQUIREMENT: ALL ACTIVITIES MUST MEET OPACITY REQUIREMENTS IN R307-309-5

Stabilize surface soils where support equipment and vehicles will operate.

03-01 Pre-water and maintain surface soils in a stabilized condition.

Stabilize disturbed soil immediately after clearing and grubbing activities.

03-03 Water disturbed soils to form crust.

Stabilize slopes at completion of activity.

03-06 Apply water and maintain sloping surfaces/wind breaks in a crusted condition.

Clearing forms, foundations, slab clearing and cleaning of forms, foundations and slabs prior to pouring concrete. BMP 04

GENERAL REQUIREMENT: ALL ACTIVITIES MUST MEET OPACITY REQUIREMENTS IN R307-309-5

04-01 Use water spray to clear forms, foundations and slabs.

Cut and fill soils for site grade preparation. BMP 06

GENERAL REQUIREMENT: ALL ACTIVITIES MUST MEET OPACITY REQUIREMENTS IN R307-309-5

Stabilize surface soils where support equipment and vehicles will operate.

06-01 Pre-water and maintain surface soils in a stabilized condition.

Pre-water soils.

06-03 Dig a test hole to depth of cut or equipment penetration to determine if soils are moist at depth. Continue to pre-water if not moist to depth of cut.

Stabilize soil during cut activities.

06-04 Apply water to depth of cut prior to subsequent cuts.

Stabilize soil after cut and fill activities.

06-05 Water disturbed soils to maintain moisture.

Disturbed soil throughout project including between structures. BMP 09

GENERAL REQUIREMENT: ALL ACTIVITIES MUST MEET OPACITY REQUIREMENTS IN R307-309-5

Limit disturbance of soils where possible.

09-01 Limit disturbance of soils with the use of fencing, barriers, barricades, and/or wind barriers.

Stabilize and maintain stability of all disturbed soil throughout construction site.

09-03 Apply water to stabilize disturbed soils. Soil moisture must be maintained such that soils can be worked without generating fugitive dust.

Hauling materials. BMP 11

GENERAL REQUIREMENT: ALL ACTIVITIES MUST MEET OPACITY REQUIREMENTS IN

R307-309-5

Limit visible dust opacity from vehicular operations.

11-02 Limit vehicle mileage and speed.

Stabilize materials during transport on site.

11-03 Use tarps or other suitable enclosures on haul trucks.

Clean wheels and undercarriage of haul trucks prior to leaving construction site.

11-05 Clean wheels.

Stockpiles materials (storage), other soils, rock or debris, for future use or export. BMP 16

GENERAL REQUIREMENT: ALL ACTIVITIES MUST MEET OPACITY REQUIREMENTS IN R307-309-5

Stabilize surface soils where support equipment and vehicles will operate.

16-01 Pre-water and maintain surface soils in a stabilized condition.

Stabilize stockpile materials during handling.

16-04 Remove material from the downwind side of the stockpile, when safe to do so.

Stabilize stockpiles after handling.

16-12 Avoid steep sides to prevent material sloughing

Trackout Prevention and Cleanup of mud, silt and soil tracked out onto paved roads. BMP 18

18-08 Clearly establish and enforce traffic patterns to route traffic over selected trackout control device(s).

Trenching with track or wheel mounted excavator, shovel, backhoe or trencher. BMP 20

GENERAL REQUIREMENT: ALL ACTIVITIES MUST MEET OPACITY REQUIREMENTS IN R307-309-5

Presoak soils prior to trenching activities.

20-01 Pre-water surface.

Stabilize surface soils where trenching equipment, support equipment and vehicles will operate.

20-04 Limit mileage and speed.

Stabilize soils after trenching.

20-05 Apply and maintain water on excavated soil.

Truck loading with materials including construction and demolition debris, rock and soil. BMP 21

GENERAL REQUIREMENT: ALL ACTIVITIES MUST MEET OPACITY REQUIREMENTS IN R307-309-5

21-03 Empty loader bucket slowly and keep loader bucket close to the truck to minimize the drop height while dumping.

Below are links to various Construction Storm Water BMP Manuals for reference.

Utah Department of Environmental Quality

<https://deq.utah.gov/legacy/permits/water-quality/utah-pollutant-discharge-elimination-system/example-appendix-g-bmp.htm>

Example Appendix G BMP Specifications and Details Construction Storm Water (UPDES)

Weber County

http://www.webercountyutah.gov/Engineering/swm/construction_bmp.php

Construction Best Management Practices