

Weber County Stormwater Construction Activity Permit

Application submittals will be accepted by appointment only. (801) 399-8374. 2380 Washington Blvd. Suite 240, Ogden, UT 84401

Date Submitted 2-14-19	Fees (Office Use) \$150.00	Receipt Number (Office Use)	Priority Site (Office Use) <input type="radio"/> Yes <input type="radio"/> No	Permit Number (Office Use) 2019-09
Property Owner/Authorized Representative Contact Information			Project Information	
Name of Property Owner(s)/Authorized Representative(s) JES STAMA			Project Name Gilks Residence.	
Phone 801-430-6622		Project Address 2337 W Hwy 158. EDEN UT 84310		
Email Address JES@JSC-BUILDERS.COM			Estimated Project Length (mo) 6	
Mailing Address of Property Owner(s)/Authorized Representative(s) 1245 S 9400 E Huntsville UT 84317			Previous Permit No. (if applicable)	
			Estimated Start Date 3-1-19.	
			Actual Start Date	

Submittal Checklist

The application shall include a Storm Water Pollution Prevention Plan which meets the criteria set forth in Section 33-3-4 of the county ordinances.

The applicant shall file the application on or before the following dates:

Subdivision: The date that the applicant submits the preliminary subdivision development plat application.

Site Plan: The date that the applicant submits a site plan application or amended site plan.

Building Permit: The date that the applicant submits a building permit application if the applicant proposes to construct a building on an existing lot or parcel.

Land Use Permit: The date that the applicant submits a land use permit application.

Other: At least two (2) weeks before the developer intends to perform any type of work not listed above that would require a Storm Water Construction Activity Permit pursuant to this Chapter.

Failure to acquire a required Storm Water Construction Activity Permit is grounds for tabling a related subdivision application, site plan application, conditional use permit application, or building permit application. It is unlawful to commence work (move dirt) on a development site before obtaining a required Storm Water Construction Activity Permit.

Note: A pre-construction meeting is required before performing any on-site earth work, unless waived by the county engineer.

Applicant Narrative

Please explain your request.

Permit for single family dwelling

Authorization

By signing below the Owner / Representative authorizes the county to enter the property to perform inspections.

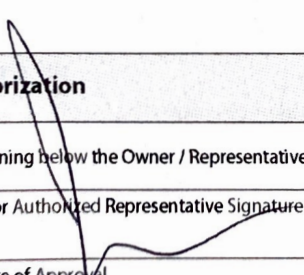
Owner or Authorized Representative Signature 	Date 2-14-19
Signature of Approval Tucker Weight	Date 2/26/19

BASIC SWPPP EXAMPLE STORMWATER POLLUTION PREVENTION PLAN

Answers

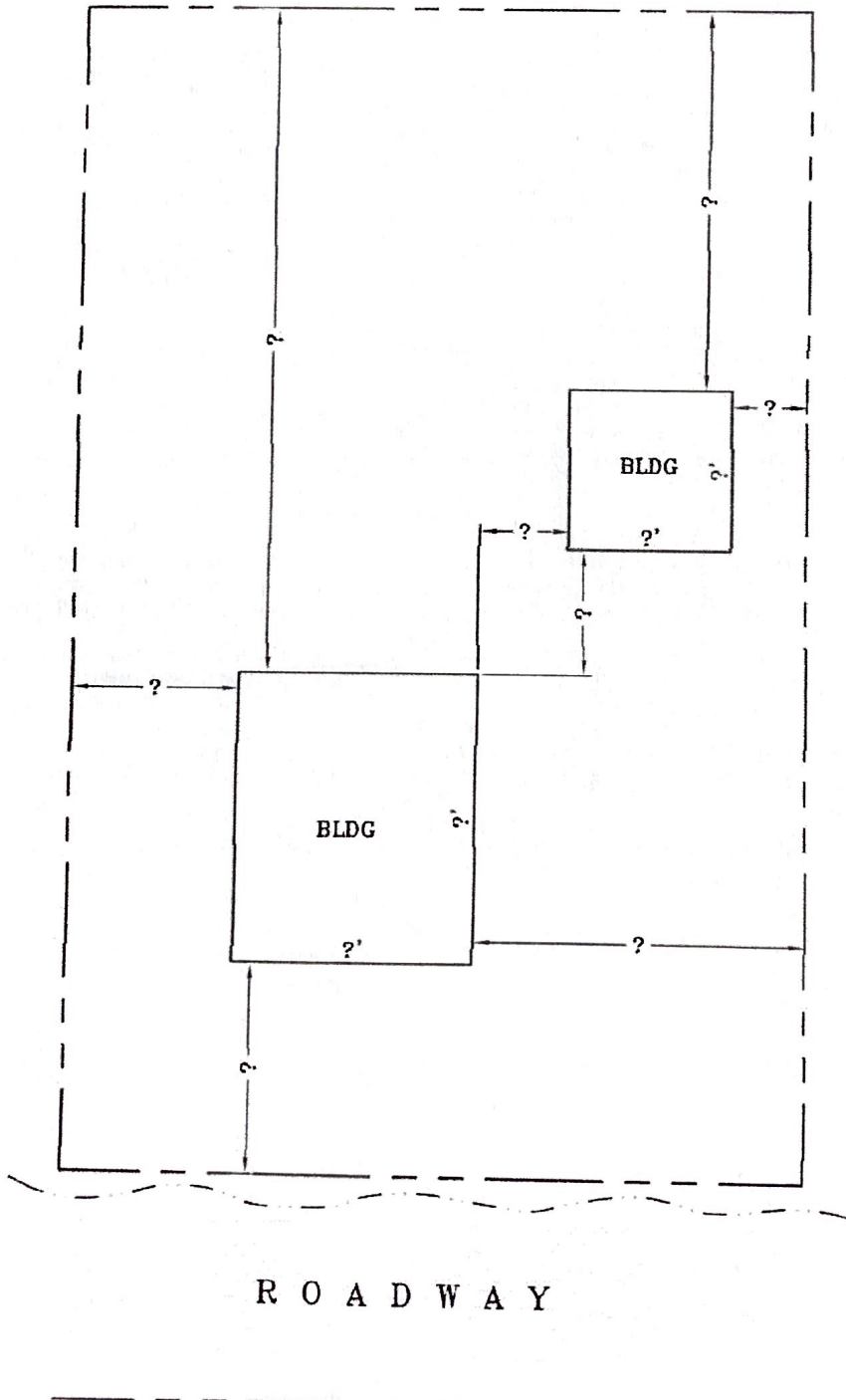

1. HOW MUCH AREA WILL BE DISTURBED? *1/2 acres*
2. WHO WILL BE RESPONSIBLE FOR THE CONDITIONS OF THE SITE DURING CONSTRUCTION? *SWPPP*
3. WHAT WILL BE DONE TO PREVENT THE NEIGHBORS FROM BEING AFFECTED BY THE PROPOSED CONSTRUCTION ACTIVITIES? *There will be none.*
4. WHAT WILL BE DONE WITH ALL EXCAVATED MATERIAL TEMPORARILY AND PERMANENTLY? *Put in a pile*
5. WHERE IS THE CONCRETE WASHOUT & HOW WILL IT BE MAINTAINED? *Noted on SWPPP plan*
6. WHERE ARE THE PORTA-JOHN'S LOCATED AND HOW ARE THEY INSTALLED? *Noted on SWPPP*
7. HOW WILL THE CONSTRUCTION ENTRANCE BE BUILT AND WHERE WILL IT BE LOCATED? *Noted on SWPPP*
8. WHAT WILL YOU DO WHEN MUD AND/OR DIRT GETS TRACKED ON THE ASPHALT? *Clean it off.*
9. IS THERE A DRAINAGE DITCH OR SWALE ON OR NEAR YOUR PROPERTY? HOW WILL IT BE PROTECTED? *No*
10. WHAT CURRENTLY HAPPENS TO THE RAIN/STORM WATER WHEN IT REACHES THIS PROJECT SITE? *Soaks in.*
11. SHOW ALL EXISTING OCCUPATION ON THE PROPERTY. *⊗*