

Landscape Calculations

Total Site Area:	32,989 Sf	33,431 sq ft	
Total Landscaped Area:	11,432 Sf	24.5% of Total Site Area	9804 sq ft = 29.3%
Total Live Plant Area:	9,589 Sf	83.0% of Total Landscaped Area	8495 sq ft = 86.6%
Total Lawn:	2,817 Sf	22.7% of Total Landscaped Area	1969 sq ft = 23.1%
Total Disturbance Area:	35,093 Sf	75.3% of Total Site Area	39,810 sq ft

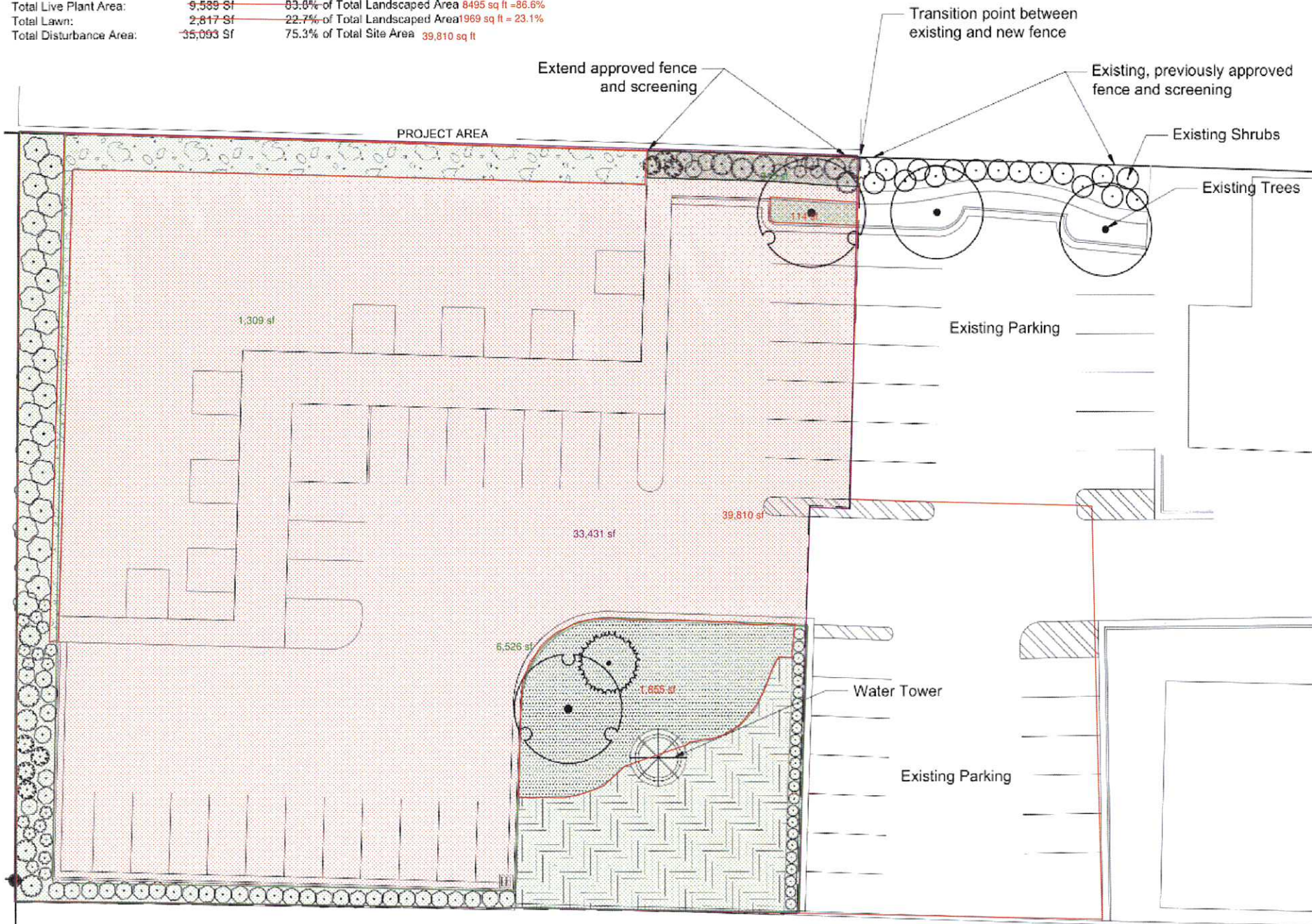

LANDSCAPE NOTES:

ANY ALTERATIONS TO THESE DRAWINGS DURING CONSTRUCTION SHALL BE REPORTED TO THE OWNER'S REPRESENTATIVE AND RECORDED ON "AS BUILT" DRAWINGS BY THE CONTRACTOR.

ALL PLANT MATERIAL SHALL CONFORM TO THE MINIMUM GUIDELINES ESTABLISHED BY THE AMERICAN STANDARD FOR NURSERY STOCK PUBLISHED BY THE AMERICAN NURSERY ASSOCIATION INC.

ALL PLANTS TO BE BALLED AND BURLAPPED OR CONTAINER GROWN, UNLESS OTHERWISE NOTED ON THE PLANTS LIST.

THE CONTRACTOR SHALL SUPPLY ALL PLANT MATERIAL IN QUANTITIES SUFFICIENT TO COMPLETE THE PLANTING SHOWN ON THE DRAWINGS.

ANY PROPOSED SUBSTITUTIONS OF PLANT SPECIES SHALL BE MADE WITH PLANTS OF EQUIVALENT OVERALL FORM, HEIGHT, BRANCHING HABIT, FLOWER, LEAF, COLOR, FRUIT AND CULTURE ONLY AS APPROVED THE OWNER'S REPRESENTATIVE.

ALL PLANTS SHALL BE TAGGED AND APPROVED BY THE OWNER'S REPRESENTATIVE AT THE NURSERY PRIOR TO DIGGING OR DELIVERY TO SITE.

THE CONTRACTOR SHALL LOCATE AND VERIFY ALL EXISTING UTILITY LINES PRIOR TO PLANTING AND SHALL REPORT ANY CONFLICTS TO THE OWNERS REPRESENTATIVE

STAKE LOCATION OF ALL PROPOSED PLANTING FOR APPROVAL BY THE OWNER'S REPRESENTATIVE PRIOR TO THE COMMENCEMENT OF PLANTING.

ALL PLANT BEDS TO RECEIVE 3" COMPOSTED BARK MULCH.

ALL EXISTING TREES TO REMAIN SHALL BE PROPERLY PROTECTED DURING CONSTRUCTION. PROTECTION TECHNIQUES SHALL BE REVIEWED AND APPROVED BY THE OWNERS REPRESENTATIVE.

PLANT SCHEDULE

TREES	BOTANICAL NAME / COMMON NAME	CONT.	QTY	
	Aves cendace / White Fir	—	1	
	Existing Tree	—	2	
	Fraxinus pennsylvanica 'Summit' / Summit Ash	—	2	
SHRUBS	BOTANICAL NAME / COMMON NAME	SIZE	QTY	
	Existing Shrub	—	24	
	Juniperus sabina Tam. / Tam's Juniper	—	39	
	Rhus aromatica 'Gro-Low' / Gro-Low Fragrant Sumac	—	25	
	Spirea japonica 'Snowmound' / Snowmound Spirea	—	22	
	Spirea x var. 'Heutel' / Spirea	—	11	
	Syringa palua 'Miss Kim' / Miss Kim Lilac	—	7	
GROUND COVERS	BOTANICAL NAME / COMMON NAME	COUNT	SPACING	QTY
	Lawn	—	—	2,817 sq ft
	Reseal Seed Mix	—	—	2,087 sq ft
	Gravel Over Wood Barrier	—	—	1,825 sq ft

SEED MIX

BOTANICAL NAME	COMMON NAME	SEED RATES
<i>Bouteloua curtipendula</i>	Sideoats Grama	1 PLS lbs/acre
<i>Bouteloua dactyloides</i>	Buffalograss	2 PLS lbs/acre
<i>Bouteloua gracilis</i>	Blue Grama	1 PLS lbs/acre
<i>Deschampsia cespitosa</i>	Northern Lights	1 PLS lbs/acre
<i>Festuca ovina</i>	Sheep Fescue	2 PLS lbs/acre

NOTE: VERIFY SEED MIX AND APPLICATION RATES WITH GRANITE SEED COMPANY OR APPROVED EQUAL.

STAMP

CONSULTANTS



PROJECT
EDEN BLACKSMITH
EDEN, UT

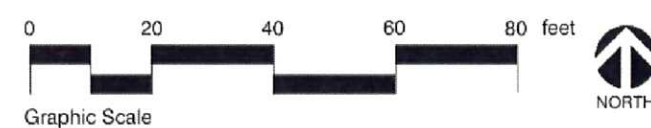

PL-101
PLANTING PLAN