

Weber County Stormwater Construction Activity Permit

Application submittals will be accepted by appointment only. (801) 399-8374. 2380 Washington Blvd. Suite 240, Ogden, UT 84401

Date Submitted 2/1/2019	Fees (Office Use) \$150.00	Receipt Number (Office Use)	Priority Site (Office Use) <input type="radio"/> Yes <input type="radio"/> No	Permit Number (Office Use) 2019-07
----------------------------	-------------------------------	-----------------------------	--	---------------------------------------

Property Owner/Authorized Representative Contact Information		Project Information	
Name of Property Owner(s)/Authorized Representative(s) DAVID PETERSON		Project Name COOK RESIDENCE	
Phone (801) 710-6065	Fax —	Project Address 2174 E 5850 N LIBERTY, UT 84310	
Email Address DAVID@PETERSONBUILDERS.COM		Estimated Project Length (mo) 12 mo.	Previous Permit No. (if applicable)
Mailing Address of Property Owner(s)/Authorized Representative(s) 4794 2600 N EDEN, UT 84310		Estimated Start Date 04/19	Actual Start Date

Submittal Checklist

The application shall include a Storm Water Pollution Prevention Plan which meets the criteria set forth in Section 33-3-4 of the county ordinances.

The applicant shall file the application on or before the following dates:

Subdivision: The date that the applicant submits the preliminary subdivision development plat application.

Site Plan: The date that the applicant submits a site plan application or amended site plan.

Building Permit: The date that the applicant submits a building permit application if the applicant proposes to construct a building on an existing lot or parcel.

Land Use Permit: The date that the applicant submits a land use permit application.

Other: At least two (2) weeks before the developer intends to perform any type of work not listed above that would require a Storm Water Construction Activity Permit pursuant to this Chapter.

Failure to acquire a required Storm Water Construction Activity Permit is grounds for tabling a related subdivision application, site plan application, conditional use permit application, or building permit application. It is unlawful to commence work (move dirt) on a development site before obtaining a required Storm Water Construction Activity Permit.

Note: A pre-costruction meeting is required before performing any on-site earth work, unless waived by the county engineer.

Applicant Narrative

Please explain your request.

Authorization

By signing below the Owner / Representative authorizes the county to enter the property to perform inspections.

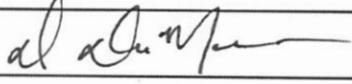
Owner or Authorized Representative Signature 	Date 2/1/19
Signature of Approval Tucker Weight	Date 2/7/2019

COOK SWPPP PLAN

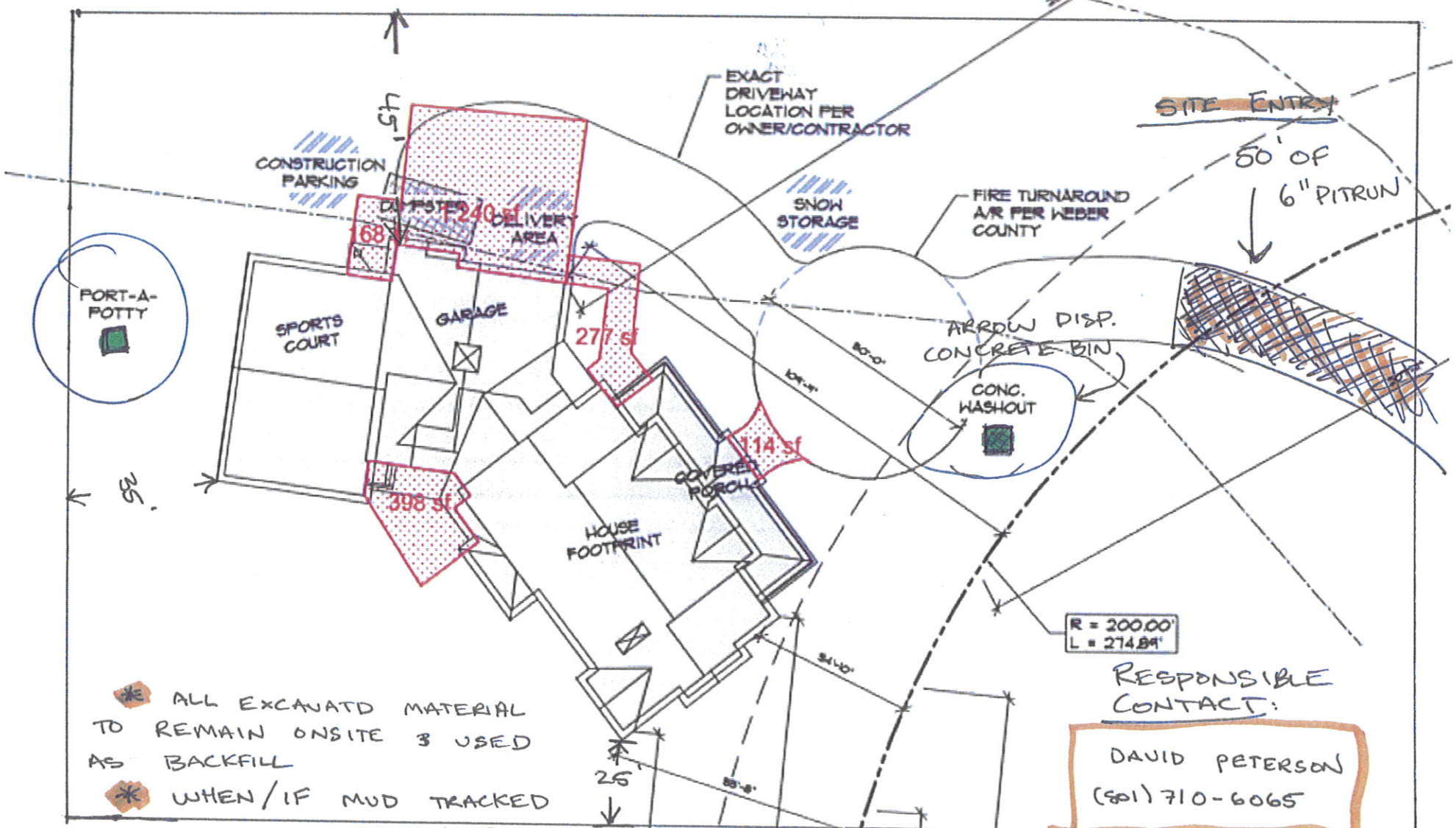

- * ALL EXCAVATED MATERIAL TO REMAIN ONSITE & USED AS BACKFILL
- * WHEN/IF MUD TRACKED INTO ROAD, IT WILL BE SCRAPPED & CLEANED.
- * 15" CONCRETE CULVERT TO BE PLACED AT DRIVEWAY PER COUNTY REVIEW

R = 200.00'
L = 274.89'

RESPONSIBLE CONTACT:
DAVID PETERSON
(501) 710-6065