

FENSTER FARM SUBDIVISION PHASE 2

PART OF THE SOUTHEAST QUARTER OF SECTION 7, TOWNSHIP 6 NORTH, RANGE 2 WEST, SALT LAKE BASE AND MERIDIAN, U.S. SURVEY
WEBER COUNTY, UTAH
OCTOBER, 2018

DEVELOPER

ALLAN KARRAS
CENTURY 21
2609 N MAIN
SUNSET, UT
80415

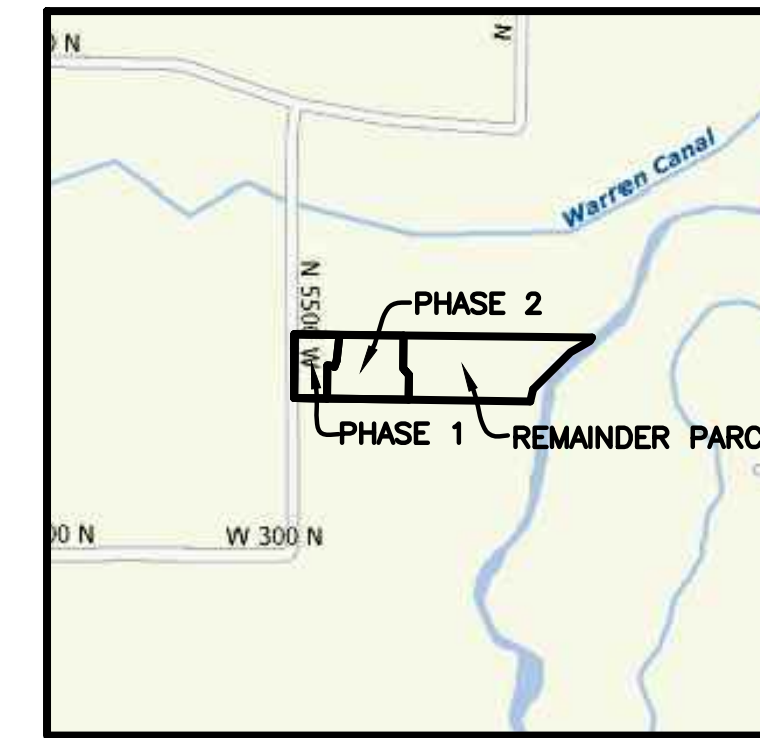

VICINITY MAP
NOT TO SCALE

CURVE TABLE

#	RADIUS	ARC LENGTH	CHD LENGTH	TANGENT	CHD BEARING	DELTA
C1	170.00'	64.54'	64.15'	32.66'	S78°31'53"E	21°45'09"
C2	170.00'	51.90'	51.70'	26.15'	S80°39'41"E	17°29'34"
C4	170.00'	50.74'	50.55'	25.56'	S63°21'50"E	17°06'06"
C5	170.00'	38.10'	38.02'	19.13'	S61°14'03"E	12°50'31"
C6	200.00'	44.83'	44.73'	22.51'	S61°14'03"E	12°50'31"
C7	230.00'	51.55'	51.44'	25.88'	S61°14'03"E	12°50'31"
C8	220.00'	117.89'	116.48'	60.40'	S70°09'52"E	30°42'10"
C9	220.00'	14.94'	14.94'	7.47'	S87°27'42"E	3°53'31"
C10	250.00'	150.95'	148.66'	77.85'	S72°06'37"E	34°35'40"
C11	280.00'	120.97'	120.03'	61.44'	S67°11'24"E	24°45'13"
C12	280.00'	48.09'	48.03'	24.10'	S84°29'14"E	9°50'27"

LEGEND

- = SECTION CORNER
- = 5/8" X 24" REBAR AND RED PLASTIC CAP TO BE SET STAMPED "REEVE & ASSOCIATES"
- = CENTERLINE MONUMENT
- = BOUNDARY LINE
- = LOT LINE
- = ADJOINING PROPERTY
- = EASEMENTS
- = SECTION TIE LINE
- = ROAD CENTERLINE
- = EXISTING FENCELINE

BASIS OF BEARINGS

THE BASIS OF BEARINGS FOR THIS PLAT IS THE SECTION LINE BETWEEN THE CENTER OF SECTION 7 AND THE SOUTH QUARTER CORNER OF SECTION 7, TOWNSHIP 6 NORTH, RANGE 2 WEST, SALT LAKE BASE AND MERIDIAN, U.S. SURVEY. SHOWN HEREON AS: S00°18'53"W

NARRATIVE

THE PURPOSE OF THIS PLAT IS TO DIVIDE THE BELOW DESCRIBED PROPERTY INTO LOTS AND STREETS AS SHOWN. THE NORTH BOUNDARY WAS SET ALONG AN EXISTING FENCELINE AS SHOWN ON A SURVEY BY C.L.S. (R.O.S. #1972). THE EAST LINE WAS DETERMINED BY THE CLIENT AS A DIVISION LINE BETWEEN PHASES. THE SOUTH LINE WAS SET ALONG AN EXISTING FENCELINE. THE DEED DESCRIPTION FOR PARCEL 15-024-0014 DID NOT CLOSE, THE ADJUSTMENT WAS MADE IN THE BOUNDARY TO CLOSE AND FIT OCCUPATION OF THE PROPERTY. ALL BOUNDARY AND LOT CORNERS TO BE SET WITH A 5/8" X 24" REBAR AND RED PLASTIC CAP STAMPED "REEVE & ASSOCIATES".

BOUNDARY DESCRIPTION

PART OF THE SOUTHEAST QUARTER OF SECTION 7, TOWNSHIP 6 NORTH, RANGE 2 WEST, SALT LAKE BASE AND MERIDIAN, U.S. SURVEY. DESCRIBED AS FOLLOWS:

BEGINNING AT THE NORTHEAST CORNER OF LOT 2 OF FENSTER FARM PHASE 1, SAID POINT BEING S00°18'53"W 688.26 FEET AND S89°41'07"E 409.65 FEET FROM THE CENTER OF SECTION 7; THENCE S89°24'27"E 582.94 FEET; THENCE S00°35'33"W 300.00 FEET; THENCE S41°41'50"E 81.05 FEET; THENCE S00°35'48"W 224.34 FEET; THENCE N89°10'55"W 745.09 FEET TO THE SOUTHEAST CORNER OF LOT 4 OF FENSTER FARMS PHASE 1; THENCE ALONG THE EASTERLY LINE OF FENSTER FARMS PHASE 1 THE FOLLOWING FOUR (4) COURSES: (1) N00°35'33"E 300.93 FEET; (2) ALONG A NON-TANGENT CURVE TURNING TO THE RIGHT WITH A RADIUS OF 170.00 FEET, AN ARC LENGTH OF 64.54 FEET, A DELTA ANGLE OF 21°45'09", A CHORD BEARING OF S78°31'53"E, A RADIAL BEARING OF S00°35'33"W, AND A CHORD LENGTH OF 64.15 FEET; (3) N22°20'41"E 60.00 FEET; AND (4) N05°59'34"E 237.87 FEET TO THE POINT OF BEGINNING.

CONTAINING 389816 SQUARE FEET OR 8.949 ACRES MORE OR LESS

AGRICULTURAL STATEMENT

"AGRICULTURE IS THE PREFERRED USE IN THE AGRICULTURAL ZONES. AGRICULTURAL OPERATIONS AS SPECIFIED IN THE ZONING ORDINANCE FOR A PARTICULAR ZONE ARE PERMITTED AT ANY TIME INCLUDING THE OPERATION OF FARM MACHINERY AND NO ALLOWED AGRICULTURAL USE SHALL BE SUBJECT TO RESTRICTION ON THE BASIS THAT IT INTERFERES WITH ACTIVITIES OF FUTURE RESIDENTS OF THIS SUBDIVISION." (AMD, ORD. #3-82, JANUARY 26, 1982; ORD. #2002-3, MARCH 05, 2002)



SURVEYOR'S CERTIFICATE

I, **TREVOR J. HATCH**, DO HEREBY CERTIFY THAT I AM A REGISTERED PROFESSIONAL LAND SURVEYOR IN THE STATE OF UTAH IN ACCORDANCE WITH TITLE 58, CHAPTER 22, PROFESSIONAL ENGINEERS AND LAND SURVEYORS ACT; AND THAT I HAVE COMPLETED A SURVEY OF THE PROPERTY DESCRIBED ON THIS PLAT IN ACCORDANCE WITH SECTION 17-23-17 AND HAVE VERIFIED ALL MEASUREMENTS, AND HAVE PLACED MONUMENTS AS REPRESENTED ON THIS PLAT, AND THAT THIS PLAT OF **FENSTER FARM SUBDIVISION PHASE 2** IN **WEBER COUNTY**, UTAH, HAS BEEN DRAWN CORRECTLY TO THE DESIGNATED SCALE AND IS A TRUE AND CORRECT REPRESENTATION OF THE HEREIN DESCRIBED LANDS INCLUDED IN SAID SUBDIVISION, BASED UPON DATA COMPILED FROM RECORDS IN THE **WEBER COUNTY** RECORDER'S OFFICE AND FROM SAID SURVEY MADE BY ME ON THE GROUND. I FURTHER CERTIFY THAT THE REQUIREMENTS OF ALL APPLICABLE STATUTES AND ORDINANCES OF **WEBER COUNTY** CONCERNING ZONING REQUIREMENTS REGARDING LOT MEASUREMENTS HAVE BEEN COMPLIED WITH.

SIGNED THIS _____ DAY OF _____, 20____.

9031945
UTAH LICENSE NUMBER **TREVOR J. HATCH**

OWNERS DEDICATION AND CERTIFICATION

WE THE UNDERSIGNED OWNERS OF THE HEREIN DESCRIBED TRACT OF LAND, DO HEREBY SET APART AND SUBDIVIDE THE SAME INTO LOTS AND STREETS AS SHOWN ON THE PLAT AND NAME SAID TRACT **FENSTER FARM SUBDIVISION PHASE 2**, AND DO HEREBY DEDICATE TO PUBLIC USE ALL THOSE PARTS OR PORTIONS OF SAID TRACT OF LAND DESIGNATED AS STREETS; THE SAME TO BE USED AS PUBLIC THOROUGHFARES AND ALSO TO GRANT AND DEDICATE A PERPETUAL RIGHT AND EASEMENT OVER, UPON AND UNDER THE LANDS DESIGNATED HEREON AS PUBLIC UTILITY, THE SAME TO BE USED FOR THE INSTALLATION MAINTENANCE AND OPERATION OF PUBLIC UTILITY SERVICE LINE, STORM DRAINAGE FACILITIES, IRRIGATION CANALS OR FOR THE PERPETUAL PRESERVATION OF WATER CHANNELS IN THEIR NATURAL STATE WHICHEVER IS APPLICABLE AS MAY BE AUTHORIZED BY THE GOVERNING AUTHORITY, WITH NO BUILDINGS OR STRUCTURES BEING ERRECTED WITHIN SUCH EASEMENTS AND HEREBY GRANT A TEMPORARY TURN AROUND EASEMENT AS SHOWN HEREON TO BE USED BY THE PUBLIC UNTIL SUCH TIME THAT THE ROAD IS EXTENDED, THE TEMPORARY TURN AROUND EASEMENT SHALL BE REVOKED AND NULLIFIED AT THE EVENT OF THE EXTENSION OF THE ROAD WITHOUT FURTHER WRITTEN DOCUMENT AND THE ENCUMBERED LAND WITHIN THE AFFECTED LOTS SHALL BE RELEASED FOR THE FULL AND EXCLUSIVE USE AND BENEFIT OF THE LOT OWNER AND ALSO TO DEDICATE PARCEL A TO WEBER COUNTY FOR DETENTION BASIN PURPOSES.

SIGNED THIS _____ DAY OF _____, 20____.

ACKNOWLEDGMENT

STATE OF UTAH)ss.
COUNTY OF _____)

ON THE _____ DAY OF _____, 20____, PERSONALLY APPEARED BEFORE ME, THE UNDERSIGNED NOTARY PUBLIC, _____ (AND) _____ SIGNER(S) OF THE ABOVE OWNER'S DEDICATION AND CERTIFICATION, WHO BEING BY ME DULY SWORN, DID ACKNOWLEDGE TO ME _____ SIGNED IT FREELY, VOLUNTARILY, AND FOR THE PURPOSES THEREIN MENTIONED.

COMMISSION EXPIRES _____ NOTARY PUBLIC

ACKNOWLEDGMENT

STATE OF UTAH)ss.
COUNTY OF _____)

ON THE _____ DAY OF _____, 20____, PERSONALLY APPEARED BEFORE ME, THE UNDERSIGNED NOTARY PUBLIC, _____ (AND) _____ BEING BY ME DULY SWORN, ACKNOWLEDGED TO ME THEY ARE _____ AND _____ OF SAID CORPORATION AND THAT THEY SIGNED THE ABOVE OWNER'S DEDICATION AND CERTIFICATION FREELY, VOLUNTARILY, AND IN BEHALF OF SAID CORPORATION FOR THE PURPOSES THEREIN MENTIONED.

COMMISSION EXPIRES _____ NOTARY PUBLIC

Project Info.

Surveyor: **T. HATCH**

Designer: **N. ANDERSON**

Begin Date: **10-16-18**

Name: **FENSTER FARM SUBDIVISION PHASE 2**

Number: **1714-26**

Revision: _____

Scale: **1"=50'**

Checked: _____



WEBER COUNTY PLANNING COMMISSION APPROVAL

THIS IS TO CERTIFY THAT THIS SUBDIVISION PLAT WAS DULY APPROVED BY THE WEBER COUNTY PLANNING COMMISSION. SIGNED THIS _____ DAY OF _____, 20____.

CHAIRMAN, WEBER COUNTY PLANNING COMMISSION

WEBER COUNTY ENGINEER

I HEREBY CERTIFY THAT THE REQUIRED PUBLIC IMPROVEMENT STANDARDS AND DRAWINGS FOR THIS SUBDIVISION CONFORM WITH THE COUNTY STANDARDS AND THE AMOUNT OF THE FINANCIAL GUARANTEE IS SUFFICIENT FOR THE INSTALLATION OF THESE IMPROVEMENTS.

WEBER COUNTY ENGINEER

WEBER COUNTY COMMISSION ACCEPTANCE

THIS IS TO CERTIFY THAT THIS SUBDIVISION PLAT, THE DEDICATION OF STREETS AND OTHER PUBLIC WORKS AND FINANCIAL GUARANTEE OF PUBLIC IMPROVEMENTS ASSOCIATED WITH THIS SUBDIVISION, THEREON ARE HEREBY APPROVED AND ACCEPTED BY THE COMMISSIONERS OF WEBER COUNTY, UTAH. SIGNED THIS _____ DAY OF _____, 20____.

CHAIRMAN, WEBER COUNTY COMMISSION

ATTEST

WEBER COUNTY SURVEYOR

I HEREBY CERTIFY THAT THE WEBER COUNTY SURVEYOR'S OFFICE HAS REVIEWED THIS PLAT FOR MATHEMATICAL CORRECTNESS, SECTION CORNER DATA, AND FOR HARMONY WITH LINES AND MONUMENTS ON RECORD IN COUNTY OFFICES. THE APPROVAL OF THIS PLAT BY THE WEBER COUNTY SURVEYOR DOES NOT RELIEVE THE LICENSED LAND SURVEYOR WHO EXECUTED THIS PLAT FROM THE RESPONSIBILITIES AND/OR LIABILITIES ASSOCIATED THEREWITH. SIGNED THIS _____ DAY OF _____, 20____.

WEBER COUNTY SURVEYOR

WEBER COUNTY ATTORNEY

I HAVE EXAMINED THE FINANCIAL GUARANTEE AND OTHER DOCUMENTS ASSOCIATED WITH THIS SUBDIVISION PLAT, AND IN MY OPINION THEY CONFORM WITH THE COUNTY ORDINANCE APPLICABLE THERETO AND NOW IN FORCE AND AFFECT. SIGNED THIS _____ DAY OF _____, 20____.

WEBER COUNTY ATTORNEY

WEBER-MORGAN HEALTH DEPARTMENT

I HEREBY CERTIFY THAT THE SOILS, PERCOLATION RATES, AND SITE CONDITIONS FOR THIS SUBDIVISION HAVE BEEN INVESTIGATED BY THIS OFFICE AND ARE APPROVED FOR ON-SITE WASTEWATER DISPOSAL SYSTEMS. SIGNED THIS _____ DAY OF _____, 20____.

WEBER-MORGAN HEALTH DEPARTMENT

Weber County Recorder

Entry No. _____ Fee Paid _____

And Recorded, _____

At _____ in Book _____

Of The Official Records, Page _____

Recorded For: _____

Weber County Recorder _____ Deputy.