

NOTE:
Bid documents should not be separated or issued as partial sets to subcontractors. Bidders are responsible for all portions of the documents that pertain to work covered by sub-bids. Bidder assumes full responsibility for error or misinterpretations resulting from partial sets of Bidding Documents by itself or any sub-bidder.

Conflicting information or errors found in the construction documents should be brought to the attention of the architect immediately. In the event of a conflict in the drawings, bidder should not assume the least expensive option will meet the project requirements.



MAVERIK, INC. STORE #250
5100 EAST & 2500 NORTH
EDEN, UTAH

SHEET TITLE
LANDSCAPE PLAN

L1

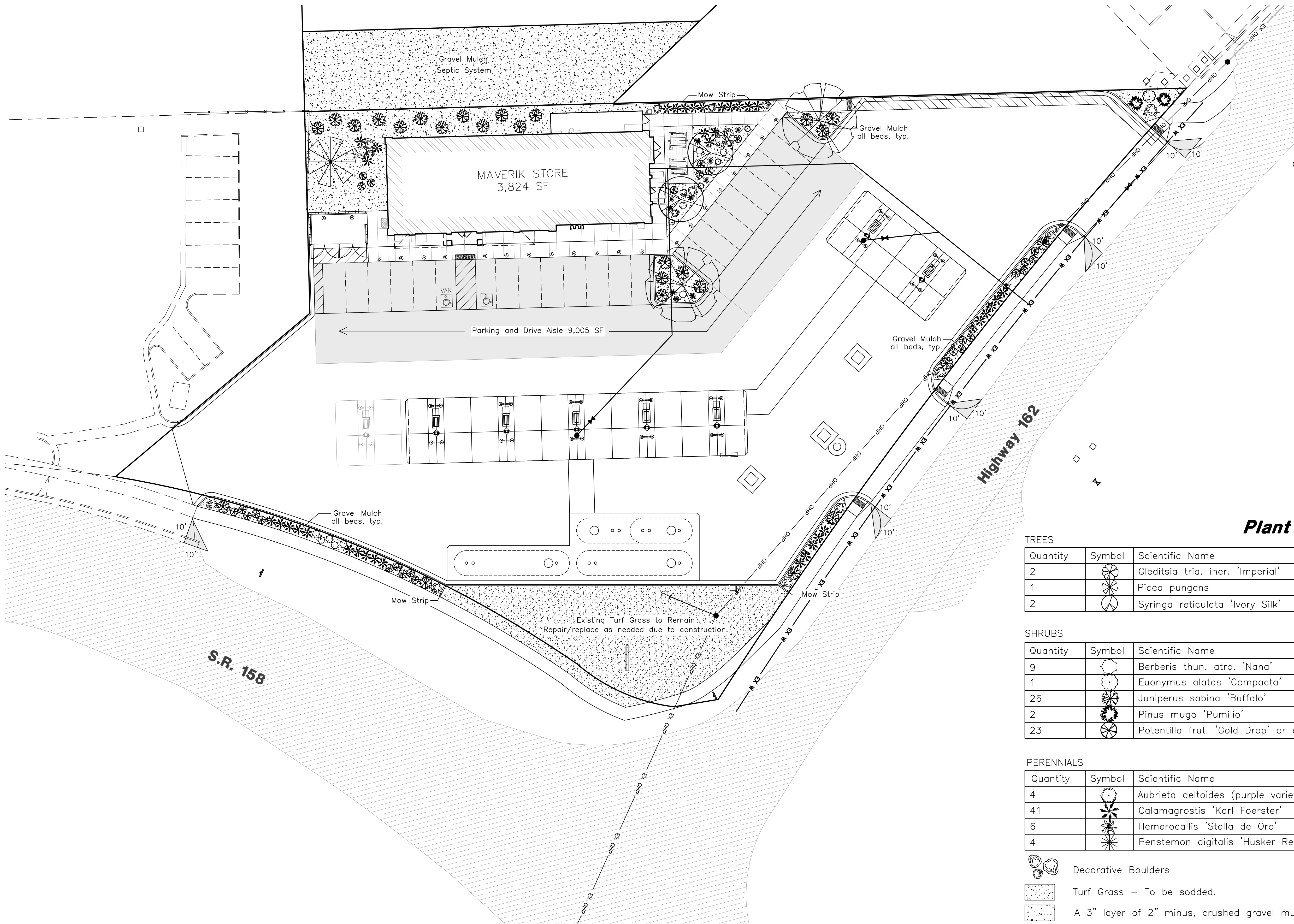

| Site Information | |
|------------------------------|--------------------------|
| APN# | 22-046-0083, 22-046-0070 |
| | 5100 EAST 2500 NORTH |
| | EDEN, WEBER COUNTY, UTAH |
| PROPERTY ZONE | CV-2, AV-3 |
| PARKING STALLS PROVIDED | 20 + 2 A.D.A. |
| BICYCLE STALLS PROVIDED | 3 |
| TOTAL PARCEL AREA | 114,143 s.f. |
| DRAINFIELD AREA | 51,595 s.f. |
| MAVERIK PARCEL AREA | 62,548 s.f. |
| BUILDING AREA | 3,824 s.f. 6.1% |
| HARD SURFACED AREA | 46,020 s.f. 73.6% |
| LANDSCAPE AREA | 12,704 s.f. 20.3% |
| INTERIOR LANDSCAPE | 1,651 18% |
| TURF GRASS | 4,063 s.f. 32% |
| 1 TREE/120 s.f. INT. LANDSCP | 4 TREES req/provided |

Plant Table

TREES

| Quantity | Symbol | Scientific Name | Common Name | Planting Size |
|----------|--------|----------------------------------|-----------------------|---------------|
| 2 | | Gleditsia tria. iner. 'Imperial' | Imperial Honeylocust | 2" cal. |
| 1 | | Picea pungens | Colorado Blue Spruce | 6' B&B |
| 2 | | Syringa reticulata 'Ivory Silk' | Ivory Silk Tree Lilac | 2" cal. |

SHRUBS

| Quantity | Symbol | Scientific Name | Common Name | Planting Size |
|----------|--------|---------------------------------------|-------------------------------|---------------|
| 9 | | Berberis thun. atro. 'Nana' | Crimson Pygmy Barberry | 5 gal. |
| 1 | | Euonymus alatus 'Compacta' | Dwarf Burning Bush | 5 gal. |
| 26 | | Juniperus sabina 'Buffalo' | Buffalo Juniper | 5 gal. |
| 2 | | Pinus mugo 'Pumilio' | Dwarf Mugo Pine | 5 gal. |
| 23 | | Potentilla frut. 'Gold Drop' or equal | Gold Drop Potentilla or equal | 5 gal. |

PERENNIALS

| Quantity | Symbol | Scientific Name | Common Name | Planting Size |
|----------|--------|-------------------------------------|-----------------------|---------------|
| 4 | | Aubrieta deltoides (purple variety) | Purple Rock Cress | 1 gal. |
| 41 | | Calamagrostis 'Karl Foerster' | Karl Foerster Grass | 5 gal. |
| 6 | | Hemerocallis 'Stella de Oro' | Stella de Oro Daylily | 1 gal. |
| 4 | | Penstemon digitalis 'Husker Red' | Husker Red Penstemon | 1 gal. |

Decorative Boulders

Turf Grass - To be sodded.

A 3" layer of 2" minus, crushed gravel mulch over Dewitt Pro 5 Weed Barrier Cloth, or equal.

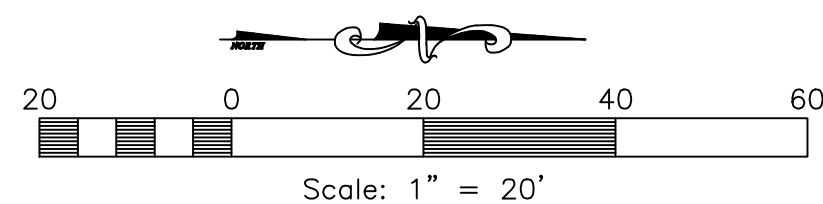

RA Reeve & Associates, Inc.
5160 SOUTH 1500 WEST
RIVERDALE, UTAH 84405
TEL: (801) 621-3100
FAX: (801) 621-2666
www.reeve-assoc.com

LAND PLANNERS * CIVIL ENGINEERS
LAND SURVEYORS * TRAFFIC ENGINEERS
STRUCTURAL ENGINEERS * LANDSCAPE ARCHITECTS

PROJECT NUMBER: 5799-230
DRAWN BY: RWH
ENGINEER: JNR