

## Stormwater Pollution Prevention Plan

- 1) Cabin dimensions are 26' x 34'. It has a wrap around porch on 3 sides which leaves the completed structure at 42' x 42'. I will likely need to get a truck around three sides, so you can add another 15' in each direction
- 2) I am responsible. Steve Morgan
- 3) The only lot touching our property line is vacant. We do have near by lots. The only issue I can think of that would affect them would be the noise. We will only work on the cabin during the day light hours. Nothing in the way of stormwater.
- 4) Excavated material will be set aside close to the building lot and be used for back fill once the footings and foundation are completed.
- 5) Concrete washout will be held just to the south of the cabin. The concrete will be allowed to harden and then broken up and hauled to the land fill.
- 6) No Porta johns. We have a trailer on site hooked up to an existing septic tank.
- 7) We will use the existing drive way to the South and build a second driveway to the North.
- 8) No asphalt. All dirt roads. There is a drainage ditch to the North.
- 9) No drainage system. There is drainage ditch to the North. All construction will be out of range.
- 10) Drains into the ground. Some run off to the North which enters a drainage ditch to prevent runoff to enter the road. Ditch is not connected to a drainage system.
- 11) There will be a trailer on site located 100 ft to the southeast. There is also a shed located 100 ft to the Southwest (10x10).

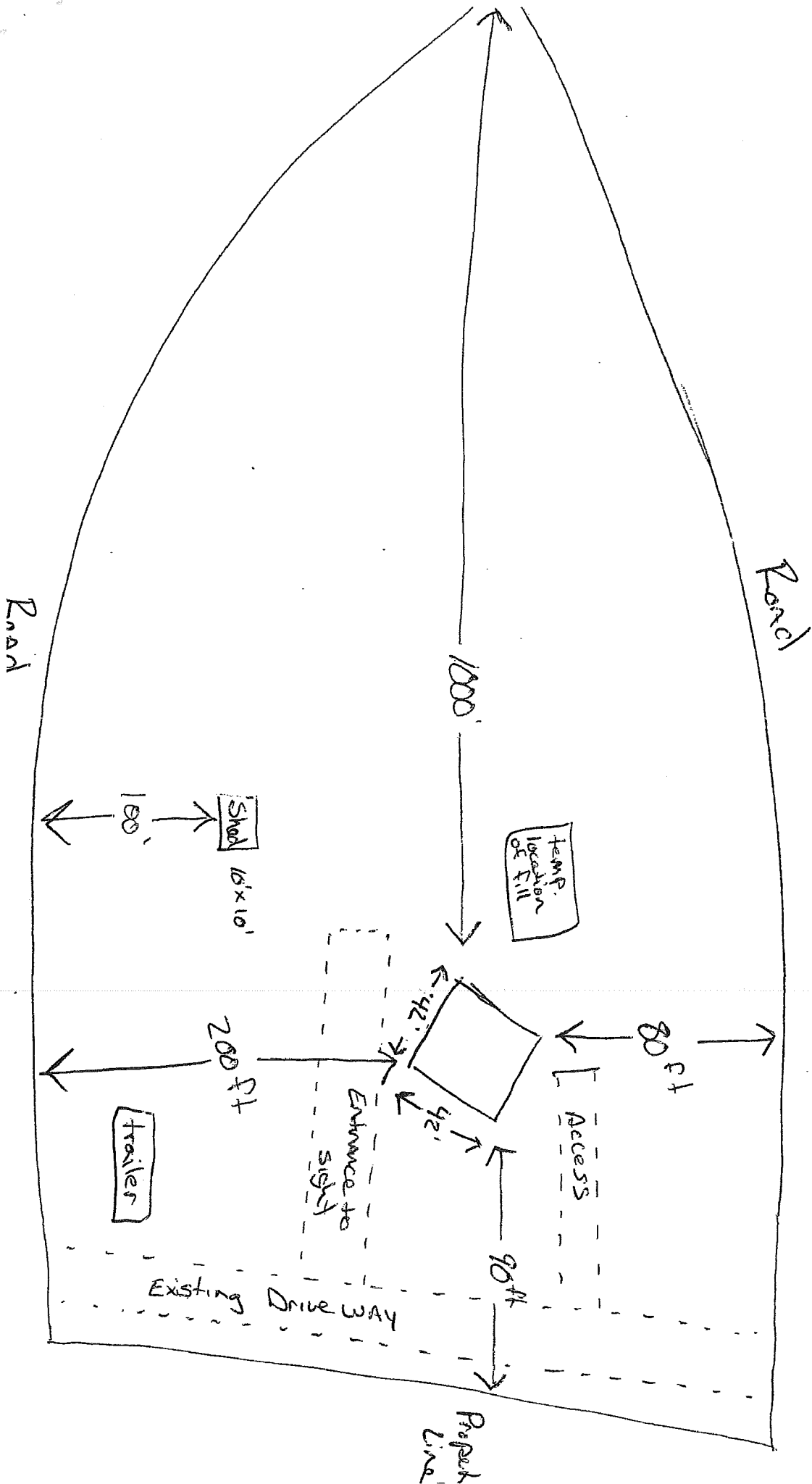

N