



# Land Use Permit

## Weber County Planning Commission

2380 Washington Blvd. STE 240  
Ogden, UT 84401  
Phone: (801) 399-8791 FAX: (801) 399-8862  
webercountyutah.gov/planning

**Permit Number: LUP110-2018**

Permit Type: Structure  
Permit Date: 05/18/2018

### Applicant

**Name:** Michael Aylward  
**Business:**  
**Address:**  
, UT  
**Phone:** 801-603-6143

### Owner

**Name:** Michael Aylward  
**Business:**  
**Address:** 3809 N. Rivers Edge Rd  
Eden, UT 84310  
**Phone:** 801-603-6143

### Parcel

**Parcel:** 222710011  
**Zoning:** AV-3 **Area:** .7576 **Sq Ft:** **Lot(s):** 18 **Subdivision:** Rivers Edge Cluster  
**Address:** 3809 N RIVERS EDGE RD EDEN, UT 84310 **T - R - S - QS:** 7N - 1E - 21 -

### Proposal

**Proposed Structure:** Shed **Building Footprint:** 160  
**Proposed Structure Height:** 10 **Max Structure Height in Zone:** 25  
**# of Dwelling Units:** **# of Accessory Bldgs:** 1  
**# Off Street Parking Reqd:** **\*Is Structure > 1,000 Sq. Ft?** No  
**\*If True Need Certif. Statement**

### Permit Checklist

**Access Type:** Front Lot Line **Alternative Access File #**  
**Greater than 4218 ft above sea level?** Yes **Wetlands/Flood Zone?** No  
**Additional Setback Reqd. ?** No **Meet Zone Area Frontage?** Yes  
**> 200 ft from paved Road?** No **Hillside Review Reqd?** No  
**Culinary Water District:** **Waste Water System:**

### Comments

Property is not located in a sensitive lands area. Meets all zoning requirements, including setbacks. max height allowed is 25', side setback may be 1 ft, if structure is located at least six feet to the rear of the main dwelling.



# Land Use Permit

## Structure Setback Graphic: Storage Shed, Detached Garage, Etc.

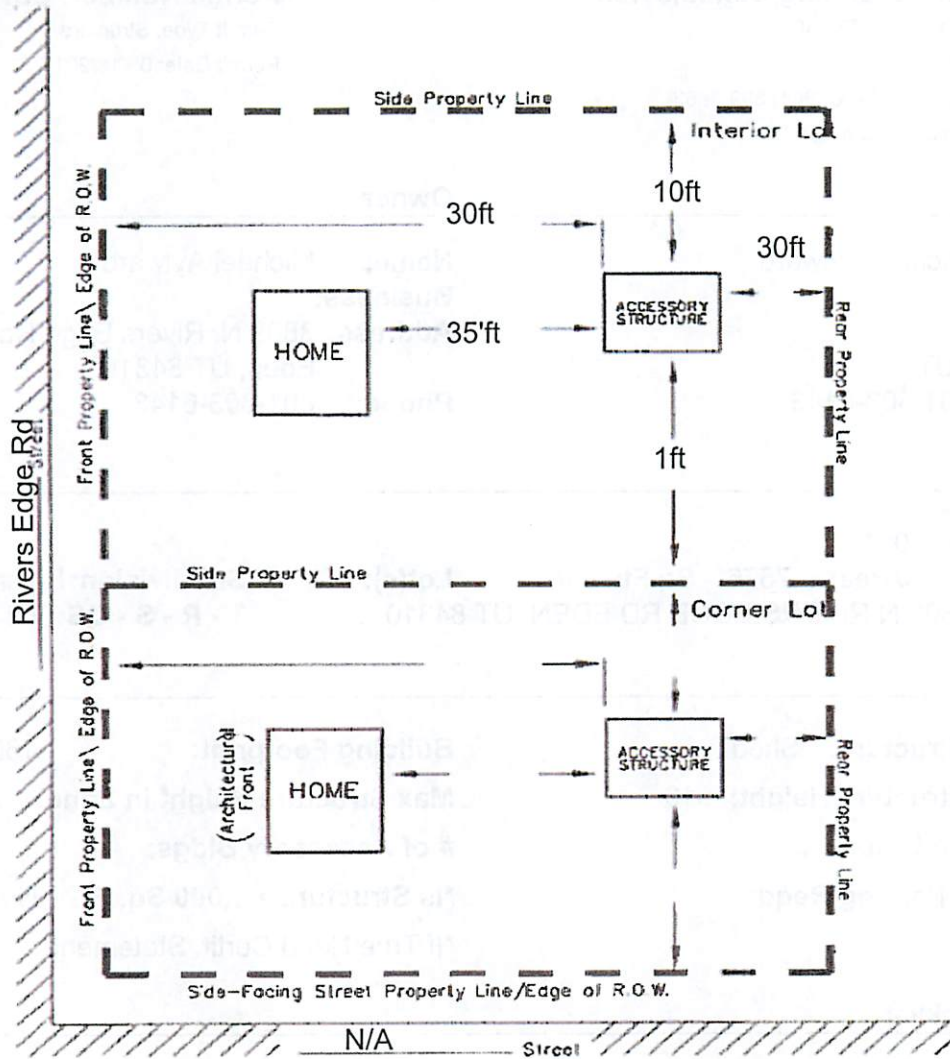

## MINIMUM YARD SETBACKS Storage Shed, Detached Garage, Etc.

### NOTICE FOR APPLICANT (Please Read Before Signing)

Proposals for the installation of an individual water supply and for a sanitary waste disposal system (septic tank) for any structure designed for human occupation must be approved by Weber County Health Department prior to installation.

Tammy Aydelotte

05/18/2018

Planning Dept. Signature of Approval

Date

I hereby certify that I have read and examined this application and know the same to be true and correct. All provisions of laws and ordinances governing this land use will be complied with whether specified herein or not. I make this statement under penalty of perjury.

Contractor/Owner Signature of Approval

Date

*[Handwritten Signature]*

5/18/18