

Weber Basin Reservoirs –

- ✘ Willard Bay: 215,120 a.f. (1958 – 1964)
- ✘ Pineview: 110,150 a.f.
(44,000 a.f.) (1934 - 1937)
- ✘ Causey: 7,870 a.f. (1962 – 1966)
- ✘ Lost Creek: 22,510 (1963 – 1966)
- ✘ East Canyon: 51,200 a.f. (1964 – 1966)
- ✘ Echo: 74,000 (1931)
- ✘ Rockport: 62,100 a.f. (1954 – 1957)

Aqueduct / Diversion Canals –

- ✘ Weber Aqueduct: 28,900 a.f.
- ✘ Davis Aqueduct: 72,000 a.f.
- ✘ Slaterville Diversion:

- Willard Bay; Layton Canal

*U.S. Dept. of Interior
Bureau of Reclamation*

Weber Basin Reservoirs

U.S. Dept. of Interior, Bureau of Reclamation

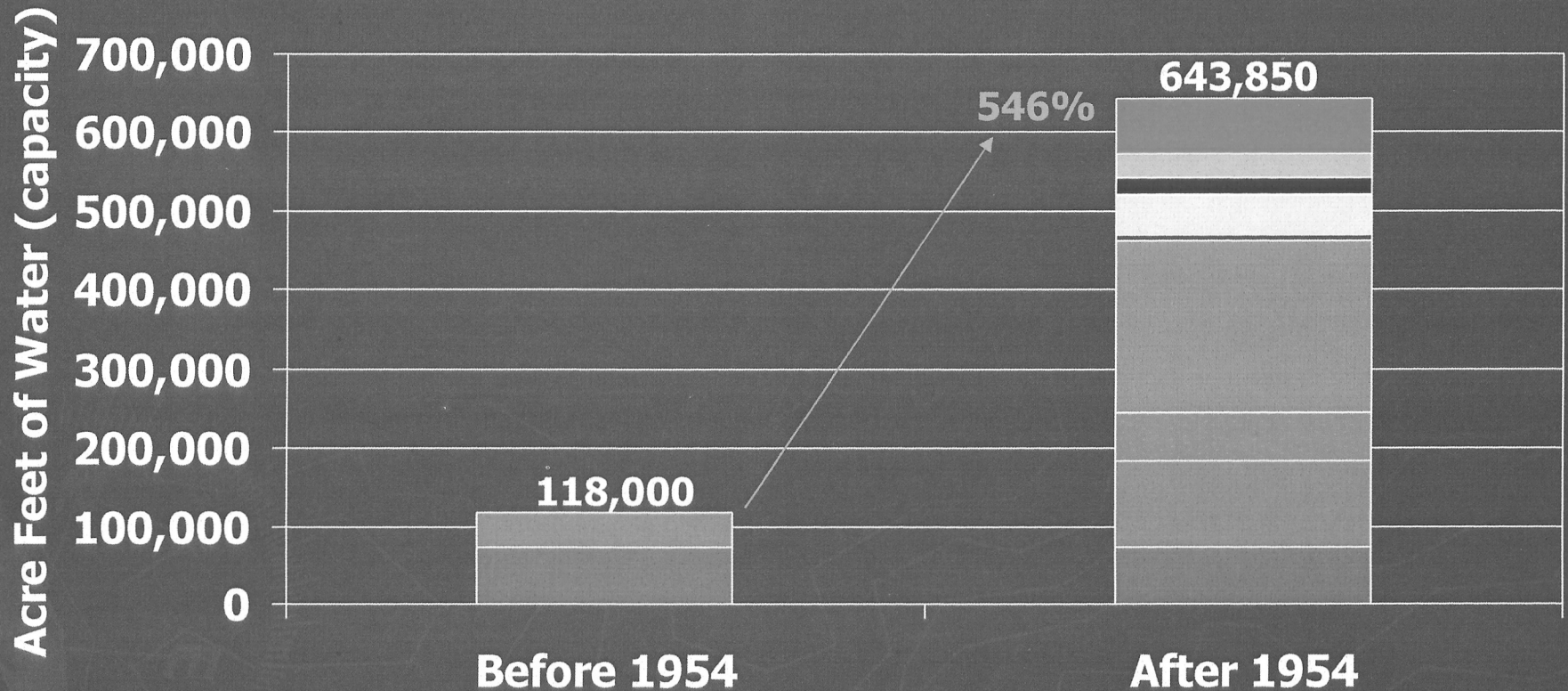



- | | | |
|---------------|------------------|------------------|
| ■ Echo | ■ Pineview | ■ Rockport |
| ■ Willard Bay | ■ Causey | ■ East Canyon |
| ■ Lost Creek | ■ Weber Aqueduct | ■ Davis Aqueduct |

WEST CENTRAL WEBER COUNTY GENERAL PLAN

PRIORITY STREAMS & FLOOD PLAIN MAP 4-4

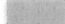
PRIORITY STREAMS

-  Priority Streams
-  100 Year Flood Zone

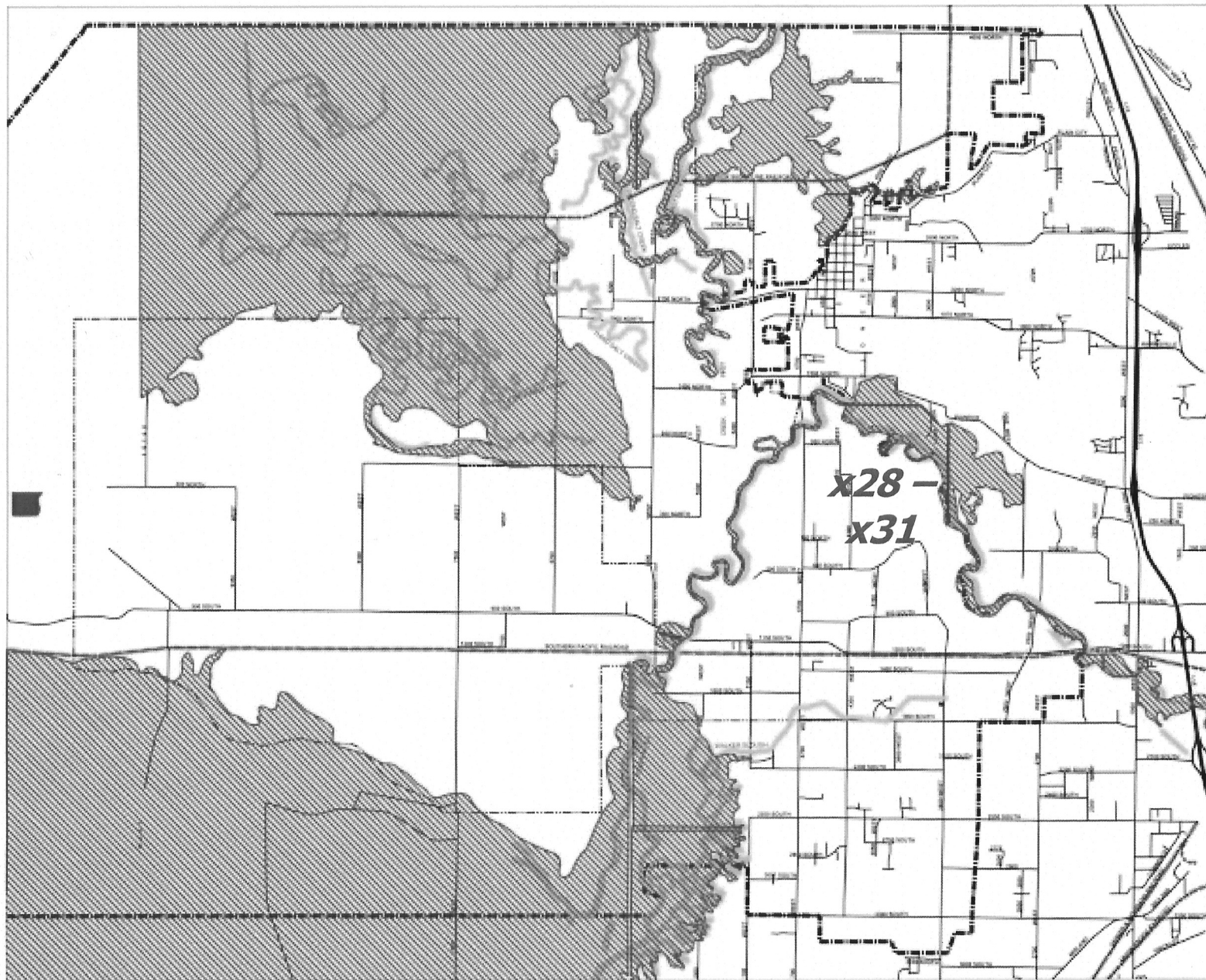

LANDMARK DESIGN
LANDMARK DESIGN
200 N. 1000 WEST
CANYON ROAD
CANYON, UT 84015
PHONE: 435-734-1111
FAX: 435-734-1112
WWW.LANDMARKDESIGN.COM
September 10, 2009