



Land Use Permit

Weber County Planning Commission

2380 Washington Blvd. STE 240
Ogden, UT 84401
Phone: (801) 399-8791 FAX: (801) 399-8862
webercountyutah.gov/planning

Permit Number: LUP12-2017

Permit Type: Structure
Permit Date: 02/21/2017

Applicant

Owner

Name: Casey Gauchat
Business:
Address: 8675 E 800 S
Huntsville, UT 84317
Phone: 801-791-9413

Name: Casey Gauchat
Business:
Address: 8675 E 800 S
Huntsville, UT 84317
Phone: 801-791-9413

Parcel

Parcel: 210260122
Zoning: **Area:** 5.63 **Sq Ft:** **Lot(s):** **Subdivision:**
Address: , UT **T - R - S - QS: 6N - 2E - 17 - SW**

Proposal

Proposed Structure: Barn Addition **Building Footprint:** 1000
Proposed Structure Height: **Max Structure Height in Zone:**25
of Dwelling Units: 0 **# of Accessory Bldgs:** 1
Off Street Parking Req'd: 0 ***Is Structure > 1,000 Sq. Ft?** N/A
***If True Need Certif. Statement**

Permit Checklist

Access Type: **Alternative Access File #**
Greater than 4218 ft above sea level? N/A **Wetlands/Flood Zone?** N/A
Additional Setback Req'd. ? N/A **Meet Zone Area Frontage?** N/A
> 200 ft from paved Road? N/A **Hillside Review Req'd?** N/A
Culinary Water District: **Waste Water System:**

Comments

This agriculture structure addition meets all Weber County Land use requirements.



Land Use Permit

Structure Setback Graphic: Storage Shed, Detached Garage, Etc.

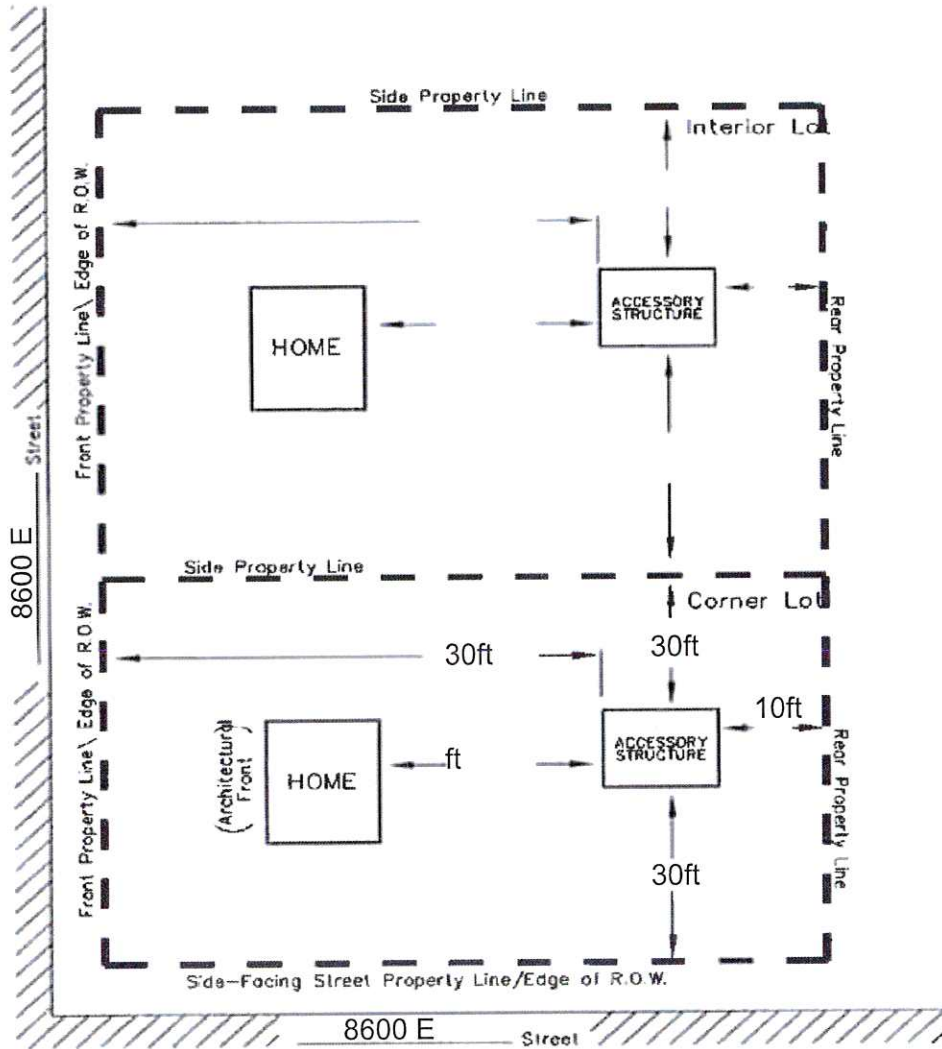

MINIMUM YARD SETBACKS Storage Shed, Detached Garage, Etc.

NOTICE FOR APPLICANT (Please Read Before Signing)

Proposals for the installation of an individual water supply and for a sanitary waste disposal system (septic tank) for any structure designed for human occupation must be approved by Weber County Health Department prior to installation.

 Planning Dept. Signature of Approval

02/21/2017
 Date

I hereby certify that I have read and examined this application and know the same to be true and correct. All provisions of laws and ordinances governing this land use will be complied with whether specified herein or not. I make this statement under penalty of perjury.

 Contractor/Owner Signature of Approval

 Date