

CONCEPT STREET TREE PLAN WITH DRIVEWAYS
SCALE: 1"=20'

CONCEPT PLANT SCHEDULE

●	<p>STREET TREES - SMALL 46</p> <p><i>Cercis canadensis</i> 'Appalachian Red' / Eastern Redbud <i>Maackia amurensis</i> / Amur Maackia <i>Prunus serrulata</i> 'Kwanzan' / Flowering Cherry <i>Prunus x yedoensis</i> 'Akebono' / Flowering Cherry <i>Syringa reticulata</i> 'Ivory Silk' / Ivory Silk Japanese Tree Lilac</p>
●	<p>EVERGREEN TREES 6</p> <p><i>Cedrus deodara</i> 'Karl Fuchs' / Karl Fuchs Deodar Cedar <i>Picea glauca pendula</i> / Weeping White Spruce <i>Picea omorika</i> 'Bruno' / Bruno Spruce <i>Pinus leucodermis</i> 'Hendrichii' / Bosman Pine <i>Pinus mugo</i> 'Tammenbaum' / Mugo Pine</p>
●	<p>ORNAMENTAL TREES 4</p> <p><i>Malus x 'Adams'</i> / Crab Apple <i>Malus x 'Coralburst'</i> / Coralburst Crabapple <i>Malus x 'Donald Wyman'</i> / Donald Wyman Crab Apple <i>Malus x 'Profusion'</i> / Profusion Crab Apple</p>

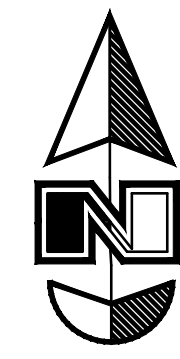
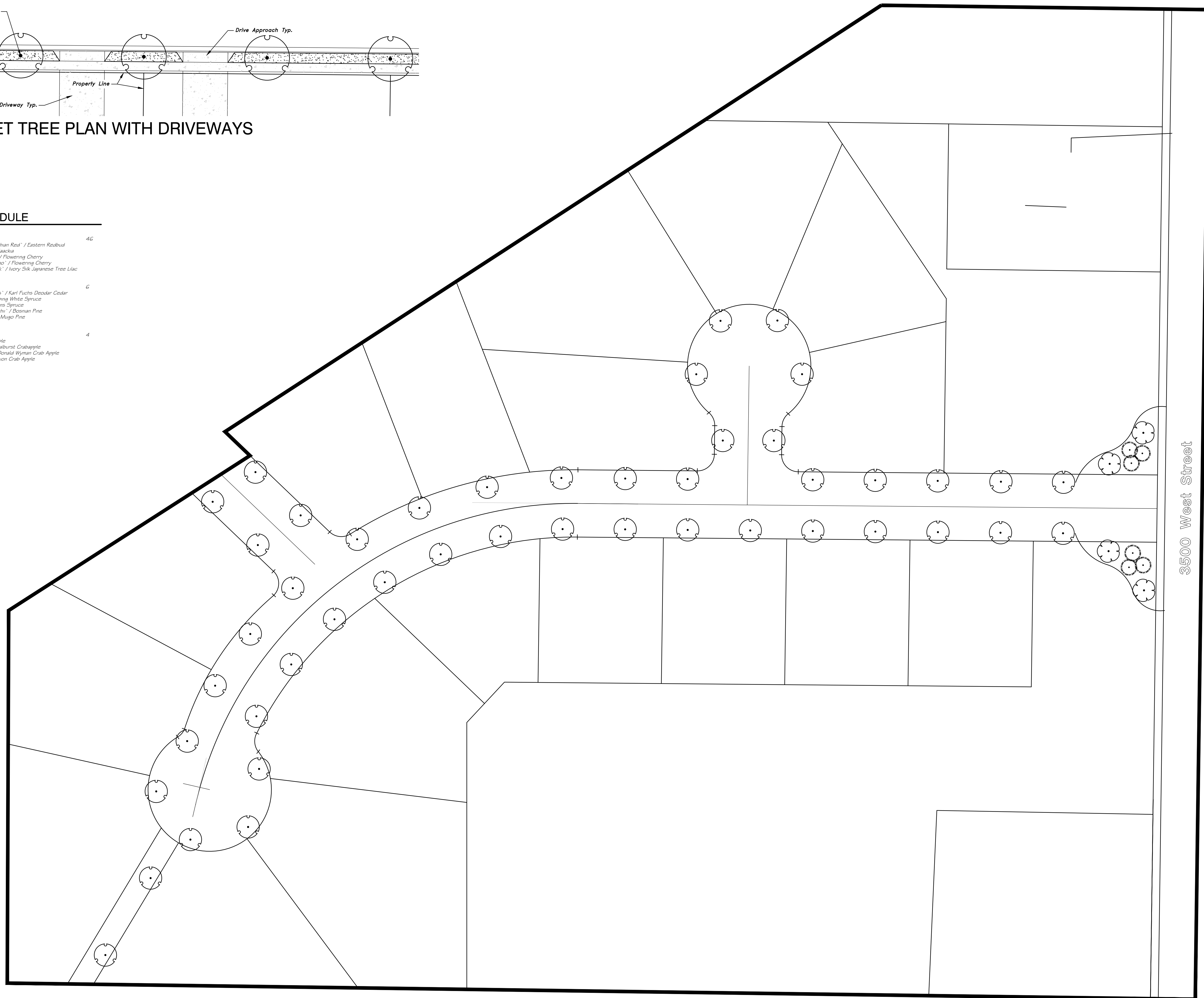

Scale: 1" = 40'

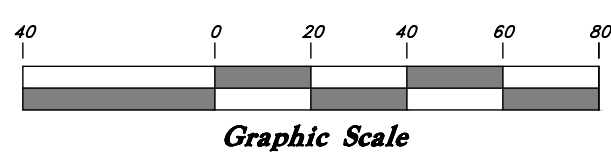

Graphic Scale

G B
GREAT BASIN ENGINEERING

5746 SOUTH 1475 EAST OGDEN, UTAH 84403
 MAIN (801)394-4515 S.L.C. (801)521-0222 FAX (801)392-7544
 WWW.GREATBASINENGINEERING.COM

LANDSCAPE PLAN
Giovanni's Legacy - Cluster Subdivision
 Weber County, Utah
 A part of Section 28, T6N, R2W, SLE&M, U.S. Survey

15 Nov, 2016

SHEET NO.

LP1

02N302 - Prelim Opt 3

REV. DATE DESCRIPTION