

NOTE:
THIS DRAWING IS THE PROPERTY OF BLACKWELL AND MAY NOT BE REPRODUCED OR TRANSMITTED IN ANY FORM OR BY ANY MEANS, ELECTRONIC OR MECHANICAL, WITHOUT THE WRITTEN PERMISSION OF BLACKWELL. THE CONTRACTOR SHALL BE RESPONSIBLE FOR CHECKING AND VERIFYING ALL LEVELS AND DIMENSIONS AND SHALL REPORT ALL DISCREPANCIES TO BLACKWELL AND OBTAIN CLARIFICATION PRIOR TO COMMENCING WORK.

PROFESSIONAL ENGINEER
MICHAEL A. HUNTER
No. 589557/2008
ON. REG. PROFESSIONAL ENGINEER
CIVIL

MARK	2018/02/28	FOR CIVIL PERMIT
MARK	DATE	DESCRIPTION
ISSUE		

Project Name
SUMMIT CABINS
1000 SQFT UNIT

Address
SUMMIT POWDER
MOUNTAIN EDEN,
UTAH

File Name	CAD/BIM Program
Drawn by	AUTOCAD
Scale	AS NOTED
Project #	1600633

Sheet Title
CIVIL WORKS
STRUCTURAL
DRAWINGS

S-100C

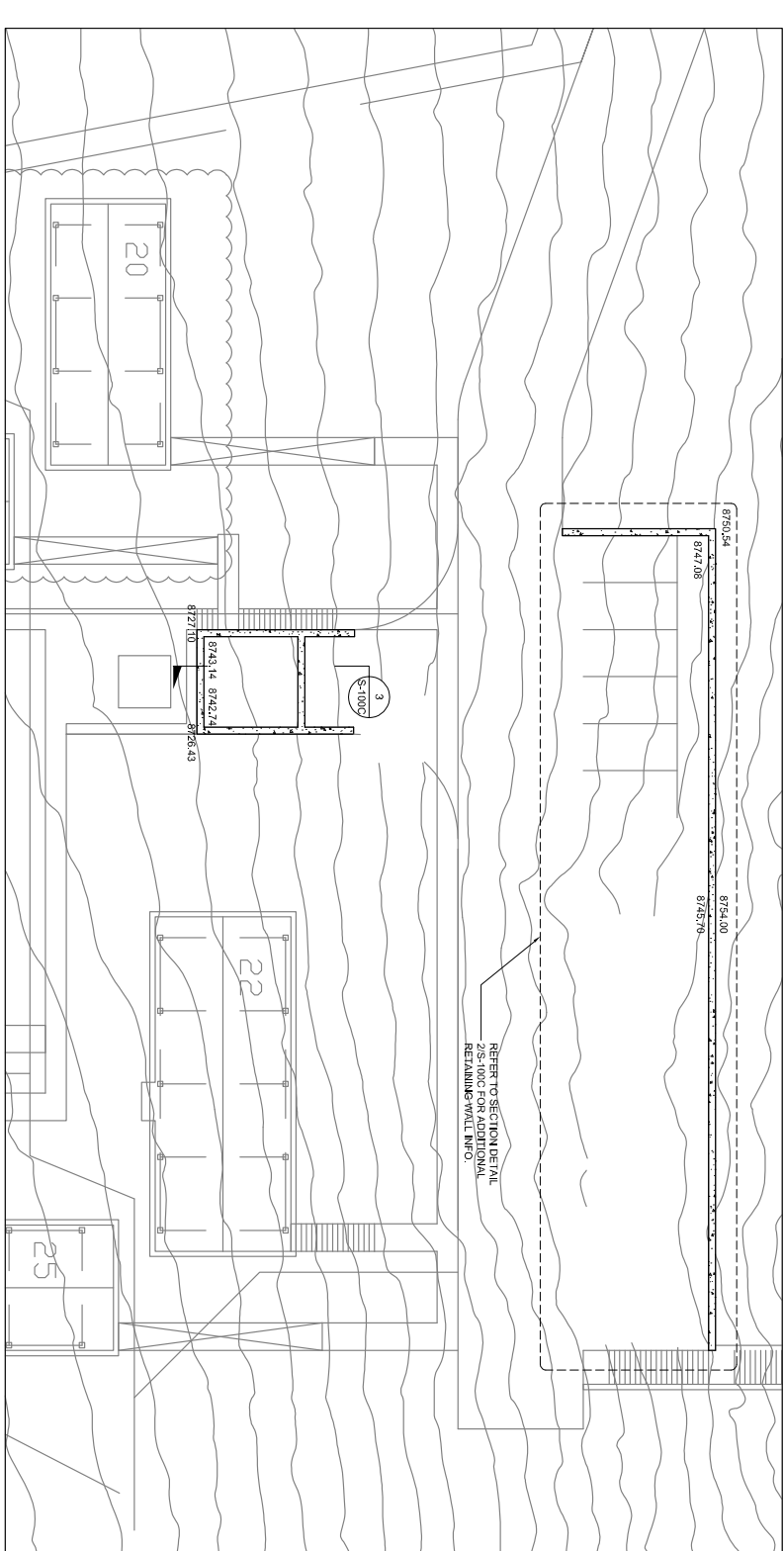

1 PLAN LAYOUT OF RETAINING WALLS
S-100C NTS

- NOTES:**
1. PLAN VIEW IS FOR REFERENCE ONLY. EXACT LOCATIONS AND ELEVATIONS TO BE AS PER CIVIL DRAWINGS.
 2. READ DRAWINGS IN CONJUNCTION WITH ALL OTHER TRADE DRAWINGS.

DESIGN NOTES - ALL DRAWINGS

- NOTES:**
1. READ AND REVIEW "GEO-TECHNICAL & GEOLOGIC HAZARD INVESTIGATION" BY IGES PRIOR TO BEGINNING ANY WORK. (DATED AUGUST 3, 2016)
 2. PRESSURE COEFFICIENT OF 0.27
 3. TRUCK TURN AROUND AREA HAS BEEN DESIGNED FOR A SURCHARGE LOAD OF 250psf
 4. REFER TO CIVIL DRAWINGS TO DETERMINE BACKFILL DIFFERENCE.
 5. CONCRETE SHALL BE 4000 PSI BATCH STRENGTH.
 6. DRIVEN PILES SHALL BE USED TO STABILIZE SOILS.
 7. THE SITE IS TO BE REMEDIATED AS PER GEO-TECHNICAL RECOMMENDATIONS TO REMOVE CREEPING SOIL. PRESSURES INDUCED BY CREEPING SOILS TO RESIST PASSIVE SOIL PRESSURES INDUCED BY CREEPING SOILS.

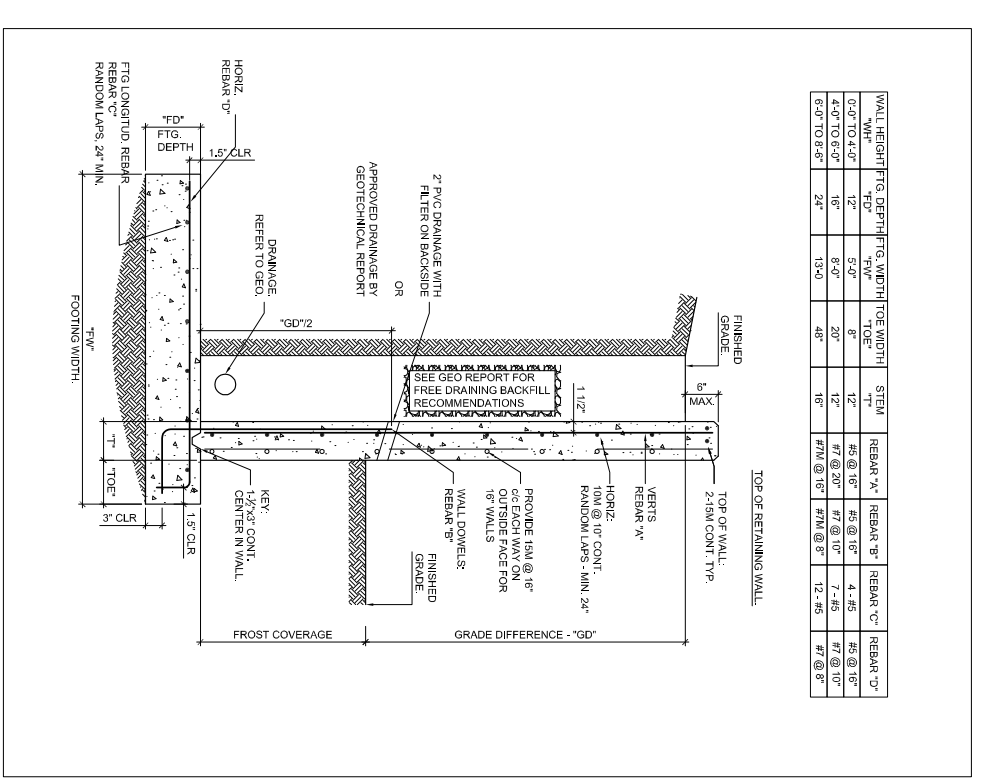

2 RETAINING WALL DESIGN NOTES
S-100C NTS

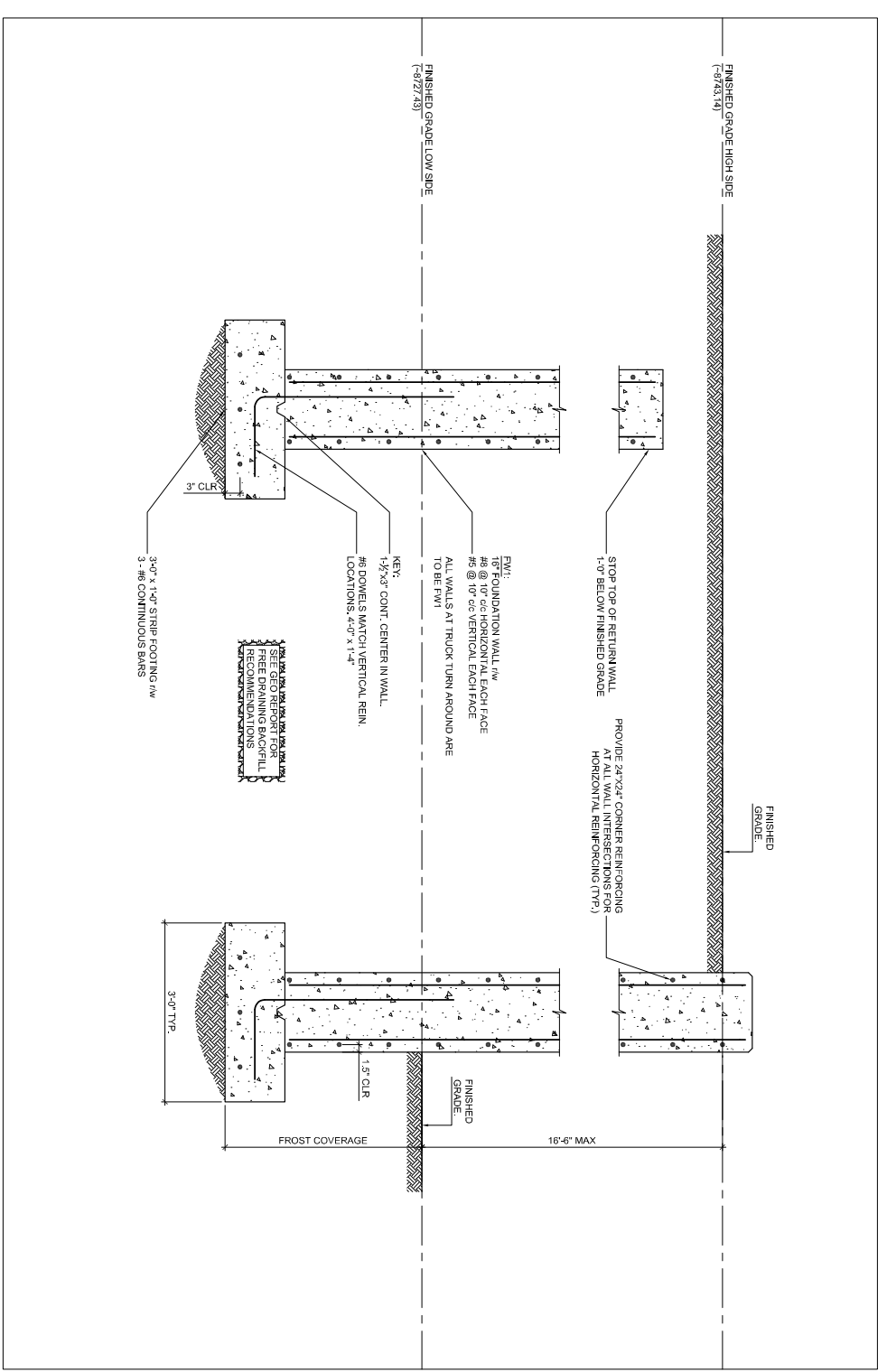

3 RETAINING WALL DESIGN NOTES
S-100C NTS