

SUMMIT EDEN
PHASE 1 PRUD SUBMITTAL
POWDER MOUNTAIN, WEBER COUNTY, UTAH



LOT LEGEND AND MIN. SETBACK STANDARDS

	RANCH SINGLE FAMILY FRONT 50' SIDES 20' REAR 30'
	ESTATE SINGLE FAMILY FRONT 20' SIDES 10' REAR 30'
	CABIN SINGLE FAMILY FRONT 20' SIDES 15' REAR 30'
	HILLSIDE SINGLE FAMILY FRONT 5' SIDES 5' REAR 20'
	VILLAGE SINGLE FAMILY FRONT 0' SIDES 0' REAR 5'
	VILLAGE LIVE/WORK SINGLE FAMILY FRONT 0' SIDES 0' REAR 0'
	NESTS FRONT 0' SIDES 0' REAR 0'

(R) RESTRICTED LOT
(54) LOTS ELIGIBLE FOR ADDITIONAL SUBDIVISION

PRUD DEVELOPMENT DATA

TOTAL PRUD BOUNDARY AREA	594.23 ACRES
ZONE FV-3 AREA	392.04 ACRES
ZONE F-40 AREA	194.83 ACRES
ZONE CVR-1 AREA	2.46 ACRES
CACHE COUNTY AREA	4.90 ACRES
ROAD ROW AREA SLOPES > 40 %	18.96 ACRES
NET DEVELOPABLE AREA	111.85 ACRES
PROPOSED LOTS	103 LOTS
PROPOSED UNITS	141 UNITS
RANCH SINGLE FAMILY	6 UNITS
ESTATE SINGLE FAMILY	26 UNITS
CABIN SINGLE FAMILY	11 UNITS
HILLSIDE SINGLE FAMILY	24 UNITS
VILLAGE SINGLE FAMILY	19 UNITS
VILLAGE LIVE/WORK SF	15 UNITS
NESTS	40 UNITS
PROPOSED DENSITY	1 UNIT/4.21 ACRES
PROPOSED OPEN SPACE	384.19 ACRES (64.6 %)

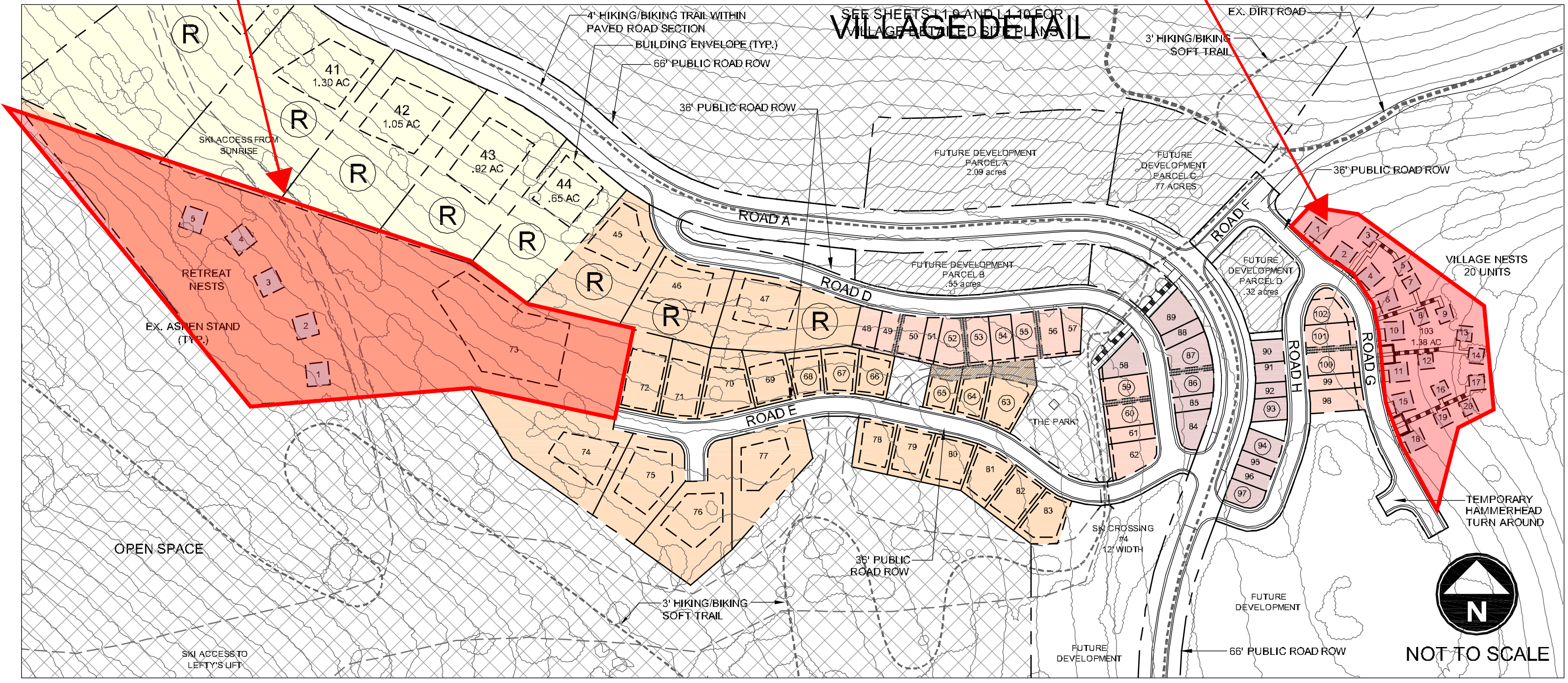

DATE:	JANUARY 22, 2013
PROJECT:	000.0000.00
DRAWN BY:	EL
REVIEW BY:	EL
VERSION:	PRUD
REVISIONS:	

SHEET TITLE:
OVERALL SITE PLAN
SHEET NUMBER:
L1.2