

Date: 4/18/2016



Planning Commission

Page 1 of 2

# Land Use Permit

Printed: 6/3/2016

Permit Number: LUP360-2016

### Applicant

Name: Brayden Thomas  
 Address: 174 South 3600 West  
 Phone: 8014996676

### Owner

Name: CSB Trust Date 01/15/2013  
 Address: 198 South 3600 West  
 Phone: 801-791-0366

### Parcel

Parcel Number: 155730002  
 Total Parcel Area: 3.97 ACRES  
 Address: 174 South 3600 West  
 OGDEN, UT 84401

Zoning: A-2  
 (\*If Zoned S-1, See Specific Height Requirements)

**\*\*See Diagram on Back Side for Setbacks**

Section: 16      Township: 6 N      Range: 2 W

Subdivision: SHAYE ESTATES      Lot(s): 2

Proposed Structure: Agriculture Outbuilding

Structure Area Used: 1512

Is Structure > 1,000 Sq. Ft.?      \*If True, Need Certif. Statement

# of Dwelling Units: 1      # of Accessory Bldgs: 2      # Off-Street Parking Req'd: 2



### Permit Checklist:

Public by/Right of Use Road?

> 200 ft. from Paved Road?      Yes

< 4218 ft. above Sea Level?

Wetlands/Flood Zone?      ?

Culvert Required?      ?

If Yes, Culvert Size:

**\*Any Work in the Right of Way requires an Excavation Permit**

Additional Frontage Req'd.?      No

OR Special Exception?      Case #

Meet Zone Area & Frontage?      True

Hillside Review Req'd.?      No      Case #

Culinary Water District:      Taylor West Weber

Waste Water System:      Individual

Comments: Agricultural pole barn location is approved based on the revised site plan uploaded 6/3/16.

Structure Setback Graphic:      Agricultural Outbuilding

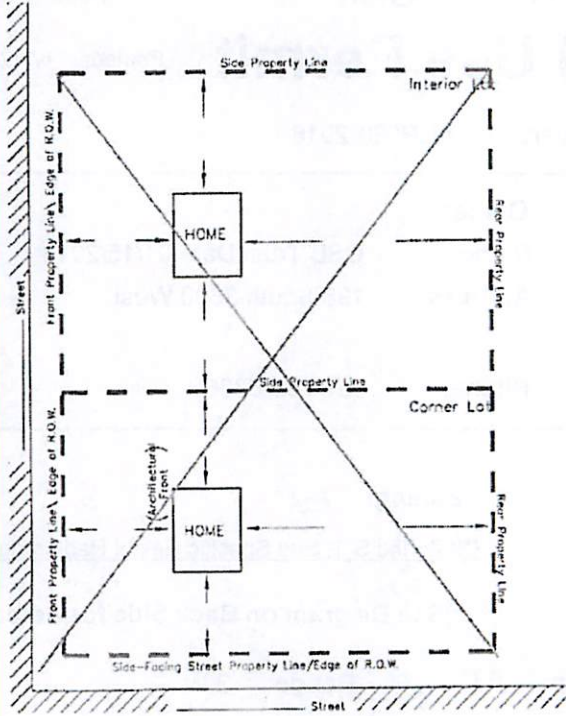

MINIMUM YARD SETBACKS  
New Dwelling, Addition, Etc.

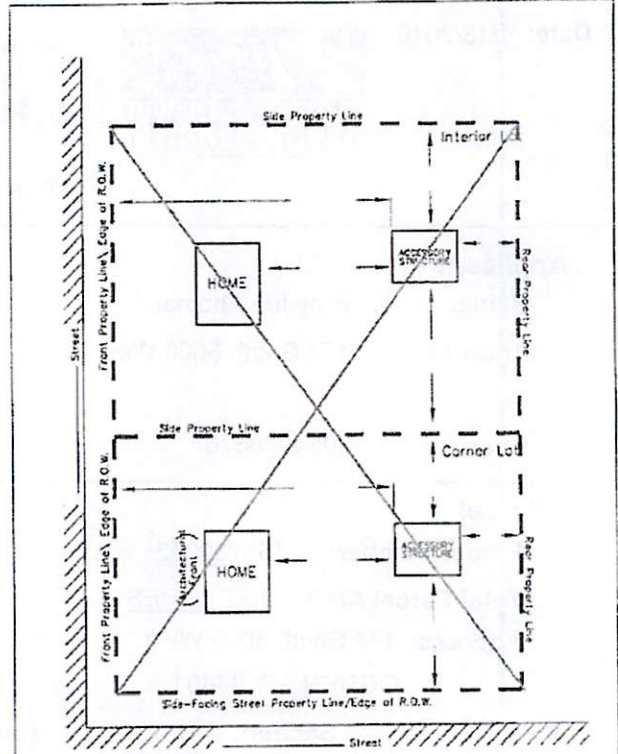

MINIMUM YARD SETBACKS  
Storage Shed, Detached Garage, Etc.

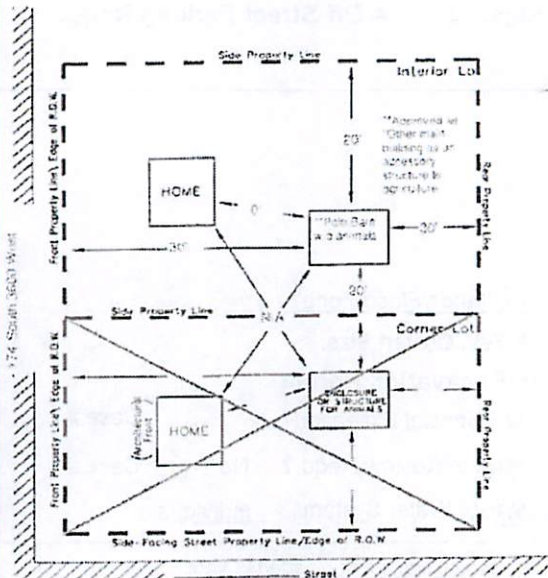

MINIMUM YARD SETBACKS  
Barn, Corral, or Stable

NOTICE FOR APPLICANT (Please Read Before Signing)

Proposals for the installation of an individual water supply and for a sanitary waste disposal system (septic tank) for any structure designed for human occupation must be approved by the Weber County Health Department prior to installation.

*Inda Kase* 6/3/16  
 Planning Dept. Signature of Approval Date

This permit becomes null and void if use or construction authorized has not commenced within 180 days or if there is a zone change affecting this property. I hereby certify that I have read and examined this application and know the same to be true and correct. All provisions of laws and ordinances governing this land use will be complied with whether specified herein or not. I make this statement under penalty of perjury. I hereby agree to make the requirements as specified on this permit issued to the owner of land as signed below.

*[Signature]* 6/4/16  
 Contractor/Owner Signature of Approval Date