

Vaquero Village

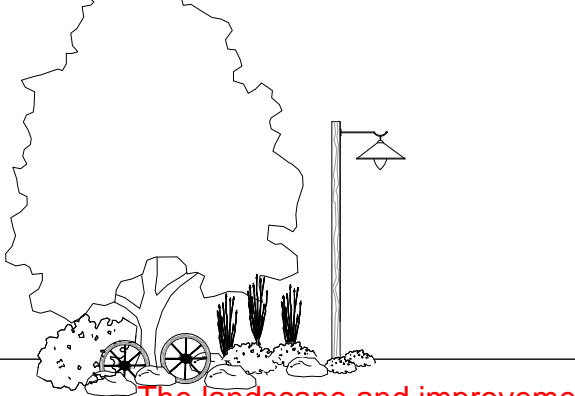

The landscape and improvement drawings need to show the trail system connecting in this location also per the approval by the WWPC

Plant Table

Quantity	Symbol	Scientific Name	Common Name	Planting Size
30		Acer freemanii 'Jeffersred'	Autumn Blaze Maple	2" cal.
20		Malus 'Prairie Fire'	Prairie Fire Crabapple	2" cal.
17		Pinus nigra	Austrian Pine	8'-12" B&B

Seed with native grasses.

IRRIGATION NOTES: All irrigation shall be provided by a private secondary water system. Use PVC lateral lines between trees. Connect to lateral lines with Netfim techline tubing, as shown in detail on Sheet L2.

Irrigation Schedule

		LATERAL LINE - CLASS 200 PVC, SIZED AS FOLLOWS 3/4" (0-10 gpm), 1" (10-16 gpm), 1 1/4" (16-26 gpm), 1 1/2" (26-35 gpm), 2" (35-55 gpm) CAN USE POLY PIPE FOR DRIP IRRIGATION.
	RAINBIRD ESP 12 LXME:120 VAC	INDOOR/OUTDOOR MOUNT BASE CONTROLLER. MOUNT ON OUTDOOR PEDESTAL.
		SLEEVING - SCHEDULE 40 PVC, 2 SIZES GREATER THAN INTERIOR PIPE SLEEVING USED WHENEVER IRRIGATION IS PLACED UNDER PAVED AREAS.
		1-1/2" MAINLINE - SCHEDULE 40 PVC

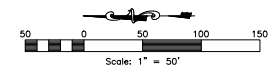
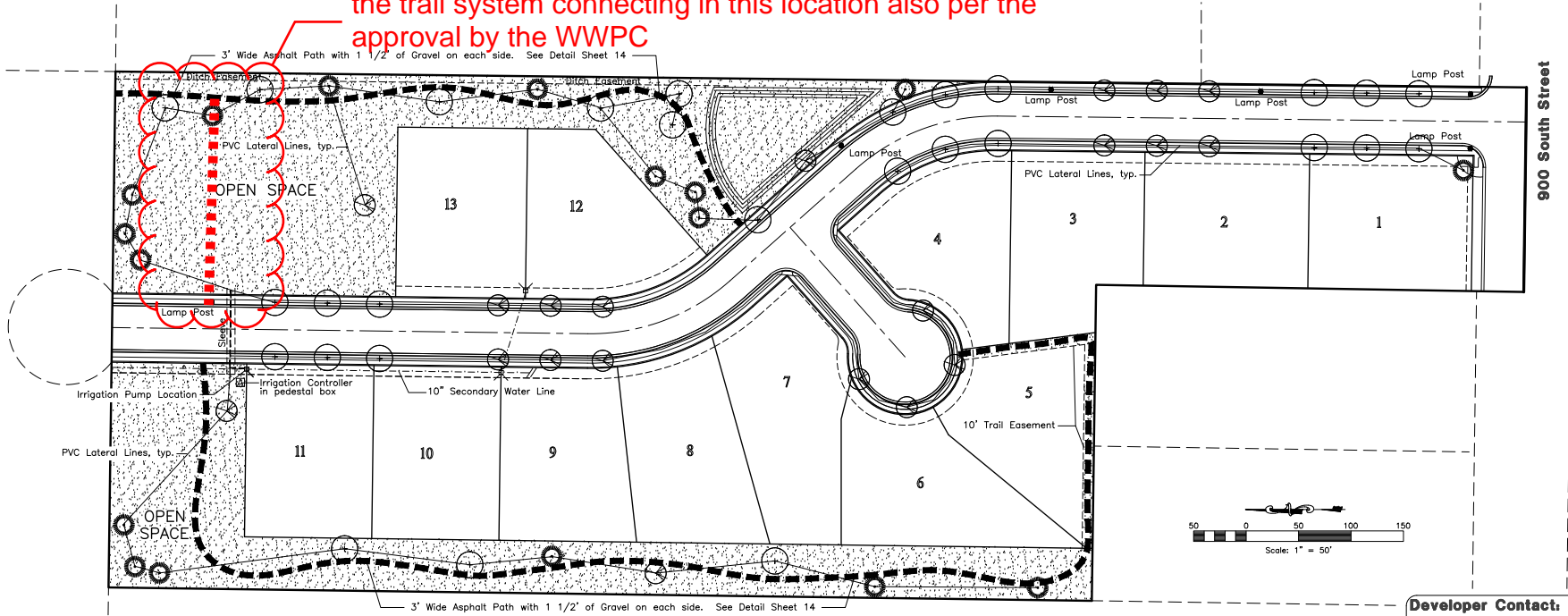

Developer Contact:
 Barrow Land Livestock, LLC
 Dean & Justin Barrow
 6835 W. 900 S.
 Ogden, UT. 84404
 (801) 514-8194

Reeve & Associates, Inc.
IRA
 920 CHAMBERS STREET, SUITE 14, OGDEN, UTAH 84403
 TEL: (801) 471-3100 FAX: (801) 471-3088 WWW.REEVE-ASSOCIATES.COM
 IRRA: IRRIGATION • SUBDIVISION • LANDSCAPE ARCHITECTURE

REVISIONS	DESCRIPTION
DATE	BY
4-3-17	RH
	Revised Comments

Vaquero Village Cluster Subdivision
Phase 1
 WEBER COUNTY, UTAH
Landscape & Irrigation Plan



Project Info:
 Engineer: NATE REEVE
 Drafter: C. KINGSLEY
 Begin Date: 4-4-16
 Name: VAQUERO VILLAGE CLUSTER SUBDIVISION PHASE 1
 Number: 6352-01

1/4/2018 1:04:35 PM Project: 100-0000133-Vaquero Village Cluster Subdivision - Irrigation - Landscape - Engineering