

**Date:** June 01, 2016

**Subject:** Response to Weber County Engineering Review - 2016-05-12 10:00:11

**Project Name:** Cedar Cove Estates 4<sup>th</sup> Amendment

**Project Address:** 6696 S 2850 E, Uintah, UT 84403

To Whom It May Concern,

Please see below for a list of responses to your review.

In reference to your comment:

"I have a concern regarding the Access to the Detention Basin. Can wording be added to the 15 foot drainage easement across Lot 34 making it both an access easement and a drainage easement? That would address the need to be able to get to the detention basin for maintenance and inspections. It might be wise to show where the existing roadway is as it would appear to meander outside of the right of way. If the applicant is willing the 15 foot easement across lot 34 might be widened to 20 feet as both the existing ditch and the access to get to the basin is needed. Blane Frandsen PE"

This change to the final plat is currently taking place. The 15 easement on lot 34 is being changed to reflect a 20' easement. Also, the note "Access and Drainage Easement" that is currently shown on lot 33 is being added to lot 34. As per our discussion at 11:20 am on 2016-05-19 we are looking at installing a pipe that would attach to the current drainage pipe that runs into the ditch along the side of lot 33 and 34. This pipe would alleviate the need for the ditch and would allow it be removed along with its retaining walls and backfilled. The paved access to lot 34 would then be paved down the 20' easement in a location such that future access for maintenance or repair without cutting the road would be possible. See attached sketch.

I appreciate your review and I am hopeful that I have addressed any and all concerns brought up in the Weber County Engineering Division's review on 2016-05-12 at 10:00:11 am. If you do have any questions please let me know.

Sincerely,

A handwritten signature in black ink, appearing to read 'Trevor Anderson', with a long horizontal line extending to the left.

Trevor Anderson

801-529-3887

trevor.c.anderson@gmail.com

PROPOSED DRAINAGE DITCH  
 REPLACEMENT ON LOTS 33 & 34  
 CEDAR COVE ESTATES 4TH AMENDMENT

CURRENT ROCK RETAINING  
 WALL AND UNSEED DRAINAGE  
 DITCH.

STORM DRAINS INSTALLED  
 AT THE END OF  
 2850 E. STREET  
 IN CURB AND GUTTER.

15" INTERIOR DIMENSION  
 CEMENT DRAIN PIPE  
 - SEE ATTACHED PICTURE -

15" +/- PVC  
 DRAINAGE PIPE

PIPE RAN TO  
 RETENTION BASIN

NOTE  
 PIPE TO BE INSTALLED PRIOR  
 TO ACCESS ROAD BEING INSTALLED

FOR LOT 34 CEDAR COVE ESTATES.  
 PIPE INSTALLED IN A LOCATION SO AS  
 TO BE ACCESSIBLE IN FUTURE FOR  
 MAINTENANCE AND REPAIR.

REMOVING WALL TO BE REMOVED  
 AND DITCH BACKFILLED.

CEMENT PIPE TO PVC PIPE COUPLER  
 - SEE ATTACHED - FERRICO. 1006-1515 -

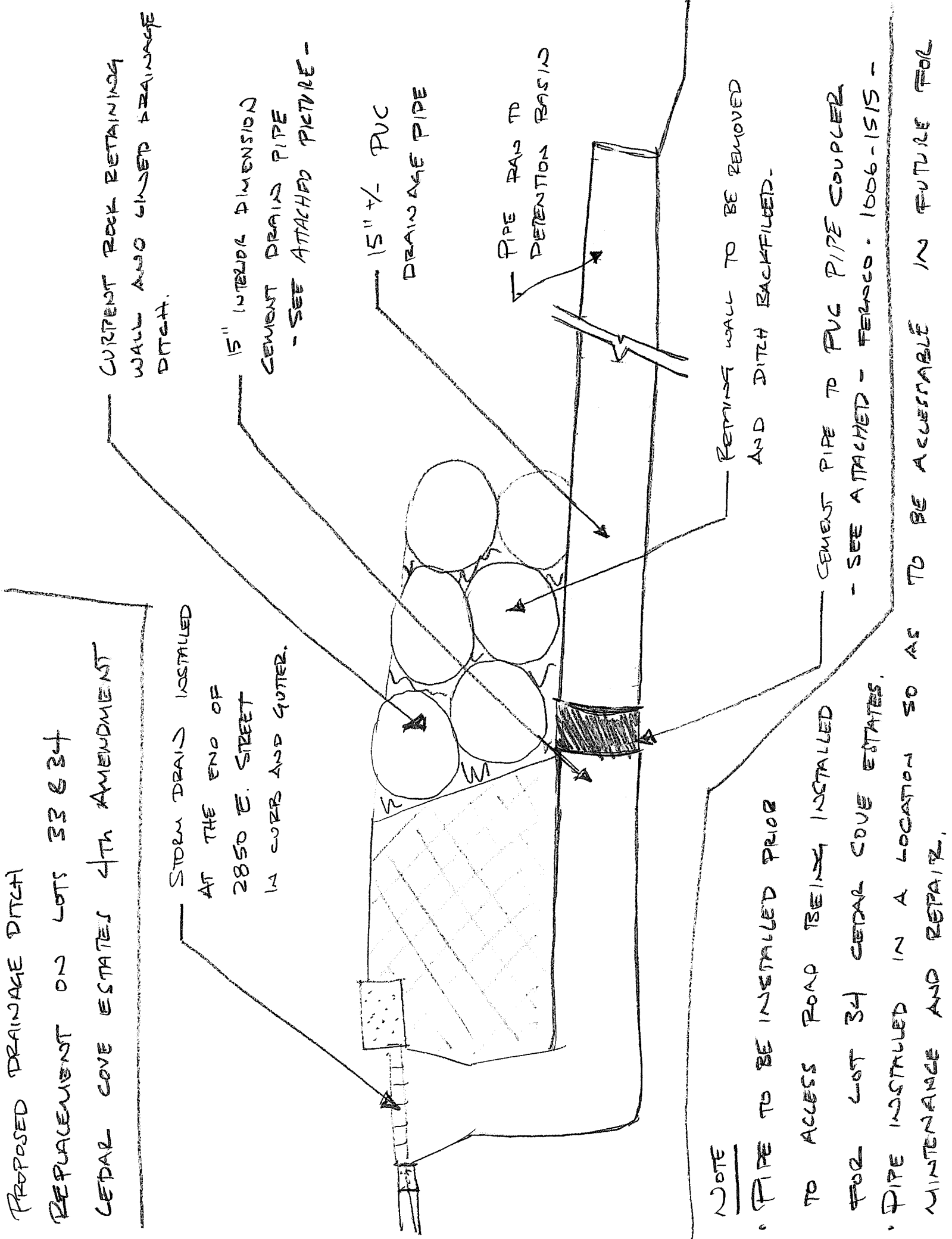



Davison, MI • PH: 810-653-9626 • FAX: 810-653-8714 • www.Fernco.com

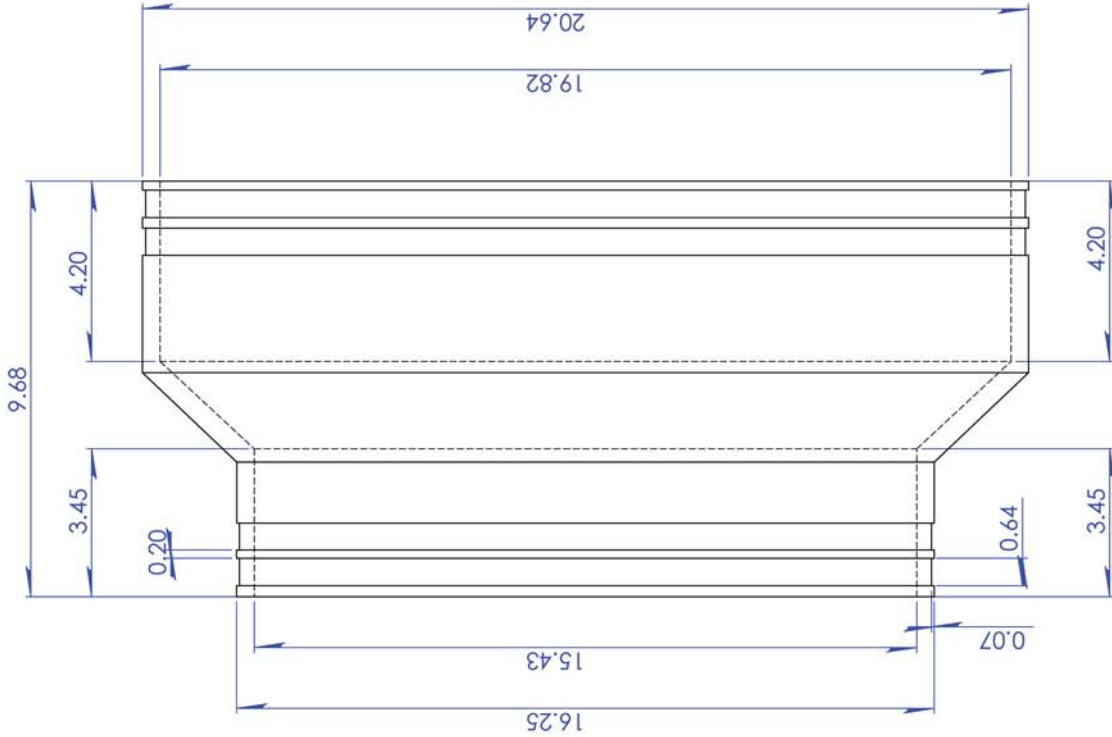

300 S. DAYTON ST.  
DAVISON, MI 48423  
PH: 810-653-9626  
FAX: 810-654-2616

Part Weight	12.88 lbs.
Min/Max Temp.	-30/140 Degrees F
Pressure Tested	4.3 PSI
Material	Flexible PVC 60 Duro Shore A
Installation Torque	60" Lbs.
Conforms to ASTM	D5926, C1173
Box Quantity	300 Series
Clamps used	

TOLERANCES:  
X= Fractional ±  
.XX = ±.060  
.XXX = ±.032  
ANG = ±0.5°  
UNLESS OTHERWISE SPECIFIED

DESCRIPTION:

Coupling 15" Concrete x  
15" Cast Iron/Plastic

1006-1515

**PROPRIETARY AND CONFIDENTIAL**  
THE INFORMATION CONTAINED IN THIS DRAWING IS THE SOLE PROPERTY OF FERNCO, INC. ANY REPRODUCTION IN PART OR AS A WHOLE WITHOUT THE WRITTEN PERMISSION OF FERNCO, INC. IS PROHIBITED.

UNITS: INCHES  
SIZE: A  
DESIGNER: D. Brady  
CHECKER:  
3RD ANGLE PROJECTION  
DO NOT SCALE DRAWING

SCALE: not to scale  
DATE: 11/14/2008  
SHEET 1 OF 1