

R1: revised sign NEED to CHRWGL-15-07 and update new photo-01-12-15
 R2: Revisedly update bid on sign EDS and to add new NET 2015-07-14-03-09-15
 R3: Revised to proposed two options for sign EPI and options for wall sign-04-14-15
 R4: revised to go with option one for sign EDS-04-14-15
 R5: revised to change to gooseneck banner sign option one and to remove from scope sign NE11-04-05-15
 R6: revised sign EPI to add a new photo to be added to new layout and dimensions for sign NE11-04-05-15
 R7: revised to update banner sign and to show dimensions for sign NE11-04-05-15

WELLS FARGO

Store Number # 104114
 Ogden Valley

2487 N HWY 158 Eden, UT 84310 USA

Owned

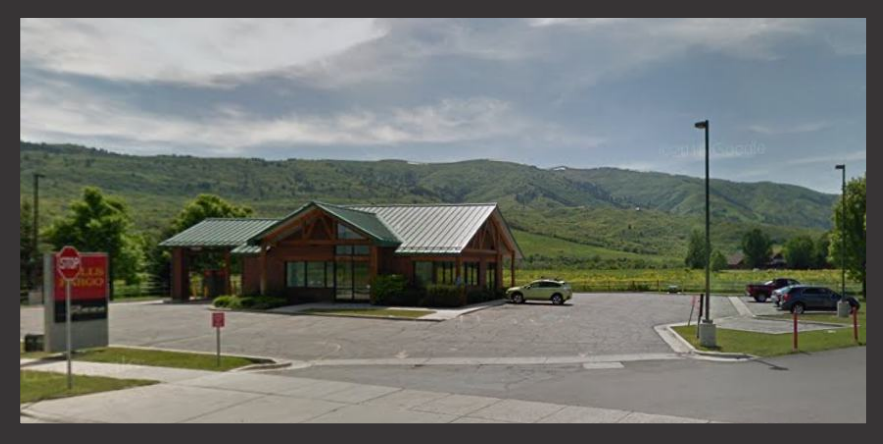

BEFORE

AFTER



Signtech™

4444 Federal Blvd. San Diego CA 92102
 Phone: (619) 527-6100 / Fax: (619) 527-6111
 www.signtechUSA.com



Wells Fargo
 # 104114

Ogden Valley
 2487 N HWY 158
 Eden, UT 84310 USA

Initial Date: 12/16/15
 Salesperson: Art Navarro
 Coordinator: Julie L. Horton
 Designer: O Lemus
 Scale: As noted

CUSTOMER APPROVAL

Customer Signature _____ Date _____

COPY, COLORS & SIZES

Signtech does NOT provide primary electrical to sign location - **RESPONSIBILITY OF OTHERS!**

Customer Signature _____ Date _____

This design is the exclusive property of Signtech and cannot be reproduced in whole or in part, without their prior written approval.

Drawing Number: 16-00140

Project ID: WELLS FARGO_104114_1

Together we'll go far



R1: revised sign NE02 to CHRWGL-15-ST and update new photo-d-12/21/15
 R2: Revisedly update had on sign E05 and to add new NE12 CHSP-ATM-5.375-CUSTOM
 R3: Revised to proposed two options for sign E01 and update for wall sign-d-04/14/16
 R4: revised to go with option one for sign E05-d-04/15/16
 R5: revised to change to gooseneck lamp sign option one and to remove from scope sign NE11-d-06/10/16
 R6: revised sign E01 to remove only, NE02 to be install at new location and distribution two for sign NE03-d-07/16/16
 R7: revised to update cover page and to show orientation for sign NE02-d-07/26/16

SIGN LEGEND

SIGN #	EXISTING SIGN	SF	RECOMMENDED SIGN	SF	QTY
E01	MONUMENT	58.3	REMOVE ONLY	0	1
NE02	NONE	0	M-22-NON-ILL	22	1
NE03	NONE	0	CPL-12-ST-GNL	20.4	1
E04	DIRECTIONAL SIGN		DS-20-48		1
E05	INFORMATIONAL SIGN		IS-18-60		1
E06	INFORMATIONAL SIGN		IS-18-60		1
E07	CLEARANCE SIGN		DRIVE THRU CLEARANCE		1
NE08	NONE		DRIVE THRU CLEARANCE		1
E09	DO NOT ENTER SIGN		DOT DO NOT ENTER		1
E10	WALL POSTER		REMOVE ONLY		1
E11	HANDICAP SIGN		ADA HANDICAP		1
NE12	NONE		CHSP-ATM-5.375-CUSTOM	1.75	1

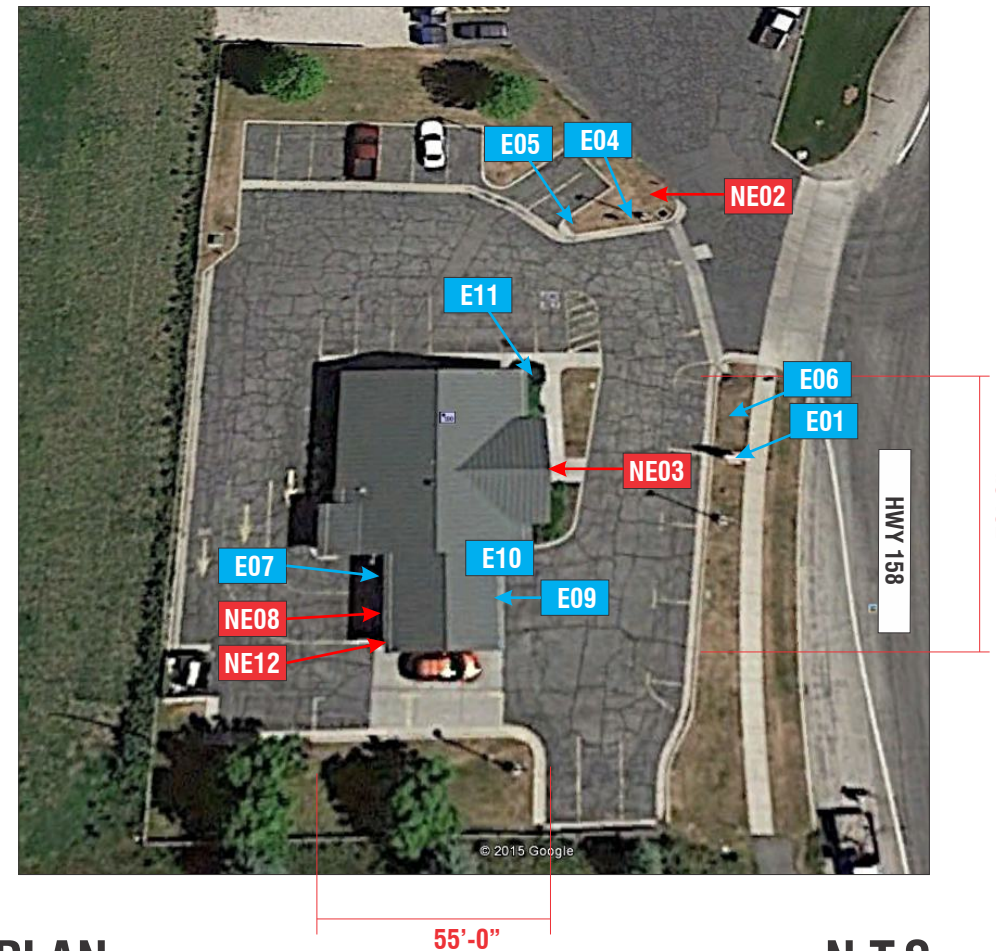
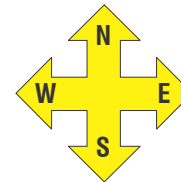

SITE PLAN

N.T.S.



Signtech™

4444 Federal Blvd. San Diego CA 92102
 Phone: (619) 527-6100 / Fax: (619) 527-6111
www.signtechUSA.com



**Wells Fargo
 # 104114**

Ogden Valley
 2487 N HWY 158
 Eden, UT 84310 USA

Initial Date: 12/16/15
 Salesperson: Art Navarro
 Coordinator: Julie L. Horton
 Designer: O Lemus
 Scale: As noted

CUSTOMER APPROVAL

Customer Signature _____ Date _____

COPY, COLORS & SIZES

Signtech does NOT provide primary electrical to sign location -
RESPONSIBILITY OF OTHERS!

Customer Signature _____ Date _____

This design is the exclusive property of Signtech and cannot be reproduced in whole or in part, without their prior written approval.

Drawing Number: 16-00140

Project ID: WELLS FARGO_104114_1

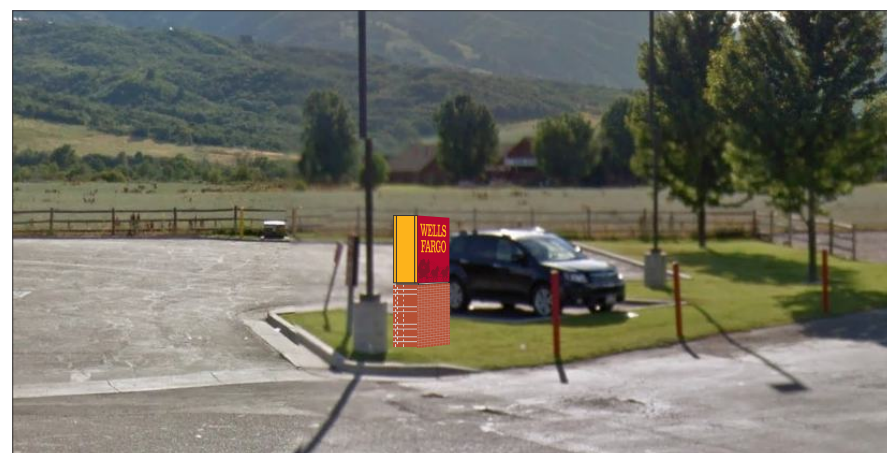

PROPOSED

NE02



PROPOSED

NE03



PROPOSED

NE12

E01

SIGNTYPE

REMOVE ONLY

10'-4 1/2"
(124 1/2")

5'-7 1/2" (67 1/2")



SIGN ELEVATION

SCALE: 3/8" = 1'-0"

E01

EXISTING

MONUMENT



SIGN ELEVATION

SCALE: 3/8" = 1'-0"

E01

PROPOSED

REMOVE ONLY

CUSTOM COMMENTS:



Signtech™

4444 Federal Blvd. San Diego CA 92102
 Phone: (619) 527-6100 / Fax: (619) 527-6111
www.signtechUSA.com



**Wells Fargo
 # 104114**

Ogden Valley
 2487 N HWY 158
 Eden, UT 84310 USA

Initial Date: 12/16/15
 Salesperson: Art Navarro
 Coordinator: Julie L. Horton
 Designer: O Lemus
 Scale: As noted

CUSTOMER APPROVAL

Customer Signature _____ Date _____

COPY, COLORS & SIZES

Signtech does NOT provide primary electrical to sign location - **RESPONSIBILITY OF OTHERS!**

Customer Signature _____ Date _____

This design is the exclusive property of Signtech and cannot be reproduced in whole or in part, without their prior written approval.

Drawing Number: 16-00140

Project ID: WELLS FARGO_104114_1

R1: revised sign NE02 to CHRWGL-15-07 and update new photo-d-12/1/15
 R2: Revisedly update had on sign E03 and to add new NE12 CHRWGL-15-07-d-03/09/16
 R3: Revised to proposed two options for sign E01 and options for wall sign-d-04/14/16
 R4: revised to go with option one for sign E02-d-04/14/16
 R5: revised to change to goose-neck lamp sign option one and to remove from scope sign NE11-d-06/10/16
 R6: revised sign E01 to remove only, NE02 to be install at new location and discontinue two for sign NE03-d-07/16/16
 R7: revised to update cover page and to show orientation for sign NE02-d-07/26/16

NE02



NEW MONUMENT ORIENTATION



Signtech™

4444 Federal Blvd. San Diego CA 92102
 Phone: (619) 527-6100 / Fax: (619) 527-6111
 www.signtechUSA.com



**Wells Fargo
 # 104114**

Ogden Valley
 2487 N HWY 158
 Eden, UT 84310 USA

Initial Date: 12/16/15
 Salesperson: Art Navarro
 Coordinator: Julie L. Horton
 Designer: O Lemus
 Scale: As noted

CUSTOMER APPROVAL

Customer Signature _____ Date _____

COPY, COLORS & SIZES

Signtech does NOT provide primary
 electrical to sign location -
RESPONSIBILITY OF OTHERS!

Customer Signature _____ Date _____

This design is the exclusive property of Signtech
 and cannot be reproduced in whole or in part,
 without their prior written approval.

Drawing Number: 16-00140

Project ID: WELLS FARGO_104114_1

NE02 **SIGNTYPE** **M-22-NON-ILL**



SIGN ELEVATION **SCALE: 3/8" = 1'-0"**

NE02 **EXISTING** **NONE**

5'-3 7/8" (63 7/8")



8'-0"
(96")

SIGN ELEVATION **SCALE: 3/8" = 1'-0"**

NE02 **PROPOSED** **M-22-NON-ILL**

CUSTOM COMMENTS:
NOTE: ORIENTATION OF MONUMENT SIGN TBD



Signtech™

4444 Federal Blvd. San Diego CA 92102
Phone: (619) 527-6100 / Fax: (619) 527-6111
www.signtechUSA.com



Wells Fargo
104114

Ogden Valley
2487 N HWY 158
Eden, UT 84310 USA

Initial Date: 12/16/15
Salesperson: Art Navarro
Coordinator: Julie L. Horton
Designer: O Lemus
Scale: As noted

CUSTOMER APPROVAL

Customer Signature _____ Date _____

COPY, COLORS & SIZES

Signtech does NOT provide primary electrical to sign location - **RESPONSIBILITY OF OTHERS!**

Customer Signature _____ Date _____

This design is the exclusive property of Signtech and cannot be reproduced in whole or in part, without their prior written approval.

Drawing Number: 16-00140

Project ID: WELLS FARGO_104114_1

R1: revised sign NE02 to CHRWGL-15-ST and update new photo-d-12/21/15
 R2: Revisedly update had on sign E03 and to add new NET 220525-07-04-03/09/16
 R3: Revised to proposed two options for sign E01 and update for wall sign-d-04/14/16
 R4: revised to go with update one for sign E02-d-04/14/16
 R5: revised to change to gooseneck lamps sign option one and to remove from scope sign NE11-d-06/10/16
 R6: revised sign E01 to remove only, NE02 to be install at new locale and distribution two for sign NE03-d-07/19/16
 R7: revised to update cover page and to show operation for sign NE02-d-07/29/16

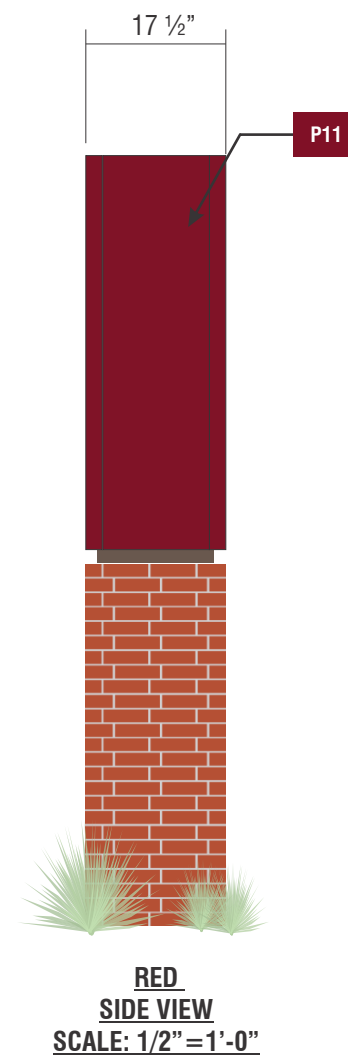
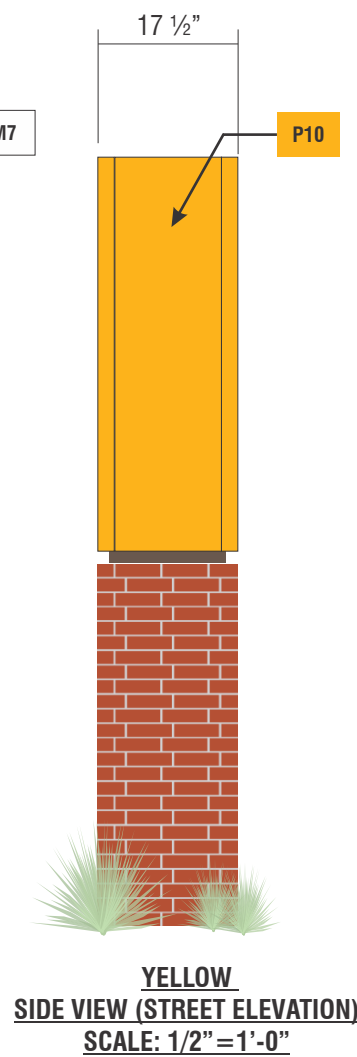
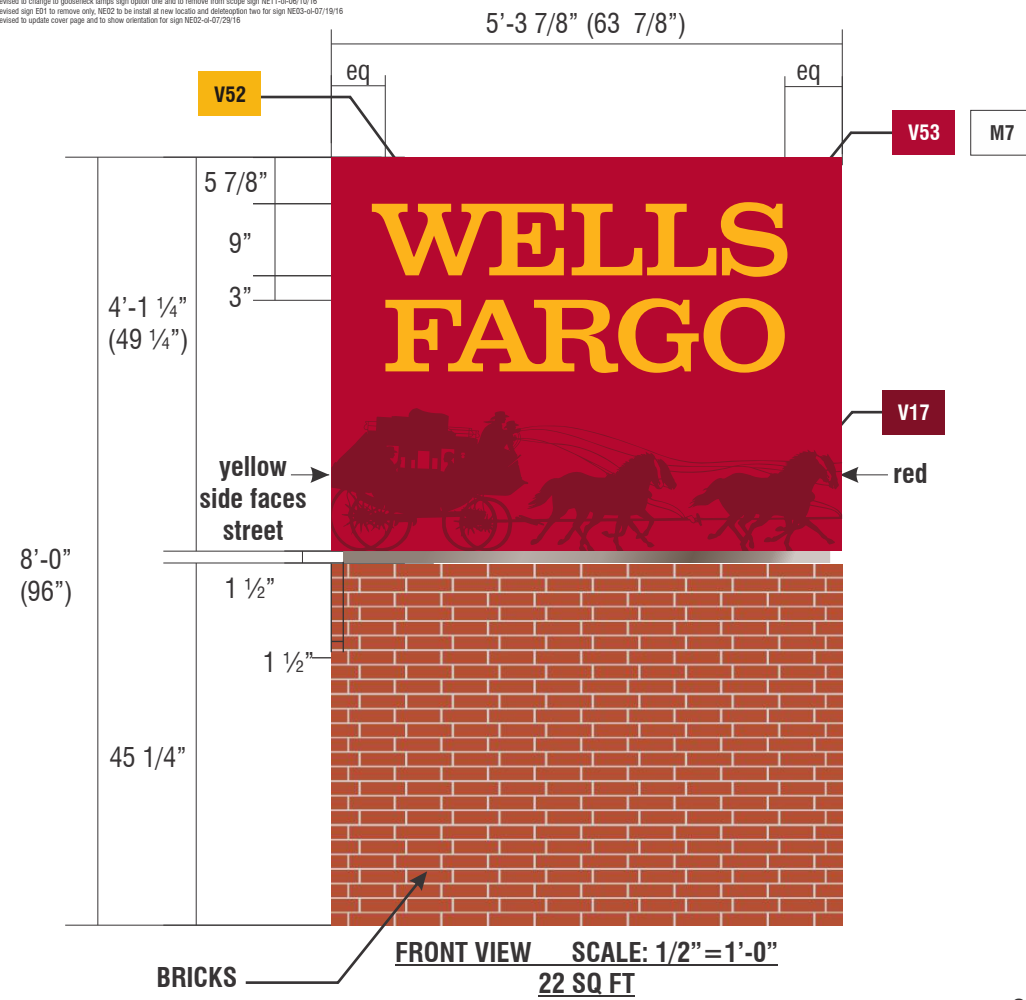

SPECIFICATIONS

- ① SIGNCOMP #2008 DOUBLE FACE HINGE BODY (TOP & BOTTOM)
- ② SIGNCOMP #2107 FLAT BLEED RETRO FRAME II (TOP & BOTTOM)
- ③ SIGNCOMP #2121 FLAT BLEED RETRO FRAME COVER (TOP & BOTTOM)
- ④ 2" X 2" X 3/16" THICK ALUMINUM ANGLE CORNER BODY
- ⑤ 2" X 2" X 1/8" THICK ALUMINUM ANGLE CORNER RETRO FRAME
- ⑥ 2" X 2" X 1/4" THICK STEEL ANGLE CORNER
- ⑦ SIGNCOMP #5357 FRAME BRACE
- ⑧ 1" X 1 1/2" X 1/8" THICK ALUMINUM RECTANGLE SUPPORT
- ⑨ 9 1/2" X 8 1/2" X 3/8" THICK STEEL SADDLE PLATE
- ⑩ 9 1/2" X 8 1/2" X 3/8" THICK STEEL SADDLE PLATE
- ⑪ SIGNCOMP #5990 #6 X 1/2" LENGTH COUNTERSUNK SCREW
- ⑫ SIGNCOMP #5178 #10 X 5/8" LENGTH HINGE CLOSURE SCREW
- ⑬ 1" X 1/8" THICK ALUMINUM FLAT BAR
- ⑭ 1/2-13 HEX NUT
- ⑮ 4" X 3/16" THICK STEEL SQUARE TUBE
- ⑯ 3/8-16 X 1" LENGTH STAINLESS STEEL HEX BOLT W/WASHER & NUT
- ⑰ 1/2-13 X 6" LENGTH HEX STEEL BOLT W/WASHER & NUT
- ⑱ 1/4-20 X 3/4" LENGTH HEX STEEL BOLT
- ⑲ SIGNCOMP #5360 TENSION CLIP - CLIP & MANDREL

NE02 SIGNTYPE WF-M-22-NON-ILL

MANUFACTURE AND INSTALL ONE (1) DOUBLE FACED INTERNALLY ILLUMINATED MONUMENT SIGN

VINYL

- V52** TRANSLUCENT YELLOW VINYL
3M ENVISION 3730-3790
- V53** TRANSLUCENT RED VINYL
3M ENVISION 3730-2222
- V17** OPAQUE DARK RED VINYL
3M SCOTCHCAL 7725-1802
- V18** CLEAR MATTE FILM
3M 3620

PAINT

- P3** LIGHT BRONZE WITH CLEARCOAT, SEMI GLOSS
MATTHEWS MP75296
- P10** YELLOW WITH CLEARCOAT, SEMI GLOSS
MATTHEWS MP66985
- P11** DARK RED WITH CLEARCOAT, SEMI GLOSS
MATTHEWS MP01126

MATERIALS

- M7** 3M PANOGRAPHICS III, WHITE

Custom Comments:

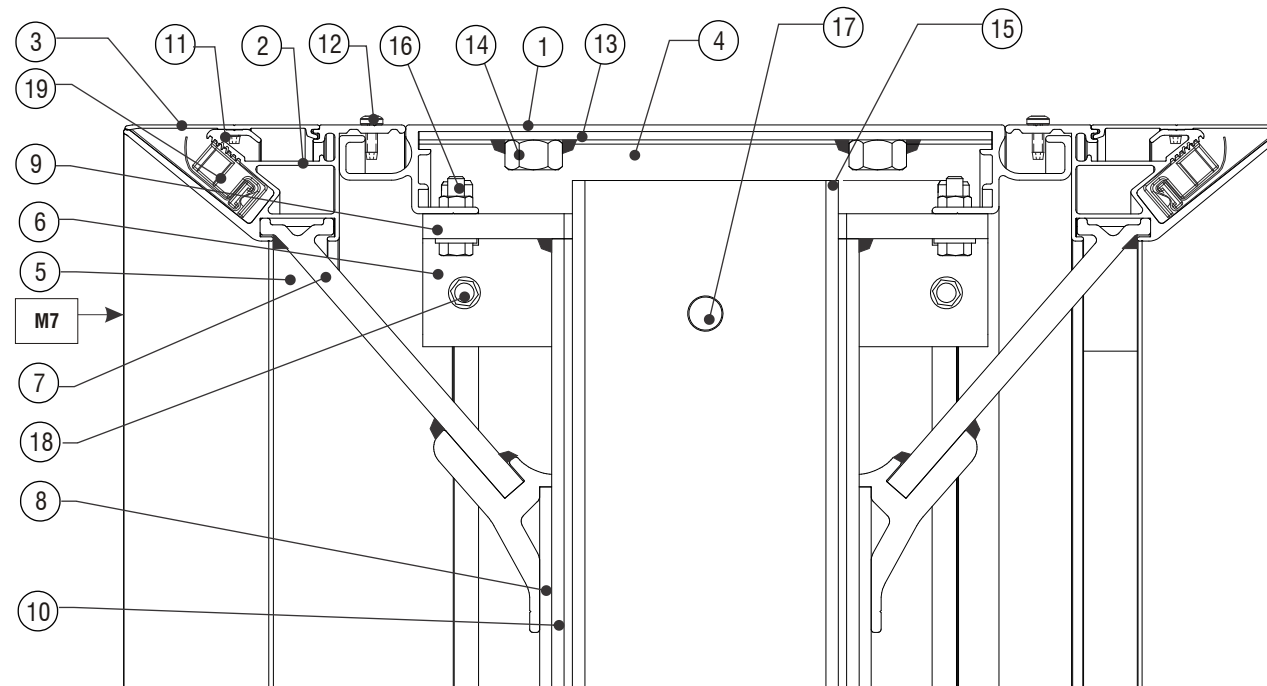

SECTION DETAIL

artwork file name: 13_WF_Cabinet.eps



Signtech™

4444 Federal Blvd. San Diego CA 92102
 Phone: (619) 527-6100 / Fax: (619) 527-6111
 www.signtechUSA.com



Wells Fargo # 104114

Ogden Valley
 2487 N HWY 158
 Eden, UT 84310 USA

Initial Date: 12/16/15
 Salesperson: Art Navarro
 Coordinator: Julie L. Horton
 Designer: O Lemus
 Scale: As noted

CUSTOMER APPROVAL

Customer Signature _____ Date _____

COPY, COLORS & SIZES

Signtech does NOT provide primary electrical to sign location - **RESPONSIBILITY OF OTHERS!**

Customer Signature _____ Date _____

This design is the exclusive property of Signtech and cannot be reproduced in whole or in part, without their prior written approval.

Drawing Number: 16-00140

Project ID: WELLS FARGO_104114_1

R1: Revised sign NE03 to CPL-12-ST and update new photo-04-12-15
 R2: Revisited update for sign 030 and to add new NE03-CPL-12-ST-04-15-15
 R3: Revisited update for sign 030 and to add new NE03-CPL-12-ST-04-15-15
 R4: New
 R5: New
 R6: New
 R7: New

NE03 **SIGNTYPE** **CPL-12-ST-GNL**



NE03 **EXISTING** **NONE** **SIGN ELEVATION** **SCALE: 1/8" = 1'-0"**

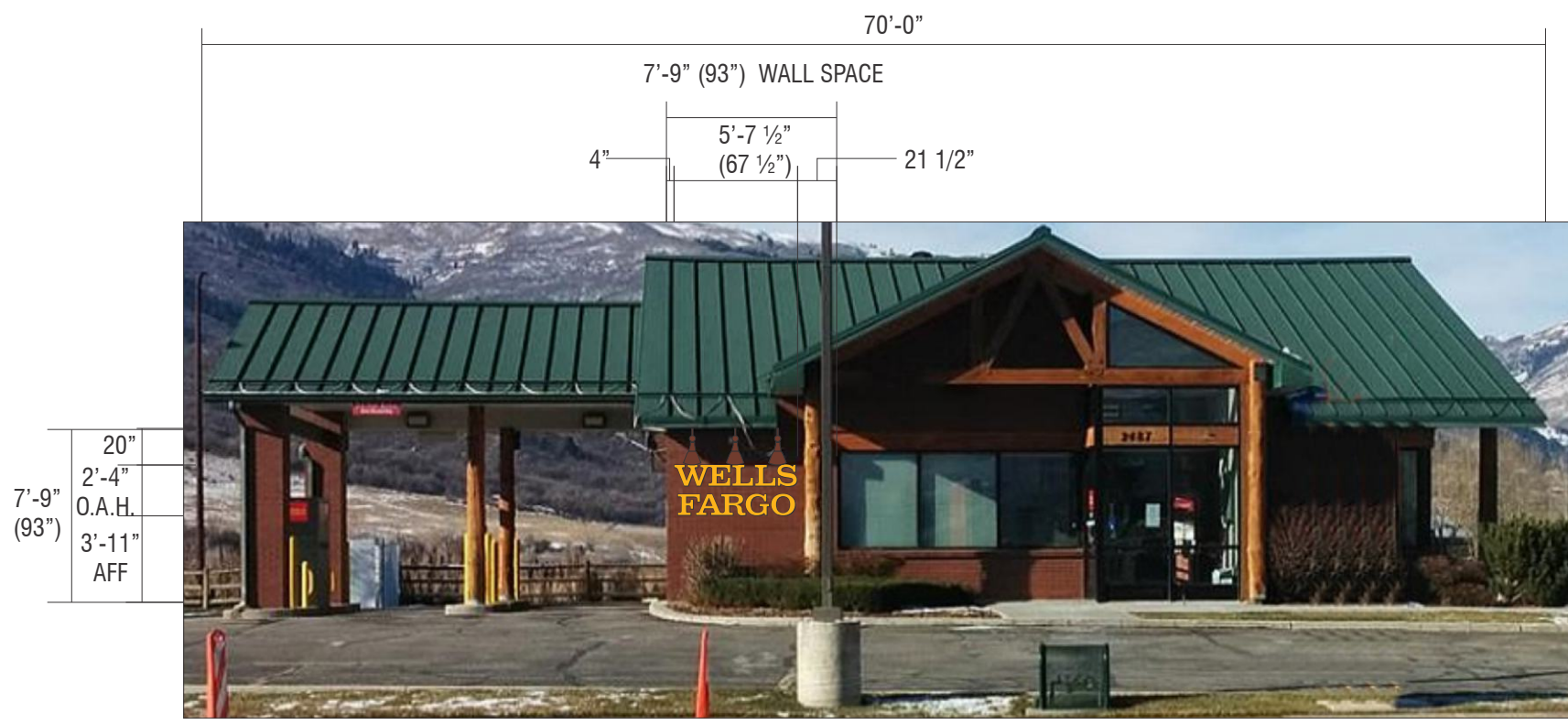

NE03 **PROPOSED** **CPL-12-ST-GNL** **SIGN ELEVATION** **SCALE: 1/8" = 1'-0"**

CUSTOM COMMENTS:



PHOTO LOOKING AWAY FROM SIGN



Signtech™

4444 Federal Blvd. San Diego CA 92102
 Phone: (619) 527-6100 / Fax: (619) 527-6111
 www.signtechUSA.com



Wells Fargo
104114

Ogden Valley
 2487 N HWY 158
 Eden, UT 84310 USA

Initial Date: 12/16/15
 Salesperson: Art Navarro
 Coordinator: Julie L. Horton
 Designer: O Lemus
 Scale: As noted

CUSTOMER APPROVAL

Customer Signature _____ Date _____

COPY, COLORS & SIZES

Signtech does NOT provide primary electrical to sign location - **RESPONSIBILITY OF OTHERS!**

Customer Signature _____ Date _____

This design is the exclusive property of Signtech and cannot be reproduced in whole or in part, without their prior written approval.

Drawing Number: 16-00140
 Project ID: WELLS FARGO_104114_1

R1: revised sign NE02 to DWG15-15-ST and update new photo-d-12/1/15
 R2: Revisedly update cut on sign E03 and to add new NET 20-CR55-A7M-d-03/09/16
 R3: Revised to proposed two options for sign E01 and options for wall sign-d-04/14/16
 R4: revised to go with option one for sign E02-d-04/14/16
 R5: revised to change to gooseneck lamps sign option one and to remove from scope sign NE11-d-06/10/16
 R6: revised sign E01 to remove only, NE02 to be install at new locale and discontinue two for sign NE03-d-07/16/16
 R7: revised to update cover page and to show orientation for sign NE03-d-07/26/16

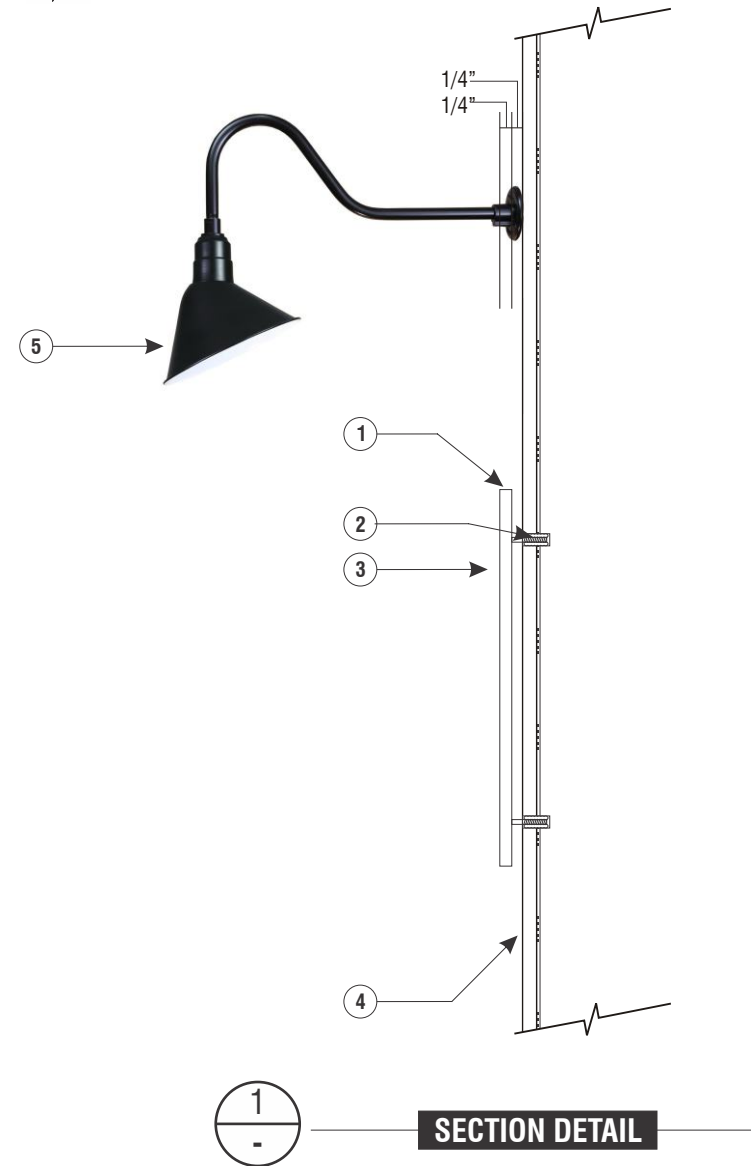
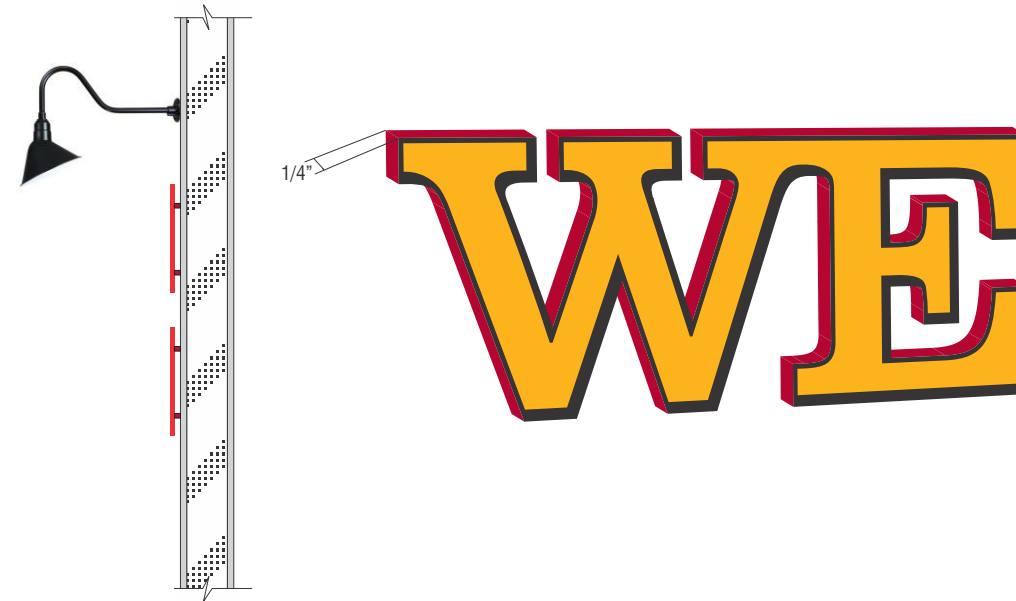
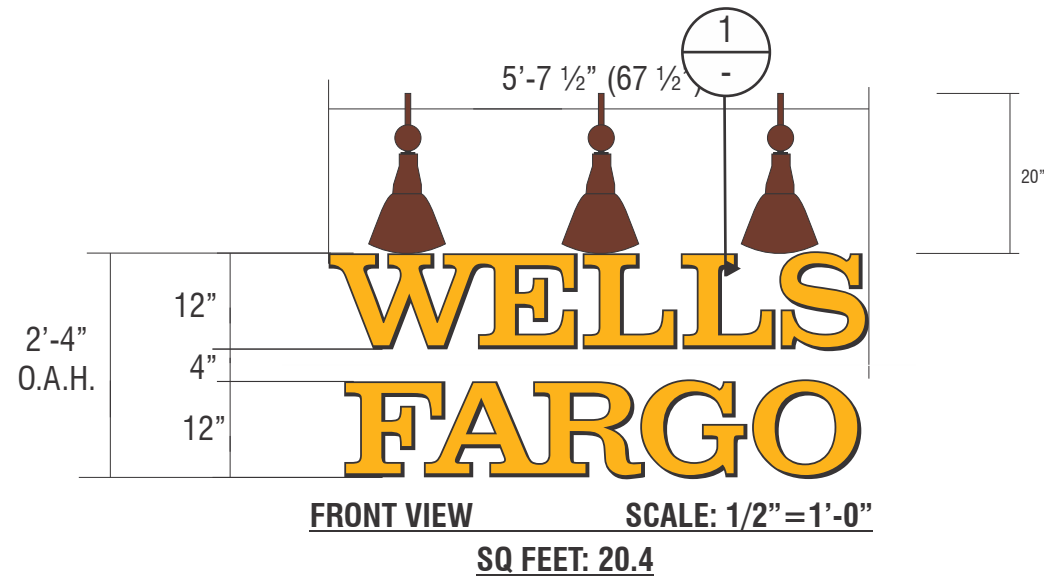

NE03 SIGNTYPE WF-CPL-12-ST-GNL

MANUFACTURE AND INSTALL ONE (1) SET OF NON-ILLUMINATED CUT PLATE LETTERS / W GOOSENECK LAMPS

PAINT

- P2** BLACK WITH CLEARCOAT, FULL GLOSS MATTHEWS MP30132
- P10** YELLOW WITH CLEARCOAT, SEMI GLOSS MATTHEWS MP66985

SPECIFICATIONS

- ① 1/4" ALUMINUM RETURNS
- ② WELDED STUDS
- ③ 1/4" ALUMINUM PLATE LETTERS
- ④ FASCIA MATERIAL - BRICKS
- ⑤ GOOSENECK LAMP (<http://www.loveitlighting.com/drawing/20-859.pdf>) PAINTED (TBV)

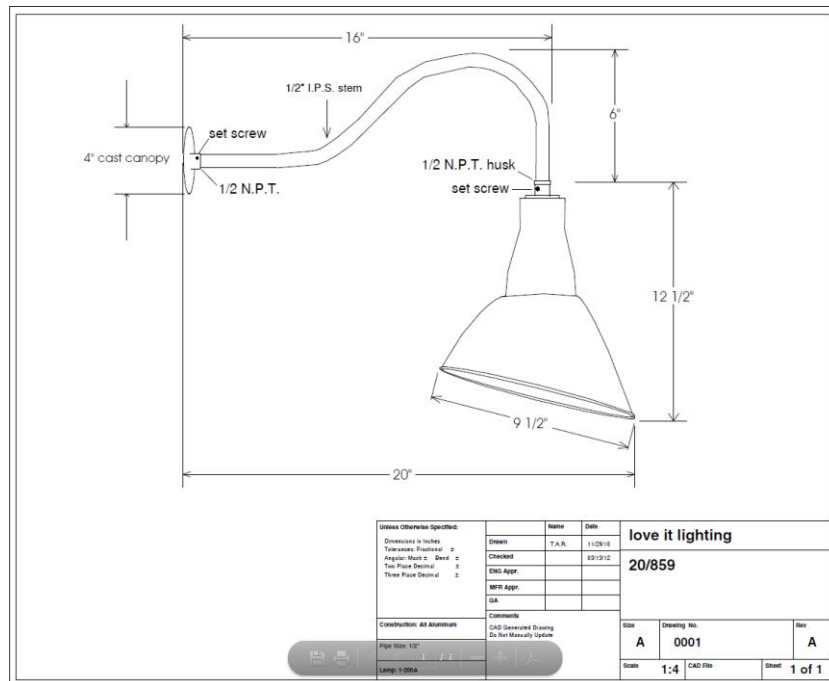

Signtech™

4444 Federal Blvd. San Diego CA 92102
 Phone: (619) 527-6100 / Fax: (619) 527-6111
www.signtechUSA.com



**Wells Fargo
 # 104114**

Ogden Valley
 2487 N HWY 158
 Eden, UT 84310 USA

Initial Date: 12/16/15
 Salesperson: Art Navarro
 Coordinator: Julie L. Horton
 Designer: O Lemus
 Scale: As noted

CUSTOMER APPROVAL

Customer Signature _____ Date _____

COPY, COLORS & SIZES

Signtech does NOT provide primary electrical to sign location - **RESPONSIBILITY OF OTHERS!**

Customer Signature _____ Date _____

This design is the exclusive property of Signtech and cannot be reproduced in whole or in part, without their prior written approval.

Drawing Number: 16-00140

Project ID: WELLS FARGO_104114_1



SIGN ELEVATION **SCALE: 3/4"=1'-0"**

E04	EXISTING	DIRECTIONAL SIGN
------------	-----------------	-------------------------

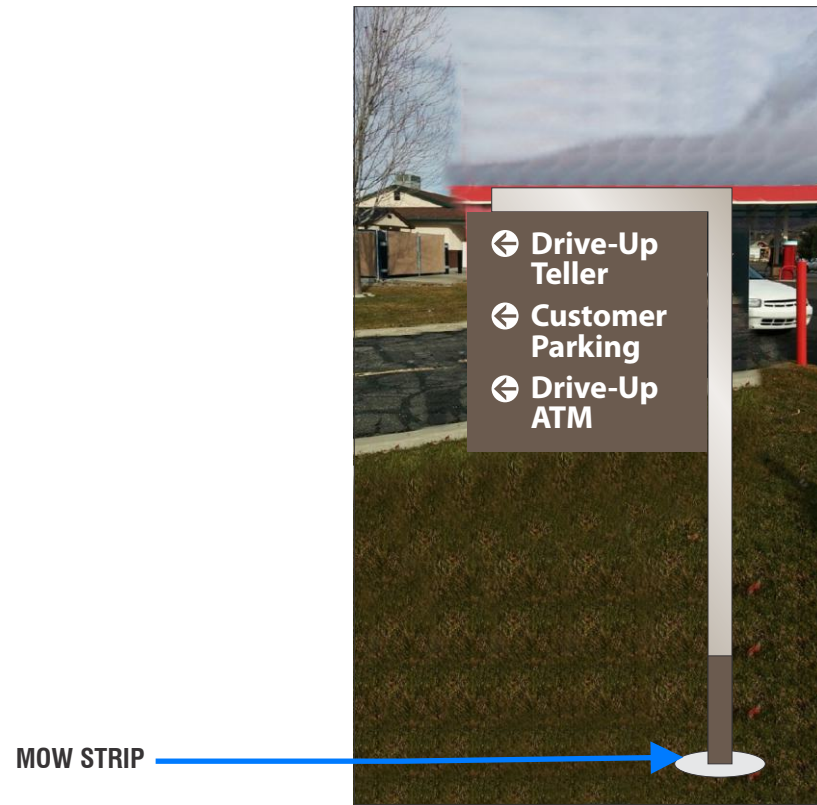

SIGN ELEVATION **SCALE: 3/4"=1'-0"**

E04	PROPOSED	DS-20-48
------------	-----------------	-----------------

CUSTOM COMMENTS:



Signtech™

4444 Federal Blvd. San Diego CA 92102
 Phone: (619) 527-6100 / Fax: (619) 527-6111
www.signtechUSA.com



Wells Fargo
104114
 Ogden Valley
 2487 N HWY 158
 Eden, UT 84310 USA

Initial Date: 12/16/15
 Salesperson: Art Navarro
 Coordinator: Julie L. Horton
 Designer: O Lemus
 Scale: As noted

CUSTOMER APPROVAL

Customer Signature _____ Date _____

COPY, COLORS & SIZES

Signtech does NOT provide primary
 electrical to sign location -
RESPONSIBILITY OF OTHERS!

Customer Signature _____ Date _____

This design is the exclusive property of Signtech
 and cannot be reproduced in whole or in part,
 without their prior written approval.

Drawing Number: 16-00140

Project ID: WELLS FARGO_104114_1

R1: revised sign NE02 to CHRWL-15-ST and update new photo-d-12/1/15
 R2: Revisedly update had on sign E03 and to add new NET C-CR05-A7M-d-03/09/16
 R3: Revised to proposed two options for sign E01 and options for wall sign-d-04/14/16
 R4: revised to go with option one for sign E02-d-04/14/16
 R5: revised to change to gooseneck lamp sign option one and to remove from scope sign NE11-d-06/10/16
 R6: revised sign E01 to remove only, NE02 to be install at new location and distribution two for sign NE03-d-07/18/16
 R7: revised to update cover page and to show orientation for sign NE02-d-07/26/16

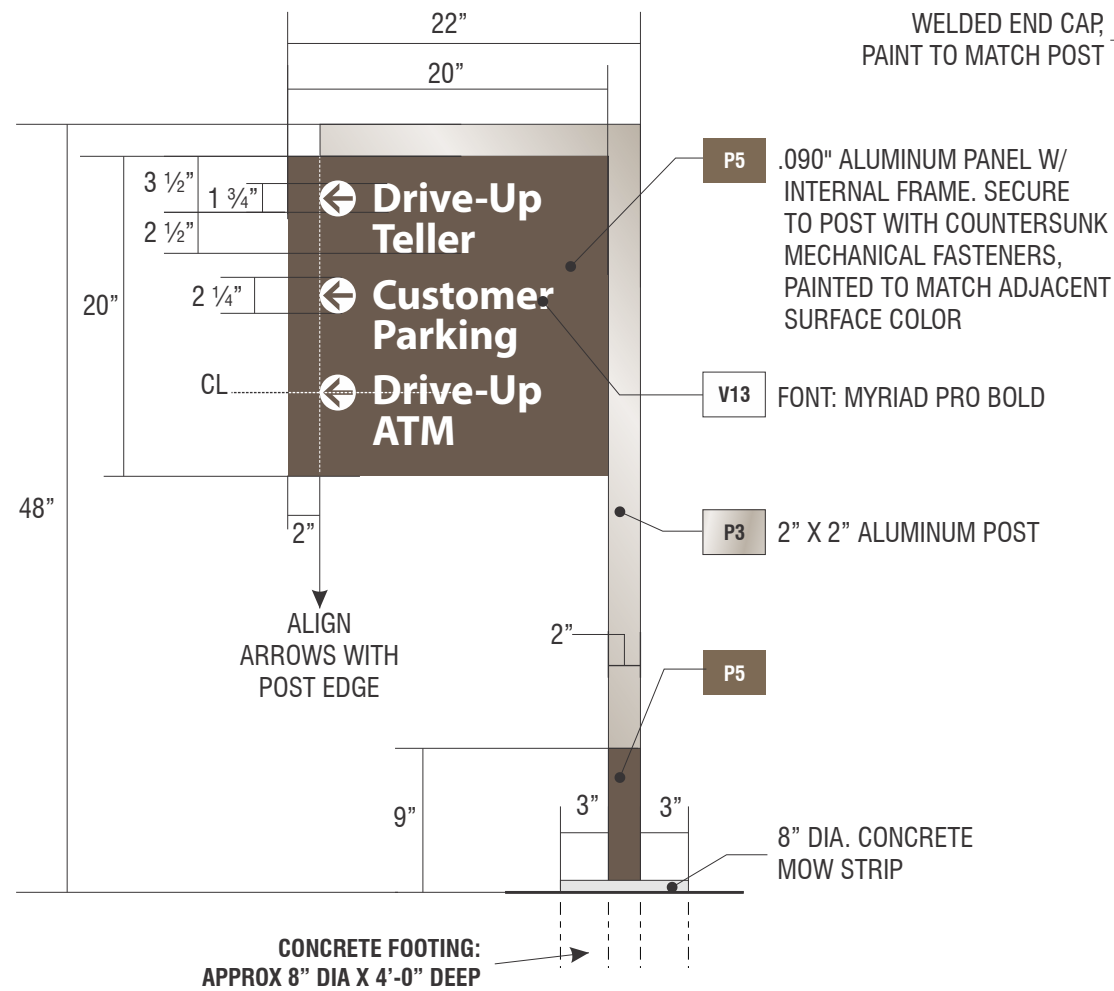
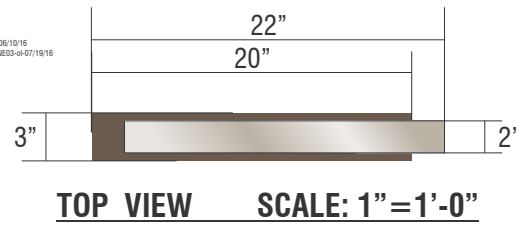

WELDED END CAP,
PAINT TO MATCH POST

P5 .090" ALUMINUM PANEL W/
INTERNAL FRAME. SECURE
TO POST WITH COUNTERSUNK
MECHANICAL FASTENERS,
PAINTED TO MATCH ADJACENT
SURFACE COLOR

V13 FONT: MYRIAD PRO BOLD

P3 2" X 2" ALUMINUM POST

8" DIA. CONCRETE
MOW STRIP

CONCRETE FOOTING:
APPROX 8" DIA X 4'-0" DEEP

ALIGN
ARROWS WITH
POST EDGE

ALIGN
ARROWS WITH
POST EDGE

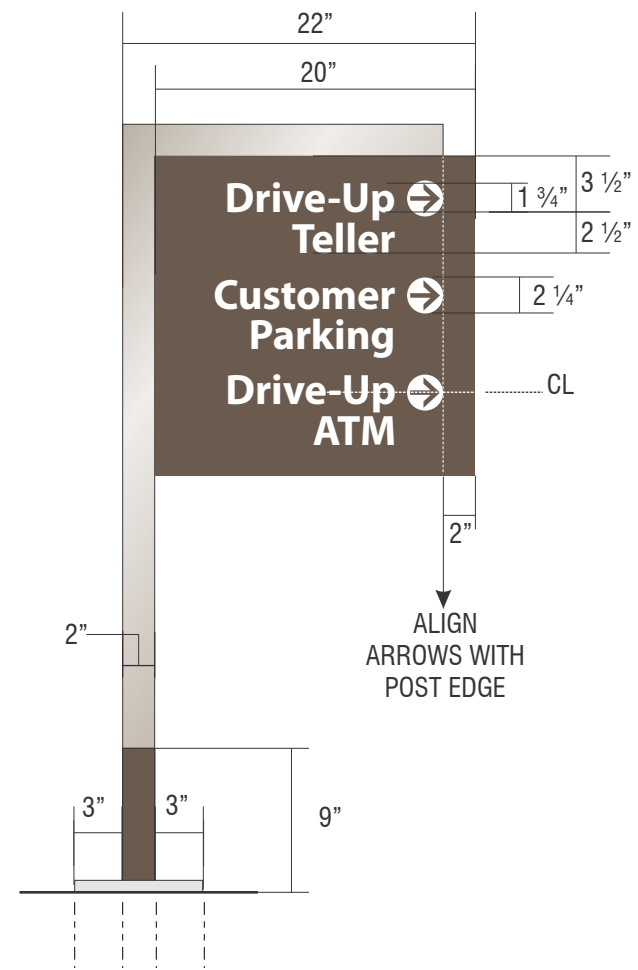
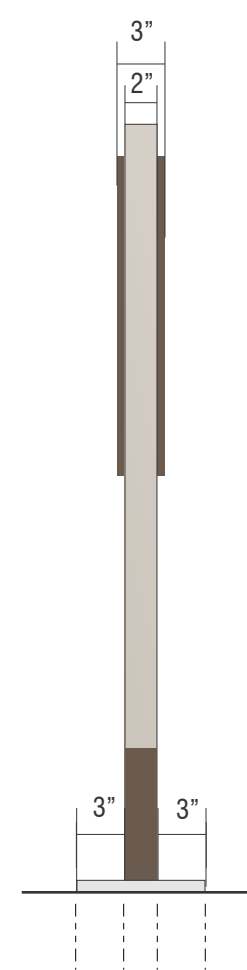
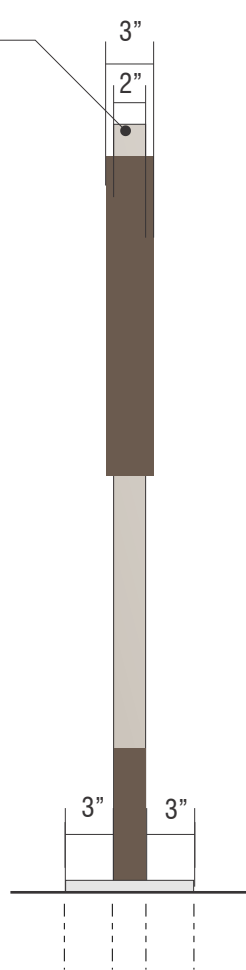

E04

SIGNTYPE WF-DS-20-48 MANUFACTURE AND INSTALL ONE (1) NON-ILLUMINATED INFORMATIONAL SIGN - POLE MOUNTED

PAINT

P3 LIGHT BRONZE WITH CLEARCOAT, SEMI GLOSS
MATTHEWS MP75296

P5 WARM GRAY WITH CLEARCOAT, SEMI GLOSS
MATTHEWS MP20148

VINYL

V13 WHITE, OPAQUE, GRAY ADHESIVE
3M CONTROLTAC 180-10

NOTES

- 1) ALL WELDS TO BE GROUND SMOOTH PRIOR TO PAINTING.
- 2) ALL SURFACES TO BE FREE OF VISIBLE SEAMS.
- 3) FOOTINGS TO BE ENGINEERED BASED ON EXISTING CONDITIONS, LOCAL WINDLOADS, AND WEATHER CONDITIONS.



Signtech™

4444 Federal Blvd. San Diego CA 92102
 Phone: (619) 527-6100 / Fax: (619) 527-6111
 www.signtechUSA.com



**Wells Fargo
 # 104114**
 Ogden Valley
 2487 N HWY 158
 Eden, UT 84310 USA

Initial Date: 12/16/15
 Salesperson: Art Navarro
 Coordinator: Julie L. Horton
 Designer: O Lemus
 Scale: As noted

CUSTOMER APPROVAL

Customer Signature _____ Date _____

COPY, COLORS & SIZES

Signtech does NOT provide primary
 electrical to sign location -
RESPONSIBILITY OF OTHERS!

Customer Signature _____ Date _____

This design is the exclusive property of Signtech
 and cannot be reproduced in whole or in part,
 without their prior written approval.

Drawing Number: 16-00140

Project ID: WELLS FARGO_104114_1



SIGN ELEVATION SCALE: 3/4" = 1'-0"

E05 EXISTING INFORMATIONAL SIGN



SIGN ELEVATION SCALE: 3/4" = 1'-0"

E05 PROPOSED IS-18-60

CUSTOM COMMENTS:



Signtech™

4444 Federal Blvd. San Diego CA 92102
 Phone: (619) 527-6100 / Fax: (619) 527-6111
 www.signtechUSA.com



**Wells Fargo
 # 104114**
 Ogden Valley
 2487 N HWY 158
 Eden, UT 84310 USA

Initial Date: 12/16/15
 Salesperson: Art Navarro
 Coordinator: Julie L. Horton
 Designer: O Lemus
 Scale: As noted

CUSTOMER APPROVAL

Customer Signature _____ Date _____

COPY, COLORS & SIZES

Signtech does NOT provide primary electrical to sign location - **RESPONSIBILITY OF OTHERS!**

Customer Signature _____ Date _____

This design is the exclusive property of Signtech and cannot be reproduced in whole or in part, without their prior written approval.

Drawing Number: 16-00140

Project ID: WELLS FARGO_104114_1



SIGN ELEVATION SCALE: 3/4"=1'-0"

E06 EXISTING INFORMATIONAL SIGN



SIGN ELEVATION SCALE: 3/4"=1'-0"

E06 PROPOSED IS-18-60

CUSTOM COMMENTS:



Signtech™

4444 Federal Blvd. San Diego CA 92102
 Phone: (619) 527-6100 / Fax: (619) 527-6111
 www.signtechUSA.com



**Wells Fargo
 # 104114**

Ogden Valley
 2487 N HWY 158
 Eden, UT 84310 USA

Initial Date: 12/16/15
 Salesperson: Art Navarro
 Coordinator: Julie L. Horton
 Designer: O Lemus
 Scale: As noted

CUSTOMER APPROVAL

Customer Signature _____ Date _____

COPY, COLORS & SIZES

Signtech does NOT provide primary electrical to sign location - **RESPONSIBILITY OF OTHERS!**

Customer Signature _____ Date _____

This design is the exclusive property of Signtech and cannot be reproduced in whole or in part, without their prior written approval.

Drawing Number: 16-00140

Project ID: WELLS FARGO_104114_1

R1: revised sign NE02 to CHRWGL-15-07 and update new photo-d-12/21/15
 R2: Revisedly update had on sign E05 and to add new NET 2-CR05-A7M-d-03/09/16
 R3: Revised to proposed two options for sign E01 and options for wall sign-d-04/14/16
 R4: revised to go with option one for sign E02-d-04/14/16
 R5: revised to change to gooseneck lamp sign option one and to remove from scope sign NE11-d-06/10/16
 R6: revised sign E01 to remove only, NE02 to be install at new location and distribution two for sign NE03-d-07/18/16
 R7: revised to update cover page and to show orientation for sign NE02-d-07/26/16

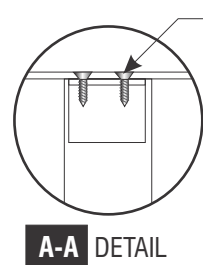
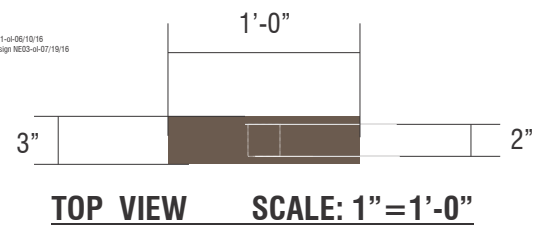

SIGN PLATE MECHANICALLY FASTENED TO 2" X 2" X 1/8" ALUM TUBE



#8 FLATHEAD SCREW
ALUM SUPPORT ANGLE

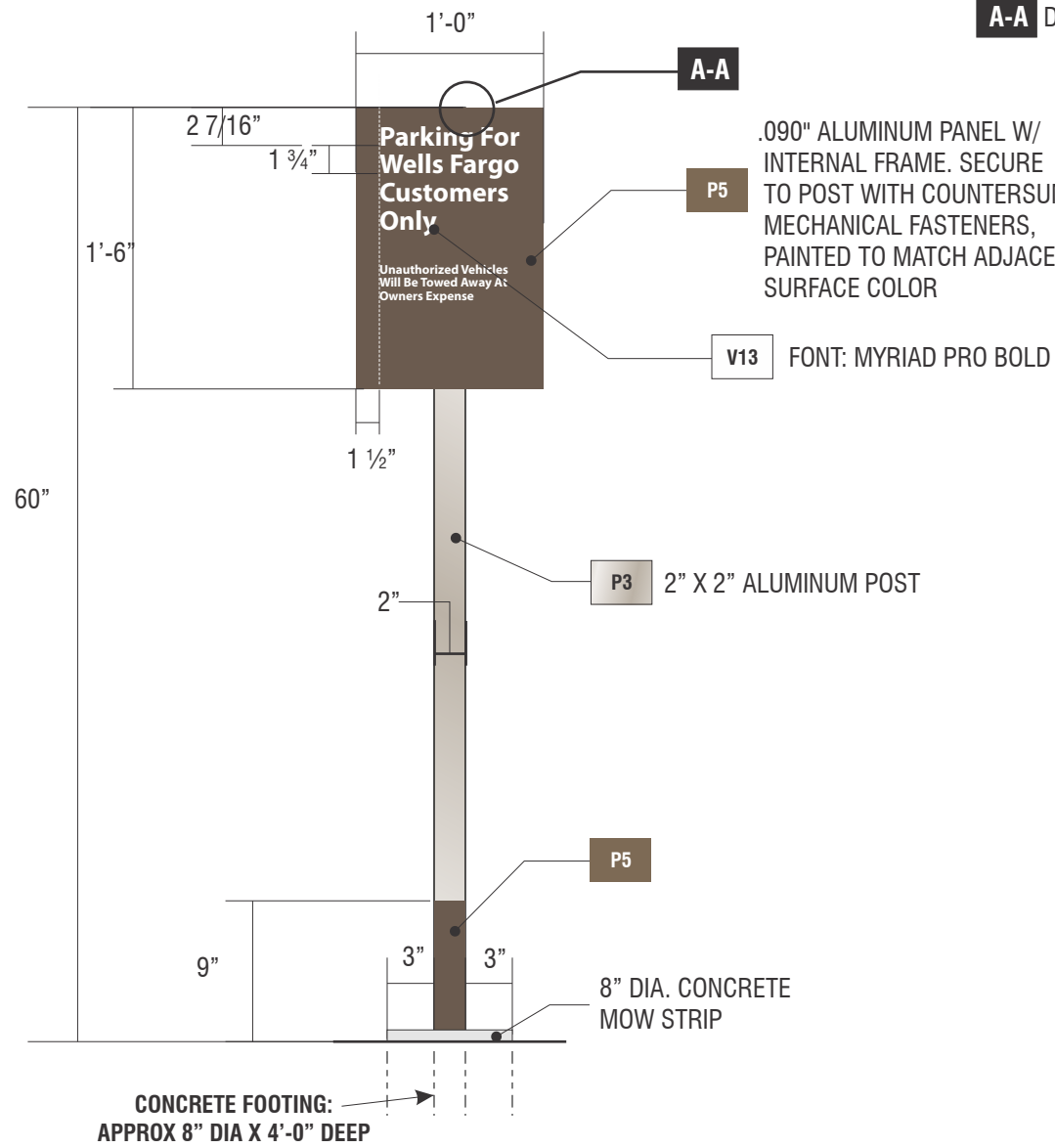

FRONT VIEW SCALE: 1"=1'-0"

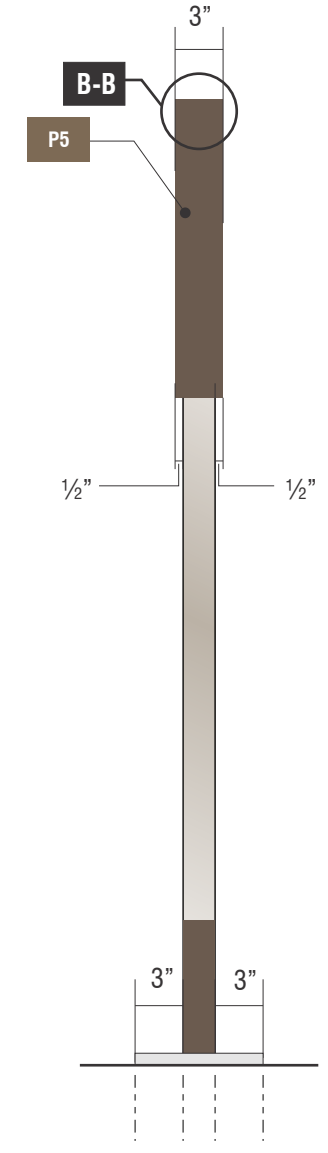

END VIEW SCALE: 1"=1'-0"

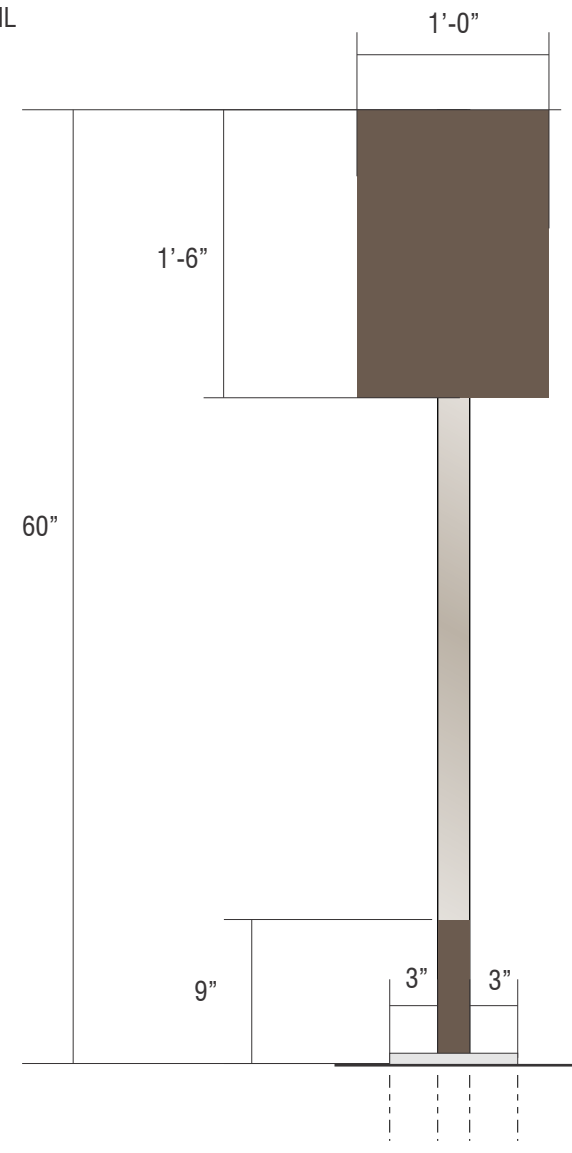

BACK VIEW SCALE: 1"=1'-0"

E05 E06

SIGNTYPE WF-IS-18-60 **MANUFACTURE AND INSTALL TWO (2) NON-ILLUMINATED INFORMATIONAL SIGN(S) - POLE MOUNTED**

PAINT

- P3 LIGHT BRONZE WITH CLEARCOAT, SEMI GLOSS MATTHEWS MP75296
- P5 WARM GRAY WITH CLEARCOAT, SEMI GLOSS MATTHEWS MP20148

VINYL

- V13 WHITE, OPAQUE, GRAY ADHESIVE 3M CONTROLTAC 180-10

NOTES

- 1) ALL WELDS TO BE GROUND SMOOTH PRIOR TO PAINTING.
- 2) ALL SURFACES TO BE FREE OF VISIBLE SEAMS.
- 3) FOOTINGS TO BE ENGINEERED BASED ON EXISTING CONDITIONS, LOCAL WINDLOADS, AND WEATHER CONDITIONS.



Signtech™

4444 Federal Blvd. San Diego CA 92102
 Phone: (619) 527-6100 / Fax: (619) 527-6111
 www.signtechUSA.com



**Wells Fargo
 # 104114**
 Ogden Valley
 2487 N HWY 158
 Eden, UT 84310 USA

Initial Date: 12/16/15
 Salesperson: Art Navarro
 Coordinator: Julie L. Horton
 Designer: O Lemus
 Scale: As noted

CUSTOMER APPROVAL

Customer Signature _____ Date _____

COPY, COLORS & SIZES

Signtech does NOT provide primary electrical to sign location - **RESPONSIBILITY OF OTHERS!**

Customer Signature _____ Date _____

This design is the exclusive property of Signtech and cannot be reproduced in whole or in part, without their prior written approval.

Drawing Number: 16-00140
 Project ID: WELLS FARGO_104114_1

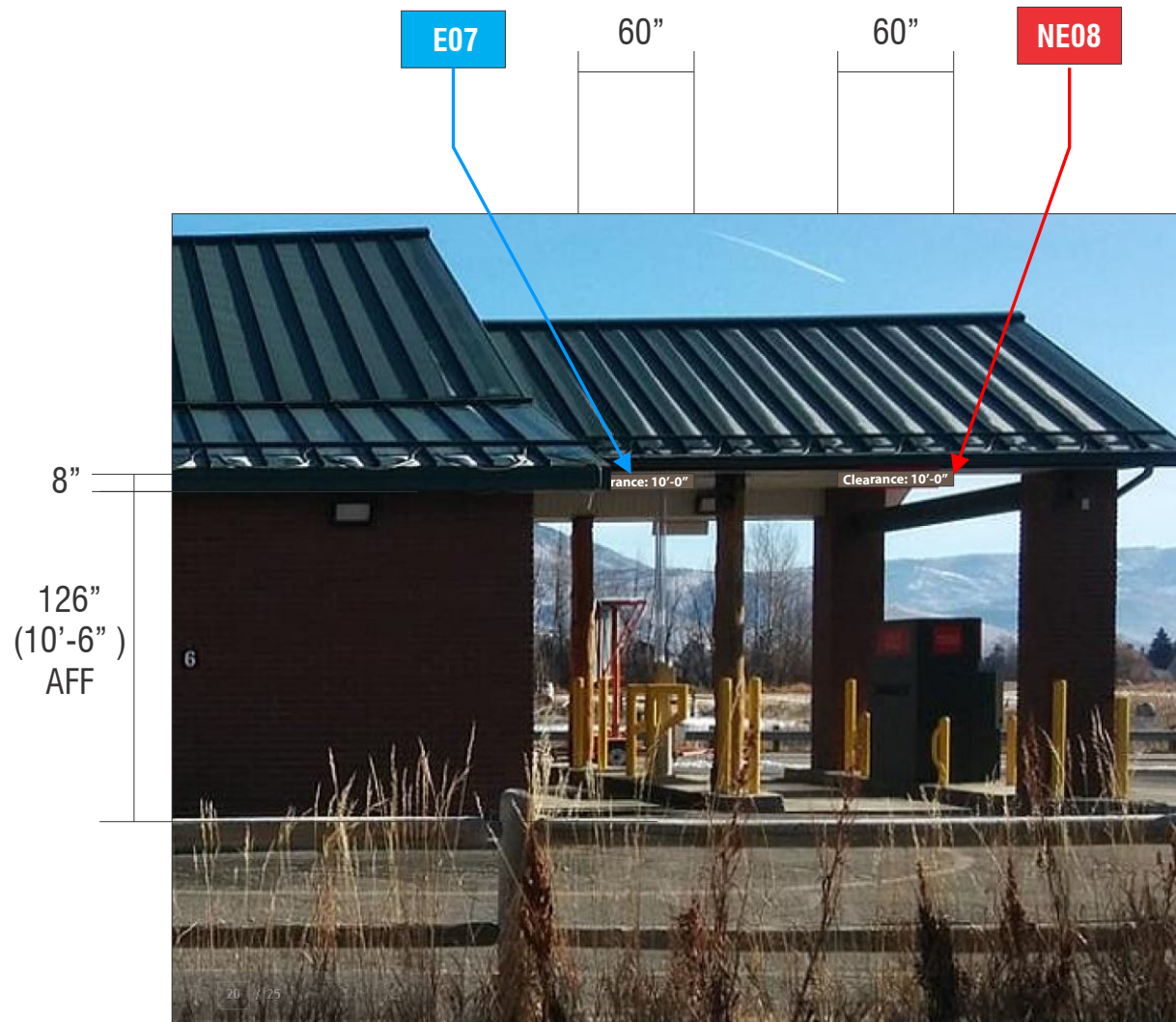

SIGN ELEVATION **SCALE: 1/8" = 1'-0"**

E07	EXISTING	CLEARANCE SIGN
NE08	EXISTING	NONE

SIGN ELEVATION **SCALE: 1/8" = 1'-0"**

E07	PROPOSED	DRIVE THRU CLEARANCE
NE08	PROPOSED	DRIVE THRU CLEARANCE

CUSTOM COMMENTS:



Signtech™

4444 Federal Blvd. San Diego CA 92102
 Phone: (619) 527-6100 / Fax: (619) 527-6111
 www.signtechUSA.com



Wells Fargo
104114
 Ogden Valley
 2487 N HWY 158
 Eden, UT 84310 USA

Initial Date: 12/16/15
 Salesperson: Art Navarro
 Coordinator: Julie L. Horton
 Designer: O Lemus
 Scale: As noted

CUSTOMER APPROVAL

Customer Signature _____ Date _____

COPY, COLORS & SIZES

Signtech does NOT provide primary electrical to sign location - **RESPONSIBILITY OF OTHERS!**

Customer Signature _____ Date _____

This design is the exclusive property of Signtech and cannot be reproduced in whole or in part, without their prior written approval.

Drawing Number: 16-00140

Project ID: WELLS FARGO_104114_1

R1: revised sign NE02 to CHRWGL-15-07 and update new photo-d-12/21/15
 R2: Revisedly update had on sign E03 and to add new NET 22-CHRWGL-15-07-03/09/16
 R3: Revised to proposed two options for sign E01 and options for wall sign-d-04/14/16
 R4: revised to go with option one for sign E02-d-04/14/16
 R5: revised to change to gooseneck lamps sign option one and to remove from scope sign NE11-d-06/10/16
 R6: revised sign E01 to remove only, NE02 to be install at new location and distribution two for sign NE03-d-07/16/16
 R7: revised to update cover page and to show elevation for sign NE02-d-07/26/16

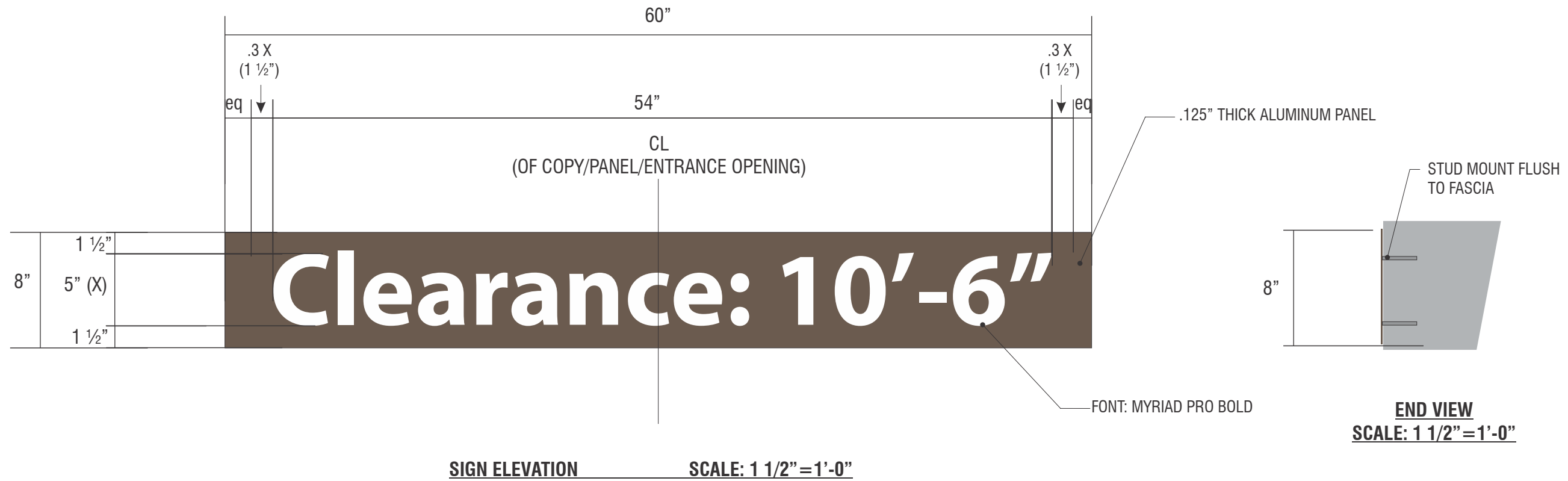

E07 | NE08

SIGNTYPE DRIVE THRU CLEARANCE SIGN

MANUFACTURE AND INSTALL TWO (2) NON-ILLUMINATED CLEARANCE SIGNS

VINYL

V13 WHITE, OPAQUE, GRAY ADHESIVE
3M CONTROLTAC 180-10

PAINT

P5 WARM GRAY WITH CLEARCOAT, SEMI GLOSS
MATTHEWS MP20148



Signtech™

4444 Federal Blvd. San Diego CA 92102
 Phone: (619) 527-6100 / Fax: (619) 527-6111
 www.signtechUSA.com



**Wells Fargo
 # 104114**

Ogden Valley
 2487 N HWY 158
 Eden, UT 84310 USA

Initial Date: 12/16/15
 Salesperson: Art Navarro
 Coordinator: Julie L. Horton
 Designer: O Lemus
 Scale: As noted

CUSTOMER APPROVAL

Customer Signature _____ Date _____

COPY, COLORS & SIZES

Signtech does NOT provide primary
 electrical to sign location -
RESPONSIBILITY OF OTHERS!

Customer Signature _____ Date _____

This design is the exclusive property of Signtech
 and cannot be reproduced in whole or in part,
 without their prior written approval.

Drawing Number: 16-00140

Project ID: WELLS FARGO_104114_1

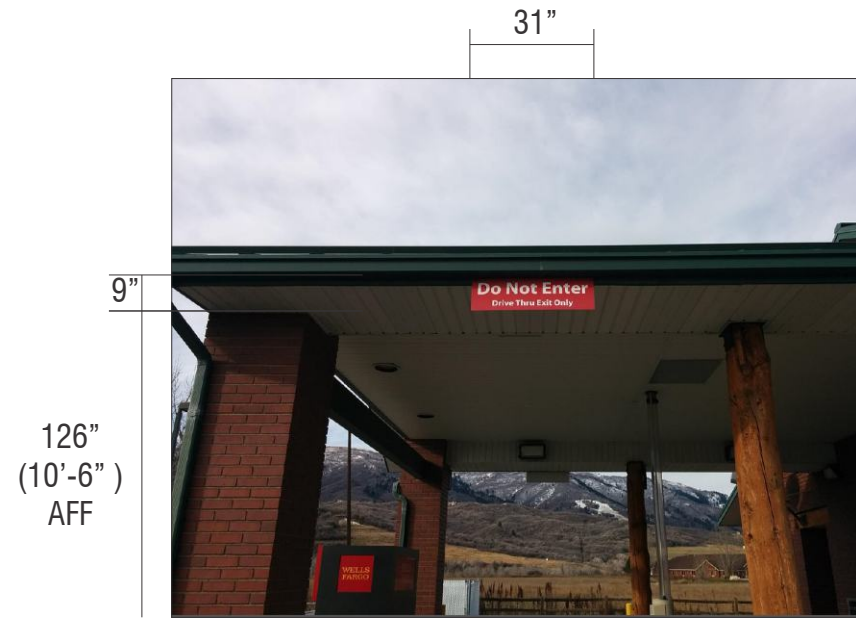

SIGN ELEVATION SCALE: 1/4" = 1'-0"

E09	EXISTING	DO NOT ENTER SIGN
-----	----------	-------------------

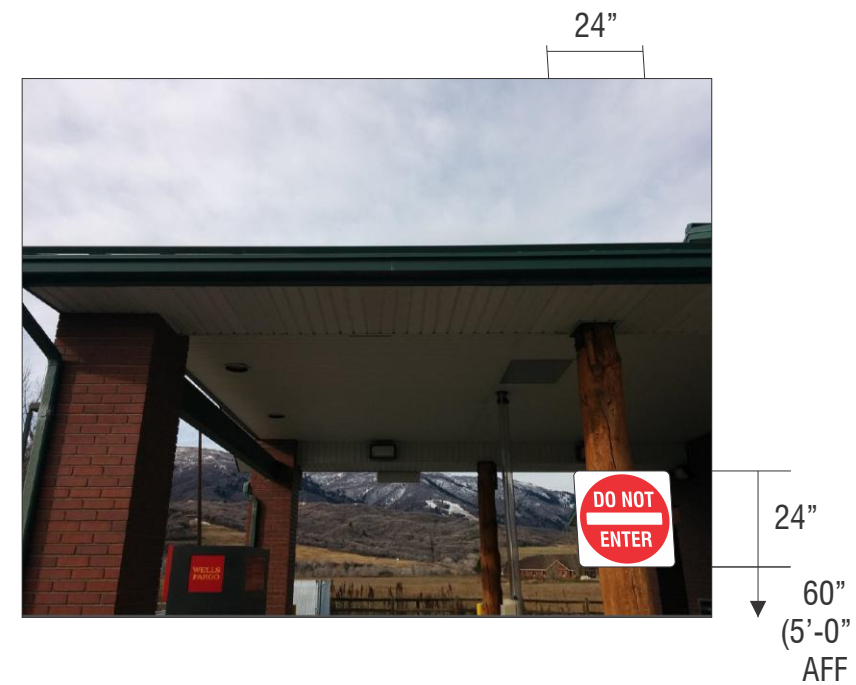

SIGN ELEVATION SCALE: 1/2" = 1'-0"

E09	PROPOSED	DOT DO NOT ENTER
-----	----------	------------------

CUSTOM COMMENTS:



Signtech™

4444 Federal Blvd. San Diego CA 92102
Phone: (619) 527-6100 / Fax: (619) 527-6111
www.signtechUSA.com



**Wells Fargo
104114**
Ogden Valley
2487 N HWY 158
Eden, UT 84310 USA

Initial Date: 12/16/15
Salesperson: Art Navarro
Coordinator: Julie L. Horton
Designer: O Lemus
Scale: As noted

CUSTOMER APPROVAL

Customer Signature _____ Date _____

COPY, COLORS & SIZES

Signtech does NOT provide primary electrical to sign location - **RESPONSIBILITY OF OTHERS!**

Customer Signature _____ Date _____

This design is the exclusive property of Signtech and cannot be reproduced in whole or in part, without their prior written approval.

Drawing Number: 16-00140

Project ID: WELLS FARGO_104114_1

R1 revised sign NE02 to CHRWL-15-ST and update new photo-d-12/1/15
 R2: Revisedly update had on sign E09 and to add new NET 2-CR25-A7M-d-03/09/16
 R3: Revised to proposed two options for sign E01 and options for wall sign-d-04/14/16
 R4: revised to go with option one for sign E02-d-04/15/16
 R5: revised to change to gooseneck lamps sign option one and to remove from scope sign NE11-d-06/10/16
 R6: revised sign E01 to remove only, NE02 to be install at new locale and distribution two for sign NE03-d-07/16/16
 R7: revised to update cover page and to show orientation for sign NE02-d-07/26/16

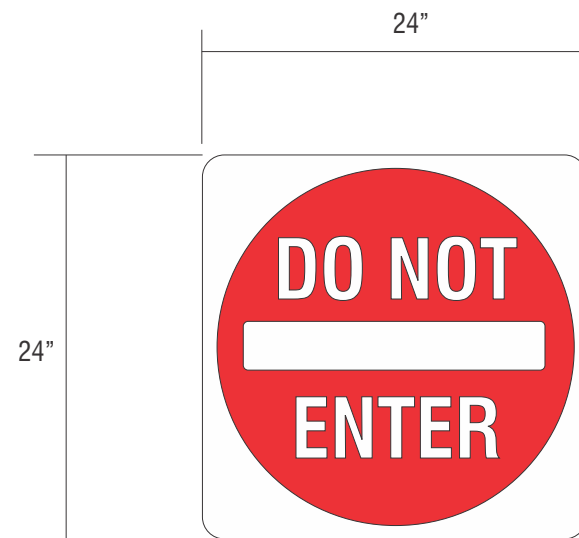

SCALE: 1" = 1'-0"

E09

SIGNTYPE DOT APPROVED "DO NOT ENTER SIGN"

MANUFACTURE AND INSTALL ONE (1) NON-ILLUMINATED DOT SIGN

SIGN CONSTRUCTION:

- THESE SIGNS ARE MANUFACTURED WITH RUST FREE ALUMINUM LAMINATED WITH ENGINEERING GRADE REFLECTIVE (TYPE I).
- GRAPHICS ARE PRINTED WITH TRANSLUCENT INKS OR APPLIED VINYL GRAPHICS, OPAQUE AND TRANSLUCENT FILM.

STUD MOUNT FLUSH TO WALL AS SHOWN ABOVE



Signtech™

4444 Federal Blvd. San Diego CA 92102
 Phone: (619) 527-6100 / Fax: (619) 527-6111
 www.signtechUSA.com



**Wells Fargo
 # 104114**

Ogden Valley
 2487 N HWY 158
 Eden, UT 84310 USA

Initial Date: 12/16/15
 Salesperson: Art Navarro
 Coordinator: Julie L. Horton
 Designer: O Lemus
 Scale: As noted

CUSTOMER APPROVAL

Customer Signature _____ Date _____

COPY, COLORS & SIZES

Signtech does NOT provide primary electrical to sign location - **RESPONSIBILITY OF OTHERS!**

Customer Signature _____ Date _____

This design is the exclusive property of Signtech and cannot be reproduced in whole or in part, without their prior written approval.

Drawing Number: 16-00140

Project ID: WELLS FARGO_104114_1

E10 SIGNTYPE REMOVE ONLY

RESTORATION AREA

31 1/4"

39 1/4"

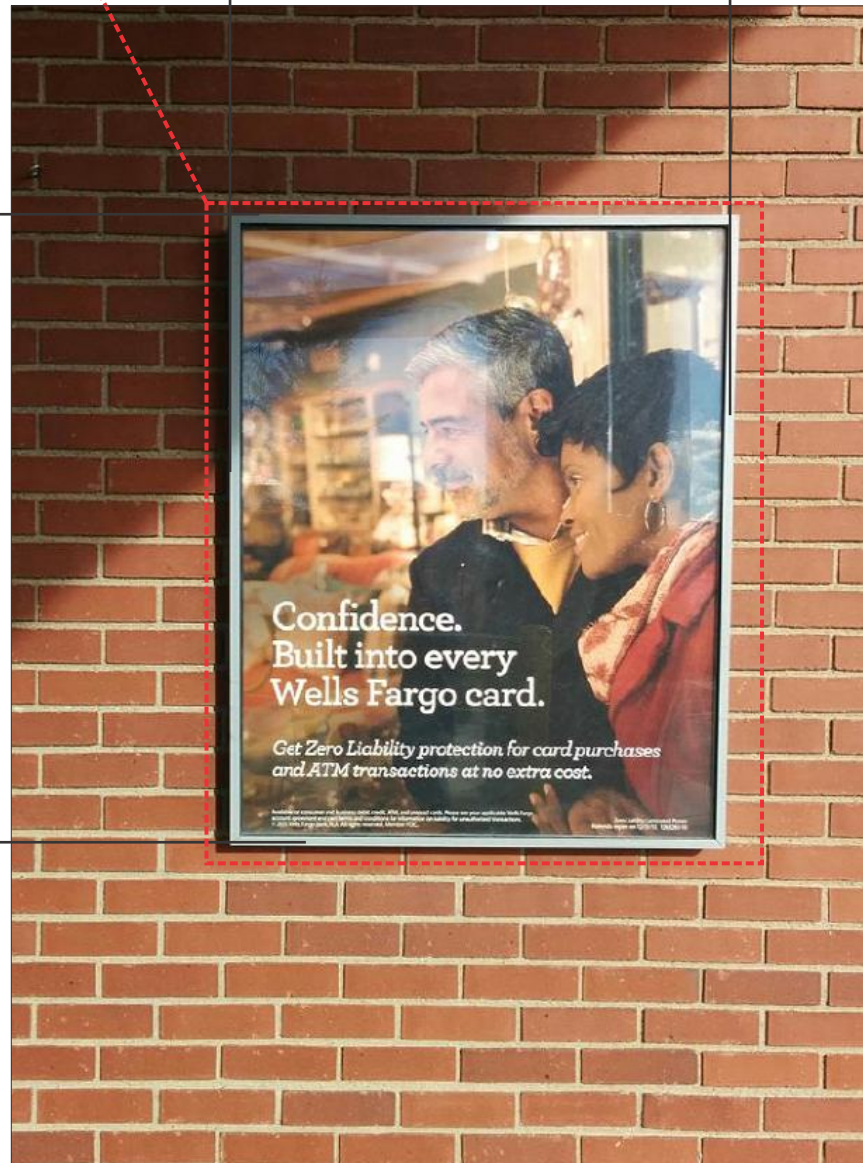

SIGN ELEVATION

SCALE: 1"=1'-0"

E10 EXISTING MARKETING POSTER

REMOVE ONLY

CUSTOM COMMENTS:

**RESTORATION AREA = 12 SQFT PAINTED TO MATCH
 ADD PAINT COLOR HERE**

E10 PROPOSED REMOVE ONLY



Signtech™

4444 Federal Blvd. San Diego CA 92102
 Phone: (619) 527-6100 / Fax: (619) 527-6111
 www.signtechUSA.com



**Wells Fargo
 # 104114**

Ogden Valley
 2487 N HWY 158
 Eden, UT 84310 USA

Initial Date: 12/16/15
 Salesperson: Art Navarro
 Coordinator: Julie L. Horton
 Designer: O Lemus
 Scale: As noted

CUSTOMER APPROVAL

Customer Signature _____ Date _____

COPY, COLORS & SIZES

Signtech does NOT provide primary
 electrical to sign location -
RESPONSIBILITY OF OTHERS!

Customer Signature _____ Date _____

This design is the exclusive property of Signtech
 and cannot be reproduced in whole or in part,
 without their prior written approval.

Drawing Number: 16-00140

Project ID: WELLS FARGO_104114_1



SIGN ELEVATION SCALE: 1/4"=1'-0"

E11 EXISTING HANDICAP SIGN



SIGN ELEVATION SCALE: 1/4"=1'-0"

E11 PROPOSED ADA HANDICAP / VAN ACCESSIBLE

CUSTOM COMMENTS:



Signtech™

4444 Federal Blvd. San Diego CA 92102
Phone: (619) 527-6100 / Fax: (619) 527-6111
www.signtechUSA.com



**Wells Fargo
104114**
Ogden Valley
2487 N HWY 158
Eden, UT 84310 USA

Initial Date: 12/16/15
Salesperson: Art Navarro
Coordinator: Julie L. Horton
Designer: O Lemus
Scale: As noted

CUSTOMER APPROVAL

Customer Signature _____ Date _____

COPY, COLORS & SIZES

Signtech does NOT provide primary electrical to sign location - **RESPONSIBILITY OF OTHERS!**

Customer Signature _____ Date _____

This design is the exclusive property of Signtech and cannot be reproduced in whole or in part, without their prior written approval.

Drawing Number: 16-00140

Project ID: WELLS FARGO_104114_1

R1: revised sign NE02 to CHRWL-15-07 and update new photo-d-12/21/15
 R2: Revisedly update had on sign E03 and to add new NET 2-CR25-A7M-d-03/09/16
 R3: Revised to proposed two options for sign E01 and options for wall sign-d-04/14/16
 R4: revised to go with option one for sign E02-d-04/15/16
 R5: revised to change to gooseneck lamp sign option one and to remove from scope sign NE11-d-06/10/16
 R6: revised sign E01 to remove only, NE02 to be install at new location and discontinue two for sign NE03-d-07/16/16
 R7: revised to update cover page and to show orientation for sign NE02-d-07/26/16

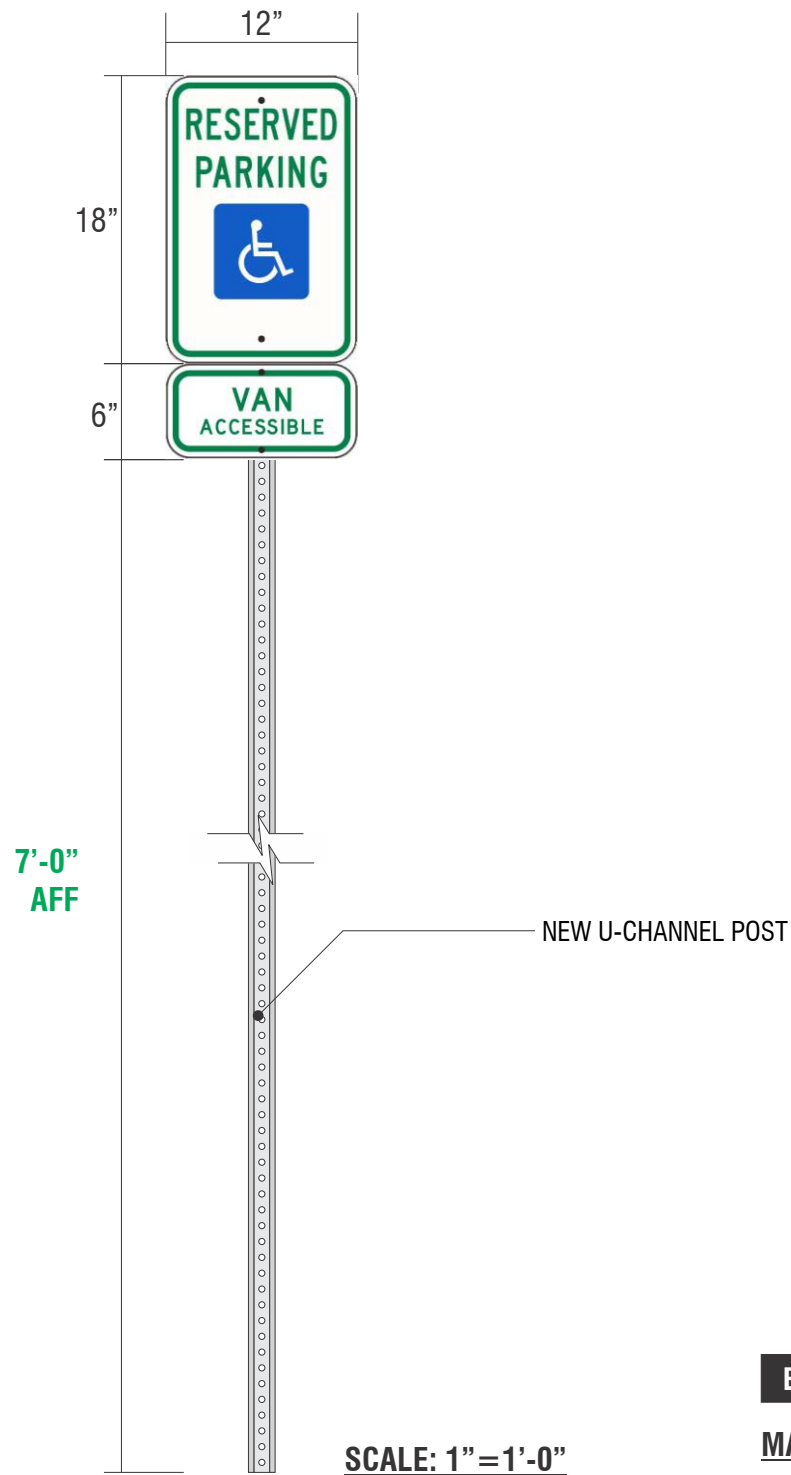

SCALE: 1" = 1'-0"

E11 SIGN TYPE UTAH HANDICAP PARKING SIGN - VAN ACCESSIBLE
MANUFACTURE AND INSTALL ONE (1) HANDICAP SIGN W/ POLE & VAN ACCESSIBLE SIGN



Signtech™

4444 Federal Blvd. San Diego CA 92102
 Phone: (619) 527-6100 / Fax: (619) 527-6111
 www.signtechUSA.com



**Wells Fargo
 # 104114**

Ogden Valley
 2487 N HWY 158
 Eden, UT 84310 USA

Initial Date: 12/16/15
 Salesperson: Art Navarro
 Coordinator: Julie L. Horton
 Designer: O Lemus
 Scale: As noted

CUSTOMER APPROVAL

Customer Signature _____ Date _____

COPY, COLORS & SIZES

Signtech does NOT provide primary electrical to sign location - **RESPONSIBILITY OF OTHERS!**

Customer Signature _____ Date _____

This design is the exclusive property of Signtech and cannot be reproduced in whole or in part, without their prior written approval.

Drawing Number: 16-00140

Project ID: WELLS FARGO_104114_1



SIGN ELEVATION SCALE: 3/16" = 1'-0"

NE12	EXISTING	NONE
-------------	-----------------	-------------

SIGN ELEVATION SCALE: 1/4" = 1'-0"

NE12	PROPOSED	PTSP-ATM-5.375-CUSTOM
-------------	-----------------	------------------------------

CUSTOM COMMENTS:



Signtech™

4444 Federal Blvd. San Diego CA 92102
 Phone: (619) 527-6100 / Fax: (619) 527-6111
 www.signtechUSA.com



Wells Fargo
104114
 Ogden Valley
 2487 N HWY 158
 Eden, UT 84310 USA

Initial Date: 12/16/15
 Salesperson: Art Navarro
 Coordinator: Julie L. Horton
 Designer: O Lemus
 Scale: As noted

CUSTOMER APPROVAL

Customer Signature _____ Date _____
COPY, COLORS & SIZES

Signtech does NOT provide primary
 electrical to sign location -
RESPONSIBILITY OF OTHERS!

Customer Signature _____ Date _____

This design is the exclusive property of Signtech
 and cannot be reproduced in whole or in part,
 without their prior written approval.

Drawing Number: 16-00140
 Project ID: WELLS FARGO_104114_1

R1: revised sign NE02 to CHRWGL-15-07 and update new photo-d-12/1/15
 R2: Revisedly update had on sign E03 and to add new NET 2-CRCHS-ATM-d-03/09/16
 R3: Revised to proposed two options for sign E01 and options for wall sign-d-04/14/16
 R4: revised to go with option one for sign E02-d-04/14/16
 R5: revised to change to gooseneck lamps sign option one and to remove from scope sign NE11-d-06/10/16
 R6: revised sign E01 to remove only, NE02 to be install at new location and distribution two for sign NE03-d-07/18/16
 R7: revised to update cover page and to show orientation for sign NE02-d-07/26/16

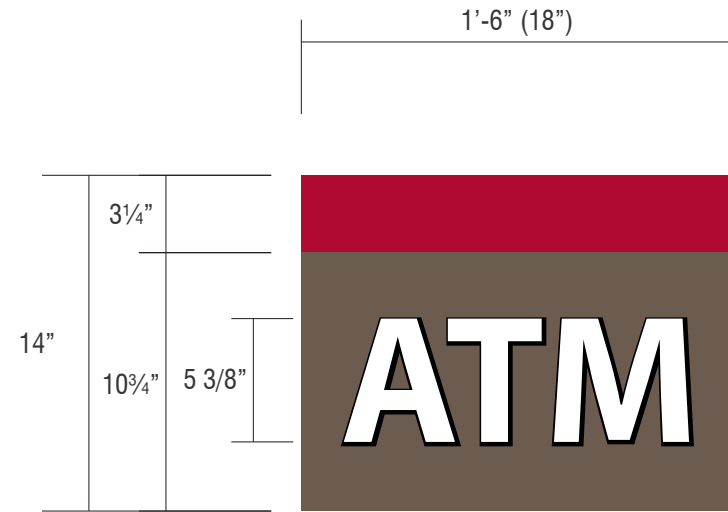

FRONT VIEW SCALE: 1 1/2" = 1'-0"
 SQ FEET: 1.75

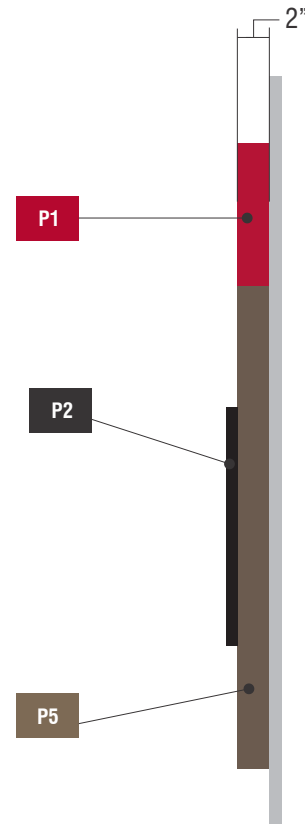

ENDVIEW SCALE: NTS

NE12 SIGNTYPE WF-PTSP-ATM-5.375-CUSTOM
MANUFACTURE AND INSTALL ONE (1) SET OF INTERNALLY ILLUMINATED CABINET WITH PUSH THRU COPY

VINYL

- V1 BLACK VINYL - 3M #3630-22
- V11 DIFFUSER FILM 3M #3635-70
- V23 TRANSLUCENT WHITE VINYL 3M SCOTCHCAL 3630-20

PAINT

- P1 RED WITH CLEARCOAT, SEMI GLOSS MATTHEWS MP65837
- P2 BLACK WITH CLEARCOAT, FULL GLOSS MATTHEWS MP30132
- P5 WARM GRAY WITH CLEARCOAT, SEMI GLOSS MATTHEWS MP20148

SPECIFICATIONS

- 1 HINGE SCREW
- 2 SIGNCOMP#2042
- 3 BRAKE FORMED FACE
- 4 GE TETRA MINIMAX WARM WHITE 4100K (GEMM71-1)
- 5 WALL BUSTER PASS THRU
- 6 CONCRETE FASTENER
- 7 3/4" THICK CLEAR PLEX PUSHED THRU FACE
- 8 SPLICE CONNECTOR
- 9 POWER SUPPLY BOX
- 10 TOGGLE DISCONNECT SWITCH
- 11 U.L. APPROVED LOW VOLTAGE WIRING
- 12 FASCIA MATERIAL - BRICK

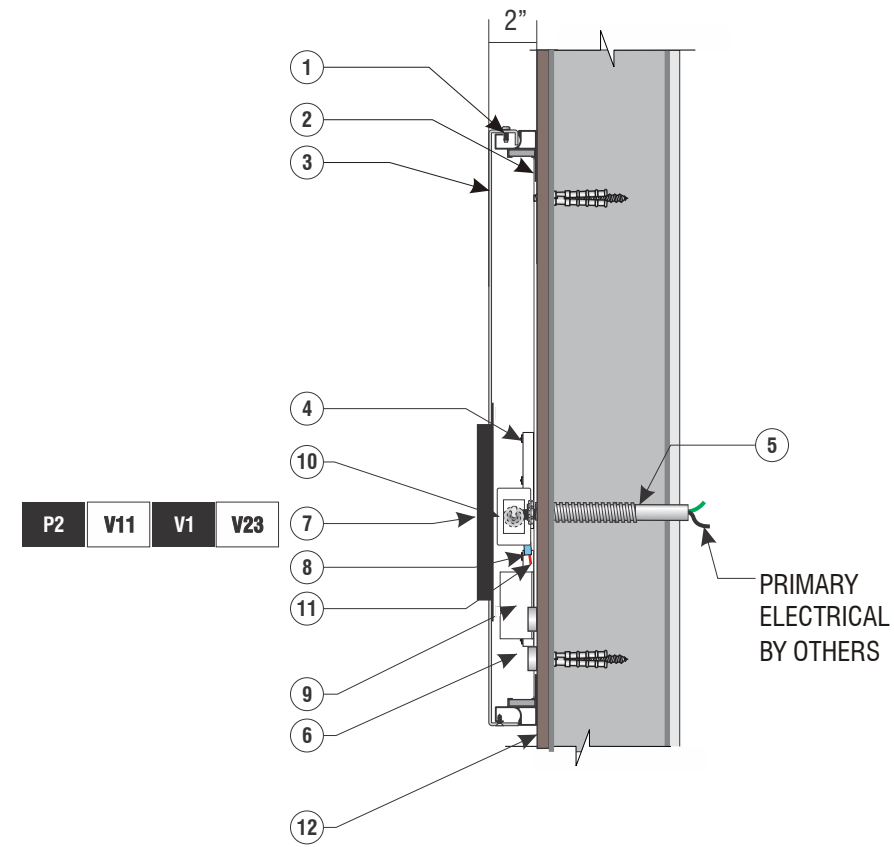

U.L. APPROVED WALL CABINET WITH PUSH THRU COPY
 NOT TO SCALE



Signtech™

4444 Federal Blvd. San Diego CA 92102
 Phone: (619) 527-6100 / Fax: (619) 527-6111
 www.signtechUSA.com



Wells Fargo
104114

Ogden Valley
 2487 N HWY 158
 Eden, UT 84310 USA

Initial Date: 12/16/15
 Salesperson: Art Navarro
 Coordinator: Julie L. Horton
 Designer: O Lemus
 Scale: As noted

CUSTOMER APPROVAL

Customer Signature _____ Date _____

COPY, COLORS & SIZES

Signtech does NOT provide primary electrical to sign location - **RESPONSIBILITY OF OTHERS!**

Customer Signature _____ Date _____

This design is the exclusive property of Signtech and cannot be reproduced in whole or in part, without their prior written approval.

Drawing Number: 16-00140

Project ID: WELLS FARGO_104114_1