

PROPOSED SITE LIGHTING

snowbasin

snowbasin A SUN VALLEY RESORT

PRELIMINARY  
FOR CONSTRUCTION  
DATE:

Paul Sloops Associates  
Architectural Lighting Design & Electrical Engineering

MAIN PARKING LOT  
LIGHTING PLAN &  
PHOTOMETRICS

DATE	2007.01.10
DESIGNED BY	PAUL SLOOPS
CHECKED BY	PAUL SLOOPS
SCALE	AS SHOWN
DATE	03.02.07
PROJECT	
DATE	

L1

Sheet 1 of 2

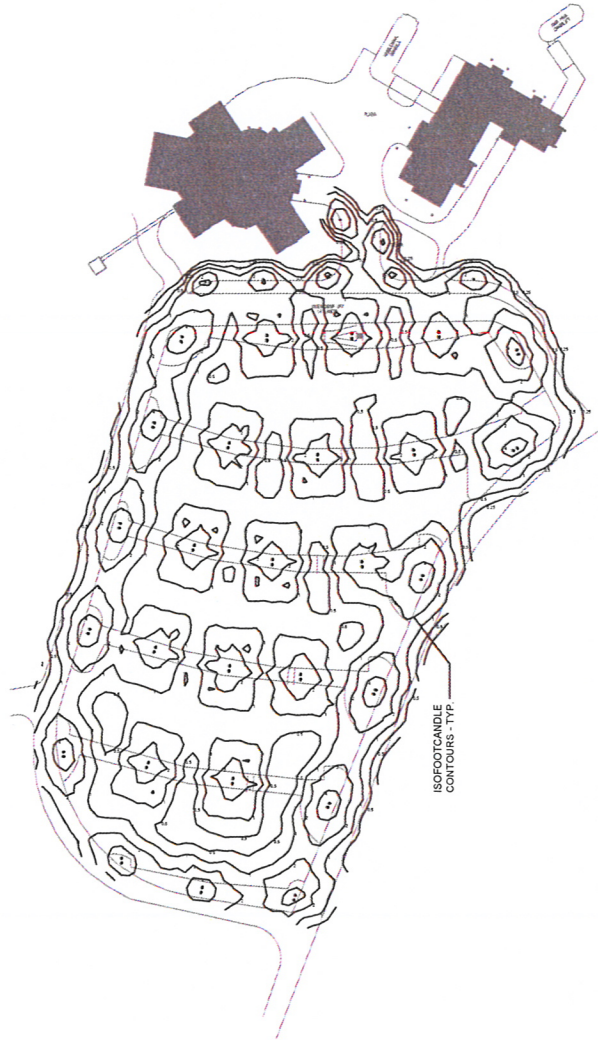
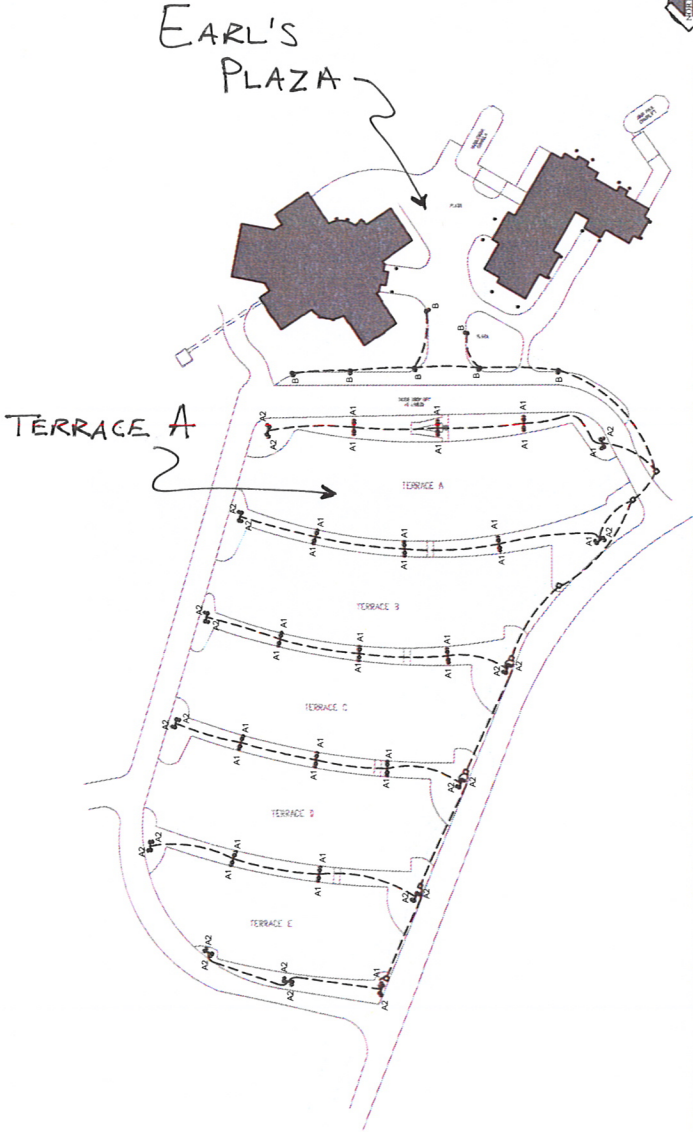
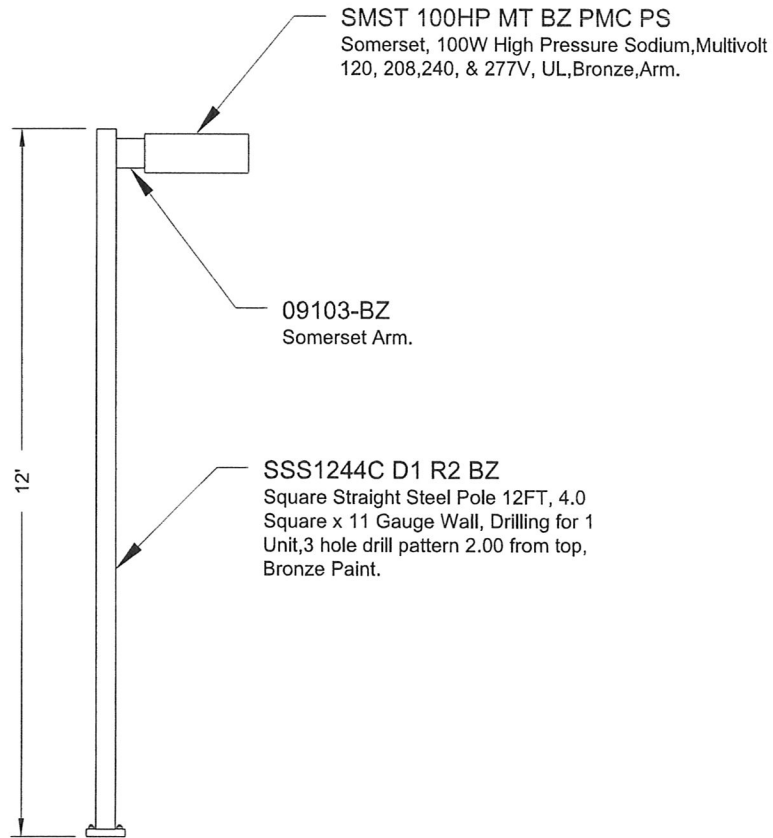

EXHIBIT B



Sinclair Oil

ORDER #:	TYPE:	DRAWING #:
REVISION:	REVISION DATE:	TSG 006292
DRAWN: BGW	ORIGIN DATE: 5/10/11	PAGE: 1 of 2

THIS DRAWING, WHEN APPROVED, SHALL BECOME THE COMPLETE SPECIFICATION FOR THE MATERIAL TO BE FURNISHED BY HOLOPHANE ON THE ORDER NOTED ABOVE. A UNIT OF SIMILAR DESIGN MAY BE SUPPLIED, BUT ONLY AFTER APPROVAL BY THE CUSTOMER IN WRITING. ON POLE ORDERS AN ANCHOR BOLT TEMPLATE PRINT WILL BE SUPPLIED WITH EACH ANCHOR BOLT ORDER TO MATCH THE POLE PROVIDED. THIS PRINT IS THE PROPERTY OF HOLOPHANE AND IS LOANED SUBJECT TO RETURN UPON DEMAND AND UPON EXPRESS CONDITION THAT IT WILL NOT BE USED DIRECTLY OR INDIRECTLY IN ANY WAY DETRIMENTAL TO OUR INTERESTS, AND ONLY IN CONNECTION WITH MATERIAL FURNISHED BY HOLOPHANE.

EXHIBIT C

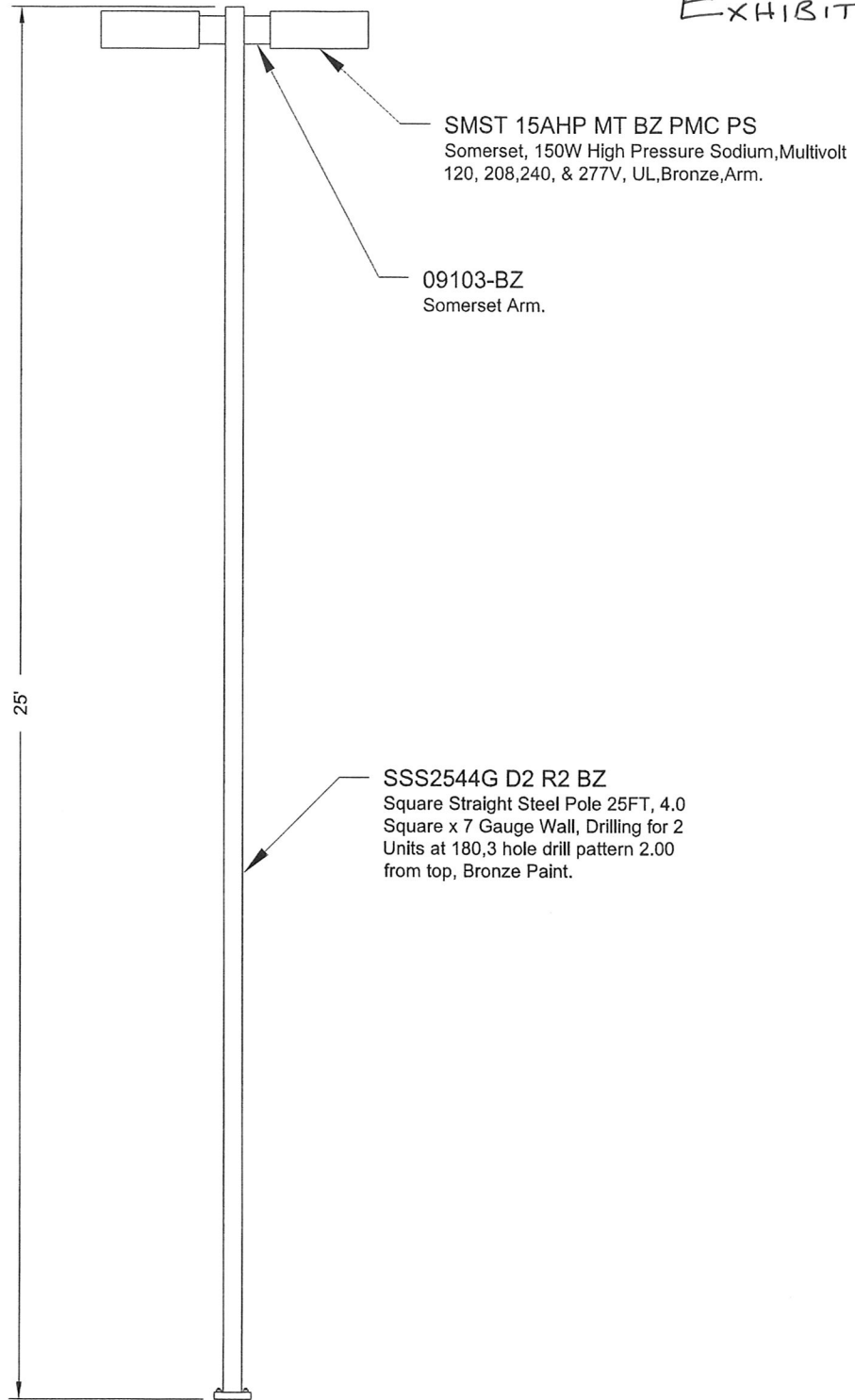

## Sinclair Oil

ORDER #:	TYPE:	DRAWING #:
REVISION:	REVISION DATE:	TSG 006292
DRAWN: BGW	ORIGIN DATE: 5/10/11	PAGE: 2 of 2

THIS DRAWING, WHEN APPROVED, SHALL BECOME THE COMPLETE SPECIFICATION FOR THE MATERIAL TO BE FURNISHED BY HOLOPHANE ON THE ORDER NOTED ABOVE. A UNIT OF SIMILAR DESIGN MAY BE SUPPLIED, BUT ONLY AFTER APPROVAL BY THE CUSTOMER IN WRITING. ON POLE ORDERS AN ANCHOR BOLT TEMPLATE PRINT WILL BE SUPPLIED WITH EACH ANCHOR BOLT ORDER TO MATCH THE POLE PROVIDED. THIS PRINT IS THE PROPERTY OF HOLOPHANE AND IS LOANED SUBJECT TO RETURN UPON DEMAND AND UPON EXPRESS CONDITION THAT IT WILL NOT BE USED DIRECTLY OR INDIRECTLY IN ANY WAY DETRIMENTAL TO OUR INTERESTS, AND ONLY IN CONNECTION WITH MATERIAL FURNISHED BY HOLOPHANE.

# ORDERING INFORMATION

## DIMENSIONAL DETAILS

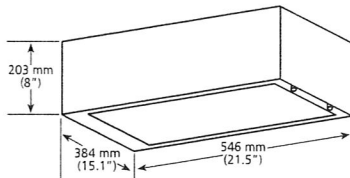
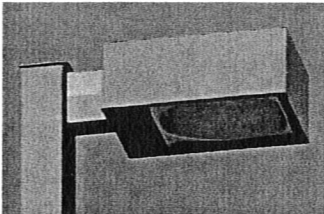

**Maximum Weight:** 16 kg. (36 lbs.)  
**Maximum EPA:** 1.43

## PERFORMANCE SPECIFICATIONS

Luminaire shall be Holophane Somerset series, catalog No. SMST \_\_\_\_\_. This fixture shall consist of mounting, optical, support, and electrical systems and will provide certain performance characteristics as follow:

The luminaire shall consist of a formed 1.3mm (18 ga.) aluminum housing with cast aluminum door frame bottom enclosure to hold prismatic lens or flat tempered glass.

All exposed surfaces shall receive a seven stage cleaning and pretreatment prior to painting. The finish shall be a fade resistant (color) polyester powder paint baked on to provide a hard durable coating.

Reflector shall be hydro-formed aluminum alloy #3002 reflector sheet, chemically brightened and anodized.

Mounting bolts, washers and nuts shall be zinc-plated steel. Electrical components (ballast, capacitor, fuses, starter board, etc.) shall be mounted to a single removable galvanized steel plate.

Socket wires shall have plug-in disconnect. Complete electrical assembly shall be removable by unplugging socket leads and primary leads and disengaging one quarter-turn faster.

Ballast area and door shall be fully gasketed with high-temperature, closed cell material.

The complete unit shall be UL listed "Suitable for Wet Locations" and CSA certified.

## DISTRIBUTIONS

### Forward Throw

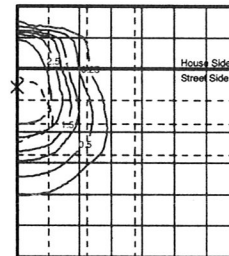

### Type III

