

Date: 8/13/2015



Planning Commission Land Use Permit

Page 1 of 2

Printed: 8/13/2015

Permit Number: LUP196-2015

Applicant

Name: Alan Heiner
Address: 3531 West 5000 South
Phone: 8019854873

Owner

Name:
Address:
Phone:

Parcel

Parcel Number: 092000006
Total Parcel Area: 15000
Address: 3515 W 5000 South

Zoning: RE-15
(*If Zoned S-1, See Specific Height Requirements)

****See Diagram on Back Side for Setbacks**

Section: 16 **Township:** 5N **Range:** 2W

Subdivision: Country Meadows Subdivision **Lot(s):** 15

Proposed Structure: New Outbuilding and Deck **Structure Area Used:** 196

Is Structure > 1,000 Sq. Ft.? *If True, Need Certif. Statement

of Dwelling Units: 1 **# of Accessory Bldgs:** 1 **# Off-Street Parking Req'd:** 2



Permit Checklist:

Public by/Right of Use Road?			
> 200 ft. from Paved Road?	<u>No</u>	Wetlands/Flood Zone?	<u>No</u>
< 4218 ft. above Sea Level?		If Yes, Culvert Size:	
Culvert Required?	<u>No</u>		
*Any Work in the Right of Way requires an Excavation Permit			
Additional Frontage Req'd.?	<u>No</u>	OR Special Exception?	Case #
Meet Zone Area & Frontage?		Hillside Review Req'd.?	Case #
Culinary Water District:	<u>Other</u>	Waste Water System:	<u>Other</u>

Comments: new 192 sq. ft. shed

Structure Setback Graphic: Storage Shed, Detached Garage,et

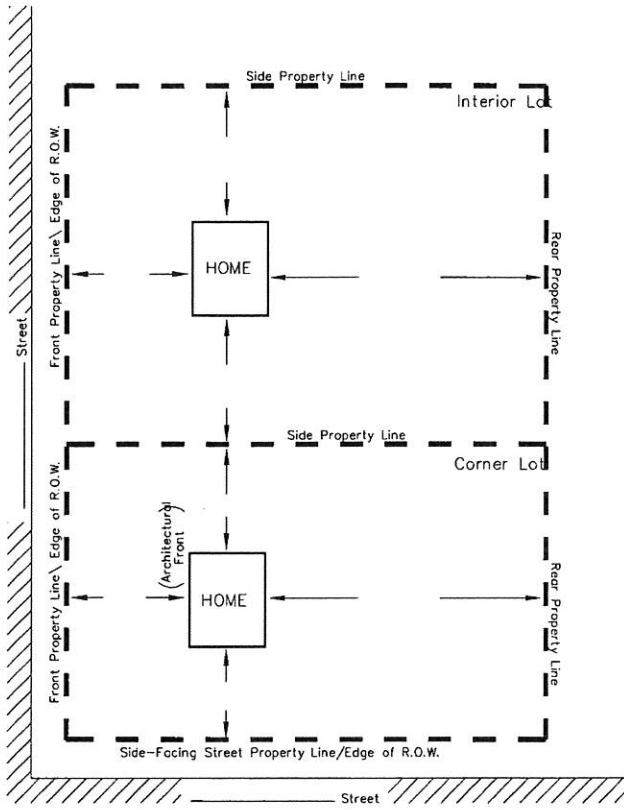

MINIMUM YARD SETBACKS
New Dwelling, Addition, Etc.

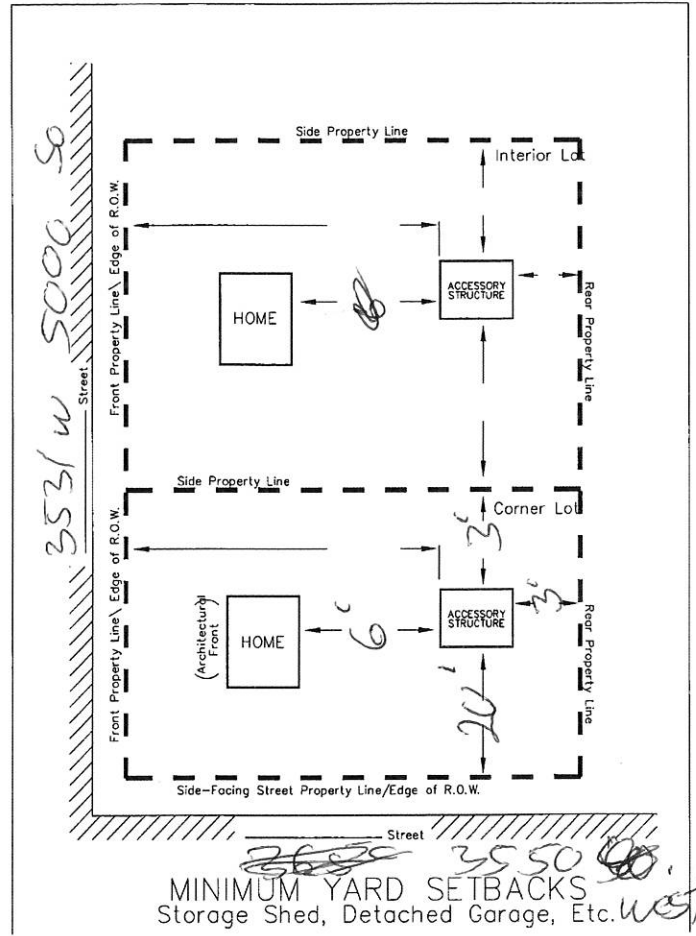

MINIMUM YARD SETBACKS
Storage Shed, Detached Garage, Etc. (w/ST)

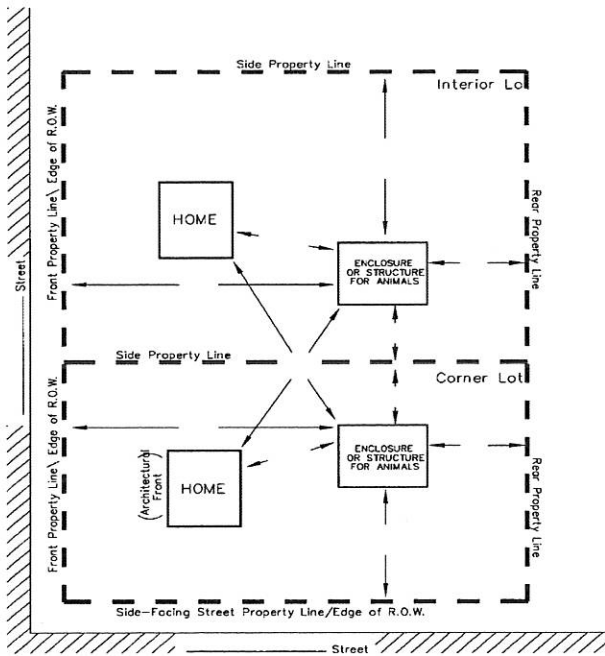

MINIMUM YARD SETBACKS
Barn, Corral, or Stable

NOTICE FOR APPLICANT (Please Read Before Signing)

Proposals for the installation of an individual water supply and for a sanitary waste disposal system (septic tank) for any structure designed for human occupation must be approved by the Weber County Health Department prior to installation.

Jim Perry 8-13-15
 Planning Dept. Signature of Approval Date

This permit becomes null and void if use or construction authorized has not commenced within 180 days or if there is a zone change affecting this property. I hereby certify that I have read and examined this application and know the same to be true and correct. All provisions of laws and ordinances governing this land use will be complied with whether specified herein or not. I make this statement under penalty of perjury. I hereby agree to make the requirements as specified on this permit issued to the owner of land as signed below.

Alan C. Heiner 8-13-15
 Contractor/Owner Signature of Approval Date

01.0

R=30'

30'

L=52.14'

2.97'

L=64.82'

3531 W

Existing House

L=115.21'

ALAN C HEINER
& WF BRENDA F
092000006
15,710 SQ. FT.

NORTH

150.00'

2019854873

33'

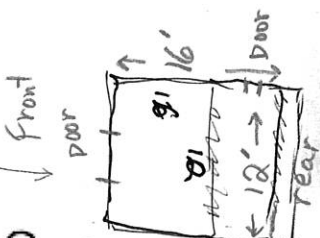

15

110.15'

N 79° 40' W

11.65'

SEE PAGE 199

12x16 TRADITIONAL VICTORIAN SHED FLOOR PLAN

