

BOYD RUSSELL SUBDIVISION 1ST AMENDMENT

PART OF THE NORTHWEST QUARTER OF SECTION 28, T.6N., R.2W., S.L.B & M., U.S. SURVEY
WEBER COUNTY, UTAH
JANUARY, 2016



Vicinity Map
SCALE: NONE

A. JAY SMITH = 4.21%
15-078-0110

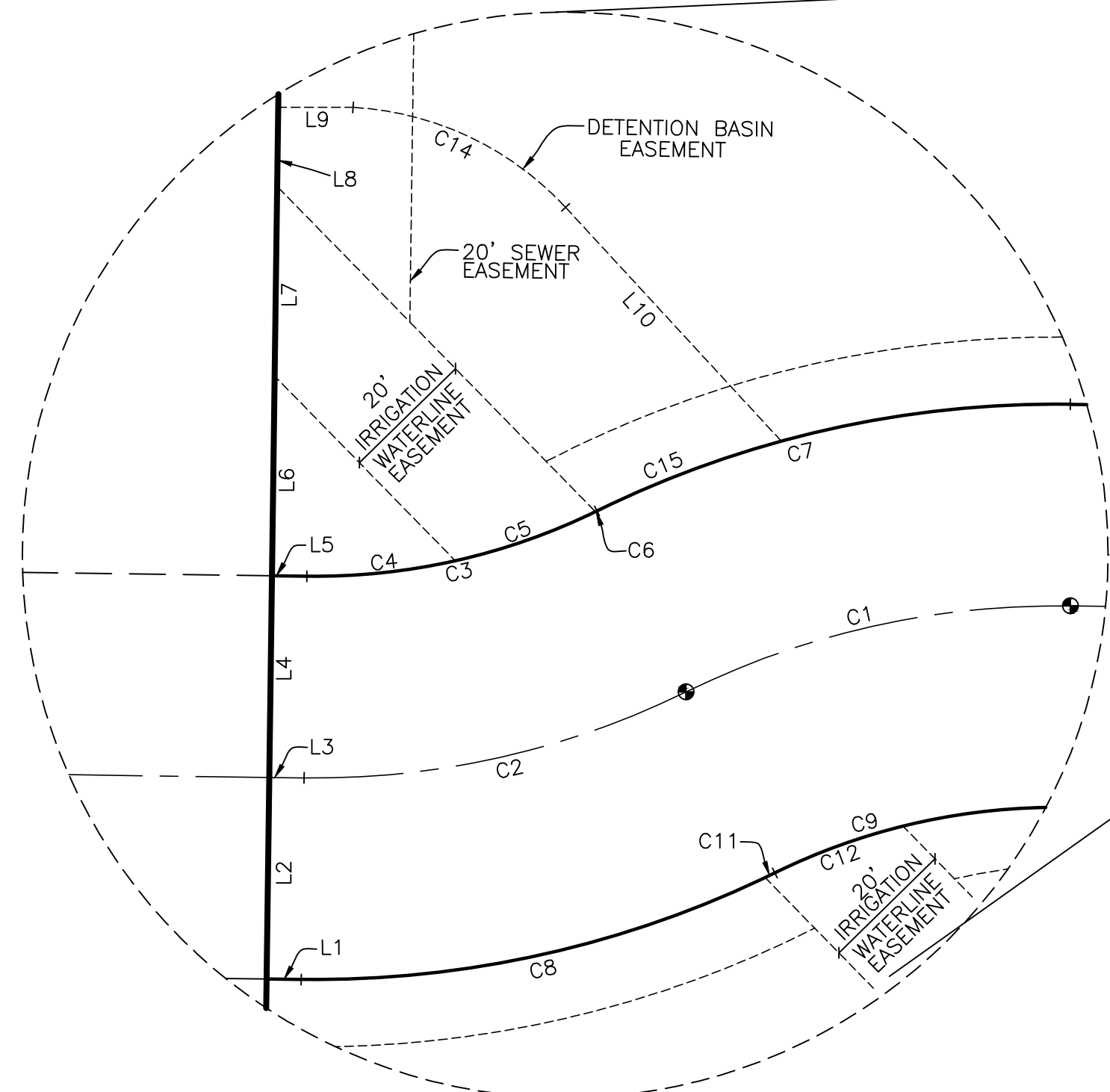

CURVE TABLE

#	RADIUS	ARC LENGTH	CHD. LENGTH	TANGENT	CHD BEARING	DELTA
C1	125.00'	58.75'	58.21'	29.93'	S77°18'16"W	26°55'44"
C2	125.00'	58.78'	58.24'	29.95'	N77°18'43"E	26°56'38"
C3	95.00'	44.67'	44.26'	22.76'	N77°18'43"E	26°56'38"
C4	95.00'	22.27'	22.22'	11.19'	S84°04'02"W	13°26'01"
C5	95.00'	22.13'	22.08'	11.11'	S70°40'41"W	13°20'40"
C6	95.00'	0.27'	0.27'	0.14'	S63°55'23"W	0°09'57"
C7	155.00'	72.85'	72.18'	37.11'	N77°18'16"E	26°55'44"
C8	155.00'	72.89'	72.22'	37.13'	S77°18'43"E	26°56'38"
C9	95.00'	44.65'	44.24'	22.75'	S77°18'16"E	26°55'44"
C10	155.01'	71.30'	70.67'	36.29'	N77°36'24"E	26°21'11"
C11	142.80'	1.59'	1.59'	0.80'	N64°08'05"E	0°38'22"
C12	95.00'	20.33'	20.29'	10.20'	N69°58'16"E	12°15'43"
C13	95.00'	24.32'	24.25'	12.23'	S83°26'08"W	14°40'00"
C14	46.67'	35.81'	34.94'	18.84'	S64°47'33"E	43°58'03"
C15	155.00'	29.39'	29.35'	14.74'	S69°16'21"W	10°51'53"

LINE TABLE

LINE	BEARING	DISTANCE
L1	S89°12'58"E	5.16'
L2	N00°46'08"E	30.00'
L3	N89°12'58"W	5.17'
L4	N00°46'08"E	30.00'
L5	S89°12'58"E	5.18'
L6	S00°46'08"W	29.71'
L7	N00°46'08"E	28.22'
L8	N00°46'08"E	11.81'
L9	EAST	11.14'
L10	N42°41'47"W	47.37'

NOTES:
1. NO BASEMENTS ARE ALLOWED DUE TO HIGH GROUND WATER, UNLESS AN APPROVED OUTLET CAN BE ESTABLISHED WITH THE COUNTY ENGINEER.

WEST QUARTER CORNER OF SECTION 28, TOWNSHIP 6 NORTH, RANGE 2 WEST, SALT LAKE BASE & MERIDIAN. 2004 WEBER COUNTY BRASS CAP MONUMENT IN GOOD CONDITION

EAST QUARTER CORNER OF SECTION 28, TOWNSHIP 6 NORTH, RANGE 2 WEST, SALT LAKE BASE & MERIDIAN. FOUND 1963 BRASS CAP MONUMENT IN GOOD CONDITION

Developer:

Gabbard Homes
Lonnib Gabbard
4052 S. 5025 W.
West Haven, UT. 84401
(801) 390-1050

LEGEND

- = FOUND SECTION CORNER
- = SET 5/8" X 24" REBAR AND PLASTIC CAP STAMPED "REEVE & ASSOCIATES"
- = SET CENTERLINE MONUMENT
- = BOUNDARY LINE
- = LOT LINE
- = ADJOINING PROPERTY
- = EASEMENTS
- = SECTION TIE LINE
- = EXISTING BUILDING
- = P.U.E. = PUBLIC UTILITY EASEMENT

BASIS OF BEARINGS

THE BASIS OF BEARINGS FOR THIS PLAT IS THE SECTION LINE BETWEEN THE FOUND BRASS CAP MONUMENTS AT THE WEST QUARTER CORNER AND THE EAST QUARTER CORNER OF SECTION 28, TOWNSHIP 6 NORTH, RANGE 2 WEST SALT LAKE BASE & MERIDIAN, U.S. SURVEY. SHOWN HEREON AS: S89°13'14"E.

NARRATIVE

THE PURPOSE OF THIS PLAT IS TO DIVIDE THE BELOW DESCRIBED PROPERTY INTO LOTS AND STREETS AS SHOWN. THE BOUNDARY WAS DETERMINED BY RETRACING LOTS 1 AND 2 OF BOYD RUSSELL SUBDIVISION AS RECORDED IN THE OFFICE OF THE WEBER COUNTY RECORDER AT BOOK 54, PAGE 50. ALL BOUNDARY AND REAR LOT CORNERS WERE SET WITH A 5/8" X 24" REBAR AND PLASTIC CAP STAMPED "REEVE & ASSOCIATES". ALL FRONT LOT CORNERS WERE SET WITH A LEAD PLUG IN THE TOP BACK OF CURB AT THE EXTENSION OF THE SIDE LOT LINES.

BOUNDARY DESCRIPTION

A PART OF THE NORTHWEST QUARTER OF SECTION 28, TOWNSHIP 6 NORTH, RANGE 2 WEST, SALT LAKE BASE AND MERIDIAN, U.S. SURVEY, DESCRIBED AS FOLLOWS:
ALL OF THE BOYD RUSSELL SUBDIVISION, ACCORDING TO THE OFFICIAL PLAT THEREOF RECORDED AND OF RECORD IN THE OFFICE OF THE WEBER COUNTY RECORDER AT BOOK 54 PAGE 50, MORE PARTICULARLY DESCRIBED AS FOLLOWS:
BEGINNING AT A POINT ON THE NORTH RIGHT-OF-WAY LINE OF 2200 SOUTH STREET, SAID POINT BEING S89°13'14"E 2224.07 FEET AND N00°46'46"E 33.00 FEET FROM THE WEST QUARTER CORNER OF SAID SECTION 28 AND RUNNING THENCE N89°13'14"W ALONG SAID RIGHT-OF-WAY 300.00 FEET; THENCE N00°46'08"E 968.00 FEET; THENCE S89°13'14"E 300.00 FEET; THENCE S00°46'08"W 968.00 FEET TO THE SAID RIGHT-OF-WAY OF 2200 SOUTH STREET AND TO THE POINT OF BEGINNING.

CONTAINING 290,400 SQUARE FEET OR 6.67 ACRES.

AGRICULTURE NOTE

AGRICULTURE IS THE PREFERRED USE IN THE AGRICULTURE ZONES. AGRICULTURAL OPERATIONS AS SPECIFIED IN THE LAND USE CODE FOR A PARTICULAR ZONE ARE PERMITTED AT ANY TIME INCLUDING THE OPERATION OF FARM MACHINERY AND NO ALLOWED AGRICULTURAL USE SHALL BE SUBJECT TO RESTRICTIONS ON BASIS THAT IT INTERFERES WITH ACTIVITIES OF FUTURE RESIDENTS OF THIS SUBDIVISION

SURVEYOR'S CERTIFICATE

I, TREVOR J. HATCH, DO HEREBY CERTIFY THAT I AM A PROFESSIONAL LAND SURVEYOR IN THE STATE OF UTAH IN ACCORDANCE WITH TITLE 58, CHAPTER 22, PROFESSIONAL ENGINEERS AND LAND SURVEYORS ACT; AND THAT I HAVE COMPLETED A SURVEY OF THE PROPERTY DESCRIBED ON THIS PLAT IN ACCORDANCE WITH SECTION 17-23-17 AND HAVE VERIFIED ALL MEASUREMENTS, AND HAVE PLACED MONUMENTS AS REPRESENTED ON THIS PLAT, AND THAT THIS PLAT OF RUSSELL PLACE SUBDIVISION IN WEBER COUNTY, UTAH, HAS BEEN DRAWN CORRECTLY TO THE DESIGNATED SCALE AND IS A TRUE AND CORRECT REPRESENTATION OF THE HEREIN DESCRIBED LANDS INCLUDED IN SAID SUBDIVISION, BASED UPON DATA COMPILED FROM RECORDS IN THE WEBER COUNTY RECORDER'S OFFICE AND FROM SAID SURVEY MADE BY ME ON THE GROUND. I FURTHER CERTIFY THAT THE REQUIREMENTS OF ALL APPLICABLE STATUTES AND ORDINANCES OF WEBER COUNTY CONCERNING ZONING REQUIREMENTS REGARDING LOT MEASUREMENTS HAVE BEEN COMPLIED WITH.

SIGNED THIS _____ DAY OF _____, 20____

9031945

UTAH LICENSE NUMBER

TREVOR J. HATCH

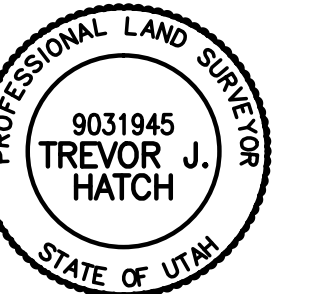

OWNERS DEDICATION AND CERTIFICATION

WE THE UNDERSIGNED OWNERS OF THE HEREIN DESCRIBED TRACT OF LAND, DO HEREBY SET APART AND SUBDIVIDE THE SAME INTO LOTS AND STREETS AS SHOWN ON THE PLAT AND NAME SAID TRACT RUSSELL PLACE SUBDIVISION, AND DO HEREBY DEDICATE TO PUBLIC USE ALL THOSE PARTS OR PORTIONS OF SAID TRACT OF LAND DESIGNATED AS STREETS, THE SAME TO BE USED AS PUBLIC THOROUGHFARES AND ALSO TO GRANT AND DEDICATE A PERPETUAL RIGHT AND EASEMENT OVER, UPON AND UNDER THE LANDS DESIGNATED HEREON AS PUBLIC UTILITY, SANITARY SEWER, STORM WATER DETENTION PONDS DRAINAGE EASEMENTS AND CANAL MAINTENANCE EASEMENT, THE SAME TO BE USED FOR THE INSTALLATION MAINTENANCE AND OPERATION OF PUBLIC UTILITY SERVICE LINE, STORM DRAINAGE FACILITIES, IRRIGATION CANALS OR FOR THE PERPETUAL PRESERVATION OF WATER CHANNELS IN THEIR NATURAL STATE WHICH EVER IS APPLICABLE AS MAY BE AUTHORIZED BY THE GOVERNING AUTHORITY, WITH NO BUILDINGS OR STRUCTURES BEING ERRECTED WITHIN SUCH EASEMENTS AND TO HEREBY GRANT A TEMPORARY TURNAROUND EASEMENT AS SHOWN HEREON TO BE USED BY THE PUBLIC UNTIL SUCH TIME THAT THE ROAD IS EXTENDED. THE TEMPORARY TURNAROUND EASEMENT SHALL BE REVOKED AND NULLIFIED AT THE EVENT OF THE EXTENSION OF THE ROAD WITHOUT FURTHER WRITTEN DOCUMENT AND THE ENCUMBERED LAND WITHIN THE AFFECTED LOTS SHALL BE RELEASED FOR THE FULL AND EXCLUSIVE USE AND BENEFIT OF THE LOT OWNERS.

SIGNED THIS _____ DAY OF _____, 20____

DUSTEN RUSSELL

ALLYSON M RUSSELL

DERK L RUSSELL

ACKNOWLEDGMENT

STATE OF UTAH)
COUNTY OF _____) ss.

ON THE _____ DAY OF _____, 20____, PERSONALLY APPEARED BEFORE ME, THE UNDERSIGNED NOTARY PUBLIC, _____ (AND) _____ SIGNED(S) OF THE ABOVE OWNER'S DEDICATION AND CERTIFICATION, WHO BEING BY ME DULY SWORN, DID ACKNOWLEDGE TO ME _____ SIGNED IT FREELY, VOLUNTARILY, AND FOR THE PURPOSES THEREIN MENTIONED.

COMMISSION EXPIRES _____

NOTARY PUBLIC

ACKNOWLEDGMENT

STATE OF UTAH)
COUNTY OF _____) ss.

ON THE _____ DAY OF _____, 20____, PERSONALLY APPEARED BEFORE ME, THE UNDERSIGNED NOTARY PUBLIC, _____ (AND) _____ BEING BY ME DULY SWORN, ACKNOWLEDGED TO ME THEY ARE _____ AND _____ OF SAID CORPORATION AND THAT THEY SIGNED THE ABOVE OWNER'S DEDICATION AND CERTIFICATION FREELY, VOLUNTARILY, AND IN BEHALF OF SAID CORPORATION FOR THE PURPOSES THEREIN MENTIONED.

COMMISSION EXPIRES _____

NOTARY PUBLIC

Project Info.

Surveyor: T. HATCH
Designer: E. ROCHE
Begin Date: 9-22-15
Name: RUSSELL PLACE SUBDIVISION
Number: 6554-01
Revision: 1-12-16 E.R.
Scale: 1"=60'
Checked:



920 CHAMBERS STREET, SUITE 14, OGDEN, UTAH 84403
TEL: (801) 621-3100 FAX: (801) 621-2666 www.reeve-assoc.com

WEBER COUNTY PLANNING COMMISSION APPROVAL

THIS IS TO CERTIFY THAT THIS SUBDIVISION PLAT WAS DULY APPROVED BY THE WEBER COUNTY PLANNING COMMISSION. SIGNED THIS _____ DAY OF _____, 20____

CHAIRMAN, WEBER COUNTY PLANNING COMMISSION

WEBER COUNTY ENGINEER

I HEREBY CERTIFY THAT THE REQUIRED PUBLIC IMPROVEMENT STANDARDS AND DRAWINGS FOR THIS SUBDIVISION CONFORM WITH THE COUNTY STANDARDS AND THE AMOUNT OF THE FINANCIAL GUARANTEE IS SUFFICIENT FOR THE INSTALLATION OF THESE IMPROVEMENTS. SIGNED THIS _____ DAY OF _____, 20____

WEBER COUNTY ENGINEER

WEBER COUNTY COMMISSION ACCEPTANCE

THIS IS TO CERTIFY THAT THIS SUBDIVISION PLAT, THE DEDICATION OF STREETS AND OTHER PUBLIC WORKS AND FINANCIAL GUARANTEE OF PUBLIC IMPROVEMENTS ASSOCIATED WITH THIS SUBDIVISION, THEREON ARE HEREBY APPROVED AND ACCEPTED BY THE COMMISSIONERS OF WEBER COUNTY, UTAH. SIGNED THIS _____ DAY OF _____, 20____

CHAIRMAN, WEBER COUNTY COMMISSION

ATTEST

TITLE

WEBER COUNTY SURVEYOR

I HEREBY CERTIFY THAT THE WEBER COUNTY SURVEYOR'S OFFICE HAS REVIEWED THIS PLAT FOR MATHEMATICAL CORRECTNESS, SECTION CORNER DATA, AND FOR HARMONY WITH LINES AND MONUMENTS ON RECORD IN THE COUNTY OFFICES. THE APPROVAL OF THIS PLAT BY THE WEBER COUNTY SURVEYOR DOES NOT RELIEVE THE LICENSED LAND SURVEYOR WHO EXECUTED THIS PLAT FROM THE RESPONSIBILITIES AND/OR LIABILITIES ASSOCIATED THEREWITH. SIGNED THIS _____ DAY OF _____, 20____

WEBER COUNTY SURVEYOR

WEBER COUNTY ATTORNEY

I HAVE EXAMINED THE FINANCIAL GUARANTEE AND OTHER DOCUMENTS ASSOCIATED WITH THIS SUBDIVISION PLAT, AND IN MY OPINION THEY CONFORM WITH THE COUNTY ORDINANCE APPLICABLE THERETO AND NOW IN FORCE AND EFFECT. SIGNED THIS _____ DAY OF _____, 20____

WEBER COUNTY ATTORNEY

WEBER-MORGAN HEALTH DEPARTMENT

I HEREBY CERTIFY THAT THE SOILS, PERCOLATION RATES, AND SITE CONDITIONS FOR THIS SUBDIVISION HAVE BEEN INVESTIGATED BY THIS OFFICE AND ARE APPROVED FOR ON-SITE WASTEWATER DISPOSAL SYSTEMS. SIGNED THIS _____ DAY OF _____, 20____

DIRECTOR, WEBER-MORGAN HEALTH DEPARTMENT

Weber County Recorder

Entry No. _____ Fee Paid _____
Filed For Record _____
And Recorded _____
At _____ in Book _____
Of The Official Records, Page _____
Recorded For: _____
Weber County Recorder _____
Deputy _____