

**Swale Detail**  
SCALE: NONE

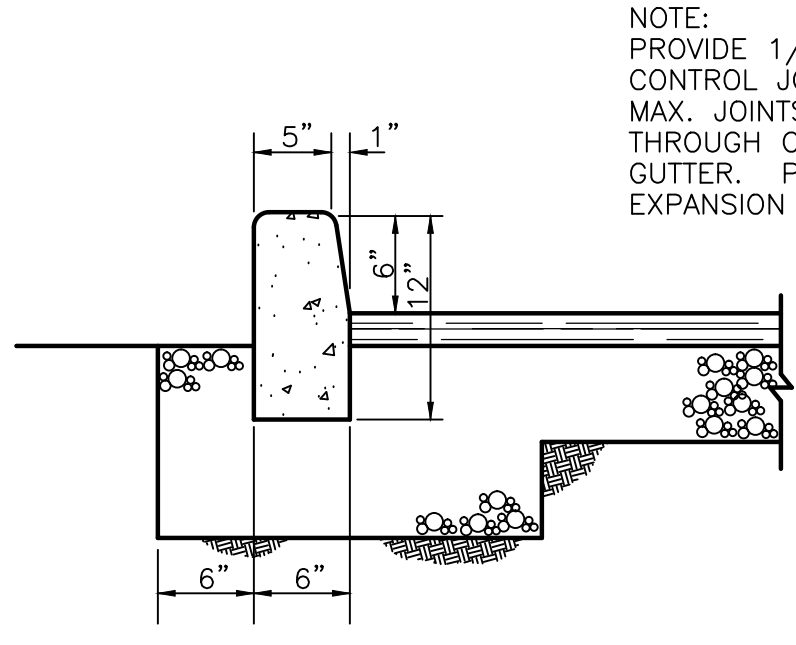

**Curb Detail**  
SCALE: NONE

NOTE:  
PROVIDE 1/8" x 1" DEEP CONTROL JOINTS AT 8" O.C. MAX. JOINTS TO CONTINUE THROUGH CONC. OR CURB & GUTTER. PROVIDE 1/2" EXPANSION JOINTS AT 30' O.C.

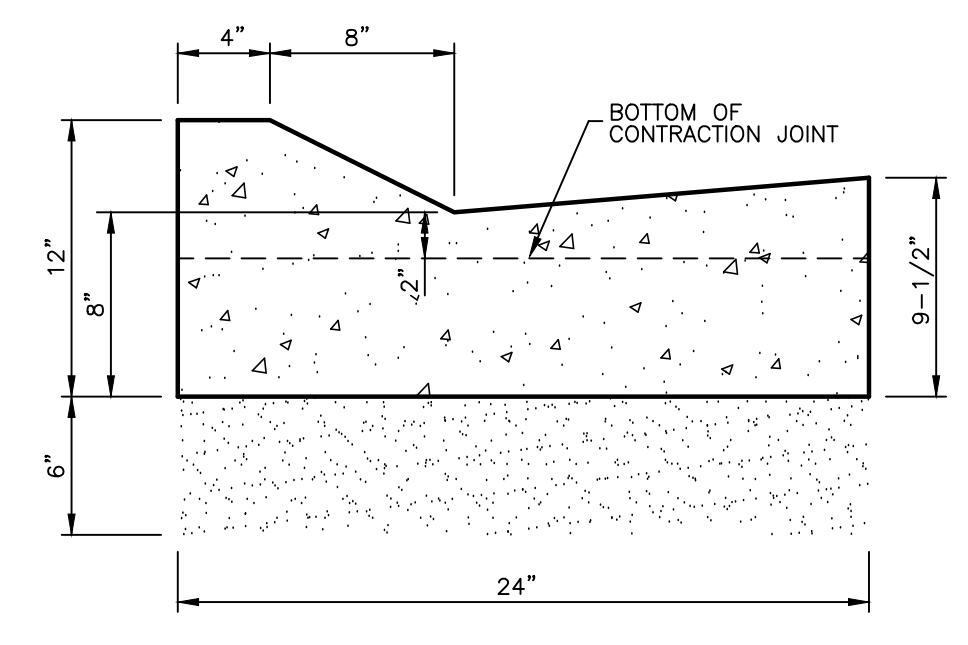

**On-Site Type 'F' Curb & Gutter**  
SCALE: NONE

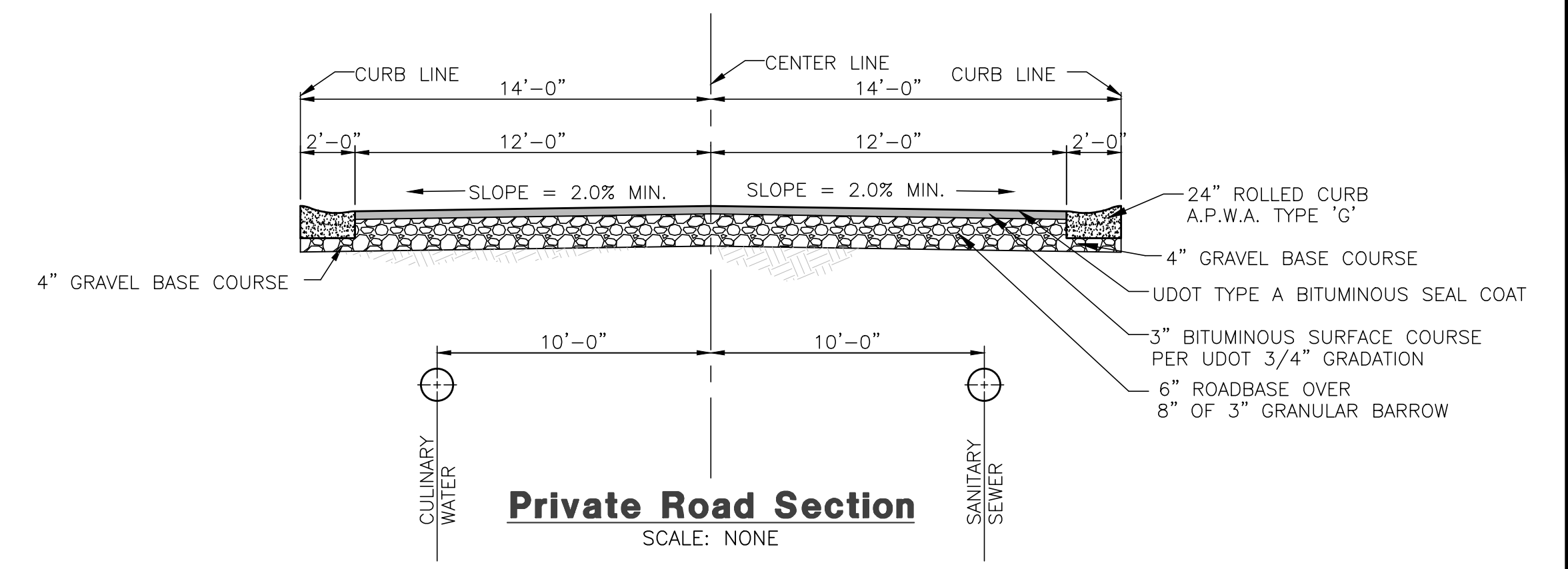

**Private Road Section**  
SCALE: NONE

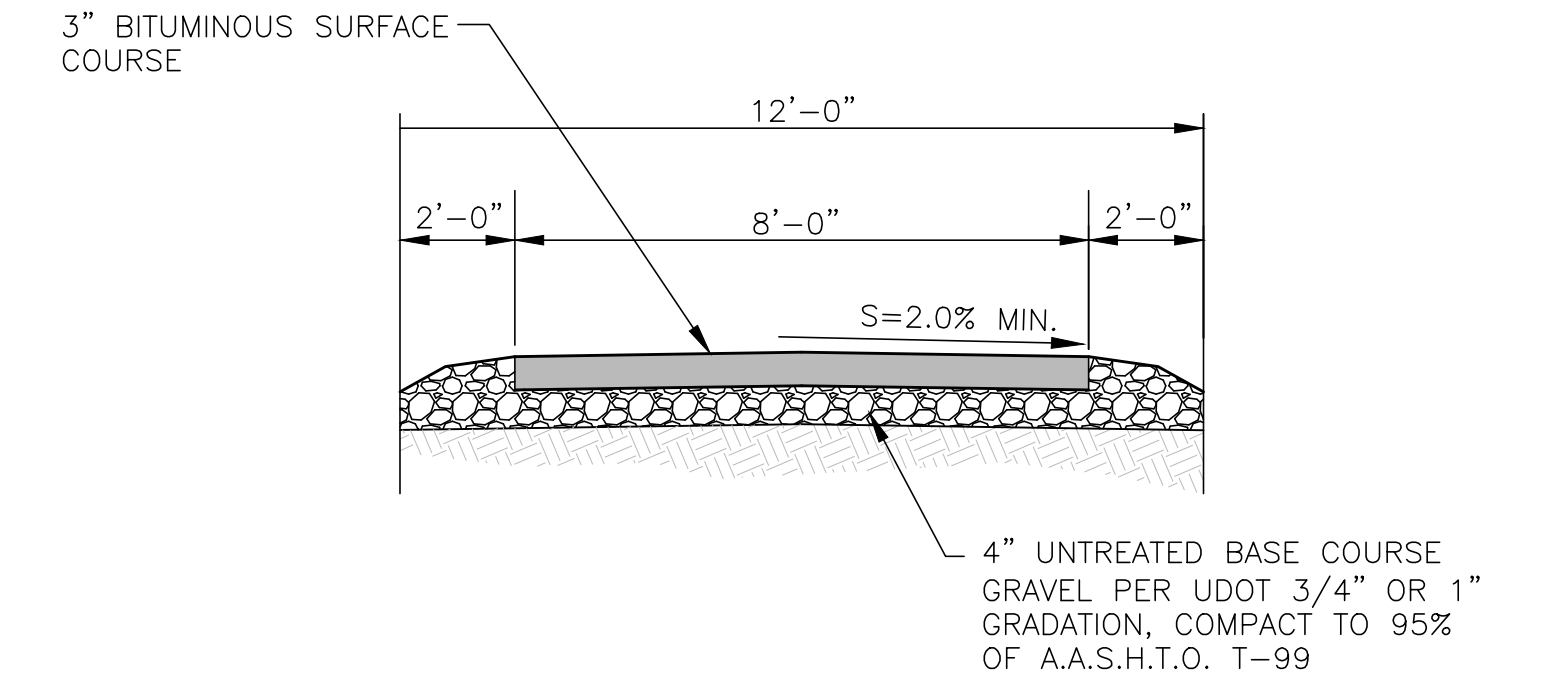

**Pathway Detail**  
SCALE: NONE

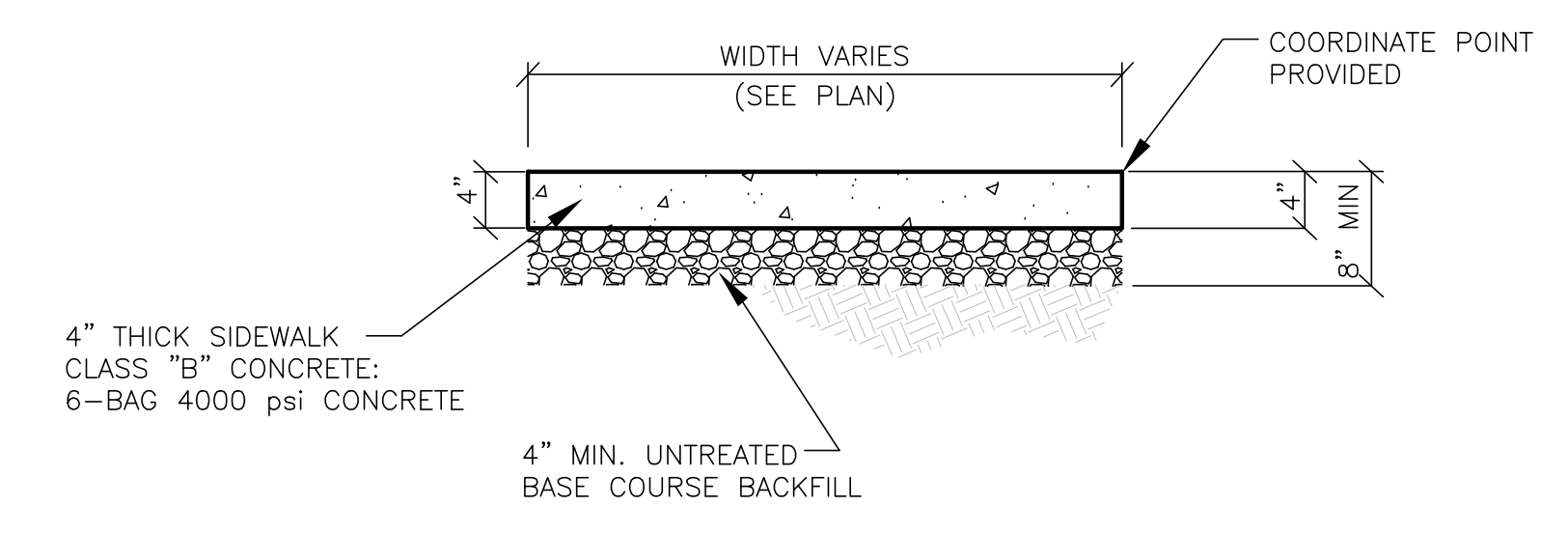

**Walkway Detail**  
SCALE: NONE  
(REFER TO SITE SPECIFIC GEOTECHNICAL REPORT)

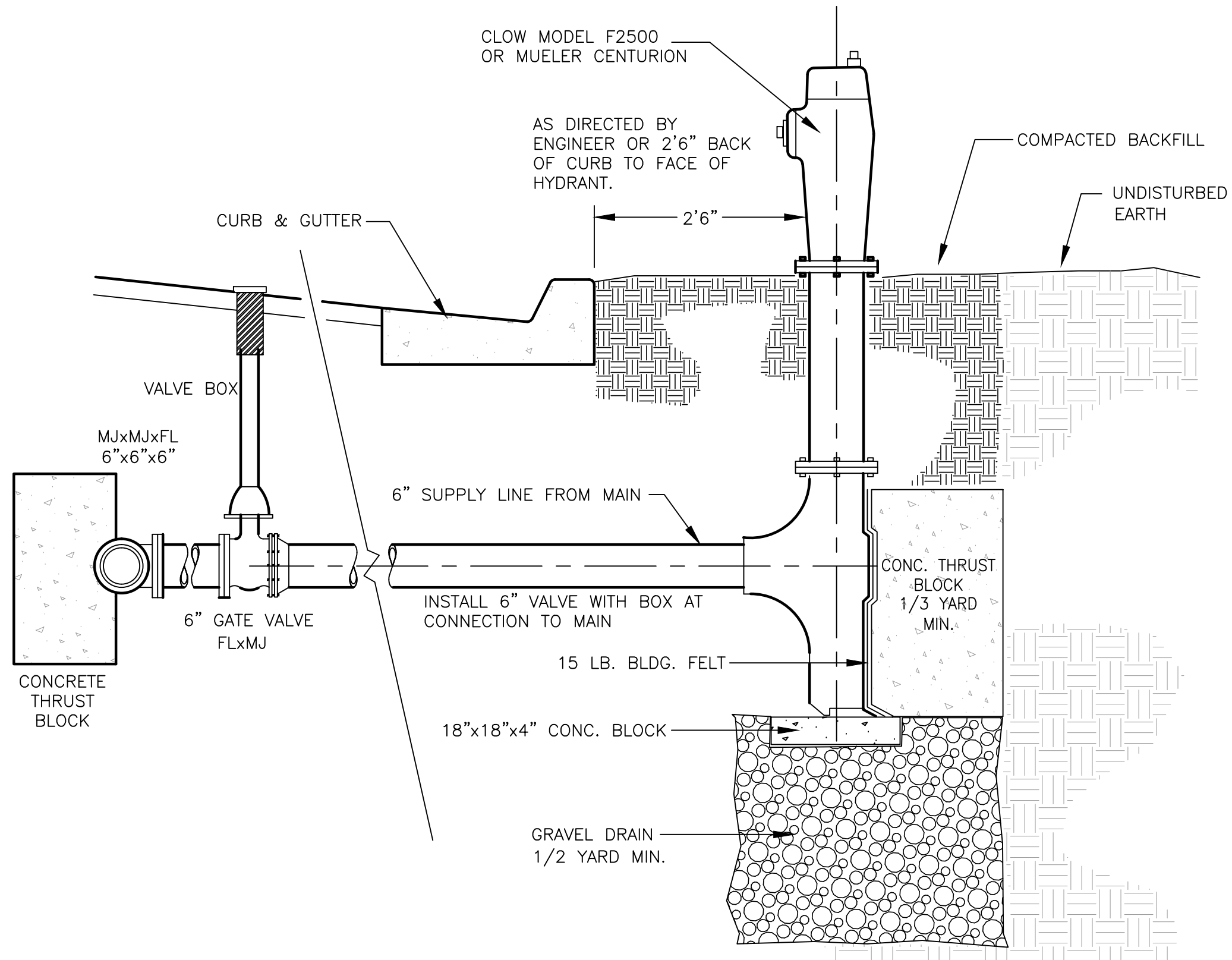

**Fire Hydrant Detail**  
SCALE: NONE

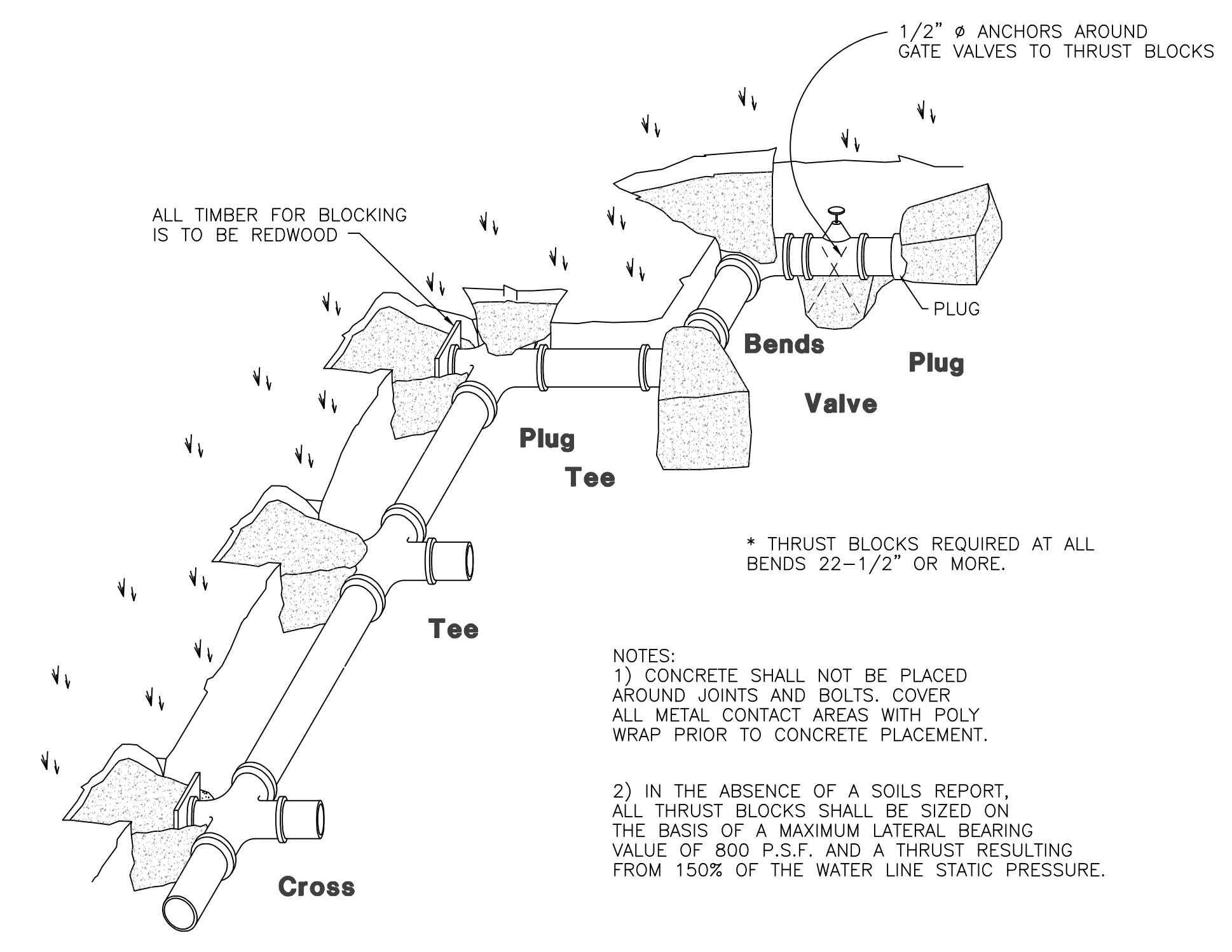

**Thrust Block Detail**  
SCALE: NONE

NOTES:  
1) CONCRETE SHALL NOT BE PLACED AROUND JOINTS AND BOLTS. COVER ALL METAL CONTACT AREAS WITH POLY WRAP PRIOR TO CONCRETE PLACEMENT.  
2) IN THE ABSENCE OF A SOILS REPORT, ALL THRUST BLOCKS SHALL BE SIZED ON THE BASIS OF A MAXIMUM LATERAL BEARING VALUE OF 800 P.S.F. AND A THRUST RESULTING FROM 150% OF THE WATER LINE STATIC PRESSURE.

\* THRUST BLOCKS REQUIRED AT ALL BENDS 22-1/2" OR MORE.

**Reeve & Associates, Inc.**  
920 CHAMBERS STREET, SUITE 14, OGDEN, UTAH 84403  
TEL: (801) 621-2100 FAX: (801) 621-2666 WWW.REEVE-ASSOC.COM  
LAND PLANNERS • CIVIL ENGINEERS • LAND SURVEYORS  
TRA PROFESSIONAL ARCHITECTS

REVISIONS	DESCRIPTION
DATE	

**Edgewater Beach Resort Phase-2**  
WEBER COUNTY, UTAH  
**Civil Details**

**REGISTERED PROFESSIONAL ENGINEER**  
375328  
J. NATE REEVE  
STATE OF UTAH

**Project Info.**  
Engineer: J. NATE REEVE, P.E.  
Drafted: R. HANSEN  
Begin Date: MARCH 2, 2015  
Name: EDGEWATER BEACH RESORT PHASE-2  
Number: 6240-03

Sheet **12**  
8 Sheets