

Weber County Building Inspections Permit

Date Submitted 20-FEB-2024	Date Issued 02-JUL-2024	Receipt Number INVOICE #20591	Square FT of Build 4006	Valuation \$750,000.00	Permit Number 2024F348
Proposed Use of Structure SINGLE FAMILY DWELLING			<input type="radio"/> Rough Basement <input type="radio"/> Finished Basement		
Building Address 3570 N 4875 E, EDEN 84310		Parcel Number 22-192-0021	Carport sq ft	Garage sq ft 915	Building Fees \$2,925.75
Lot 35	Subdivision Name VILLAGE AT WOLF CREEK (THE) A PRUD		Type of Bldg. V-B	Occ. Group R-3	Plan Check Fees \$1,146.51
Property Location 3570 N 4875 E		Total Property Area	Total Bld. Area 4006	No. of Bldgs. 1	No. of Stories 2
Property Owner JOHNSON, WILLIAM ANDREW		Phone		No. of Dwellings 1	Electrical Fees \$150.00
Mailing Address 2089 S 850 E		City - Zip BOUNTIFUL - 84010		No. of Bedrooms 5	Plumbing Fees \$100.00
Architect or Engineer		Phone		Max Occ. Load	Fire Sprinkler NO
General Contractor VISTA CONSTRUCTION		Phone 801-493-5697		Mechanical Fees \$100.00	
Contractor Address 423 W BROADWAY, STE 230, SLC		State License # 10757861-5501		Subtotal \$4,422.26	
Electrical Contractor Grimm Electric		Phone 801-979-7886		State Fee \$32.76	
Contractor Address		State License # 12529849-5501		Storm Drain Impact Fee \$1,234.71	
Plumbing Contractor Quick Quality Plumbing		Phone 801-763-7835		Wastewater Impact Fee	
Contractor Address		State License # 8321521-5501		Roadways Impact Fee \$1,200.00	
Mechanical Contractor Quality Control HVAC		Phone 801-783-8002		Other Fees \$40.00	
Contractor Address		State License # 12833540-5501		Total Fees \$8,704.73	

This application does not become a permit until signed below.

Plan Chk. OK by

Signature of Approval **REBECCA HANSEN** Date **7-2-2024**

This permit becomes null and void if work or construction authorized is not commenced within 180 days, or if construction or work is suspended or abandoned for a period of 180 days at any time after work is commenced. I hereby certify that I have read and examined this application and know the same to be true and correct. All provisions of laws and ordinances governing this type of work will be complied with whether specified herein or not the granting of a permit does not presume to give authority to violate or cancel the provisions of any other state or local law regulating construction or the performance of construction and that I make this statement under penalty of perjury.

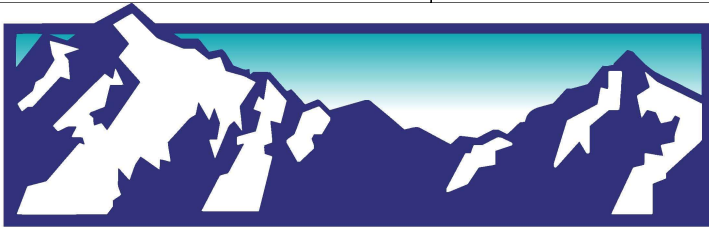

WEBER COUNTY

* **VISTA CONSTRUCTION**
Signature of Contractor or Authorized Agent

7-1-2024
Date

*
Signature of Owner (If owner)

(Date)



Land Use Permit

Weber County Planning Commission

2380 Washington Blvd. STE 240

Ogden, UT 84401

Phone: 801-399-8374 FAX: 801-399-8862

webercountyutah.gov/planning

Permit Number: LUP240-2024

Permit Type: Structure

Permit Date: 06/26/2024

Applicant

Name: Andrew Pynes

Business:

Address: 3570 N WILLOWCREEK LN
Eden, UT 84310

Phone: 801-493-5697

Owner

Name: Andrew Johnson

Business:

Address:
, UT

Phone: 801-870-4827

Parcel

Parcel: 221920021

Zoning: FR-3 **Area:** .0705 **Sq Ft:**

Address: 3570 N 4875 E EDEN, UT 84310

Lot(s): 35

Subdivision: VILLAGE AT WOLF CRE

T - R - S - QS: 7N - 1E - 22 -

Proposal

Proposed Structure: Single Family Dwelling

Proposed Structure Height: 35

of Dwelling Units: 1

Off Street Parking Req'd: 2

Building Footprint: 1331

Max Structure Height in Zone: 35

of Accessory Bldgs:

***Is Structure > 1,000 Sq. Ft?** N/A

***If True Need Certif. Statement**

Permit Checklist

Access Type: Front lot line

Greater than 4218 ft above sea level? Yes

Additional Setback Req'd. ? N/A

> 200 ft from paved Road? N/A

Culinary Water District: Wolfcreek Water Comp

Alternative Access File #

Wetlands/Flood Zone? N/A

Meet Zone Area Frontage? Yes

Hillside Review Req'd? N/A

Waste Water System: Wolfcreek Sewer Improveme

Comments

Any outdoor lighting must comply with section 108-16

Land Use Permit

Structure Setback Graphic: New Dwelling, Addition, Etc.

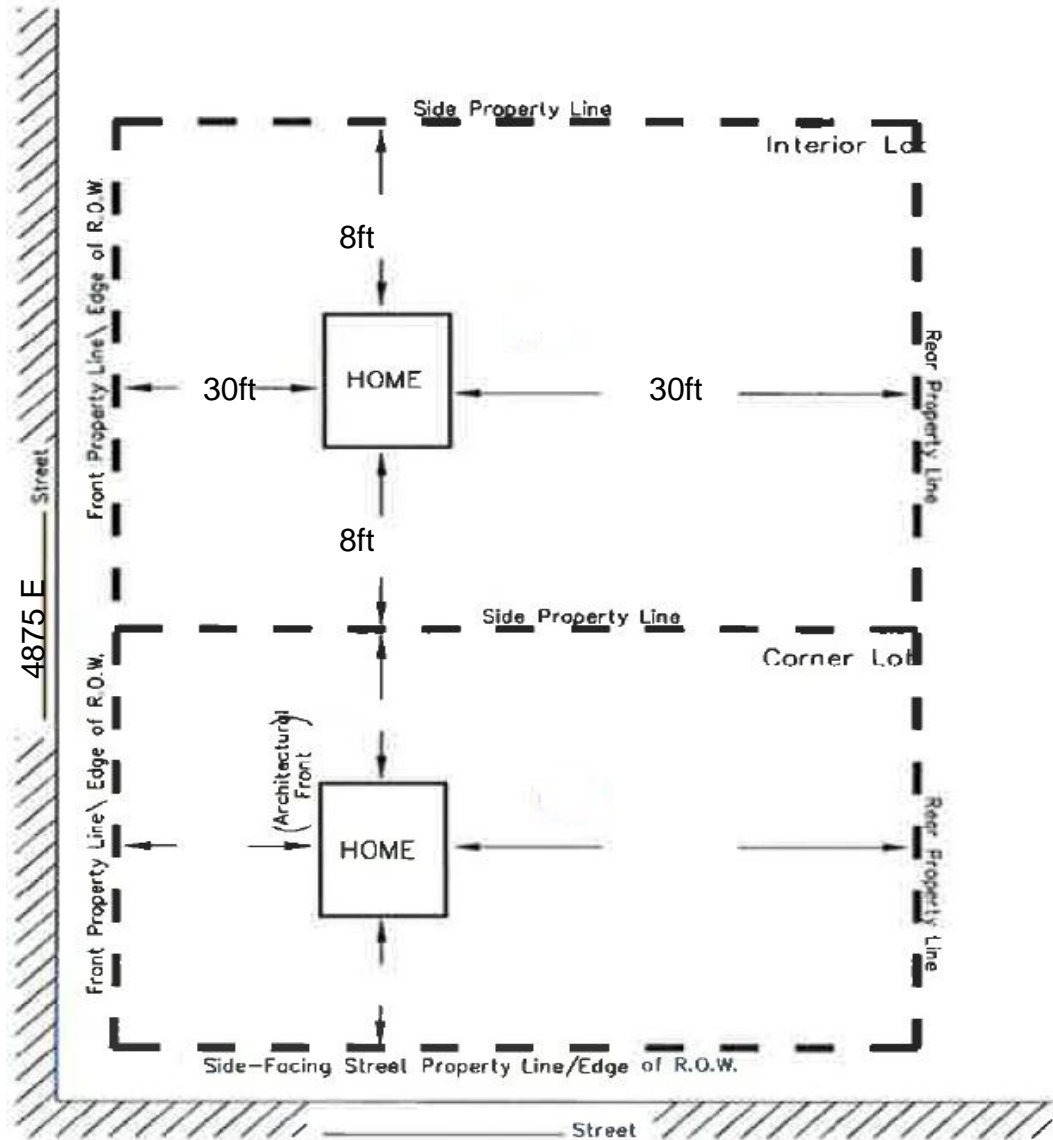

MINIMUM YARD SETBACKS New Dwelling, Addition, Etc.

NOTICE FOR APPLICANT (Please Read Before Signing)

Proposals for the installation of an individual water supply and for a sanitary waste disposal system (septic tank) for any structure designed for human occupation must be approved by Weber County Health Department prior to installation.

Marta Borchert

06/26/2024

Planning Dept. Signature of Approval

Date

I hereby certify that I have read and examined this application and know the same to be true and correct. All provisions of laws and ordinances governing this land use will be complied with whether specified herein or not. I make this statement under penalty of perjury.

VISTA CONSTRUCTION

7-1-2024

Contractor/Owner Signature of Approval

Date

Weber County Building Inspection Upper Valley Permit Fee Worksheet

Permit Type: Single Family Dwelling

Permit Number: 2024F348

Owner: Andrew Johnson
Address: 3570 N 4875 E, Eden
General Contractor: Vista Construction
Telephone: 801-493-5697

Examiner: Kelly A. Janis
Date: June 14, 2024
Type of Const: V-B
No. of Bedrooms: 5

	Sq. Ft.	Rate	Total
Area of Main Floor:	355		
Area of 2nd&3rd Floor:	2,680		
Total	3,035	\$130.58	\$396,310.30
Finished Basement		\$65.29	\$0.00
Unfinished Basement		\$23.20	\$0.00
Area of Garage:	915	\$51.28	\$46,921.20
Covered Patio/Deck:	56	\$14.40	\$806.40
Area of Wood Deck		\$5.50	\$0.00
Total			\$444,037.90

Footprint:	1,326
Fire Area:	3,035
Total Sq. Feet:	4,006

Fee Type	Amount	
Building Fees:	\$2,925.75	
Plan Check Fees:	\$1,146.51	412210
Electrical Fees:	\$150.00	
Plumbing Fees:	\$100.00	
Mechanical Fees:	\$100.00	
Subtotal:	\$4,422.26	
Subtotal less Plan Check:	\$3,275.75	412205
State Fee:	\$32.76	412300
Storm Drain Impact Fee:	\$1,234.71	442205
Wastewater Impact Fee:		444205
Roadways Impact Fee:	\$1,200.00	446205
Trails Impact Fee:	\$1,350.00	440205
Total Impact Fees:	\$3,784.71	
Land Use Permit:	\$60.00	410100
SWPPP Fees:		402310
W.C.Engineering Review:	\$40.00	402200
Excavation Permit:		402350
Sewer Connection Fee:		412295
Sewer Lateral Connection Insp:		402500
Total Other Fees:	\$100.00	
Weber Fire Dist.Impact Fee:	\$315.00	410900
Weber Fire Dist. Plan Review:	\$50.00	410905
Total Fire District Fees:	\$365.00	

Comments:
PAID 7-1-2024
INVOICE #20591

Grand Total **\$8,704.73**