

DEVELOPMENT DATA	
DEVELOPMENT BOUNDARY AREA	56.25 ACRES
PROPOSED UNITS	101 UNITS
12-PLEX	120 UNITS
TOWNHOMES	72 UNITS

NOTE:
SITE DESIGN, AMENITIES ROAD ALIGNMENTS AND LOT LINES ARE ALL CONCEPTUAL AND SUBJECT TO CHANGE BASED ON FINAL ENGINEERING AND CONSTRUCTION

EXHIBIT B
MASTER PLAN

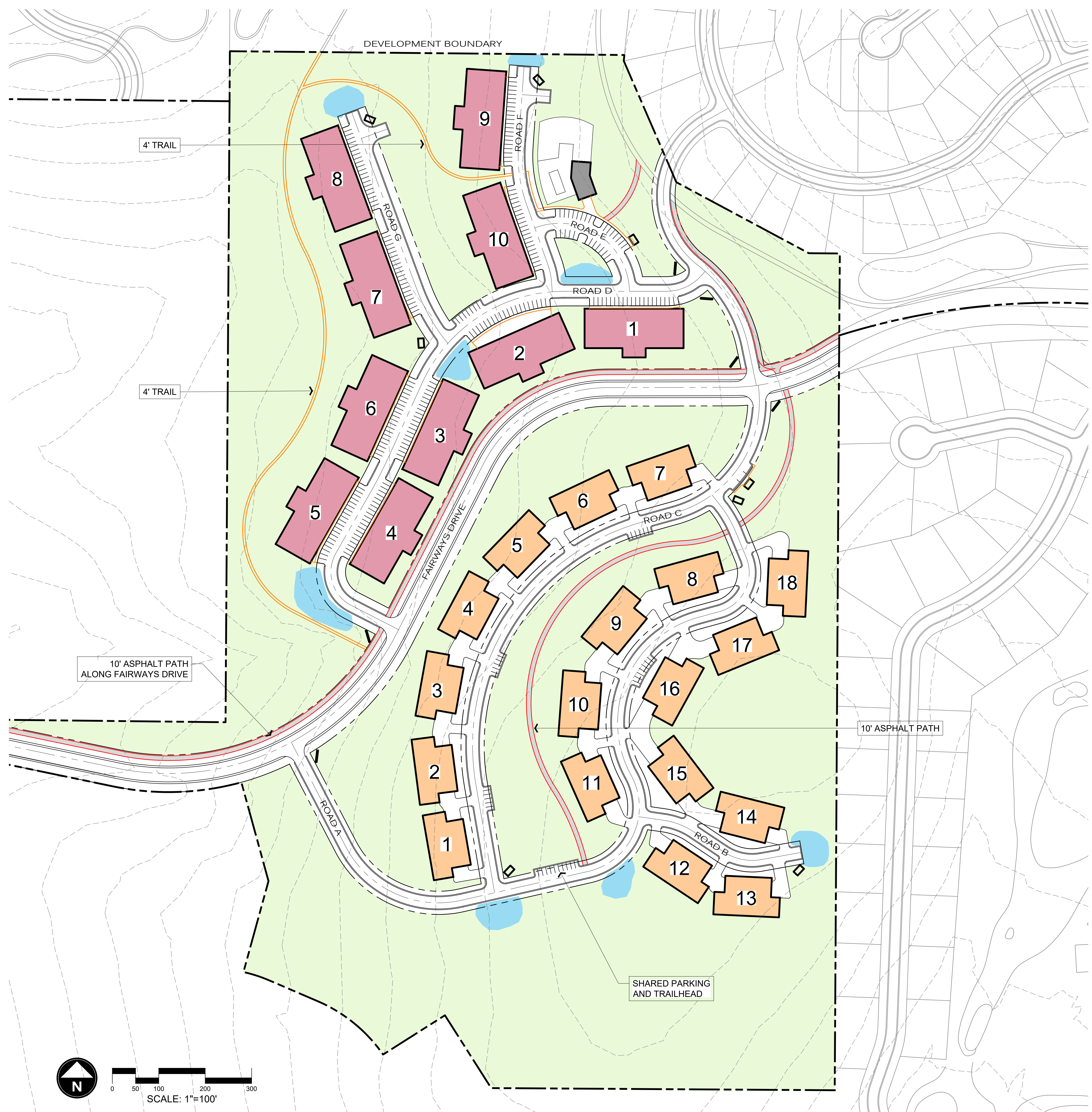

OPEN SPACE DATA

PROPOSED OPEN SPACE	<div></div>	35.00 ACRES
PROPOSED TRAILS		
<div></div> 10' ASPHALT PATH		0.75 MILES
<div></div> 4' TRAIL		0.35 MILES

NOTE:
SITE DESIGN, AMENITIES ROAD ALIGNMENTS
AND LOT LINES ARE ALL CONCEPTUAL AND
SUBJECT TO CHANGE BASED ON FINAL
ENGINEERING AND CONSTRUCTION

10' ASPHALT PATH



4' TRAIL

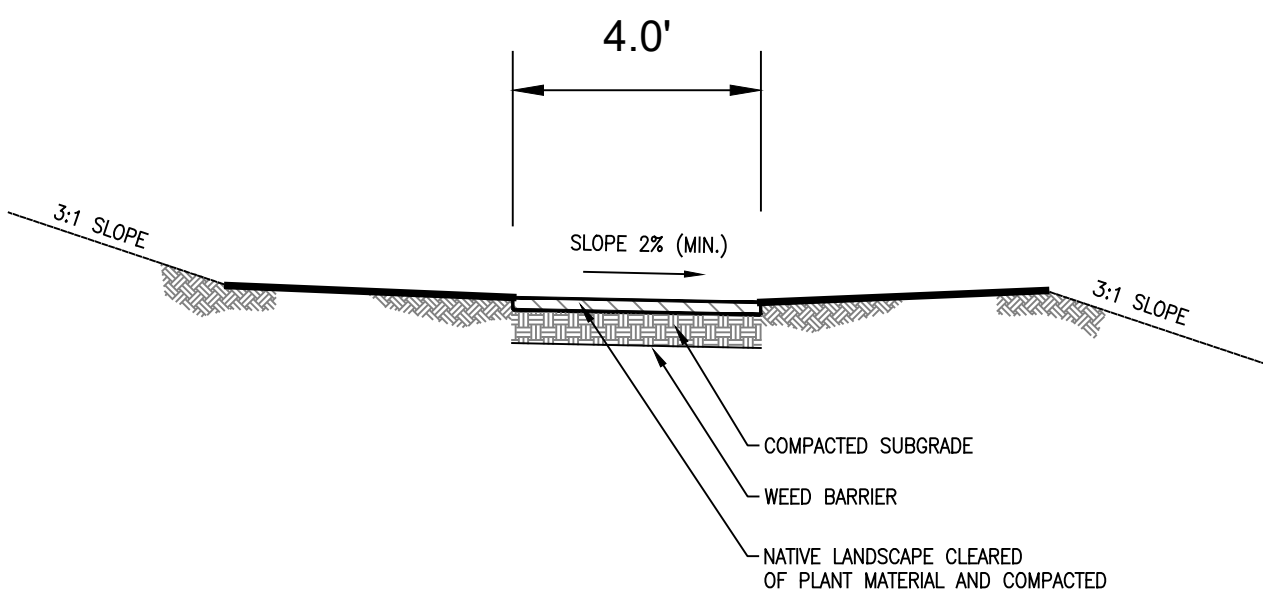
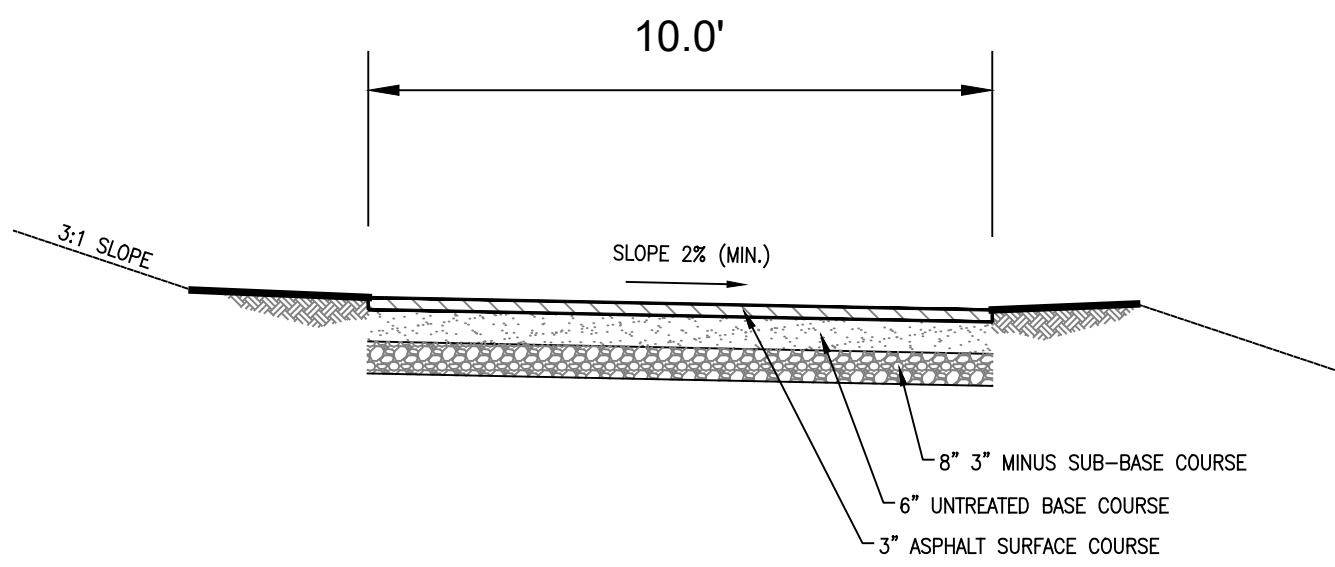
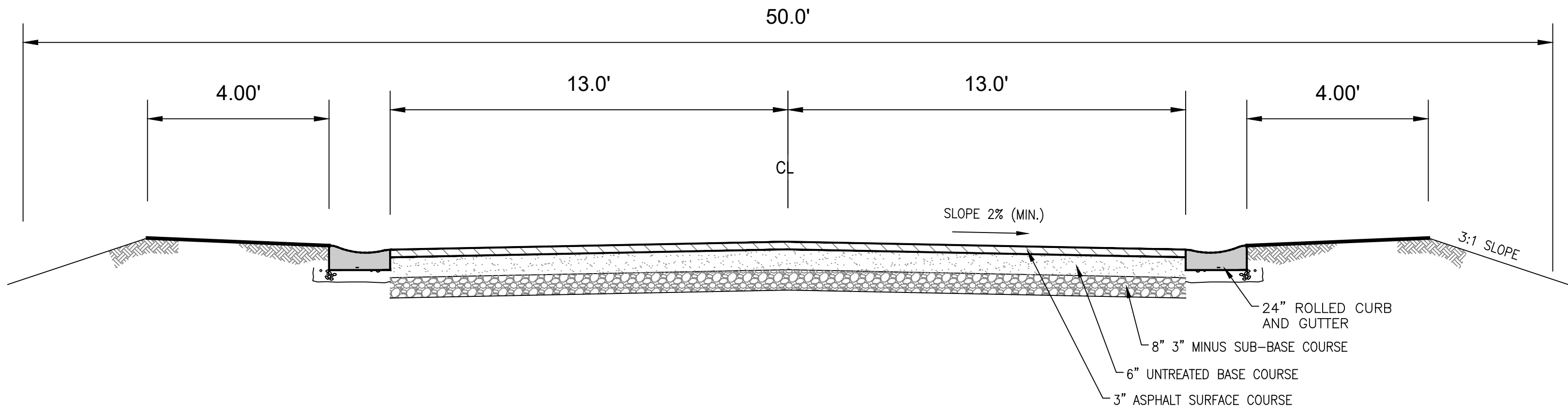

EXHIBIT C
PARKS / TRAILS /
OPEN SPACE (PTOS)



NOTE:
ALL DEPTH STANDARDS ARE MINIMUM AND MORE CAN BE REQUIRED BASED ON GEOTECHNICAL REPORT

50' ROW - TYPICAL PRIVATE ROADWAY

NOT TO SCALE

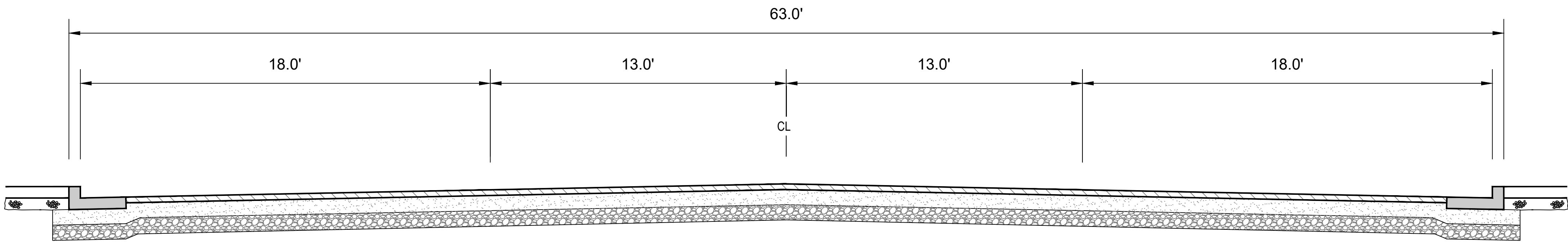

NOTE:
ALL DEPTH STANDARDS ARE MINIMUM AND MORE CAN BE REQUIRED BASED ON GEOTECHNICAL REPORT

50' ROW - TYPICAL PRIVATE ROADWAY

NOT TO SCALE

ROAD PROFILES

NOT TO SCALE

EXHIBIT D
TECHNICAL GUIDELINES

<div><div>SHEET TITLE:</div><div>TECHNICAL GUIDELINES</div><div>SHEET NUMBER:</div><div>EX. D</div></div>	<div>EAGLE CREST</div> <div>MASTER PLAN</div> <div>WEBER COUNTY, UTAH</div>	<div><div>LANDSCAPE DESIGN GROUP</div><div>EST. 2006</div><div>LDG</div><div>SALT LAKE CITY</div><div>LANDSCAPE ARCHITECTURE</div></div>
-----------------------------------------------------------------------------------------------------------	-----------------------------------------------------------------------------	------------------------------------------------------------------------------------------------------------------------------------------